

LOCATION ONE COMMERCE | WEST LAS VEGAS SUBMARKET

3111 S Valley View Dr
LAS VEGAS, NV 89102



FLEX WAREHOUSE SUBLEASE ±5,416 SF NEAR I-15 & STRIP | LEASE EXPIRES NOVEMBER 2028

KAYLEE BORAM CHO, CCIM
NV LIC# BS.0144592

RENA AREE
NV LIC# S.0197997
C: (702) 530-8383
E: RenaAree@gmail.com

kw | Keller Williams
COMMERCIAL
LAS VEGAS

9420 W Sahara Ave Ste 100 | Las Vegas, NV



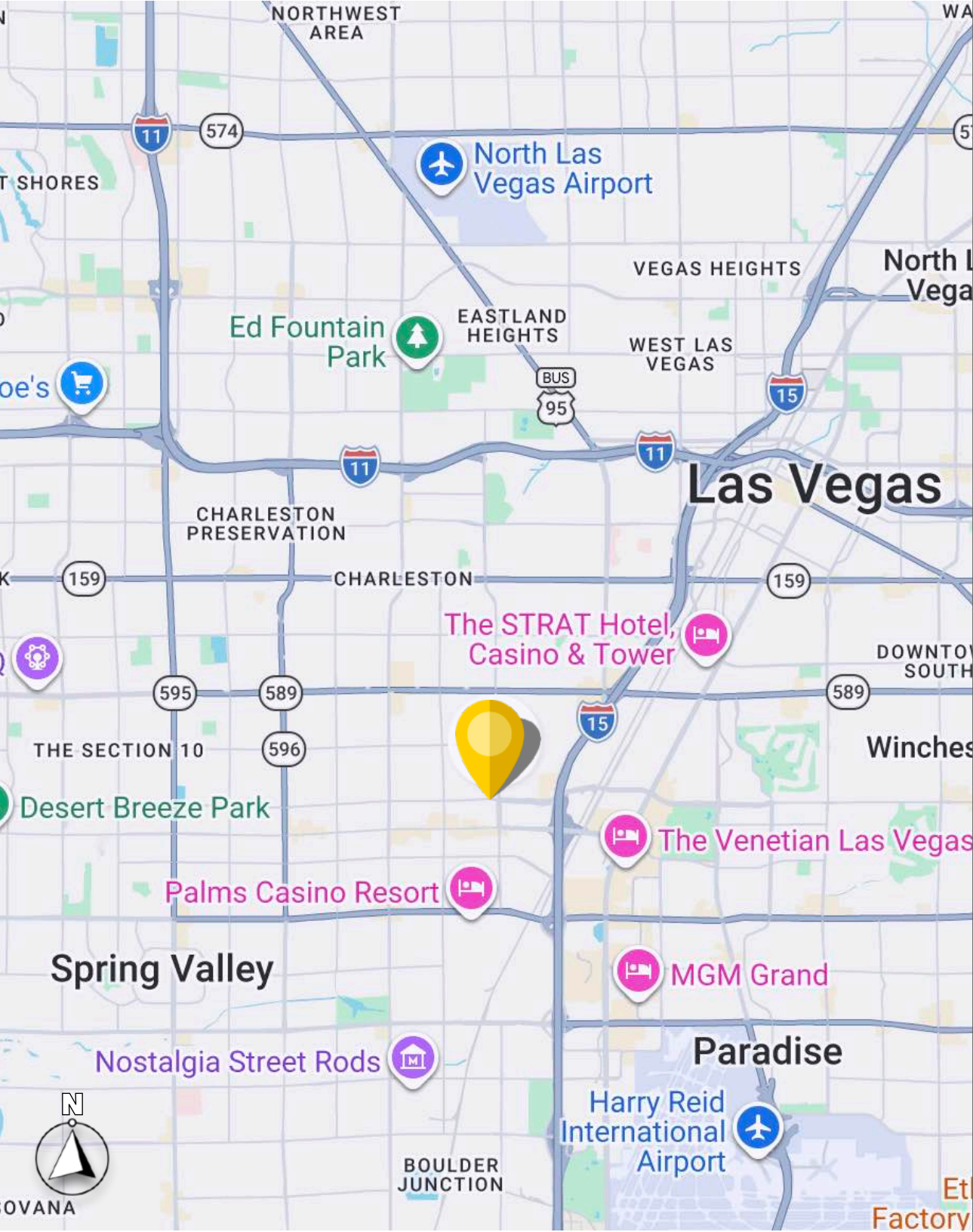

PROPERTY SUMMARY

SUBMARKET: West Las Vegas
APN: 162-07-802-013
ZONING: Industrial Light (I-L)
JURISDICTION: Clark County
BUILT: 1974
CENTER: Location One Commerce
PARKING RATIO: 3.1/1,000 SF

PROPERTY HIGHLIGHTS

- 522,431 SF Mixed-use/Flex center
- Centrally located in the West Las Vegas Submarket
- Quick access to I-15 and the Las Vegas Strip
- Multiple ingress/egress points via Desert Inn Rd, Valley View Blvd, Sirius Ave, and Wynn Rd

AVAILABLE FOR SUBLEASE

SUITE D-103 SUBLEASE

SIZE	±5,416 SF
RATE	\$1.082 PSF/mo (\$5,858/mo)
CAM	\$0.299 PSF/mo (\$1,622/mo)
TOTAL MONTHLY	\$7,480/mo
LEASE EXPIRATION	November 30, 2028
ANNUAL INCREASE	4%
CLEAR HEIGHT	15'9"
DOCK LOADING DOOR	12'x12'
POWER	120/240V, Single phase, 125 Amps
SPACE DETAILS	<ul style="list-style-type: none">• 2 offices (PTAC)• Reception area• Private restroom• Warehouse (evaporative cooled)

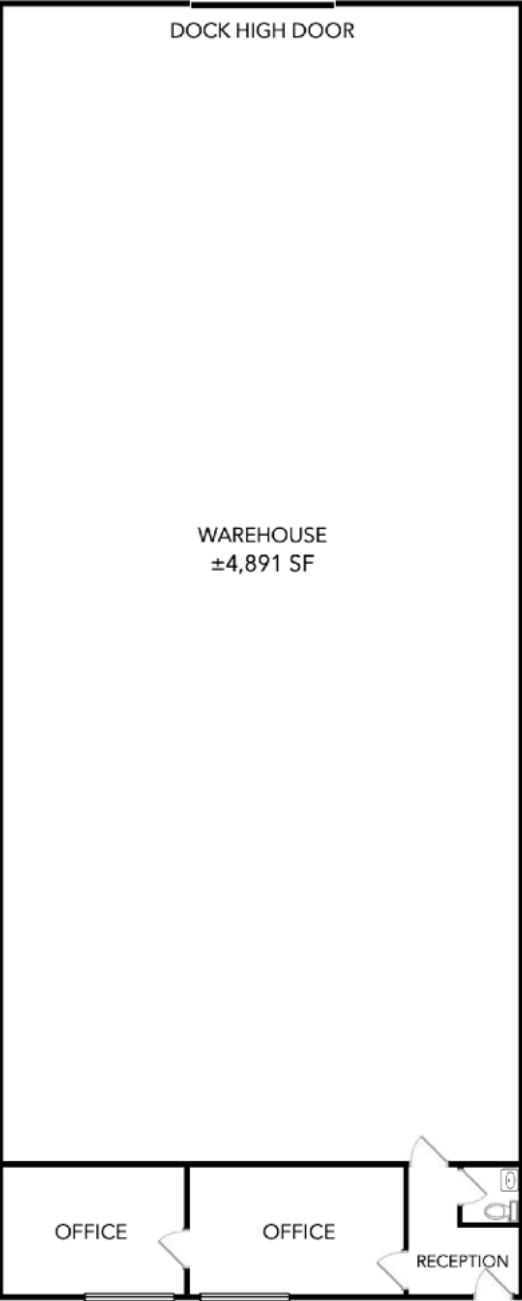

* Floor plan is not to exact scale. Intended for general information purposes only.

PHOTOS



MAP

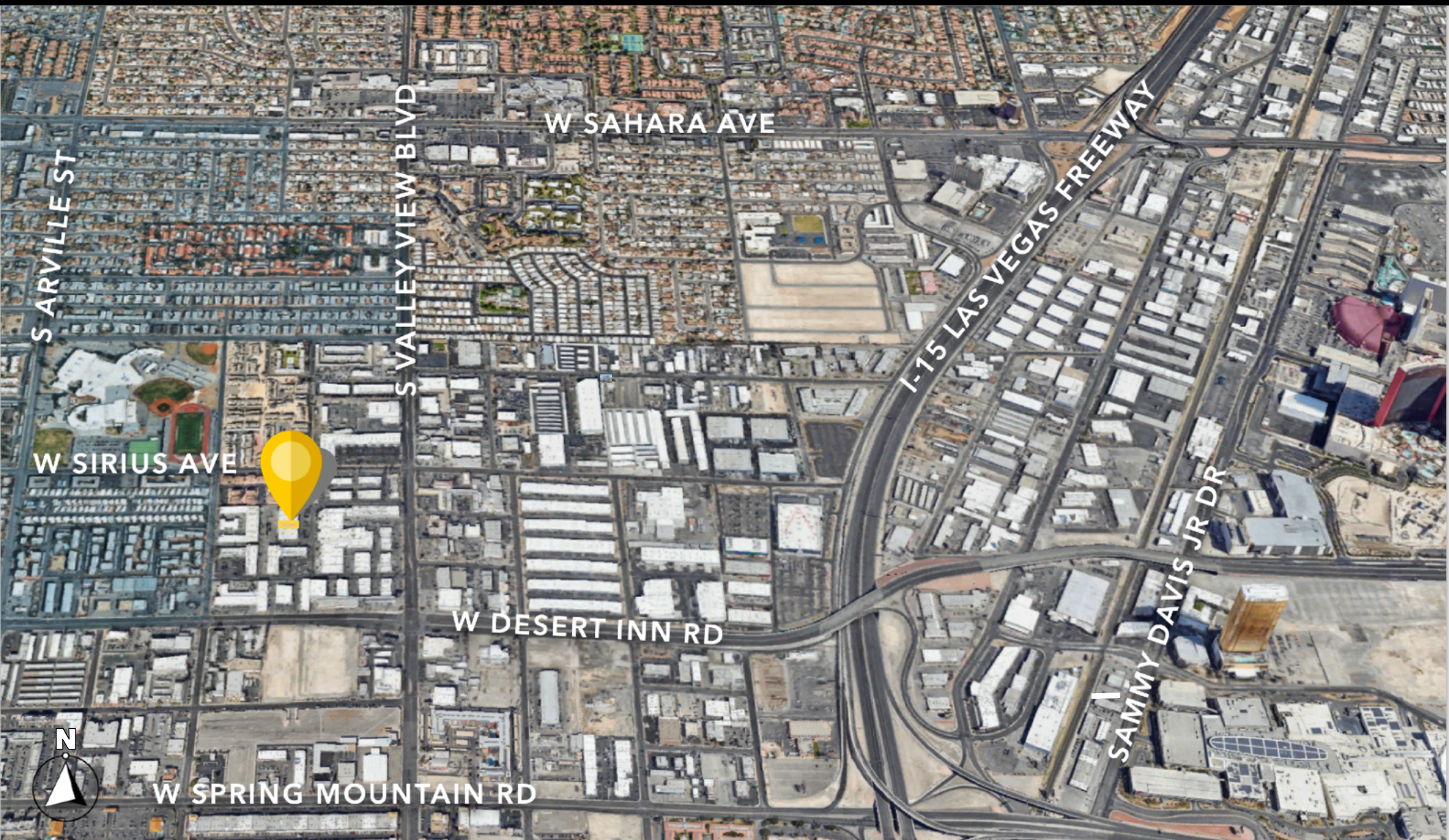

KAYLEE BORAM CHO, CCIM
NV LIC# BS.0144592

RENA AREE
NV LIC# S.0197997
C: (702) 530-8383
E: RenaAree@gmail.com

kw | Keller Williams
COMMERCIAL
LAS VEGAS



9420 W Sahara Ave Ste 100 | Las Vegas, NV

All materials and information received or derived from Keller Williams Realty Las Vegas | KW Commercial its directors, officers, agents, advisors, affiliates and/or any third party sources are provided without representation or warranty as to completeness, veracity, or accuracy, condition of the property, compliance or lack of compliance with applicable governmental requirements, developability or suitability, financial performance of the property, projected financial performance of the property for any party's intended use or any and all other matters.

Neither Keller Williams Realty Las Vegas | KW Commercial its directors, officers, agents, advisors, or affiliates makes any representation or warranty, express or implied, as to accuracy or completeness of the any materials or information provided, derived, or received. Materials and information from any source, whether written or verbal, that may be furnished for review are not a substitute for a party's active conduct of its own due diligence to determine these and other matters of significance to such party. Keller Williams Realty Las Vegas | KW Commercial will not investigate or verify any such matters or conduct due diligence for a party unless otherwise agreed in writing.

EACH PARTY SHALL CONDUCT ITS OWN INDEPENDENT INVESTIGATION AND DUE DILIGENCE.

Any party contemplating or under contract or in escrow for a transaction is urged to verify all information and to conduct their own inspections and investigations including through appropriate third-party independent professionals selected by such party. All financial data should be verified by the party including by obtaining and reading applicable documents and reports and consulting appropriate independent professionals. Keller Williams Realty Las Vegas | KW Commercial makes no warranties and/or representations regarding the veracity, completeness, or relevance of any financial data or assumptions. Keller Williams Realty Las Vegas | KW Commercial does not serve as a financial advisor to any party regarding any proposed transaction.

All data and assumptions regarding financial performance, including that used for financial modeling purposes, may differ from actual data or performance. Any estimates of market rents and/or projected rents that may be provided to a party do not necessarily mean that rents can be established at or increased to that level. Parties must evaluate any applicable contractual and governmental limitations as well as market conditions, vacancy factors and other issues in order to determine rents from or for the property. Legal questions should be discussed by the party with an attorney. Tax questions should be discussed by the party with a certified public accountant or tax attorney. Title questions should be discussed by the party with a title officer or attorney. Questions regarding the condition of the property and whether the property complies with applicable governmental requirements should be discussed by the party with appropriate engineers, architects, contractors, other consultants, and governmental agencies. All properties and services are marketed by Keller Williams Realty Las Vegas | KW Commercial in compliance with all applicable fair housing and equal opportunity laws.

The calculations and data presented are deemed to be accurate, but not guaranteed. They are intended for the purpose of illustrative projections and analysis. The information provided is not intended to replace or serve as substitute for any legal, accounting, investment, real estate, tax or other professional advice, consultation or service. The user of this software should consult with a professional in the respective legal, accounting, tax or other professional area before making any decisions.

KAYLEE BORAM CHO, CCIM
NV LIC# BS.0144592

RENA AREE
NV LIC# S.0197997
C: (702) 530-8383
E: RenaAree@gmail.com

kw | Keller Williams
COMMERCIAL
LAS VEGAS

9420 W Sahara Ave Ste 100 | Las Vegas, NV



KAYLEE CHO & RENNA AREE
COMMERCIAL REAL ESTATE