



2245 West Broadway

// FOR LEASE

UNIT 100

1,184 SF (APPROX.)



[Virtual Tour](#)

Ground floor office with private washroom and a shared outdoor patio.
Can be combined with Unit 101 for ~2,077 SF total. Additional rent: \$13.20 PSFPA. On-site parking available.

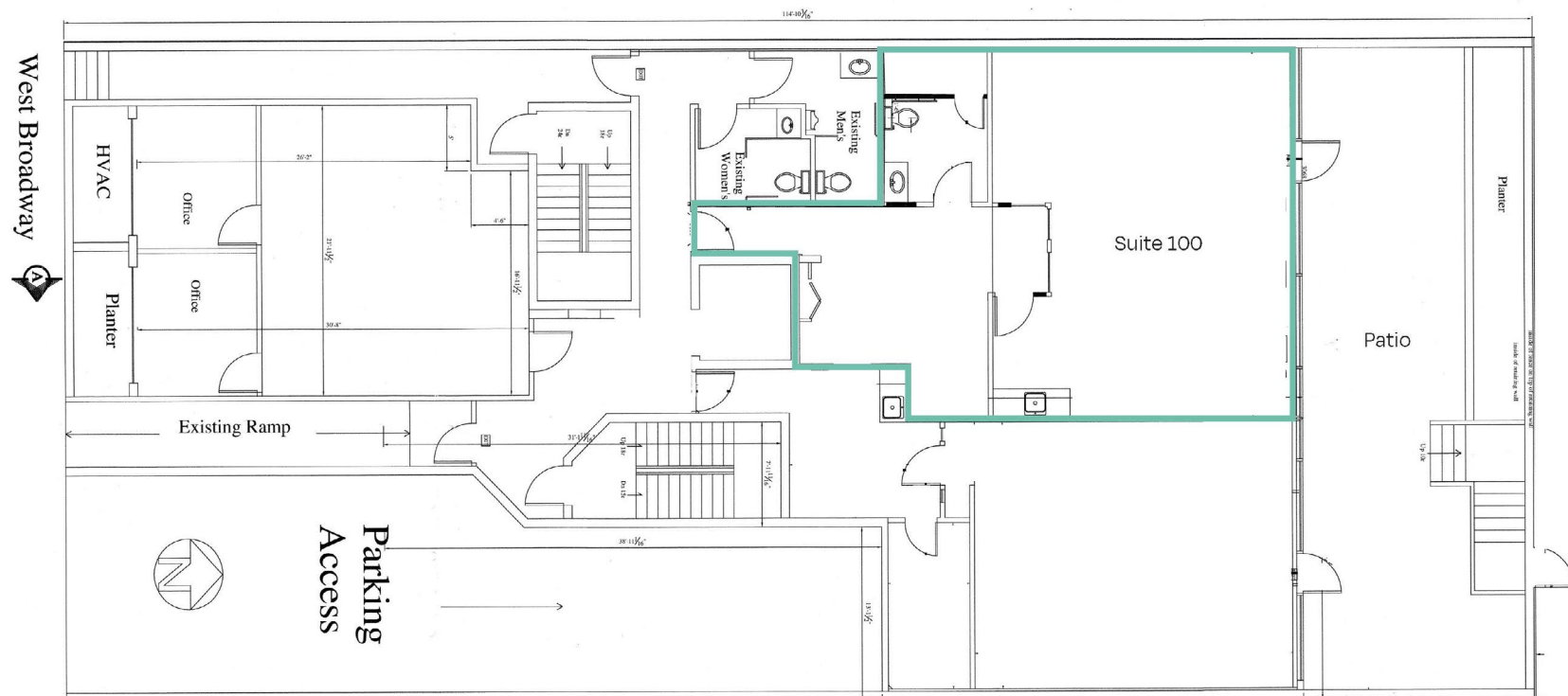

UNIT 101

893 SF (APPROX.)



[Virtual Tour](#)

Ground floor office with a front room with built-in cabinetry and a sink, a separate enclosed room, and a large main area with natural light and a shared outdoor patio. Can be combined with Unit 101 for ~2,077 SF total. Additional rent: \$13.20 PSFPA. On-site parking available.

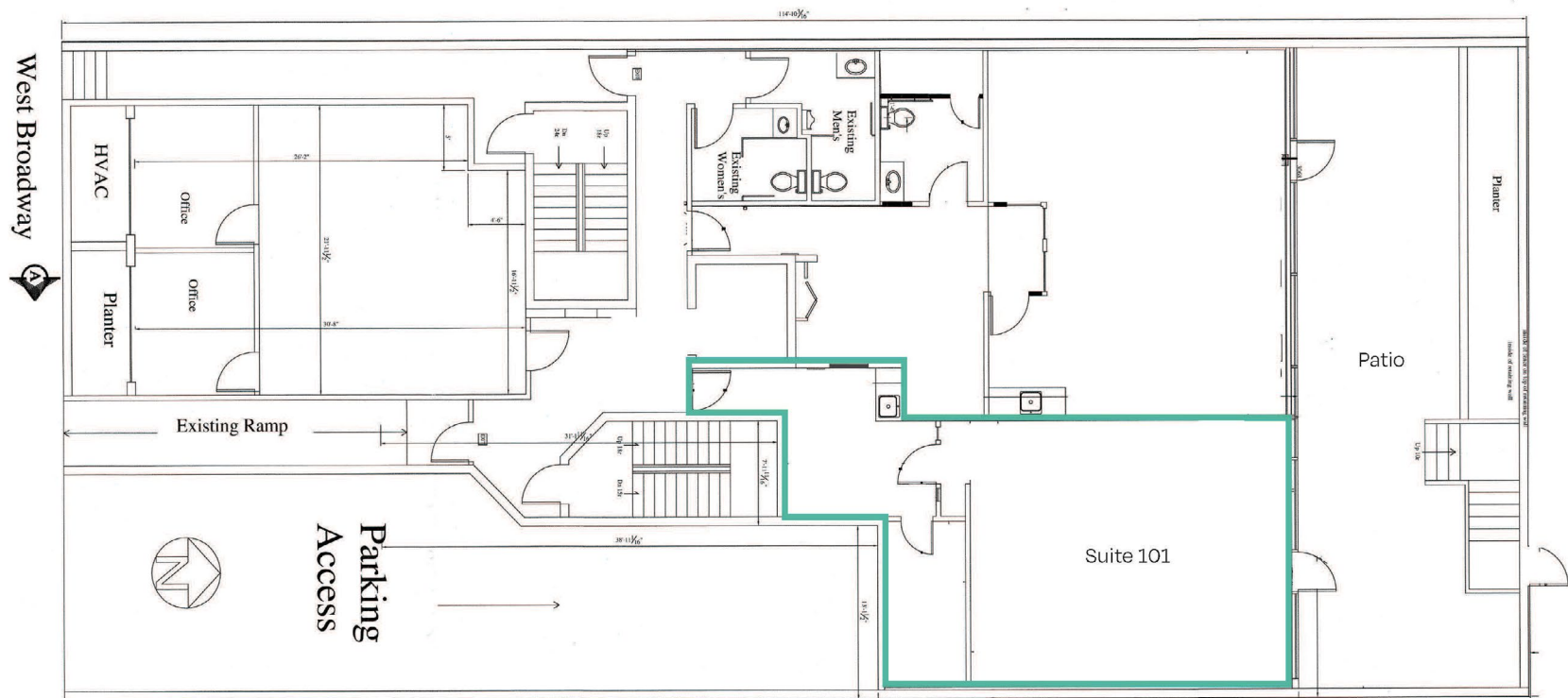

UNIT 202

981 SF (APPROX.)



[Virtual Tour](#)

Second floor functional office space featuring two private offices with windows and a private patio. Layout includes an open area suitable for workstations or reception, along with a kitchenette. Additional rent: \$13.20 PSFPA. On-site parking available.

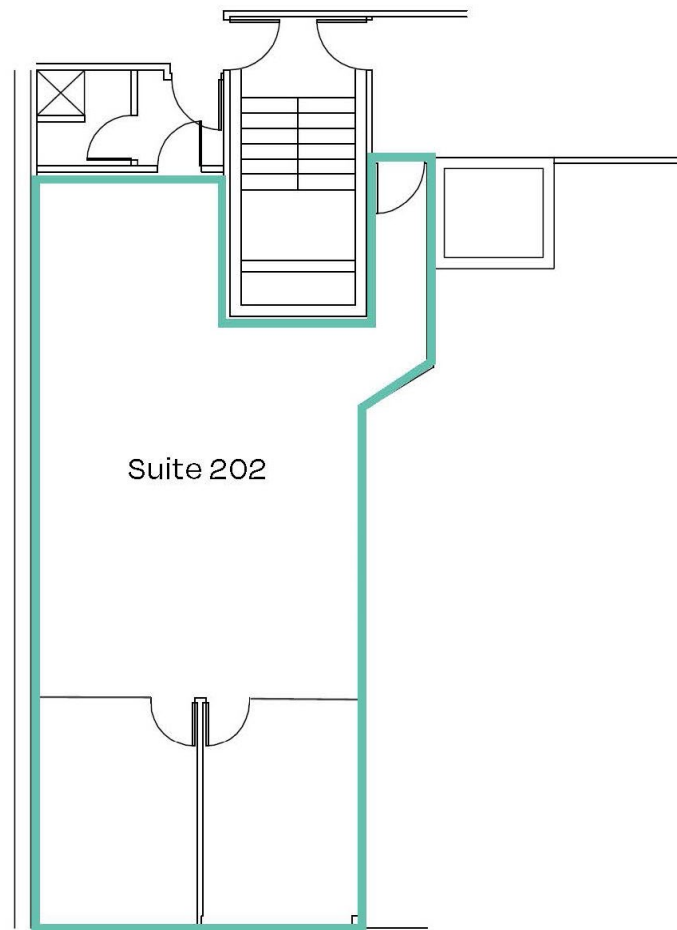

UNIT 301

941 SF (APPROX.)

Spacious and adaptable office space in a well-maintained professional building in Kitsilano. ~941 Sq.Ft., ideal for a variety of business uses. Conveniently located near transit, shops, and the future Arbutus SkyTrain station. Additional rent: \$13.20 PSFPA. On-site parking available.

FLOOPLAN TBD



For more information, please contact:



Harris Sheldon

ASSOCIATE

+1 604 612 6516

harris@floorspace.ca

FLOORSPACE

900 West Hastings St., Suite 520

Vancouver, BC Canada

V6C 1E5

www.floorspace.ca

THIS DOCUMENT HAS BEEN PREPARED BY FLOORSPACE COMMERCIAL INC. FOR ADVERTISING AND GENERAL INFORMATION ONLY. ALL INFORMATION CONTAINED HEREIN IS FROM SOURCES WE DEEM RELIABLE, AND WE HAVE NO REASON TO DOUBT ITS ACCURACY; HOWEVER, NO GUARANTEE OR RESPONSIBILITY IS ASSUMED THEREOF, AND IT SHALL NOT FORM ANY PART OF FUTURE CONTRACTS. PROPERTY INFORMATION IS SUBMITTED SUBJECT TO ERRORS AND OMISSIONS AND ALL INFORMATION SHOULD BE CAREFULLY VERIFIED. ANY INTERESTED PARTY SHOULD UNDERTAKE THEIR OWN INQUIRIES AS TO THE ACCURACY OF THE INFORMATION. ALL MEASUREMENTS QUOTED HEREIN ARE APPROXIMATE. THIS PUBLICATION IS THE COPYRIGHTED PROPERTY OF FLOORSPACE COMMERCIAL INC. AND/OR ITS LICENSOR(S). COPYRIGHT © 2025 FLOORSPACE COMMERCIAL INC.

