

**4,000±
& 5,000±
SQUARE FEET
UNITS AVAILABLE
FOR LEASE**

**WAREHOUSE /
LIGHT INDUSTRIAL**

**IDEAL LOCATION
MINUTES FROM
TACONY-PALMYRA
BRIDGE & I-95**

How & Where May We Help You?



OWNED BY

**Camber
Real Estate
Partners**

AVAILABLE FOR LEASE

855 INDUSTRIAL HWY

CINNAMINSON, NJ

Scott Mertz, SIOR
+1 856 802 6529
scott.mertz@naimertz.com

NAI Mertz
21 Roland Avenue | Mount Laurel, NJ 08054
+1 856 234 9600 | naimertz.com

NAIMertz
COMMERCIAL REAL ESTATE SERVICES, WORLDWIDE

AVAILABLE FOR LEASE

855 INDUSTRIAL HWY

CINNAMINSON, NJ

CURRENT AVAILABILITIES

UNIT 2

- 4,005 SF flex unit
- Open warehouse area
- (1) tailgate door
- 14'2" ceiling height
- Approx. 25% office area
- Restrooms in office and warehouse

UNIT 4

- 5,006 SF flex unit
- Open warehouse area
- (1) tailgate door
- 14'2" ceiling height
- Approx. 20% office area
- Restrooms in office and warehouse

UNIT 11

- 4,022 SF flex unit
- Open warehouse area
- (1) tailgate door
- 14'2" ceiling height
- Approx. 20% office area
- Restrooms in office and warehouse

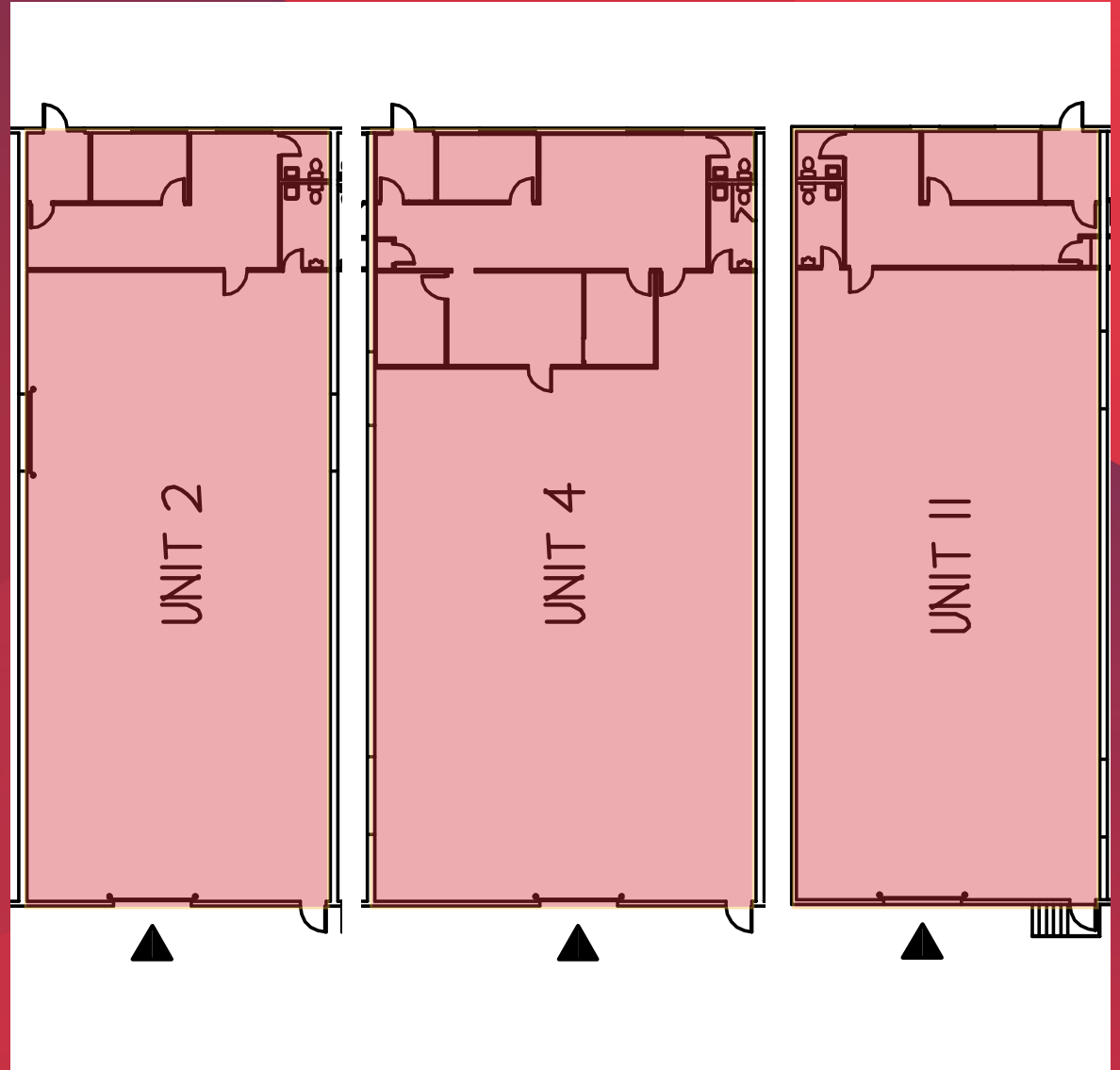

LOCATION INFORMATION

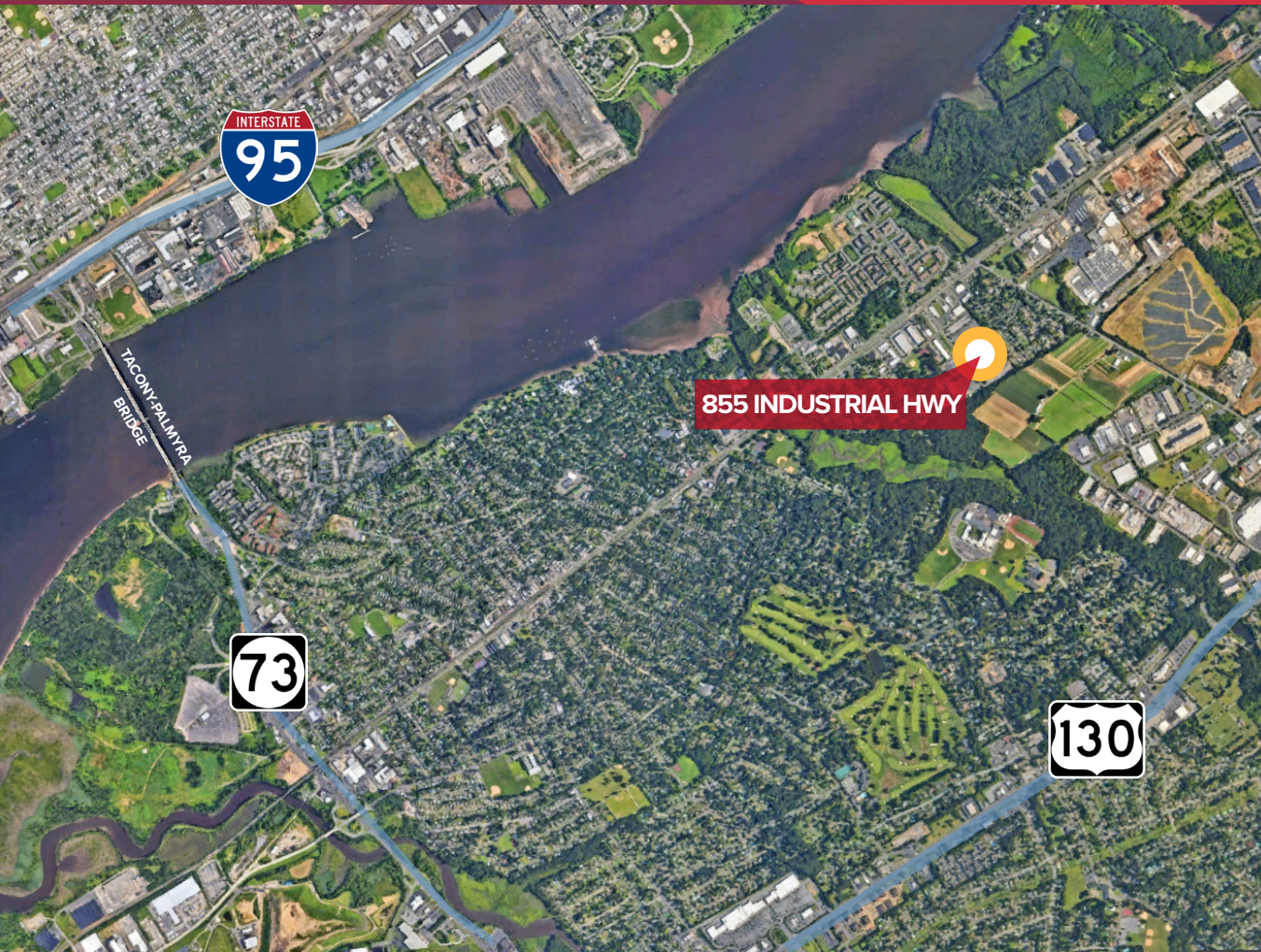

AVAILABLE FOR LEASE 855 INDUSTRIAL HWY

CINNAMINSON, NJ

Distance to

Route 130	1.8 mi
Route 73	2.6 mi
Tacony-Palmyra Bridge	3.0 mi
I-95 S	4.5 mi
I-95 N	5.0 mi
Betsy Ross Bridge	7.5 mi
Center City Philadelphia	12 mi

OWNED BY

**Camber
Real Estate
Partners**

Scott Mertz, SIOR

+1 856 802 6529

scott.mertz@naimertz.com

NAI Mertz

21 Roland Avenue | Mount Laurel, NJ 08054

+1 856 234 9600 | naimertz.com

NO WARRANTY OR REPRESENTATION, EXPRESS OR IMPLIED, IS MADE AS TO THE ACCURACY OF THE INFORMATION CONTAINED HEREIN, AND THE SAME IS SUBMITTED SUBJECT TO ERRORS, OMISSIONS, CHANGE OF PRICE, RENTAL OR OTHER CONDITIONS, PRIOR SALE, LEASE OR FINANCING, OR WITHDRAWAL WITHOUT NOTICE, AND OF ANY SPECIAL LISTING CONDITIONS IMPOSED BY OUR PRINCIPALS NO WARRANTIES OR REPRESENTATIONS ARE MADE AS TO THE CONDITION OF THE PROPERTY OR ANY HAZARDS CONTAINED THEREIN ARE ANY TO BE IMPLIED.

NAI Mertz

COMMERCIAL REAL ESTATE SERVICES, WORLDWIDE