

3900 S. ASHLAND AVENUE CHICAGO, IL



AVAILABLE

LOCATED AT THE INTERSECTION OF W. PERSHING ROAD AND S. ASHLAND AVENUE

ANTHONY CIARAVINO
+1 312 424 8193
anthony.ciaravino@cushwake.com

CHRIS BOBOWSKI
+1 312 424 8066
chris.bobowski@cushwake.com



**CUSHMAN &
WAKEFIELD**

PROPERTY FEATURES

SIZE

19,200 SF

TERM

10 YEAR TERM

DELIVERY

JULY 1ST, 2023
DO NOT DISTURB TENANT

LOCATION

Strategically located between the neighborhoods of Bridgeport, McKinley Park, Canaryville and Bronzeville on Chicago's South Side. The area is home to a mix of residential, commercial and industrial areas and is home to Guaranteed Rate Field.

PROPERTY INFORMATION

Large entertainment space located adjacent to 90,000 SF Indoor Soccer Facility. The space has minimum ceiling height of 18', allowing for a range of uses including restaurant, brewery, family and corporate entertainment or event space. The space has the ability to obtain expansive Food & Liquor licenses.

NEIGHBORING RETAIL TENANTS

Mariano's, Antique Taco Bridgeport, Marz Community Brewing Co., Ramova Theatre Redevelopment, Zhou B Art Center, Guaranteed Rate Stadium (home of the Chicago White Sox) & more

NEIGHBORHOOD DEMOGRAPHICS

	1 mile	2 miles	3 miles
Population	23,335	139,741	344,120
Households	8,166	47,433	121,798
Median Income	\$52,701	\$49,007	\$45,916
Daytime Population	25,945	119,393	293,759

3900 S. ASHLAND AVENUE
CHICAGO, IL

ANTHONY CIARAVINO
+1 312 424 8193
anthony.ciaravino@cushwake.com

CHRIS BOBOWSKI
+1 312 424 8066
chris.bobowski@cushwake.com



PROPERTY FLOORPLAN

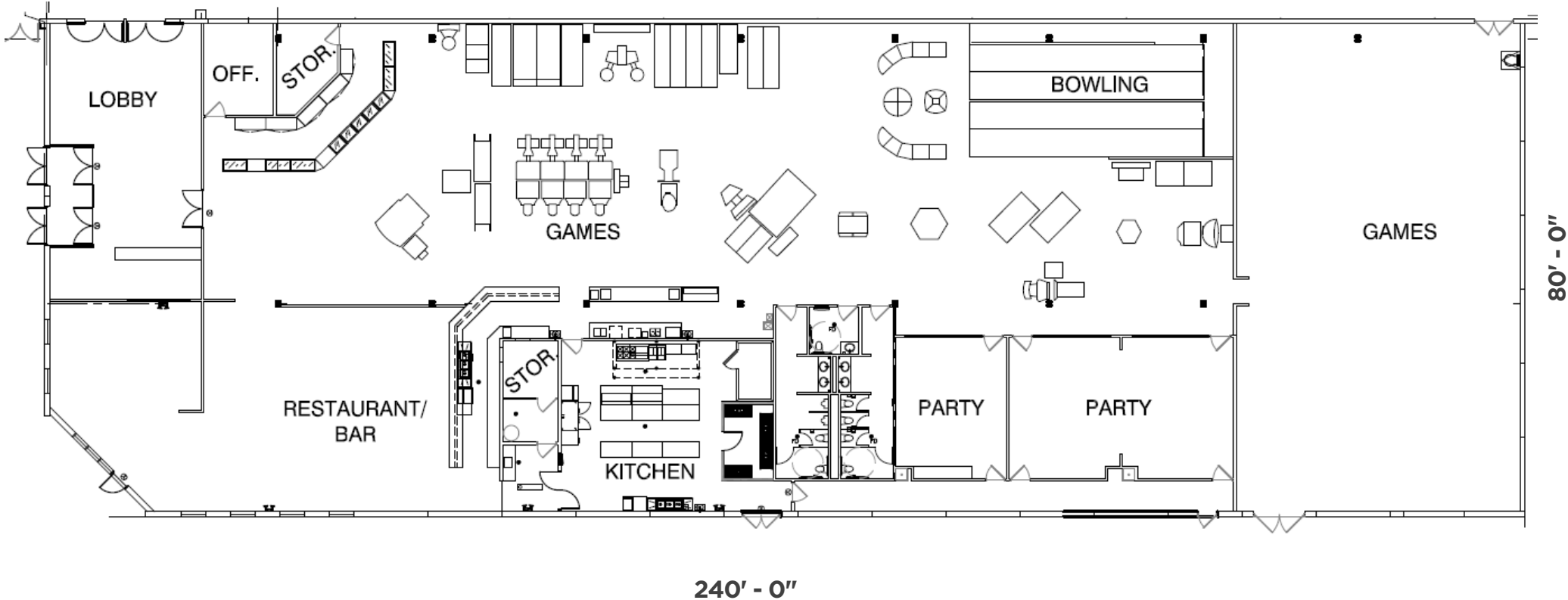

**3900 S. ASHLAND AVENUE
CHICAGO, IL**

ANTHONY CIARAVINO
+1 312 424 8193
anthony.ciaravino@cushwake.com

CHRIS BOBOWSKI
+1 312 424 8066
chris.bobowski@cushwake.com

LOCATION & AMENITIES

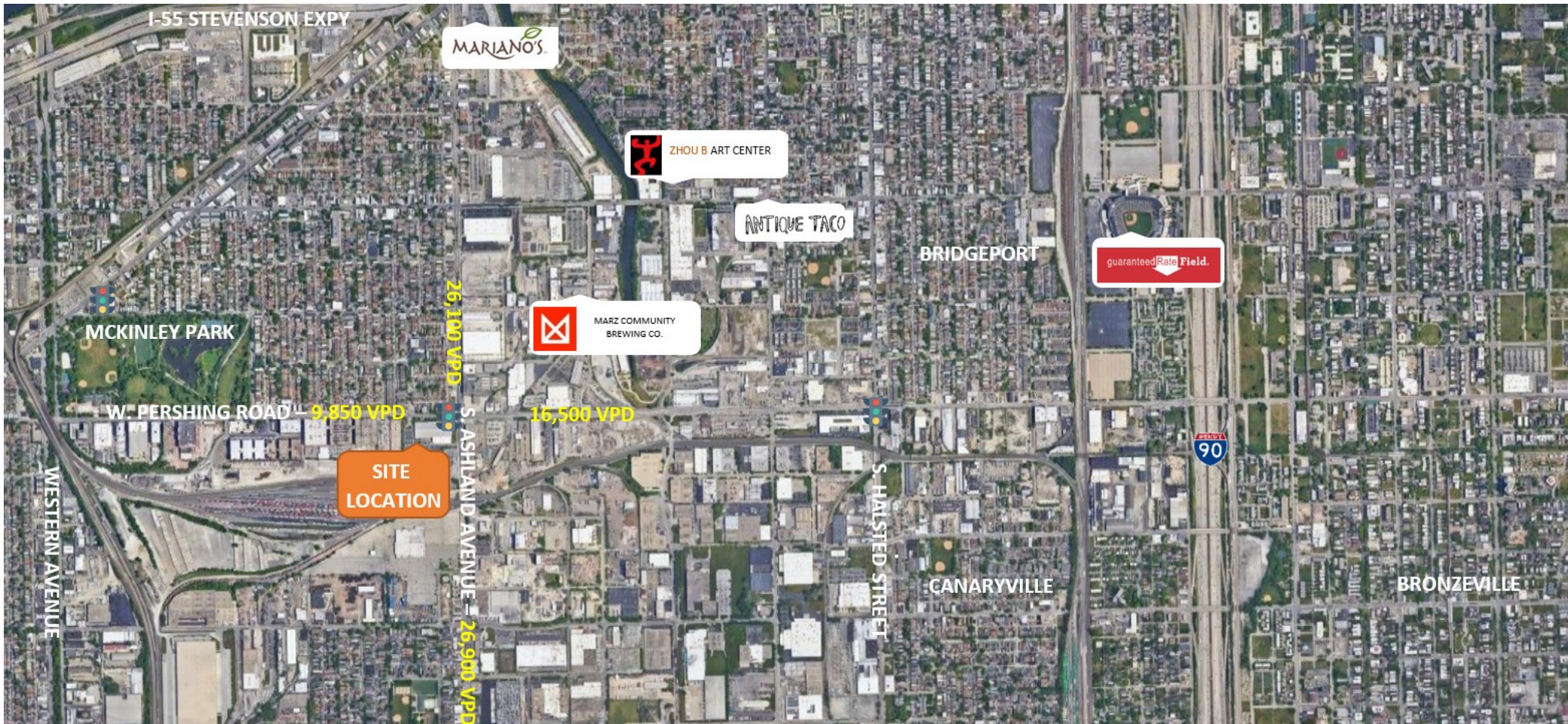

ANTHONY CIARAVINO
+1 312 424 8193
anthony.ciaravino@cushwake.com

CHRIS BOBOWSKI
+1 312 424 8066
chris.bobowski@cushwake.com