

4111 & 4125 DIVISION AVENUE S  
WYOMING, MICHIGAN

BUSINESS FOR SALE  
2,100 Square Feet Available



**SIGNATURE  
ASSOCIATES**  
KNOW SIGNATURE | KNOW RESULTS

**KARS MOTORS**

**PRICE REDUCED**



## PROPERTY FEATURES

- Business with real estate for sale
- 2,100 square feet available
- Corner location with 0.63 acres
- Zoned FBC-CG
- Sale Price: ~~\$734,999~~ \$675,000

**Comments:** First time on market; this coveted and grandfathered auto-dealership is available for purchase. Located along busy Division Avenue, this purchase comes with two (2) lots, full turn-key business with grandfathered license and over 200' of frontage. Site has multiple curb-cuts. Business has shown continued and steady growth. Partnership is looking to retire.

**Do not approach the employees or customers.**

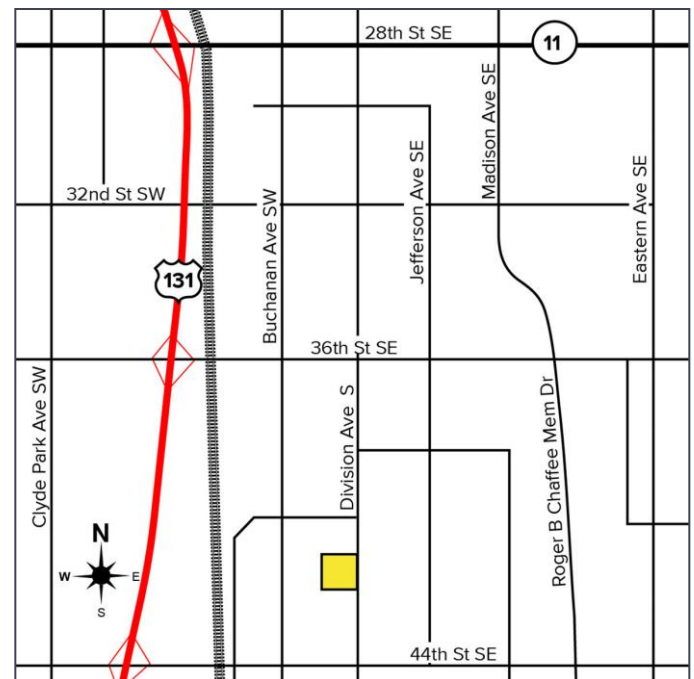

For more information, please contact:

**JOE RIZQALLAH**  
(616) 822 6310  
jrizzqallah@signatureassociates.com

**PETER CACHEY**  
(616) 259 6386  
pcachey@signatureassociates.com

**SIGNATURE ASSOCIATES**  
1188 East Paris Ave SE, Suite 220  
Grand Rapids, MI 49546  
www.signatureassociates.com

# 4111 & 4125 Division Ave S – Wyoming, Michigan

## Business for Sale

2,100  
Square Feet  
AVAILABLE

### Site Plan

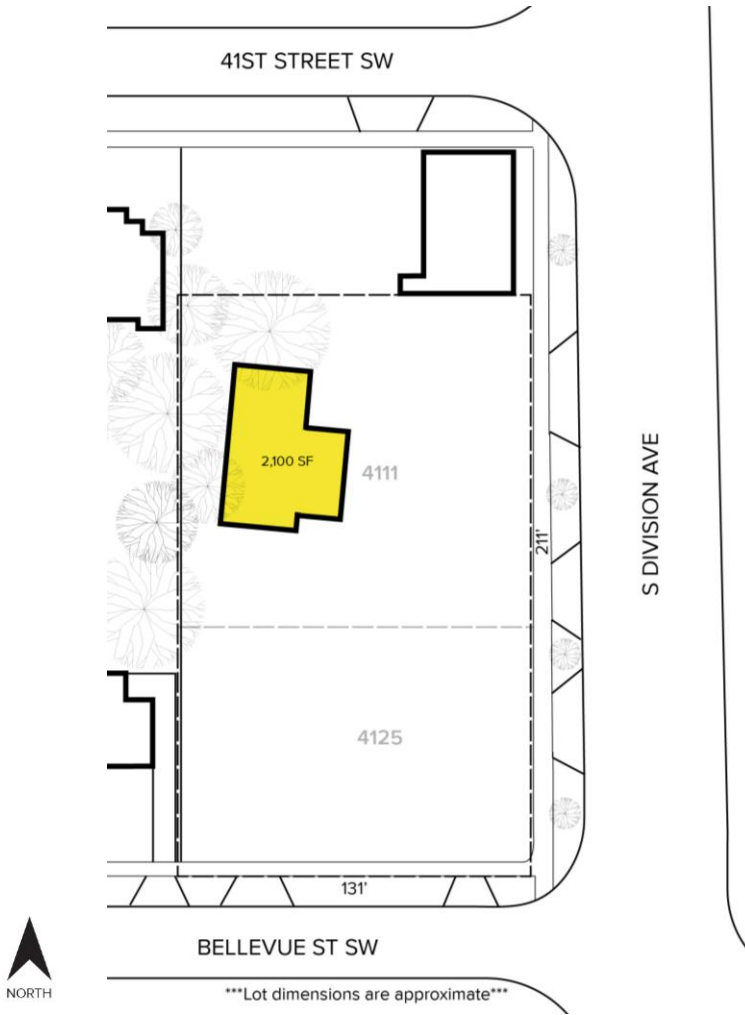

### Additional Photos



For more information, please contact:

**JOE RIZQALLAH**  
(616) 822 6310  
jrizzqallah@signatureassociates.com

**PETER CACHEY**  
(616) 259 6386  
pcachey@signatureassociates.com

**SIGNATURE ASSOCIATES**  
1188 East Paris Ave SE, Suite 220  
Grand Rapids, MI 49546  
www.signatureassociates.com

# 4111 & 4125 Division Ave S – Wyoming, Michigan

## Business for Sale

2,100  
Square Feet  
AVAILABLE

Aerial



DEMOGRAPHICS		
	POPULATION	MED. HH INCOME
1 MILE	9,082	\$62,116
3 MILE	111,506	\$67,351
5 MILE	264,329	\$75,350

TRAFFIC COUNTS (TWO-WAY)	
16,360	Division St. north of 44th St.
18,364	Division St. south of 44th St.
24,890	44th St. east of Division St.
28,690	44th St. west of Division St.

For more information, please contact:

**JOE RIZQALLAH**  
(616) 822 6310  
jrizzqallah@signatureassociates.com

**PETER CACHEY**  
(616) 259 6386  
pcachey@signatureassociates.com

**SIGNATURE ASSOCIATES**  
1188 East Paris Ave SE, Suite 220  
Grand Rapids, MI 49546  
www.signatureassociates.com