

INVESTMENT OR OWNER/USER OPPORTUNITY
40200 GRAND RIVER AVE
NOVI, MICHIGAN

Interim
HEALTHCARE.



PROPERTY INFORMATION

40200 Grand River Ave

10,200 SF FLEX/OFFICE FOR SALE

40200 Grand River is currently occupied by the existing ownership. Owners will consider a sale-leaseback, or can vacant upon a sale.

PROPERTY HIGHLIGHTS

- Convenient location I-275, I-96, and M5
- Clean and professional corporate image
- Zoned I-1: Light Industrial District
- One (1) overhead door; 2,500 SF of warehouse space

Address	40200 Grand River Ave Novi, MI 48375
Total Building Square Footage	10,200 SF (7,700 SF Office/ 2,500 SF Warehouse)
Total Floors	1
Parking	Shared with adjacent buildings and tenants
Zoning	I-1: Light Industrial District
Year Built	1997
2022 Taxes	\$12,931
Asking Price	\$1,350,000

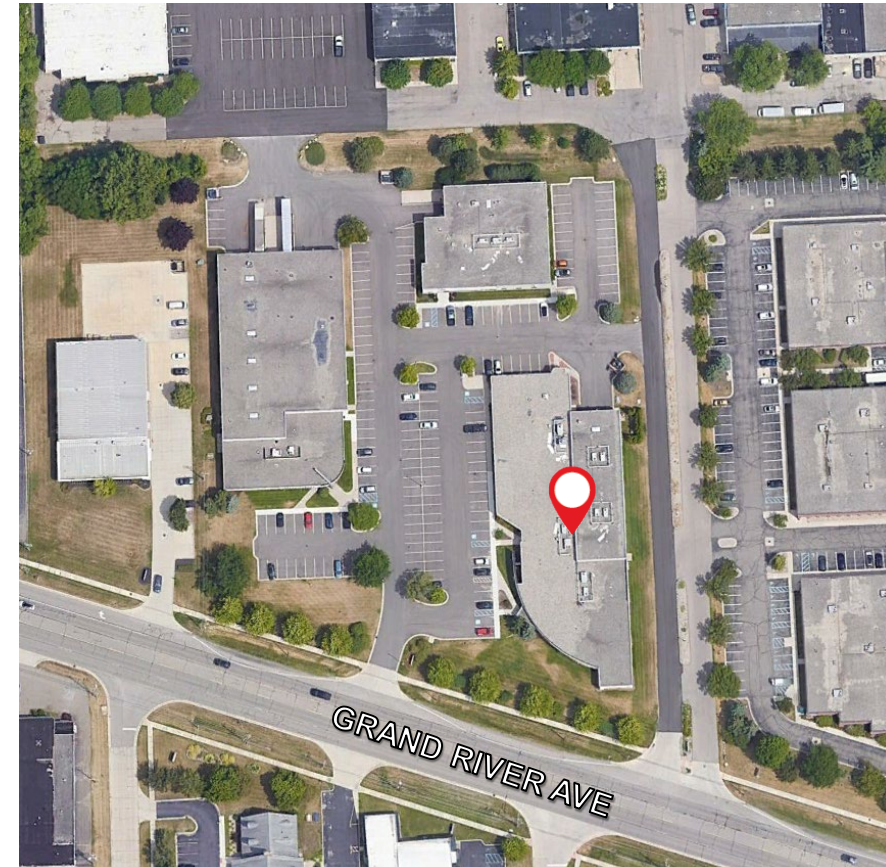

TRAFFIC COUNTS	
Intersection	Cars Per Day
Grand River Ave & Olde Orchard St E	17,650
Grand River Ave & Bashian Dr E	15,434
Grand River Ave & Olde Orchard St W	16,141

FLOORPLAN

40200 Grand River Ave

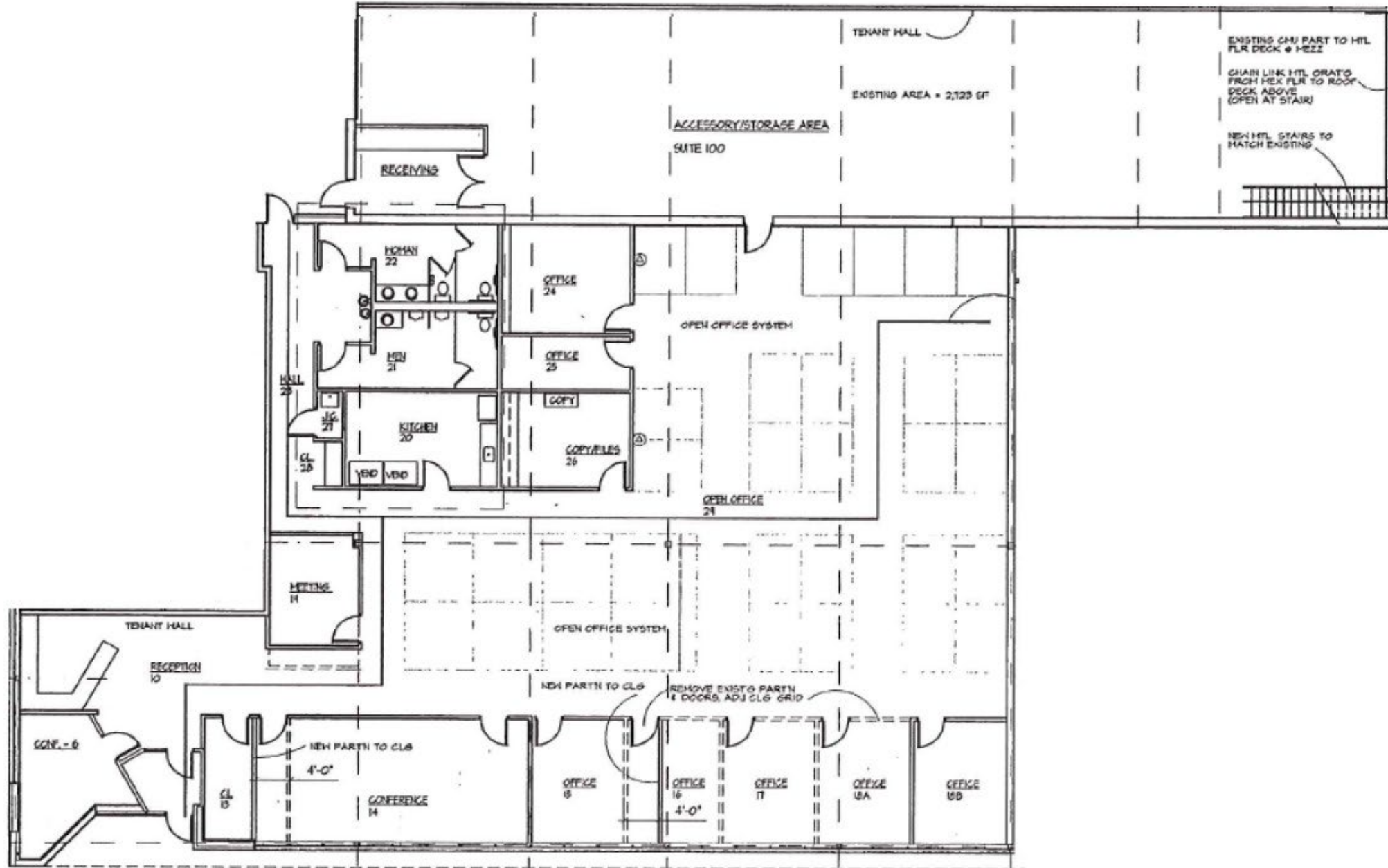

LOCATION AERIAL

40200 Grand River Ave



PHOTOS

40200 Grand River Ave



40200 GRAND RIVER AVE

NOVI, MICHIGAN



GARRETT KEAIS, SIOR
EXECUTIVE MANAGING DIRECTOR
+1 248 358 6112
garrett.keais@cushwake.com

JOHN VANNOORD
SENIOR ASSOCIATE
+1 248 358 6106
john.vannoord@cushwake.com

©2023 Cushman & Wakefield. All rights reserved. The material in this presentation has been prepared solely for information purposes, and is strictly confidential. Any disclosure, use, copying or circulation of this presentation (or the information contained within it) is strictly prohibited, unless you have obtained Cushman & Wakefield's prior written consent. The views expressed in this presentation are the views of the author and do not necessarily reflect the views of Cushman & Wakefield. Neither this presentation nor any part of it shall form the basis of, or be relied upon in connection with any offer, or act as an inducement to enter into any contract or commitment whatsoever. NO REPRESENTATION OR WARRANTY IS GIVEN, EXPRESS OR IMPLIED, AS TO THE ACCURACY OF THE INFORMATION CONTAINED WITHIN THIS PRESENTATION, AND CUSHMAN & WAKEFIELD IS UNDER NO OBLIGATION TO SUBSEQUENTLY CORRECT IT IN THE EVENT OF ERRORS.