



# 16,000 SF AVAILABLE

2575 Cobb International Boulevard  
Suites B & C  
Kennesaw, GA 30152

## FOR LEASE



### PROPERTY INFORMATION

<b>Total Size:</b>	16,000 SF
<b>Office:</b>	3,390 SF
<b>Warehouse:</b>	12,160
<b>Clear Height:</b>	20'
<b>Loading:</b>	Five (5) Dock High Doors
<b>Available:</b>	One (1) Oversized Drive-In Door
<b>Location:</b>	Immediately +/- 3.0 miles from I-75 +/- 14.0 miles from I-285 +/- 23.5 miles from I-20 +/- 40 miles from Atlanta Airport

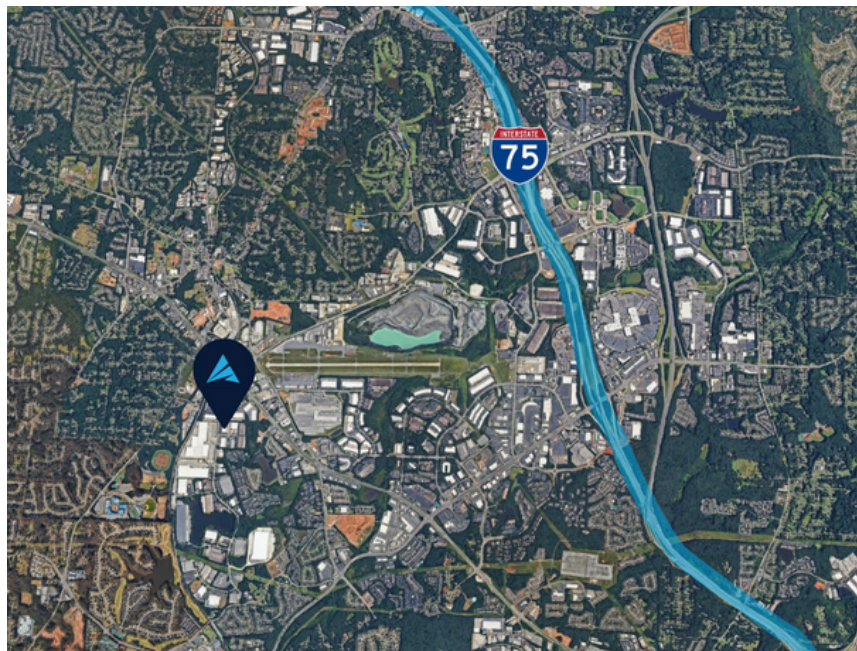

**APEX INDUSTRIAL**  
REAL ESTATE ADVISORS

3500 Lenox Road NE | Suite 1275 | Atlanta, GA 30326 | [apexindustrialre.com](http://apexindustrialre.com)

For more information, please contact:

**ANDY HEAD**

Office: (404) 595-1466  
Cell: (404) 713-4601  
[ahead@apexindustrialre.com](mailto:ahead@apexindustrialre.com)

Although the information contained therein was provided from sources believed to be reliable, Apex Industrial makes no representation, expressed or implied, as to its accuracy and said information is subject to errors, omissions or changes.



# 16,000 SF AVAILABLE

2575 Cobb International Boulevard  
Suites B & C  
Kennesaw, GA 30152

## FLOOR PLAN

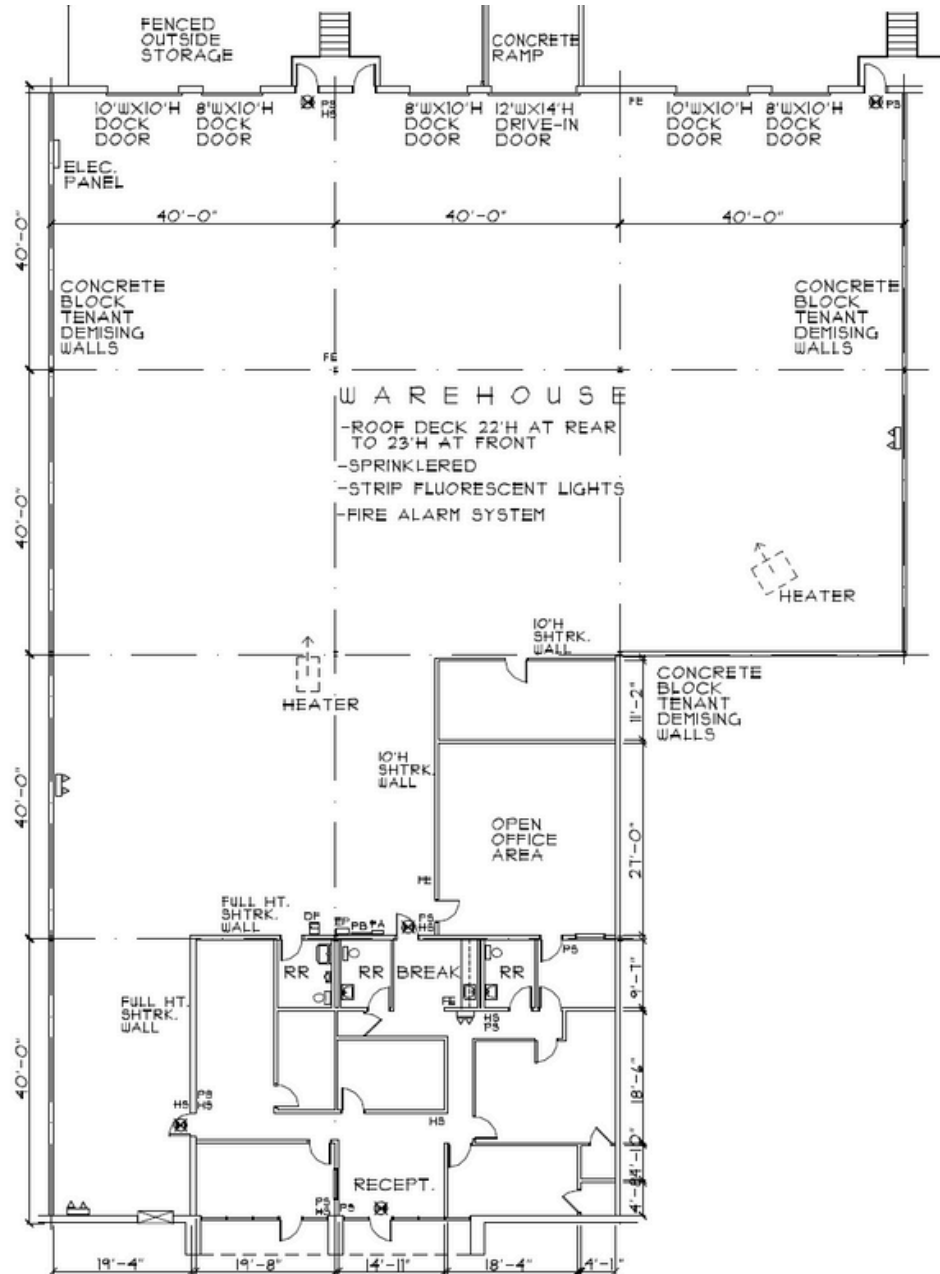

**APEX INDUSTRIAL**  
REAL ESTATE ADVISORS

3500 Lenox Road NE | Suite 1275 | Atlanta, GA 30326 | [apexindustrialre.com](http://apexindustrialre.com)

For more information, please contact:

**ANDY HEAD**

Office: (404) 595-1466  
Cell: (404) 713-4601  
[ahead@apexindustrialre.com](mailto:ahead@apexindustrialre.com)