

# For Lease

# OFFICE/WAREHOUSE

FOR LEASE  
ANKENY, IOWA

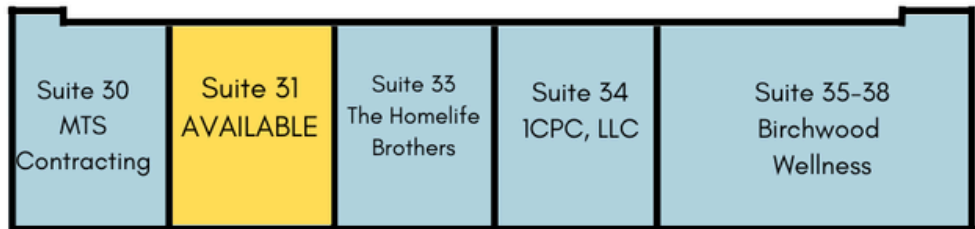

Woodside Business Park  
Building 3  
6950 NE 14th St  
Ankeny, Iowa 50023

- Suite 31 Available
- 3,000 Total SF @ \$10.00 PSF/NNN  
1,300 Office  
1,700 Warehouse
- 1 Drive-In Door
- 2.5 Miles North of I-80
- 2 Miles West of I-35
- 9 Multi-Tenant Office/Warehouse Buildings in Park
- Zoned Light Business
- Located in Polk County
- Clear Ceiling Height of 16' to 18'



 [dennyelwellcompany.com](http://dennyelwellcompany.com)  
515-964-1587

Darcy Gill  
515.238.5793

[DGill@DennyElwellCompany.com](mailto:DGill@DennyElwellCompany.com)

# For Lease

## Suite 31

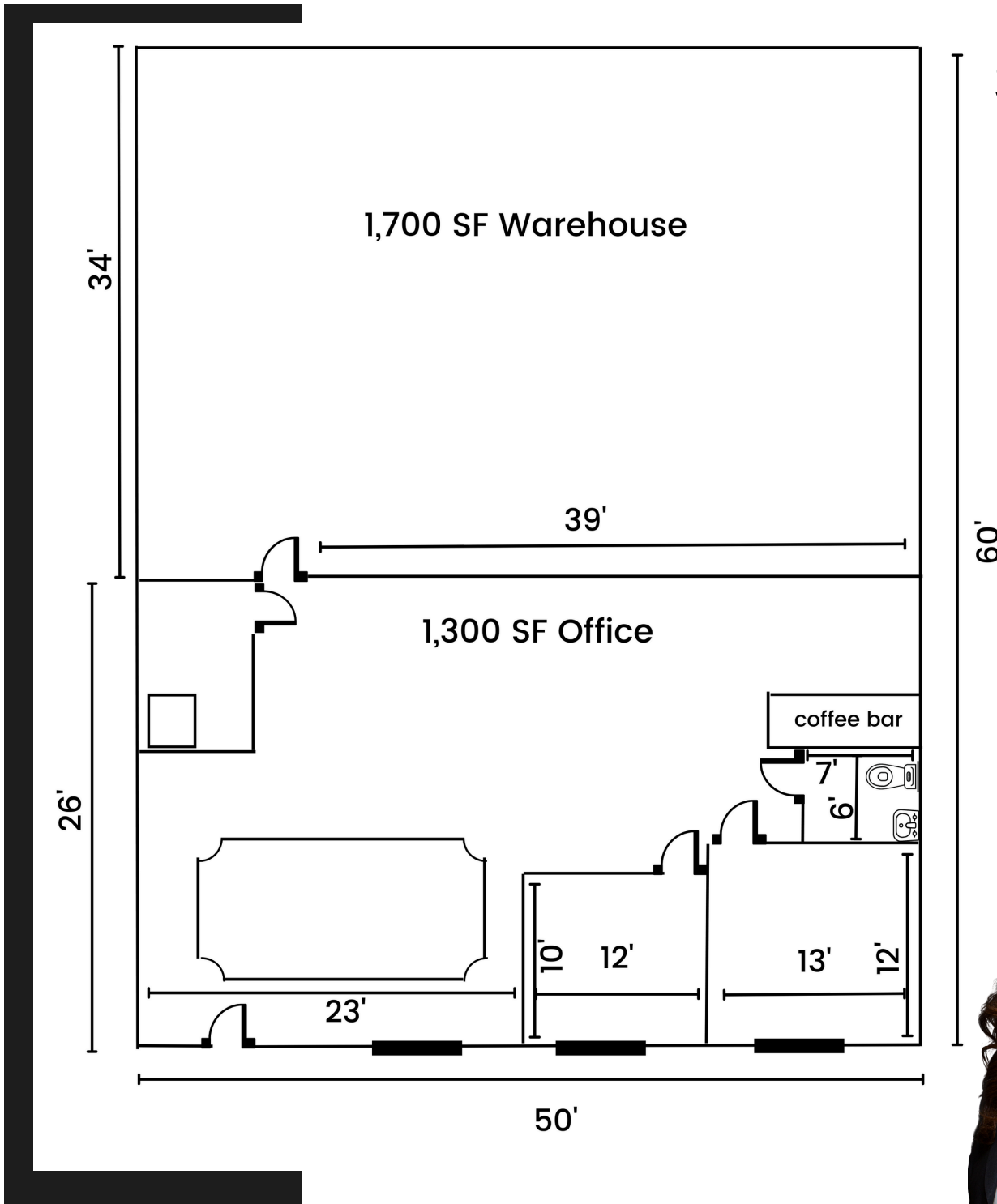

2401 SE Tones Dr Suite 17 Ankeny, Iowa 50021

515.964.1587

[DennyElwellCompany.com](http://DennyElwellCompany.com)

Darcy Gill  
[DGill@DennyElwellCompany.com](mailto:DGill@DennyElwellCompany.com)

515.238.5793



The information contained herein is deemed reliable but not guaranteed by Denny Elwell Company  
Licensed to sell real estate in the state of Iowa