

For Lease

1754 & 1773 BUILDTEK COURT

Las Cruces, New Mexico



Lease Rate: For More Information, Contact Broker

1754 Buildtek Ct

Las Cruces, NM 88005

Property Features

- Space available from 2,000-10,000 sq. ft.
- 20' Clear Ceiling Height
- Sprinkler Fire Suppression System
- 3 Phase 480
- Ample off-street parking
- Two (2) miles to Interstate 10 access
- Pre-cast concrete tilt-up construction
- Roll-up overhead doors: 9' x 12' , 14' x 14' , 20' x 14'
- New TPO roof



AVAILABLE SF: 2,000 - 10,000 SF

LEASE RATE: \$5.75 psf NNN

ESTIMATED INSURANCE: \$0.18 ± psf

ESTIMATED TAXES: \$0.36 ± psf

For more information:

Jacob Slavec

575 521 1535 • jacob@1stvalley.com

Randy McMillan, CCIM, SIOR

575 521 1535 • randy@1stvalley.com

For Lease

1754 & 1773 BUILDTEK COURT

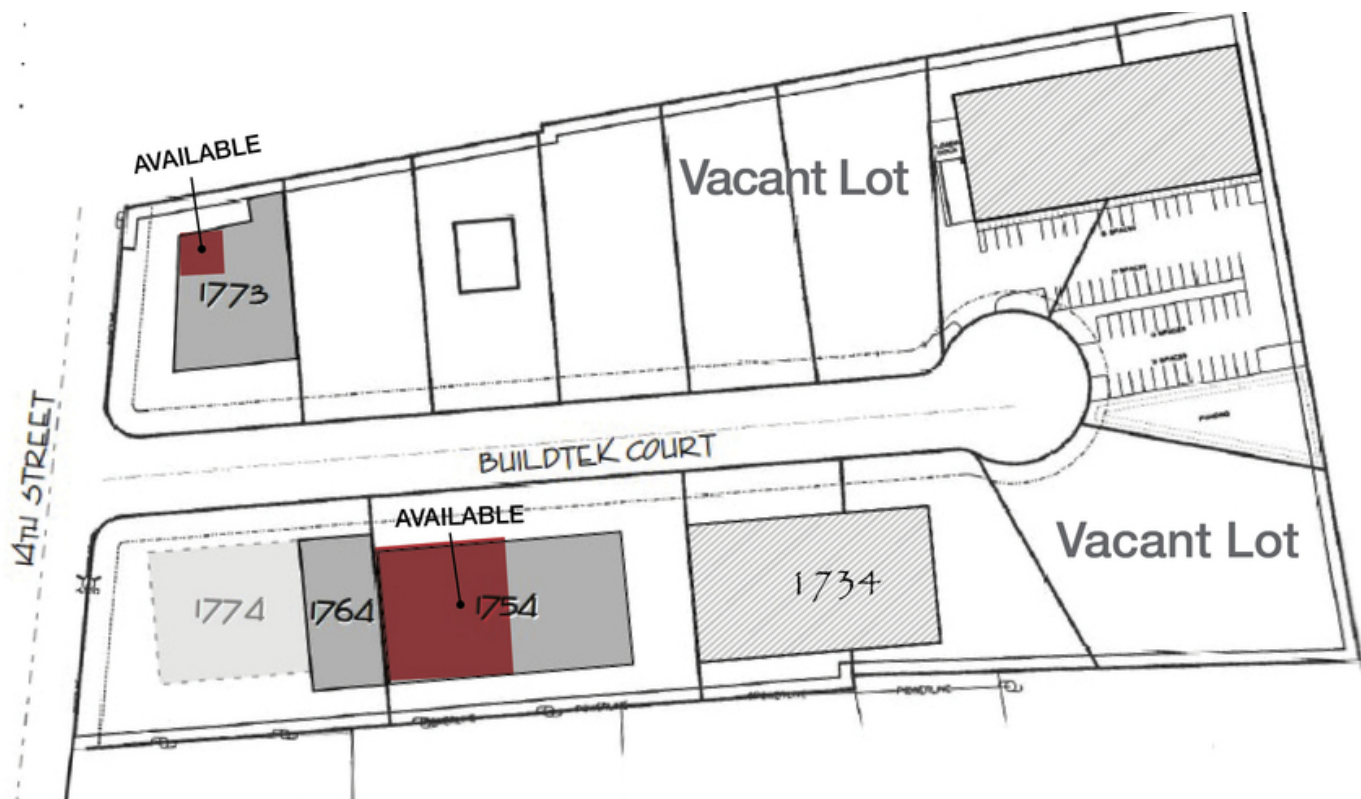

1773
Approx.
2,000 ± sf

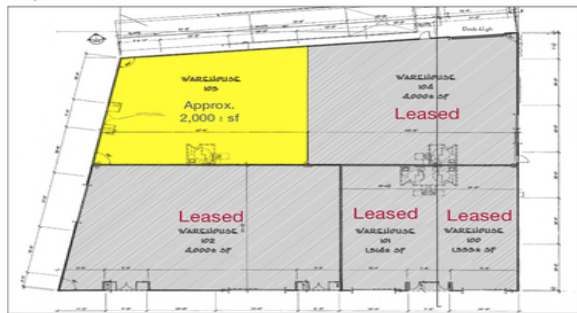

BUILDTEK COURT 1734



1734
19,500 ± sf

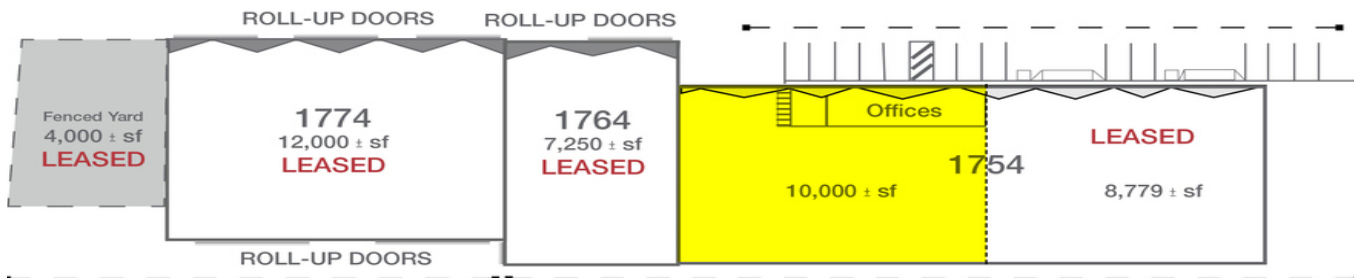

ROLL-UP DOORS ROLL-UP DOORS

Fenced Yard
4,000 ± sf
LEASED

1774
12,000 ± sf
LEASED

1764
7,250 ± sf
LEASED

Offices
10,000 ± sf

1754

LEASED
8,779 ± sf

ROLL-UP DOORS

For Lease

1754 & 1773 BUILDTEK COURT



**Office / Showroom
Reception Area**

For Lease

1754 & 1773 BUILDTEK COURT

