 **JLL** SEE A BRIGHTER WAY

For lease

1429 Hildale Avenue
Haverhill, MA

Property Overview

Building Size: 24,688 SF

Site Size: 4.99 AC

Site Coverage: 11.1%

Year Built: 2001

No. of Buildings: One

% WH / Office: 63% / 37%

No. of Stories: Two (4,510 SF on
2nd Floor)

Parking: 80 Spaces (3.30/1,000 SF)

Clear Height: 18'

Column Spacing: 25' x 40'

Fire Protection: Wet System

Power: 1,600A, 277/480V, 3P

Loading: One (1) tailboard loading
dock, One (1) drive-in door

HVAC: Property is serviced by ten (10)
large roof-mounted units



Floorplan

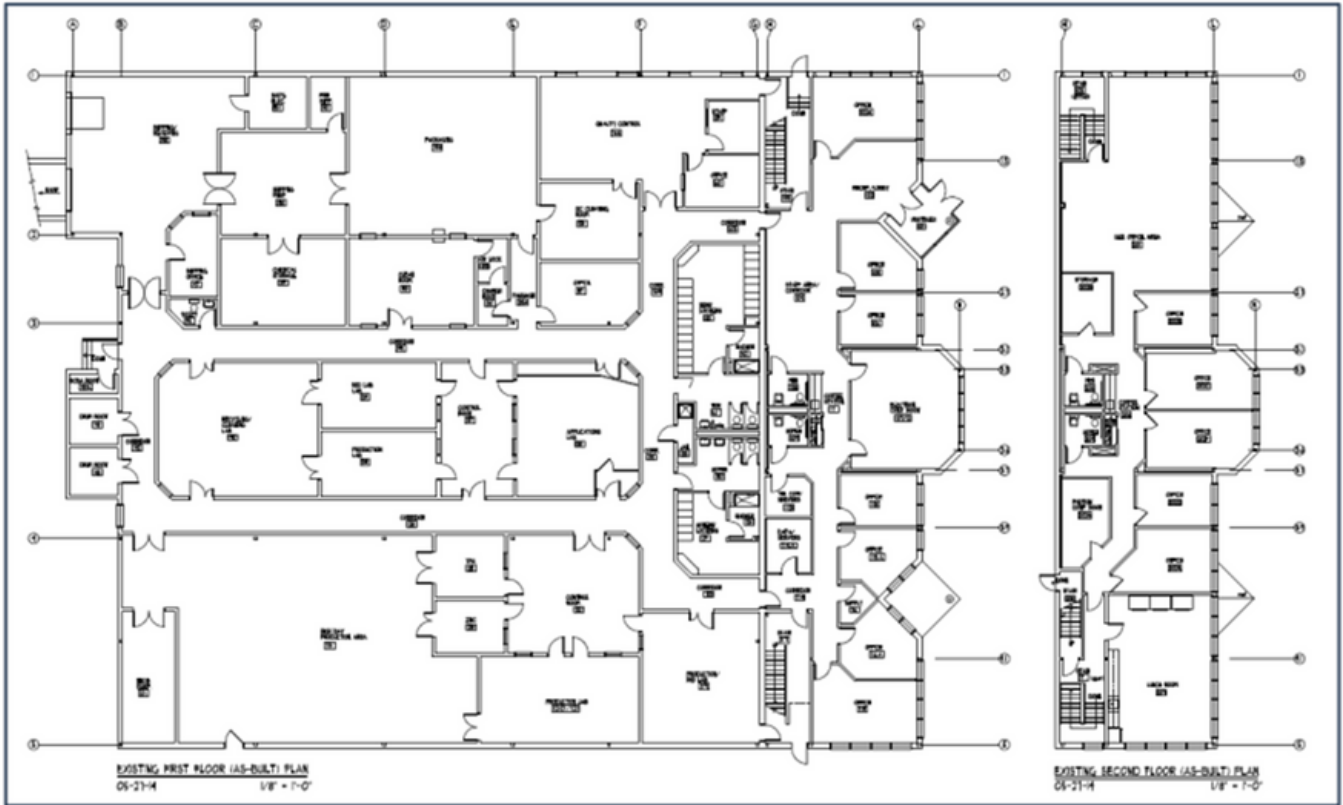

Exterior



Brian Tisbert
Managing Director
Brian.Tisbert@jll.com
+1 978 273 6379

Hannah Kiernan
Associate
Hannah.Kiernan@jll.com
+1 978 473 3885