



FOR LEASE

AVAILABILITIES

7170 RIVERWOOD DRIVE | 8,187 SF - 18,608 SF

AMENITIES

- » Conveniently located at the intersection of Route 29 and Route 32
- » High-end cafe with collaborative dining space, fitness center with showers, and a conference center/multi-function space with mobile furniture and catering kitchen
- » Individually controlled HVAC
- » On-site property management by Corporate office Properties Trust



DAN CALLIHAN
Executive Managing Director
dan.callihan@nmrk.com
410.625.4213

JAMES CUMBER
Associate Director
james.cumber@nmrk.com
410.625.4203

NEWMARK

AVAILABILITIES

7170 RIVERWOOD DRIVE | 8,187 SF - 18,608 SF

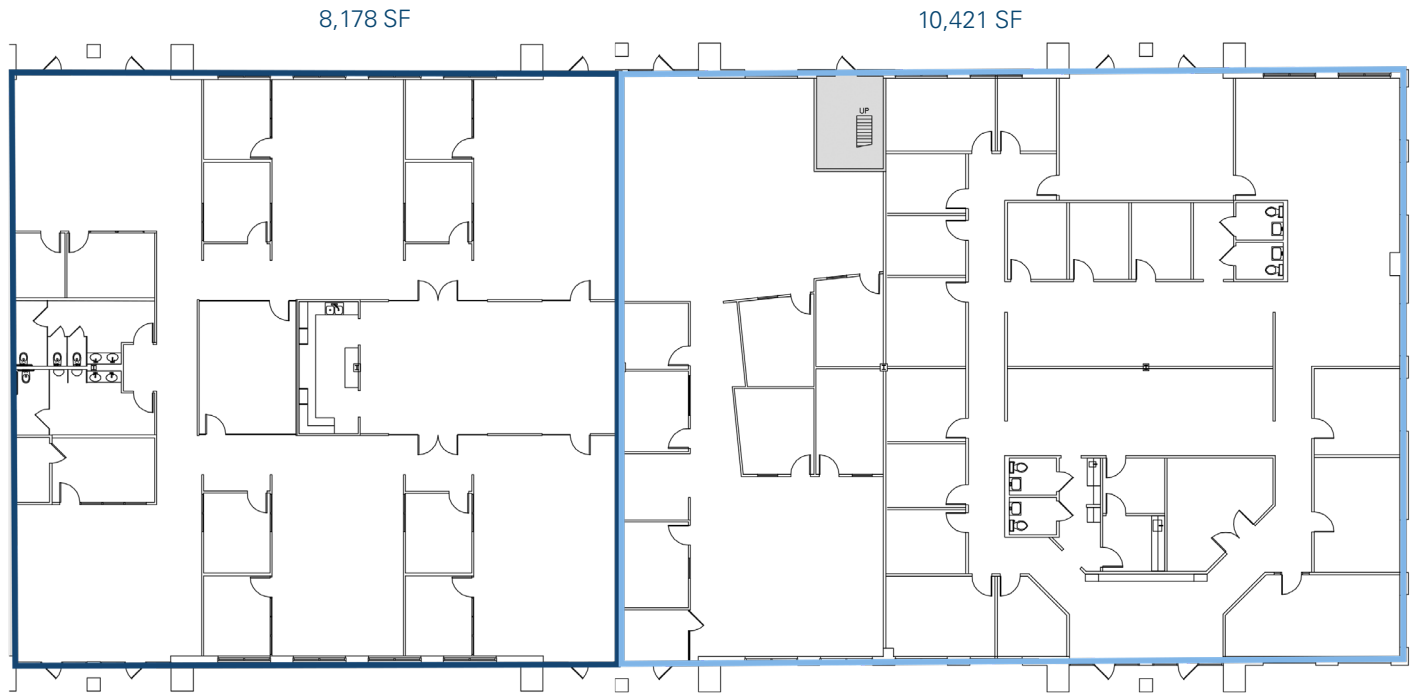

DAN CALLIHAN
Executive Managing Director
dan.callihan@nrmk.com
410.625.4213

JAMES CUMBER
Associate Director
james.cumber@nrmk.com
410.625.4203

NEWMARK