

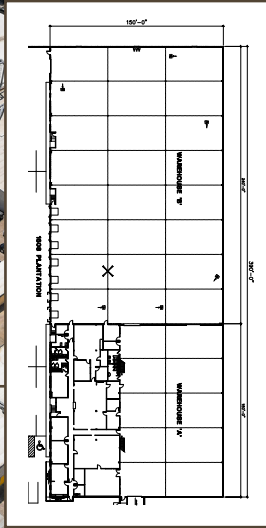

JASON MOSER | 214.244.6144 | JMOSER@STREAMREALTY.COM

GIOVANNI SCARDINO | 847.612.8488 | GIOVANNI.SCARDINO@STREAMREALTY.COM



1608 PLANTATION RD

- 67,575 sf bldg. (tilt wall)
- 111,997 sf land
- 9,075 sf office
- 130' truck court
- 7 dock high loading doors with dock levelers
- 1 oversized grade level door
- 21' clear height
- 240W High Bay LEDs in warehouse
- Exhaust fans
- Fire sprinkler
- Column spacing 30'x51'
- YOC 1988
- Heavy power
- 400 amp, 277/408V, 3-phase
- Sprinklered
- Fenced/gated lot
- 102 car parks (with space for more)
- LED lights



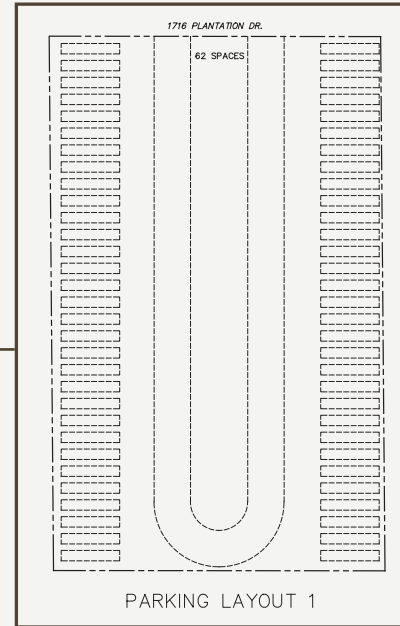

1716 PLANTATION RD

- Additional land / no buildings
- 2.414 acres (105,175 sf) of land
- Fenced and gated
- Improved with hard packed road base
- Great yard for outside storage
- 62 Trailer Park Positions
- New lights added
- 600 amp, 3-phase switch board with 120/208V



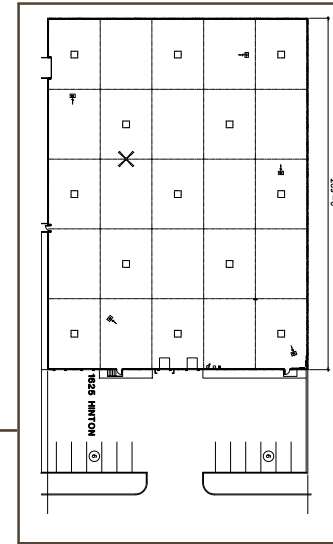

1625 HINTON ST

- 32,340 sf bldg.
- 20' clear height
- Heavy power
- 2 Services: 1200 amp, 3-phase, 277/480V and 200 amp, 3-phase, 120/240V
- Tilt wall construction
- 4 dock high doors
- YOC 1977
- Sprinklered

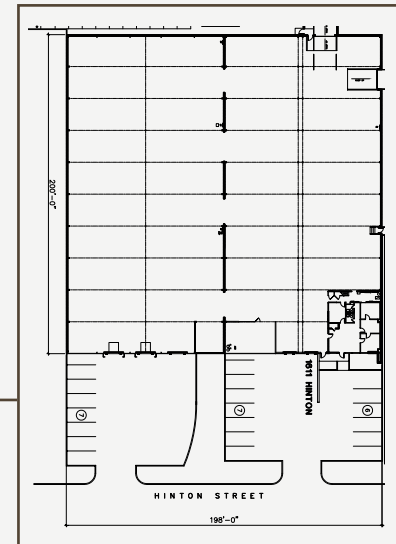

1611-1615 HINTON ST

- 39,600 sf bldg.
- 1,097 sf office
- 14'-21' clear height
- 5 dock high doors
- Heavy power
- 4 Services: each is 400 amp, 3-phase, 120/240V (Total: 1600 amps)
- YOC 1958 / 1966 (west building half)
- Sprinklered

ELECTRICAL PLAN

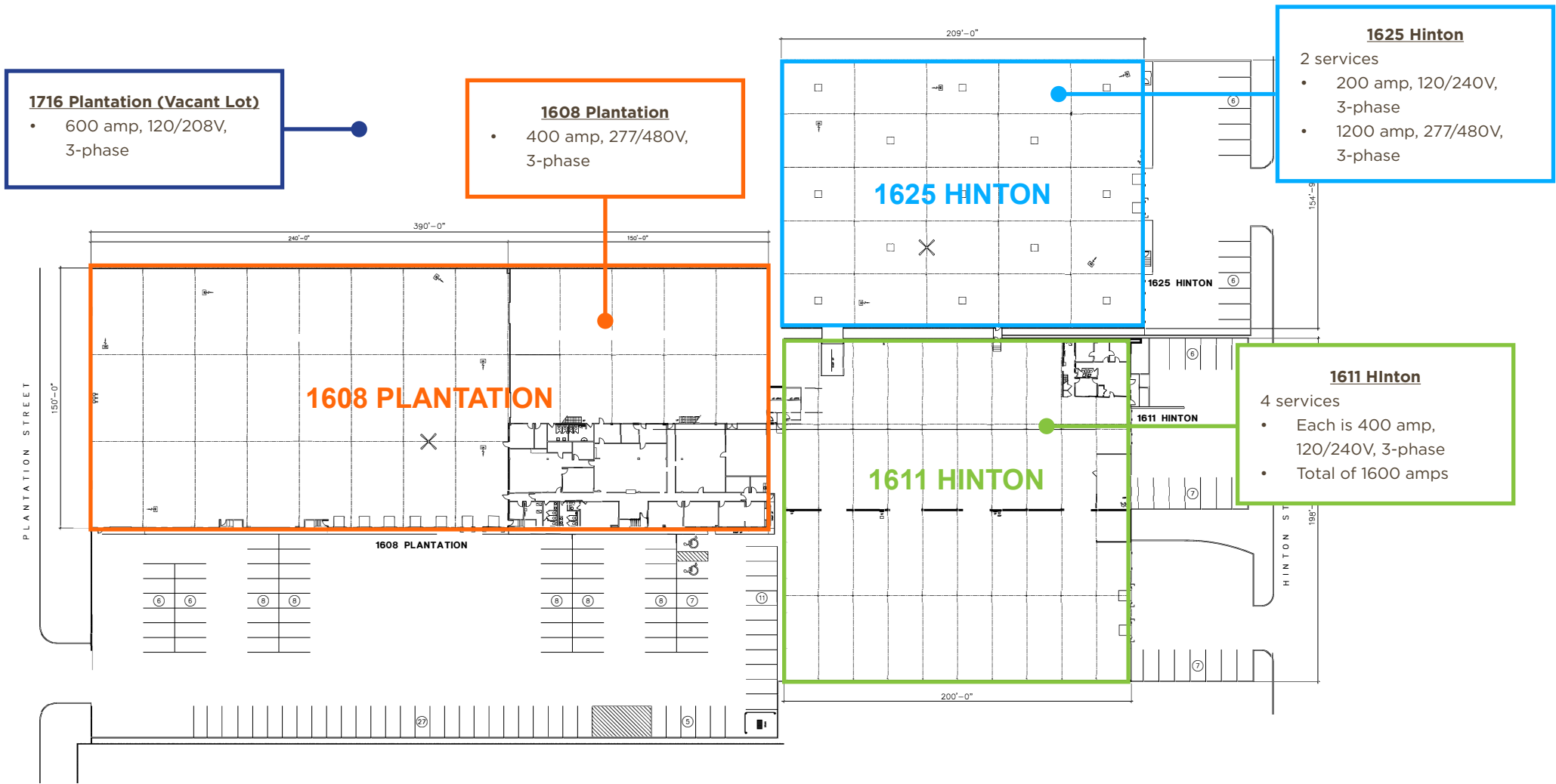

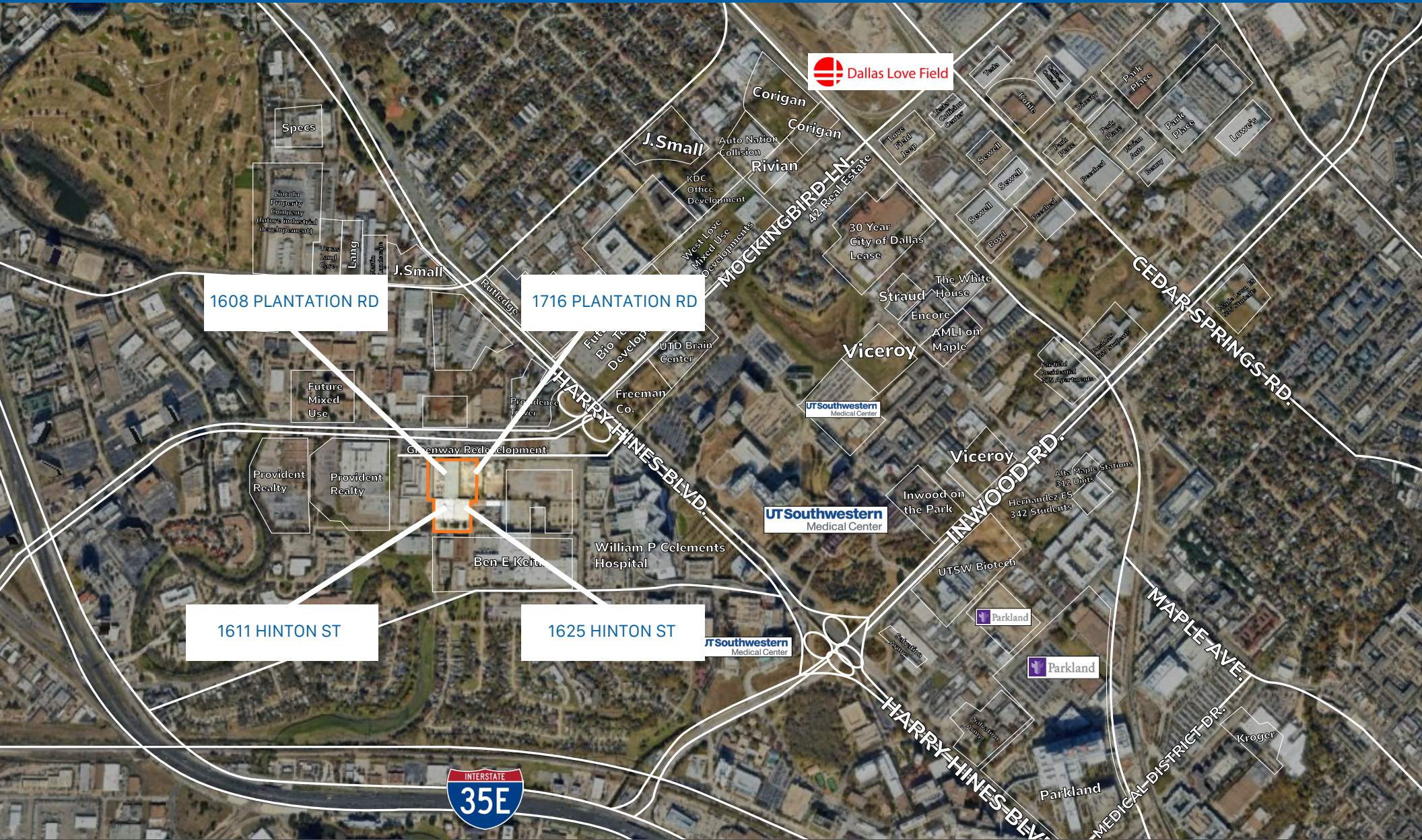

JASON MOSER | 214.267.0451 | J MOSER@STREAMREALTY.COM

GIOVANNI SCARDINO | 847.612.8488 | GIOVANNI.SCARDINO@STREAMREALTY.COM