

D. CARLES

EVANS MILL OFFICE
100 NORTH JONATHAN ST.
SUITE 200
RALLI, GA 30151
CONTACT: TERESA HUNTER
PHONE: 770.426.5000

EVANS MILL
JMC DEVELOPMENT
100 NORTH JONATHAN ST.
SUITE 200
RALLI, GA 30151
CONTACT: TERESA HUNTER
PHONE: 770.426.5000

EVANS MILL
JMC DEVELOPMENT, LLC
100 NORTH JONATHAN ST.
SUITE 200
RALLI, GA 30151
CONTACT: TERESA HUNTER
PHONE: 770.426.5000

GRAPHIC SCALE

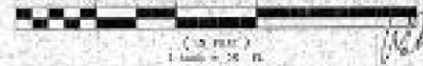

C. R. RILEY & ASSOCIATES
REGISTERED PROFESSIONAL ENGINEER
NO. 10000
PAID UP FEE \$1000.00
EXPIRES 12/31/2010

14/8
100' TYPICAL ROAD WIDTH
EASEMENT

140' LOT LINE

EVANS MILL DRIVE 85' R/W

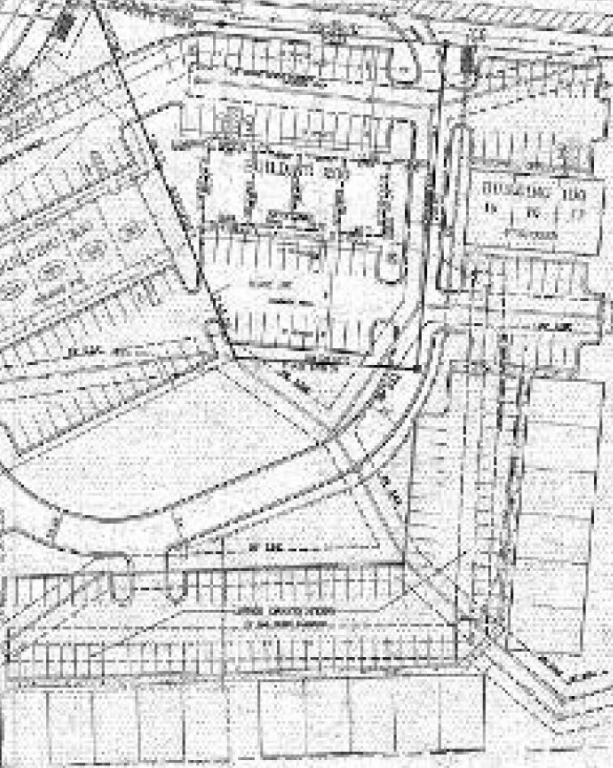

PAULDING COUNTY
DEVELOPMENT DIVISION
(ENGINEERING)
11/11/11 11:29 AM DAT

LINE STYLE

---	SUBMITTAL	BOUNDARY
---	EXISTING	PROPOSED

147' LOT LINE

Handwritten signature: C. Riley

11/11/11



LOCATED IN LOTS 1000 - 300 AND 301
2nd DISTRICT, 2nd SECTION
PAULDING COUNTY, GEORGIA

LOCATION SHEET OF SUBDIVISION
EVANS MILL OFFICE PARK
BUILDING 100 AND 101