

# FOR LEASE

Retail Property For Lease

SPRINGFIELD PLAZA, W. SUNSHINE (BUS 60) & WEST BYPASS (HWY 160) // SPRINGFIELD, MO 65807



## OFFERING SUMMARY

Lease Rate: TBD

Available SF: 5,000 SF & 23,000+/- sf

Taxes, Insurance & CAM est: \$2.90 SF

Building SF: 150,000 SF

## CONTACTS:

Scott F. Harrell & Associates, Inc.  
417-832-0033  
Scott Harrell (x1)

SVN/Rankin Co.  
417-887-8826  
Jeff Childs (X104)  
Tom Rankin (X102)

## PROPERTY OVERVIEW

For Lease - 5,000 sf (between Ulta Beauty & Five Below) and 23,000+/- sf in the Springfield Plaza

## PROPERTY HIGHLIGHTS

- Springfield Plaza is a 150,000 retail center, which opened in the fall of 2017, and is located next to the Walmart Super Center Springfield's MSA Retail Sales approximately \$5.5 Billion. Located in West Springfield near the intersection of W. Sunshine and West Bypass.
- Traffic Counts:  
West Sunshine St. 22,856 vehicles per day  
West Bypass 20,745 vehicles per day
- Access to the Springfield Plaza via 3 signalized intersections: W. Sunshine & Zimmer, W. Sunshine & McCurry and West Bypass (US 160) & W. Seminole
- Located adjacent to the Walmart Super Center
- NNN Expenses - estimated at \$2.90 sf total (Taxes \$1.50 sf, Insurance \$0.40 sf and CAM \$1.00 sf)
- Property Retail & Restaurants include: Ross Dress for Less, Shoe Department /Encore, Petco, Burlington, Five Below, Ulta Beauty, Verizon, Sport Clips, Plaza Tire, Taco Bell, Whataburger, Michaels, McDonald's, Central Bank and BioLife Plasma Center
- Other Area Retailers include: Walmart Super Center, Menards, Discount Tire, Dollar Tree, Cato, GameStop, Cricket, Murphy USA, Casey's, Jiffy Lube & More
- Future Area Retail & Restaurants coming soon: Target, Olive Garden, Wendy's, Chick-Fil-A and Menards Self Storage



## SCOTT F. HARRELL & ASSOCIATES, INC.

Commercial Real Estate Services  
1354 E. Kingsley Suite B, Springfield, MO 65804  
www.scottfharrell.com

## SCOTT HARRELL

Broker-Officer  
417.832.0033  
scott@scottfharrell.com

# SPRINGFIELD PLAZA & LOCATION

Retail Property For Lease

SPRINGFIELD PLAZA, W. SUNSHINE (BUS 60) & WEST BYPASS (HWY 160) // SPRINGFIELD, MO 65807



**SCOTT F. HARRELL & ASSOCIATES, INC.**

Commercial Real Estate Services  
1354 E. Kingsley Suite B, Springfield, MO 65804  
[www.scottfharrell.com](http://www.scottfharrell.com)

**SCOTT HARRELL**

Broker-Officer  
417.832.0033  
[scott@scottfharrell.com](mailto:scott@scottfharrell.com)



## Retail Property For Lease

**SPRINGFIELD PLAZA, W. SUNSHINE (BUS 60) & WEST BYPASS (HWY 160) // SPRINGFIELD, MO 65807**



**SCOTT F. HARRELL & ASSOCIATES, INC.**

Commercial Real Estate Services  
1354 E. Kingsley Suite B, Springfield, MO 65804  
[www.scottfharrell.com](http://www.scottfharrell.com)

**SCOTT HARRELL**

Broker-Officer  
417.832.0033  
scott@scottfharrell.com

# SITE PLAN

Retail Property For Lease

SPRINGFIELD PLAZA, W. SUNSHINE (BUS 60) & WEST BYPASS (HWY 160) // SPRINGFIELD, MO 65807

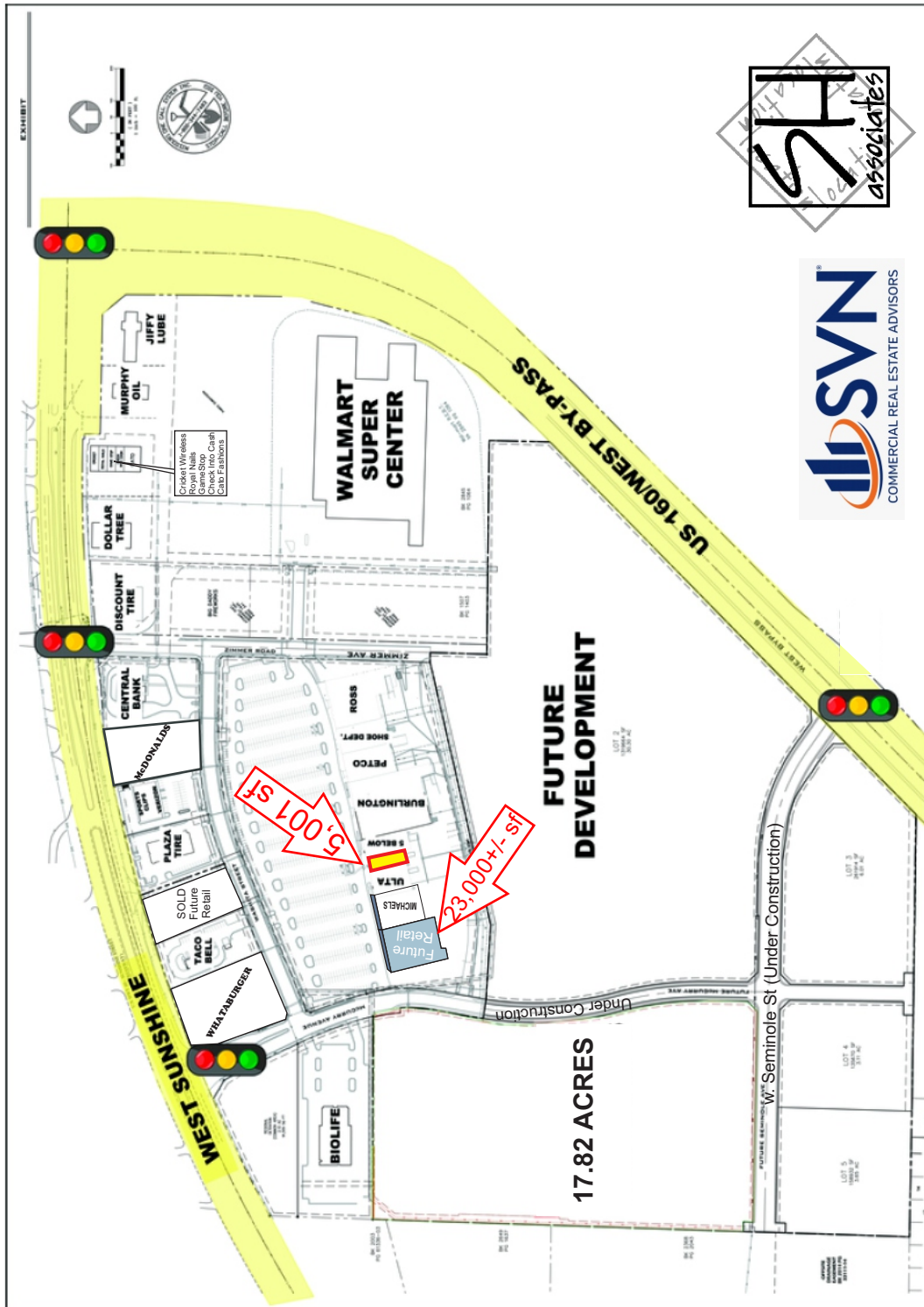

**SCOTT F. HARRELL & ASSOCIATES, INC.**

Commercial Real Estate Services  
1354 E. Kingsley Suite B, Springfield, MO 65804  
[www.scottfharrell.com](http://www.scottfharrell.com)

**SCOTT HARRELL**

Broker-Officer  
417.832.0033  
[scott@scottfharrell.com](mailto:scott@scottfharrell.com)



# ADDITIONAL SITE PLAN

Retail Property For Lease

SPRINGFIELD PLAZA, W. SUNSHINE (BUS 60) & WEST BYPASS (HWY 160) // SPRINGFIELD, MO 65807



**SCOTT F. HARRELL & ASSOCIATES, INC.**

Commercial Real Estate Services  
1354 E. Kingsley Suite B, Springfield, MO 65804  
[www.scottfharrell.com](http://www.scottfharrell.com)

**SCOTT HARRELL**

Broker-Officer  
417.832.0033  
[scott@scottfharrell.com](mailto:scott@scottfharrell.com)

# PREMISE & DEMOGRAPHICS

Retail Property For Lease

SPRINGFIELD PLAZA, W. SUNSHINE (BUS 60) & WEST BYPASS (HWY 160) // SPRINGFIELD, MO 65807

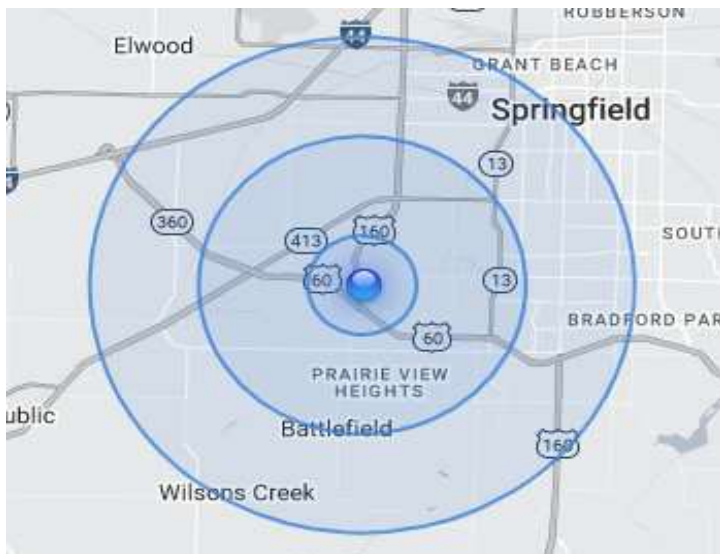
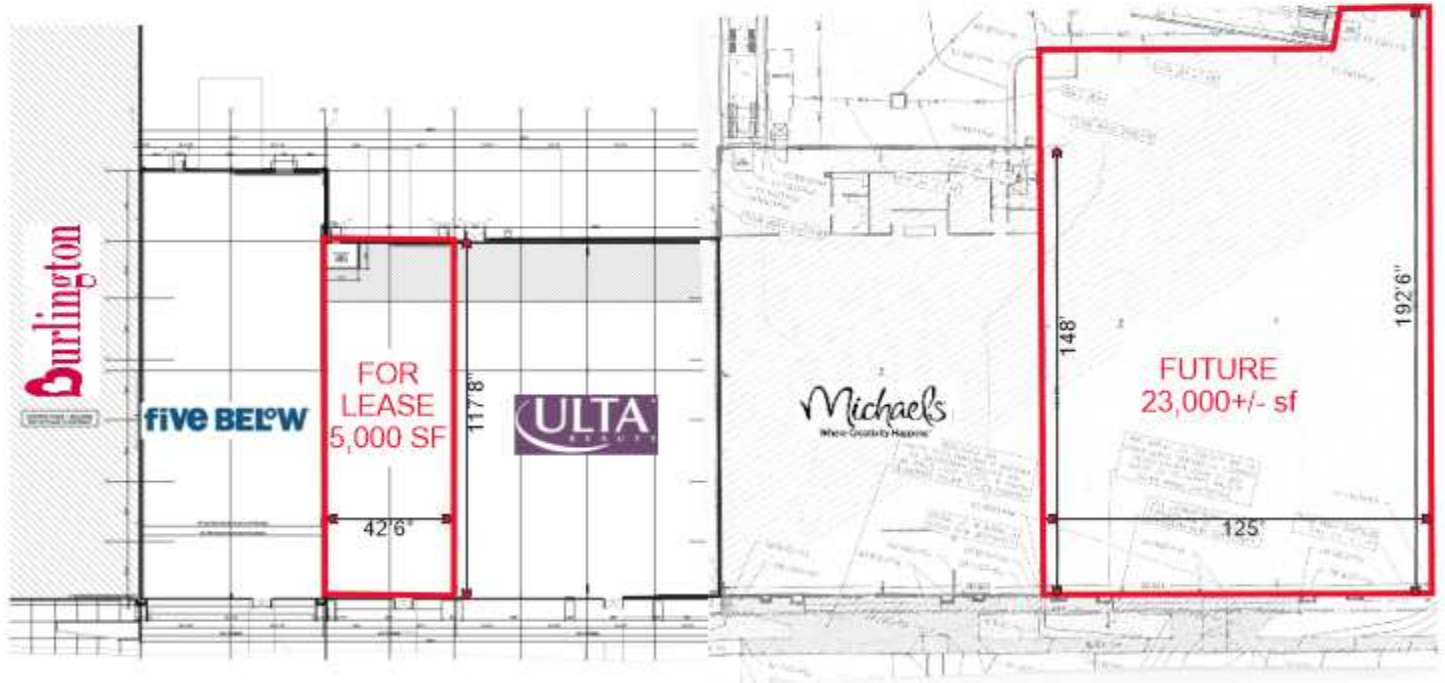

## Demographics

	1 Mile	3 Mile	5 Mile
Population	5,863	46,100	117,117
Avg Household Income	\$78,803	\$85,241	\$80,194
Number of Households	2,458	19,344	50,464



### SCOTT F. HARRELL & ASSOCIATES, INC.

Commercial Real Estate Services  
1354 E. Kingsley Suite B, Springfield, MO 65804  
[www.scottfharrell.com](http://www.scottfharrell.com)

### SCOTT HARRELL

Broker-Officer  
417.832.0033  
[scott@scottfharrell.com](mailto:scott@scottfharrell.com)

# SPRINGFIELD MARKET OVERVIEW

Retail Property For Lease

*SPRINGFIELD PLAZA, W. SUNSHINE (BUS 60) & WEST BYPASS (HWY 160) // SPRINGFIELD, MO 65807*

## Population

- Economic Trade Area 1,071,707
- Greene County 307,942
- City of Springfield 170,067
- MSA 487,061 (5 County )
- Springfield Daytime Population 252,454
- 1.5% Annual Population Growth

## Retail Sales

- \$10.4 billion – 5 county region  
Polk, Greene, Christian, Dallas & Webster
- \$6.5 billion – Springfield, MO

## Top Employers

- Cox Health Systems 13,297 (1,074 beds)
- Mercy Health 9,238 \*1,068 beds)
- State of Missouri 6,298
- Walmart & Sam's Club 5,960
- United States Government 3,946
- Springfield Public Schools 3,735
- Bass Pro Shop\* / White River Marine\* 3,492
- O'Reilly Automotive\* 2,305
- Citizens Memorial Healthcare 2,258 (86 beds)
- Missouri State University (MSU) 2,099
- City of Springfield 1,906
- SRC Holdings, Inc.\* 1,900
- Burrell Behavioral Health 1,872 (75 beds)
- Ozarks Technical Community College (OTC) 1,610
- EFCO Manufacturing\* 1,600
- Jack Henry Associates, Inc. 1,412
- Prime, Inc.\* 1,405
- Amazon 1,400
- RPS (Pyramid Foods) 1,350
- Greene County 1,110
- Lowe's 1,031
- The Arc of the Ozarks, Inc. 1,030

\*Corporate Headquarters in Springfield, MO

## Economic Generators

- Regional Healthcare Mecca 32,000+ employed with Two Top 100 Hospitals with a \$4.5B Economic Impact
- Education 33,800+/- students attending 8+ colleges and universities.
  - MSU – 23,274
  - OTC – 9,969
  - Drury - 1,868
  - Evangel University – 2,467
  - Cox College - 668
  - Mission University - 269
- Tourism
  - #1 Tourist Venue in the State – Bass Pro Shops - World's Largest Sporting Goods Store
  - #1 Tourist Destination in State - Branson, Missouri
  - Wonder's of Wildlife Aquarium voted best aquarium in the U.S.
  - Springfield Cardinals - AA Minor League Baseball Affiliated with the St. Louis Cardinals
- Springfield Gross Metro Product (GMP) \$22.23 billion

## Miscellaneous

- Top 5 Best Cities to Start a Business / WalletHub
- Top 10 Recovery Leaders / Business Facilities
- Top 20 Magnets for Young Adults / USA Today
- Top 30 Best Cities for Job Growth / New Geography
- Top 40 for Business and Careers / Forbes Magazine
- Top 100 Places to Live / Livability.com

Scott F. Harrell & Associates, Inc. obtained the above attached information from sources deemed reliable but does not warrant the accuracy hereof and is subject to errors or omissions. April 9, 2025



### SCOTT F. HARRELL & ASSOCIATES, INC.

Commercial Real Estate Services  
1354 E. Kingsley Suite B, Springfield, MO 65804  
www.scottfharrell.com

### SCOTT HARRELL

Broker-Officer  
417.832.0033  
scott@scottfharrell.com

# DISCLAIMER

Retail Property For Lease

*SPRINGFIELD PLAZA, W. SUNSHINE (BUS 60) & WEST BYPASS (HWY 160) // SPRINGFIELD, MO 65807*

## DISCLAIMER

All materials and information received or derived from Scott F. Harrell & Associates, Inc. its directors, officers, agents, advisors, affiliates and/or any third party sources are provided without representation or warranty as to completeness, veracity, or accuracy, condition of the property, compliance or lack of compliance with applicable governmental requirements, developability or suitability, financial performance of the property, projected financial performance of the property for any party's intended use or any and all other matters.

Neither Scott F. Harrell & Associates, Inc. its directors, officers, agents, advisors, or affiliates makes any representation or warranty, express or implied, as to accuracy or completeness of the any materials or information provided, derived, or received. Materials and information from any source, whether written or verbal, that may be furnished for review are not a substitute for a party's active conduct of its own due diligence to determine these and other matters of significance to such party. Scott F. Harrell & Associates, Inc. will not investigate or verify any such matters or conduct due diligence for a party unless otherwise agreed in writing.

EACH PARTY SHALL CONDUCT ITS OWN INDEPENDENT INVESTIGATION AND DUE DILIGENCE.

Any party contemplating or under contract or in escrow for a transaction is urged to verify all information and to conduct their own inspections and investigations including through appropriate third party independent professionals selected by such party.

All financial data should be verified by the party including by obtaining and reading applicable documents and reports and consulting appropriate independent professionals. Scott F. Harrell & Associates, Inc. makes no warranties and/or representations regarding the veracity, completeness, or relevance of any financial data or assumptions. Scott F. Harrell & Associates, Inc. does not serve as a financial advisor to any party regarding any proposed transaction. All data and assumptions regarding financial performance, including that used for financial modeling purposes, may differ from actual data or performance. Any estimates of market rents and/or projected rents that may be provided to a party do not necessarily mean that rents can be established at or increased to that level. Parties must evaluate any applicable contractual and governmental limitations as well as market conditions, vacancy factors and other issues in order to determine rents from or for the property.

Legal questions should be discussed by the party with an attorney. Tax questions should be discussed by the party with a certified public accountant or tax attorney. Title questions should be discussed by the party with a title officer or attorney. Questions regarding the condition of the property and whether the property complies with applicable governmental requirements should be discussed by the party with appropriate engineers, architects, contractors, other consultants and governmental agencies. All properties and services are marketed by Scott F. Harrell & Associates, Inc. in compliance with all applicable fair housing and equal opportunity laws.



### SCOTT F. HARRELL & ASSOCIATES, INC.

Commercial Real Estate Services  
1354 E. Kingsley Suite B, Springfield, MO 65804  
[www.scottfharrell.com](http://www.scottfharrell.com)

### SCOTT HARRELL

Broker-Officer  
417.832.0033  
[scott@scottfharrell.com](mailto:scott@scottfharrell.com)