

# Publix #1685 - Publix at Winder Hill

401 Gainesville Highway  
Winder, GA 30680  
Lat 33.990, Long -83.723

FOR LEASE



1,200 SF & ±0.98 - 1.55 ACRE OP AVAILABLE

## PROPERTY HIGHLIGHTS

- New Publix-Anchored Neighborhood Center Providing Convenient Access to Highway 11 and Highway 53
- Located in Winder which is Positioned in the Heart of Georgia's Innovation Crescent and Convenient to Highway 316 Connecting Atlanta to Athens
- Strategically Positioned Nearby Northeast Georgia Medical Center (56 beds) with a Medical Staff of More than 200 Physicians
- Just Three Miles to Fort Yargo State Park with over 1,800 Acres and Activities like Camping, Hiking/Biking Trails, Fishing, and Boating
- 1,200 SF Inline Spaces Available
- Three Outparcels Available for Ground Lease

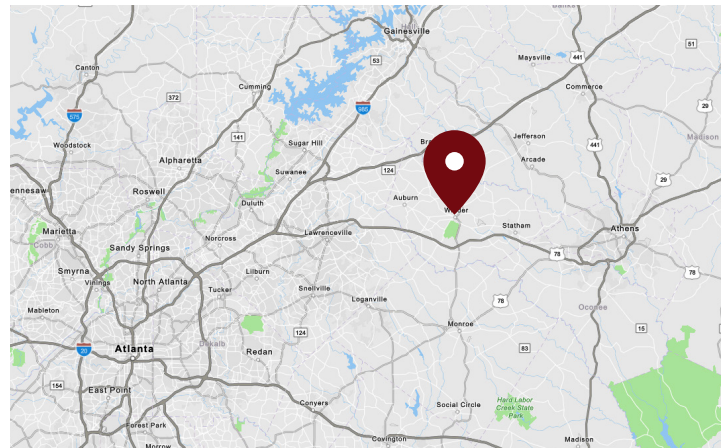

DEMOGRAPHICS	1 Mile	3 Miles	5 Miles
Total Population	5,736	23,995	45,297
Daytime Population	7,207	23,036	42,415
Total Households	2,202	8,582	15,660
Avg. HH Income	\$49,026	\$66,005	\$71,972

Data provided by Placer Labs Inc. ([www.placer.ai](http://www.placer.ai)) & Esri

## Melody Holley

Main: 770.541.0881 | Cell: 678.414.8989 | [mholley@crossmanco.com](mailto:mholley@crossmanco.com)  
6400 Powers Ferry Road, Suite 300, Atlanta, GA

Licensed Real Estate Broker. No warranty expressed or implied has been made to the accuracy of the information provided herein, no liability assumed for error or omission.



[www.crossmanco.com](http://www.crossmanco.com)

# Publix #1685 - Publix at Winder Hill

401 Gainesville Highway  
 Winder, GA 30680  
 Lat 33.990, Long -83.723

## SITE PLAN

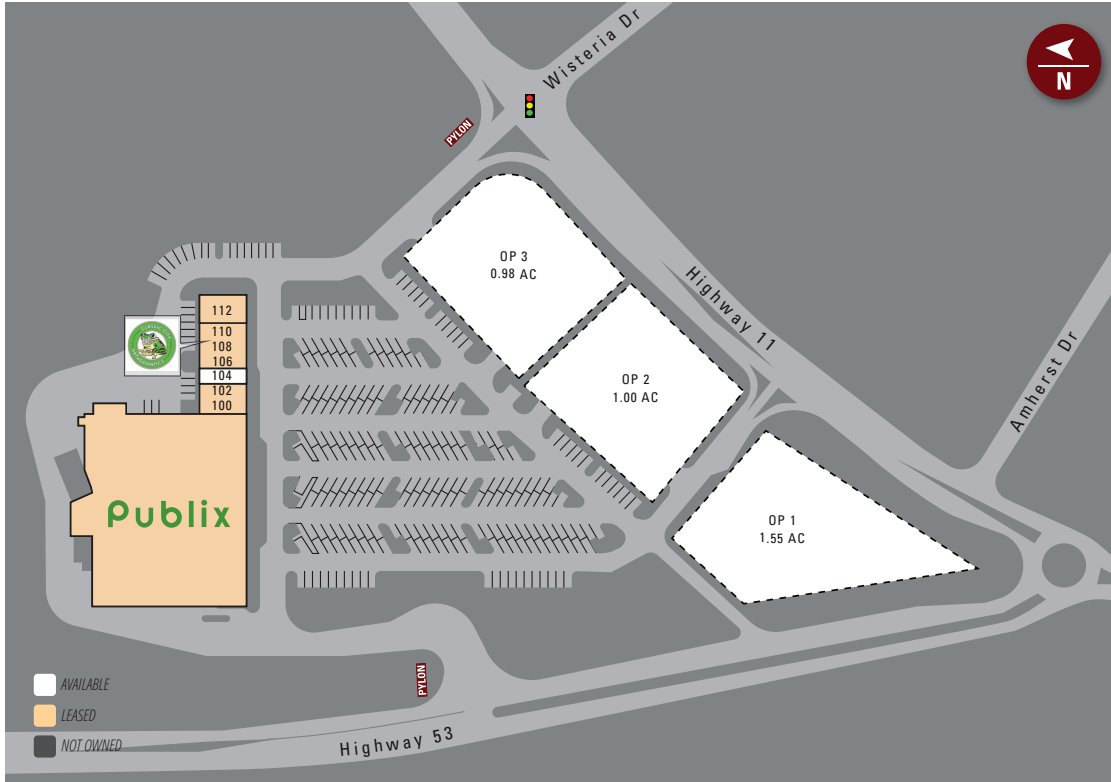

Suite	Tenant	Size
	Publix	48,387
100-102	B Nails & Spa	2,400
104	AVAILABLE	1,200
106 108 110	Classic City Orthodontics	3,600
112	WNB Factory	1,800
OP 1	AVAILABLE	1.55 AC
OP 2	AVAILABLE	1.00 AC
OP 3	AVAILABLE	0.98 AC

TOTAL 57,387



## Melody Holley

Main: 770.541.0881 | Cell: 678.414.8989 | [mholley@crossmanco.com](mailto:mholley@crossmanco.com)  
 6400 Powers Ferry Road, Suite 300, Atlanta, GA

*Licensed Real Estate Broker. No warranty expressed or implied has been made to the accuracy of the information provided herein, no liability assumed for error or omission.*



[www.crossmanco.com](http://www.crossmanco.com)