

FOR SALE OFFICE SITE



E. SILVERBELL ROAD +/- 13,600 VPD

512 East Silverbell Road Lake Orion, MI 48360

FEATURES

- Up to 10,000 SF of general office space available for sale or BTS
- Tenant signage
- 44 surface parking spaces
- 249' on Silverbell Road with 1 curb cut and 363' on Bald Mountain Road with 1 curb cut
- Located at the SW corner of Silverbell Road and Bald Mountain Road
- Quick and easy access to M-24

SALE PRICE: \$1,250,000

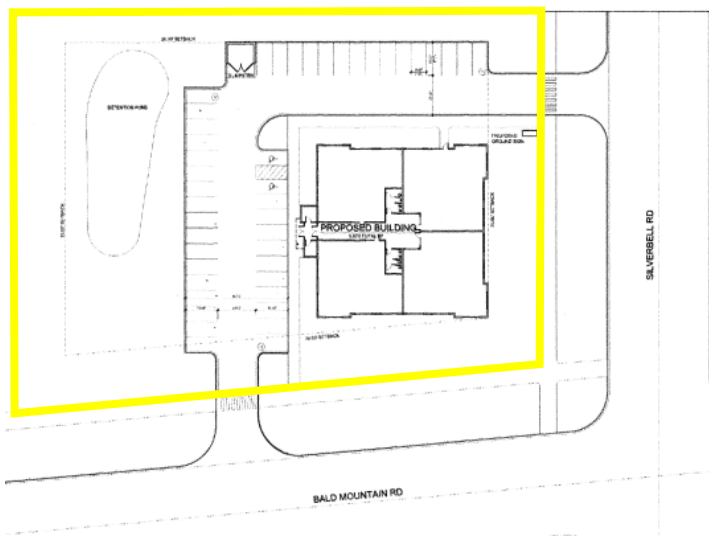

	1 MILE	3 MILES	5 MILES
Population	5,154	33,579	106,267
Total H.H	1,903	13,498	41,612
AVG. H.H Income	\$174,257	\$162,372	\$143,003

DAVID MCNABNAY, SIOR

Senior Vice President
 (o) 248.399.9999 x250
 (m) 248.980.5076
 dmcnabnay@dominionra.com



DOMINION
 REAL ESTATE ADVISORS