

3226-3230 Mines Ave

HOON JAE (JAY) KIM

Broker

LIC # 01834319

DAHAMREALTY@GMAIL.COM

310.800.5662

DAHAM REALTY GROUP INC

2164 CLIFFORD ST

LOS ANGELES CA 90026

LIC# 01987989



FOR LEASE

13,200 SF
(OFFICE 4,500 SF)

AVAILABLE NOW



PROPERTY DESCRIPTION

BUILDING ADDRESS

3230 Mines Ave, Los Angeles CA 90023

LAND SIZE (MLS)

13,245 SF

BUILDING SIZE (BUILT IN 1969)

TOTAL 13,200 SF (Office 4,500SF)
(1ST FL AND MEZZANINE)

© VHT STUDIOS

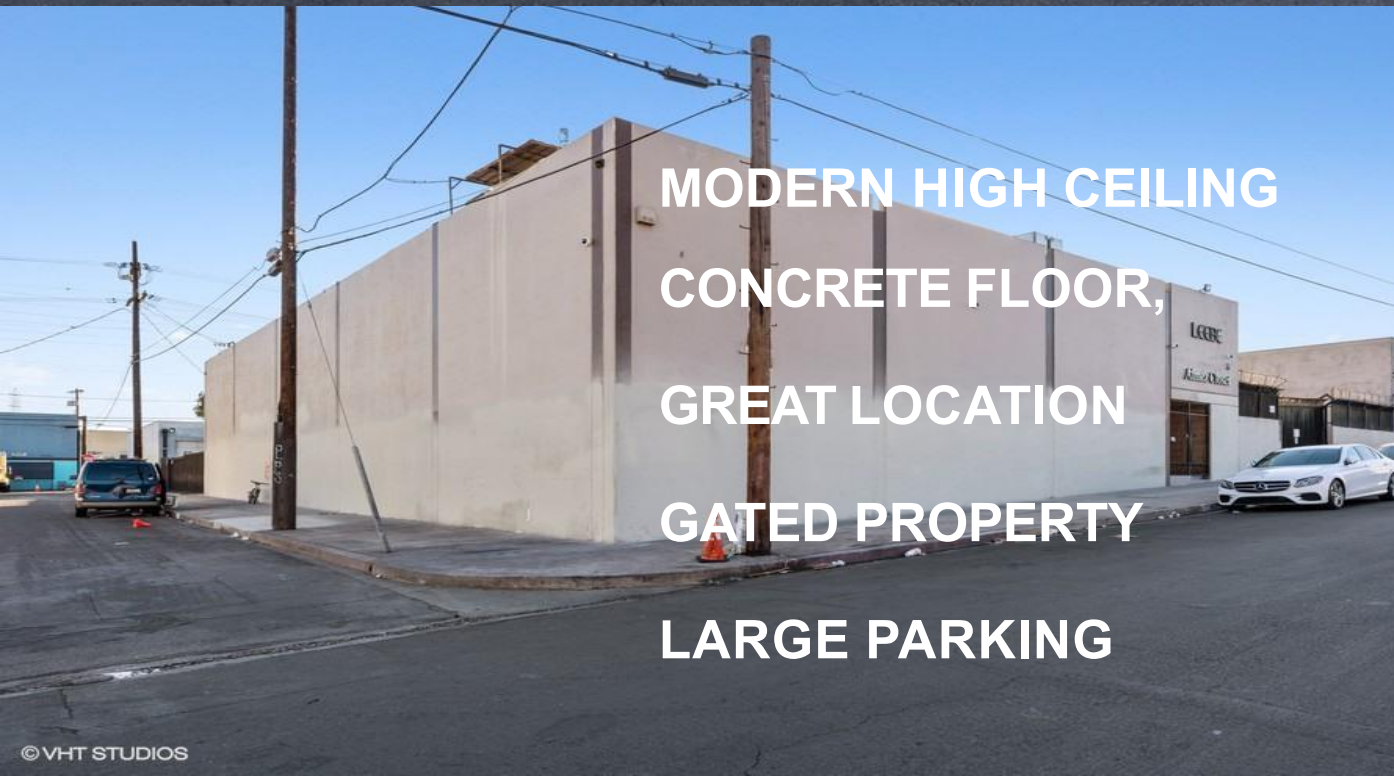

**MODERN HIGH CEILING
CONCRETE FLOOR,
GREAT LOCATION
GATED PROPERTY
LARGE PARKING**

CLEAR HEIGHT 17'

**PARKING 10 + SPACES
(3,600 SF)**

**POWER TOTAL 200 AMP
Single**

Ready to upgrade to 600 AMP

GATED PROPERTY

© VHT STUDIOS



PROPERTY PHOTO

WAREHOUSE AREAS 56,469 SF

FREIGHT ELEVATOR

GROUND DOCK LOADING

17 FEET CEILING





PROPERTY PHOTO

OFFICE AREAS 4,500SF

2 Bathrooms





PROPERTY PHOTO

PARKING AREAS 4,300SF

10 + space

Gated Lot



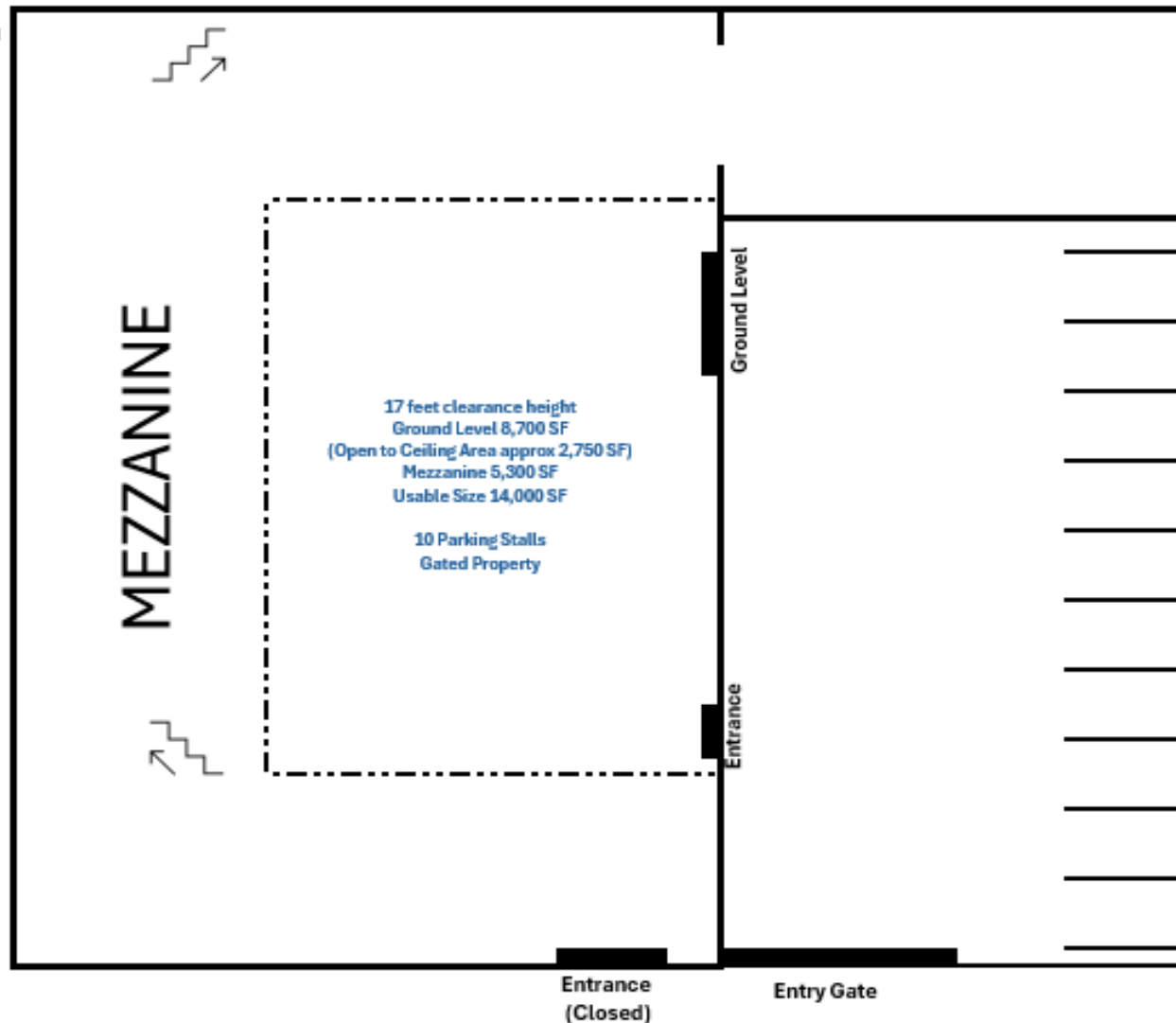

GROUND LEVEL USUALBLE SIZE APPROX.)

7,700 SF (MAIN)+1,000SF (ANNEX)=8,700 SF

(OPEN TO CEILING AREA 2,750 SF) TOTAL USABLE SIZE: APPROX. 14,000 SF

MEZZANINE LEVEL USUALBLE SIZE (APPROX)

5,300 SF

PARKING LOT SIZE

10 + PARKING SPACES

4,300 SF

BATHROOM

TOTAL 2 (1 ON EACH FLOOR)