

# 2,166 SF INLINE RESTAURANT SPACE AT WESTWOOD COMMONS

13311 PEARL ROAD, STRONGSVILLE, OHIO 44136

FOR LEASE



2,166 SF CONFIDENTIAL  
LEASE OPPORTUNITY

CONTACT EXCLUSIVE AGENT:

Joseph W. Khouri  
Senior Vice President  
216 658 6120  
joseph.khouri@cbre.com

CBRE



# THE OPPORTUNITY

- 2,166 SF Existing pizza restaurant / sit down and take-out now available
- Confidential, business is still open and operating, please do not approach Tenant and direct all inquires to CBRE
- Furniture, Fixtures, & Equipment: Negotiable
- Join thriving Tenant's at Westwood Commons (built in 2016) including Mitchell's Ice Cream, Square 22 restaurant, Nothing Bundt Cake, VIO Med Spa, Hot Head Burrito, Goldie's Deli, Delta-Works, Studio Vasi Salon, and Jersey Mikes
- Traffic Counts: 21,740 VPD on Pearl Road and 32,254 VPD on Royalton Road (SR 82)
- 5 Mile Average Household Income: \$110,246 and Daytime Population: 104,828
- Local hands-on, engaged property ownership and management



## Quick Stats - 5 mile Radius



DAYTIME  
POPULATION  
**104,828**



POPULATION  
**103,482**



HOUSEHOLDS  
**43,700**



POPULATION  
25 & OVER  
**75,478**



AVG. HOUSEHOLD  
INCOME  
**\$110,246**

# FLOOR PLAN

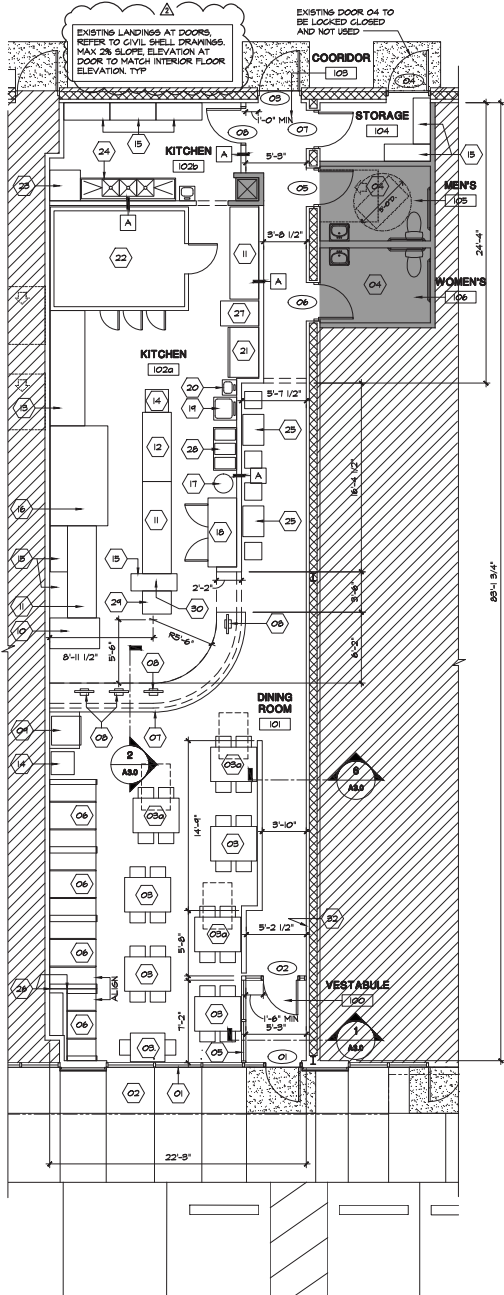

**FLOOR PLAN**  
**3/16"=1'-0"**

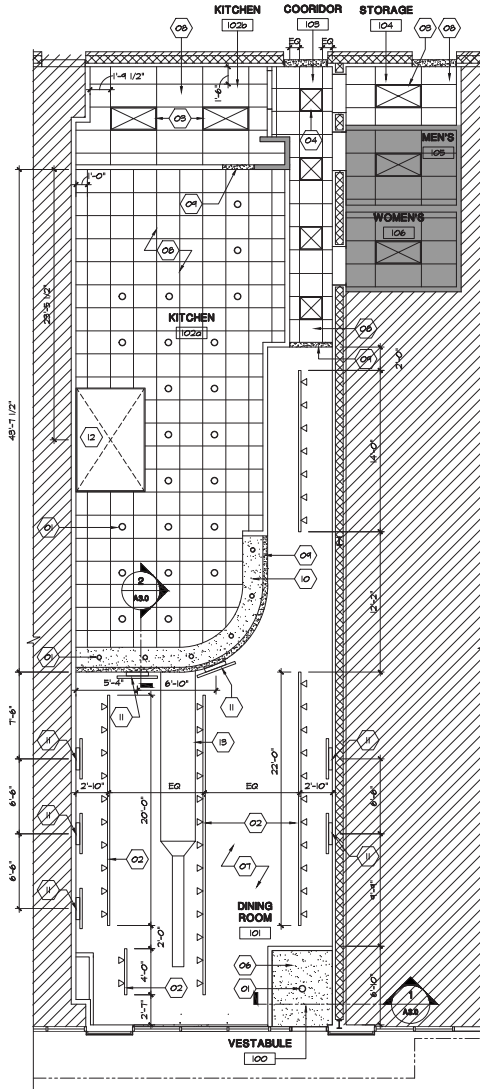

**REFLECTED CEILING PLAN**  
3/16"=1'-0"





# SITE PLAN





# AERIAL VIEW



2,166 SF CONFIDENTIAL  
LEASE OPPORTUNITY





# RETAIL TRADE MAP





# DEMOGRAPHICS

	1 MILE	3 MILES	5 MILES
2024 Population - Current Year Estimate	7,359	46,215	103,482
2029 Population - Five Year Projection	7,385	46,134	103,423
2024 Daytime Population	7,941	51,161	104,828
2024 Households - Current Year Estimate	3,361	19,164	43,700
2024 Average Household Income	\$109,928	\$115,973	\$110,246
2029 Average Household Income Projection	\$127,994	\$133,801	\$127,239
2024 Median Household Income	\$90,002	\$94,270	\$84,217
2024 Population Over 25	5,687	33,752	75,478

## CONTACT EXCLUSIVE AGENT:

**Joseph W. Khouri**  
Senior Vice President  
216 658 6120  
[joseph.khouri@cbre.com](mailto:joseph.khouri@cbre.com)

© 2024 CBRE, Inc. All rights reserved. This information has been obtained from sources believed reliable, but has not been verified for accuracy or completeness. You should conduct a careful, independent investigation of the property and verify all information. Any reliance on this information is solely at your own risk. CBRE and the CBRE logo are service marks of CBRE, Inc. All other marks displayed on this document are the property of their respective owners, and the use of such logos does not imply any affiliation with or endorsement of CBRE. Photos herein are the property of their respective owners. Use of these images without the express written consent of the owner is prohibited. Licensed Real Estate Broker.

**CBRE**