

Warehouse with Excellent Loading

31 Graystone Street
Warwick, RI 02886
www.cbre.com

Property Description

CBRE is pleased to offer for sub-lease ±15,503 SF of 22' warehouse space at 31 Graystone Street, Warwick, RI. This space is well located just off Jefferson Boulevard and the Airport exit from I-95.

Highlights

- + ±15,503 SF available
- + 22' ceilings
- + 2 docks 8' X 10', 9 van docks 5' X 8', 2 OHD's 8' X 10
- + 1.15 acres



Building Specifications

Floor Plan

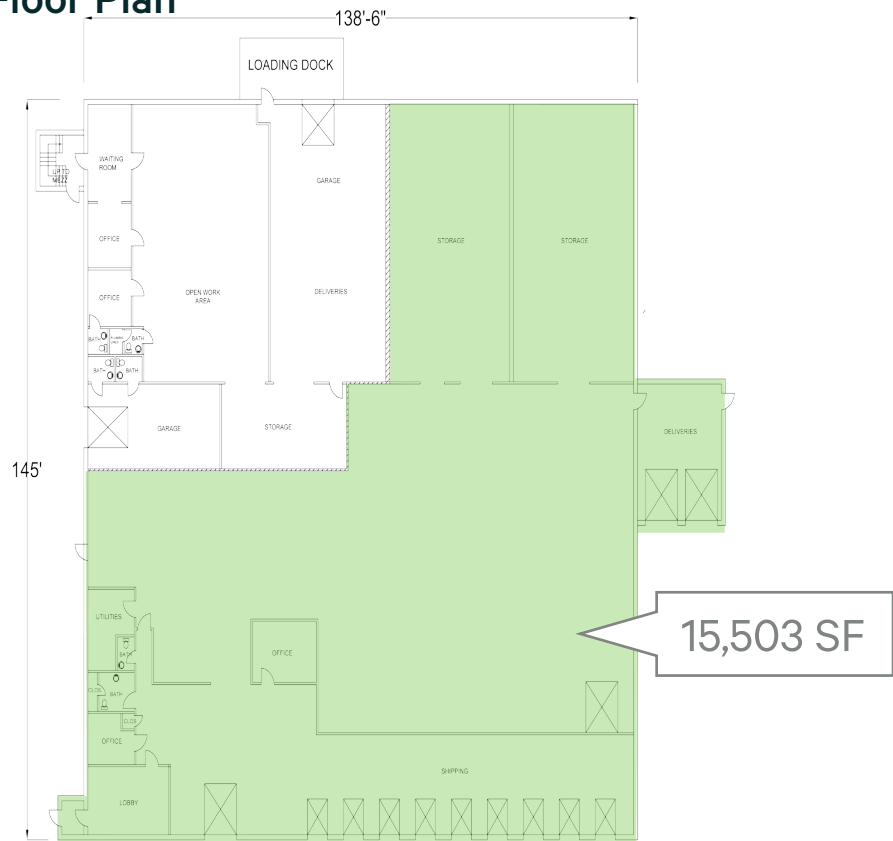

Building Specs	
Total SF	20,344
Available SF	15,503
Available Office SF	820
Land Area	1.15 acres
Ceiling Height	22'
Loading Docks	9 (5'x8'), 2 (8'x10')
Overhead Doors	1 (8'x10'), 1 (8'x10' on dock platform)
Structure	Cement block
Year Built	1970
Heat	Gas
Zoning	I (Industrial)
Rent	\$9.00/SF, NNN (\$2.65/SF)



Contact Us

Daniel Cregan
Vice President
+1 401 621 4340
dan.cregan@cbre.com



© 2025 CBRE, Inc. All rights reserved. This information has been obtained from sources believed reliable, but has not been verified for accuracy or completeness. You should conduct a careful, independent investigation of the property and verify all information. Any reliance on this information is solely at your own risk. CBRE and the CBRE logo are service marks of CBRE, Inc. All other marks displayed on this document are the property of their respective owners, and the use of such logos does not imply any affiliation with or endorsement of CBRE. Photos herein are the property of their respective owners. Use of these images without the express written consent of the owner is prohibited.