

4.67 ACRES OF LAND FOR LEASE

788 Johnson Lane, West Palm Beach, FL 33411

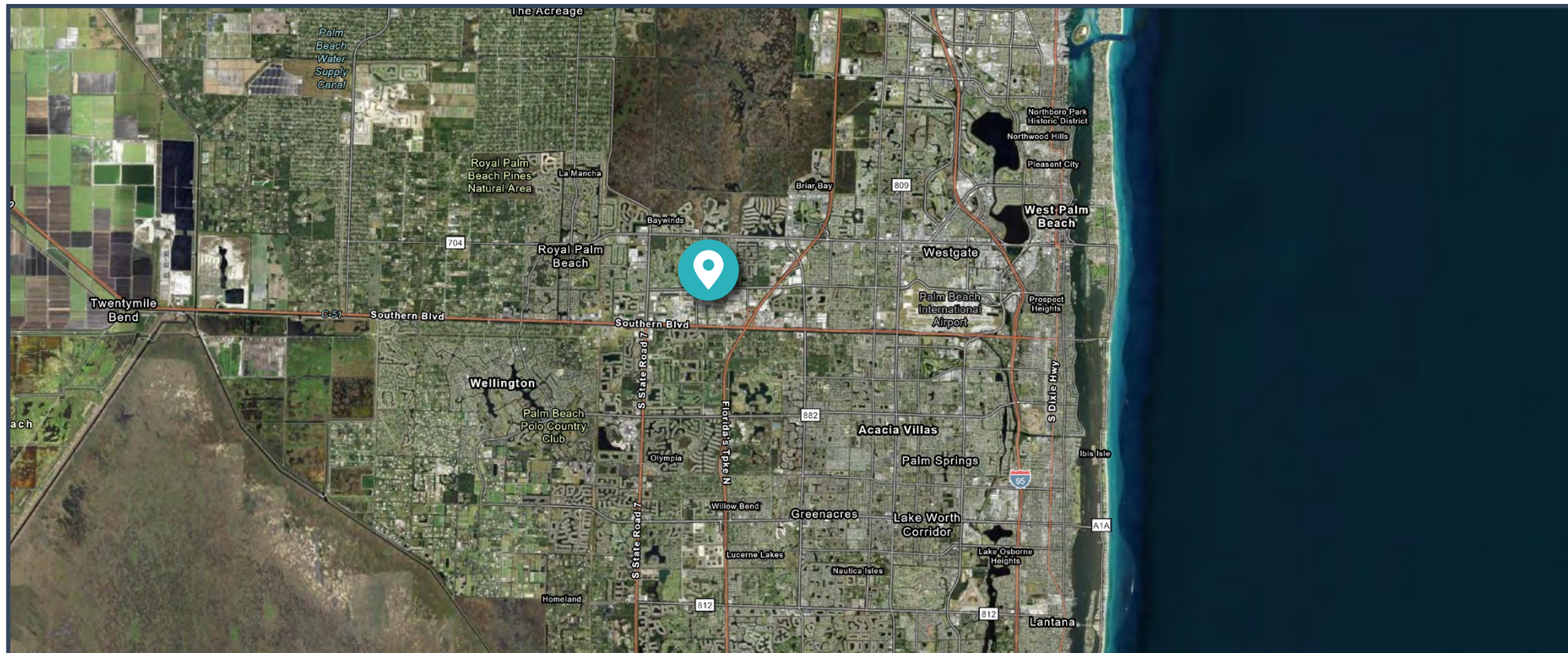

Andrew Rosenberg
(305) 897-0939
andrew@upsidecre.com
www.upsidecre.com



4.67 ACRES OF LAND FOR LEASE

788 Johnson Lane, West Palm Beach, FL 33411

TOTAL SF: 203,426 SF

LAND SIZE: 4.67 Acres

ZONING: IL-Light Industrial (00-Unincorporated)

RENT PRICE: Upon request

POSSESSION: Immediate

HIGHLIGHTS:

- Ideal IOS site
- Site has been cleared and is ready for development
- Less than 1 mile from the entrance to the FL Turnpike and 6 miles to I-95
- Ideal location between West Palm Beach, Royal Palm Beach and Wellington
- Site is surrounded by IOS sites and industrial parks
- Cell tower to remain in place

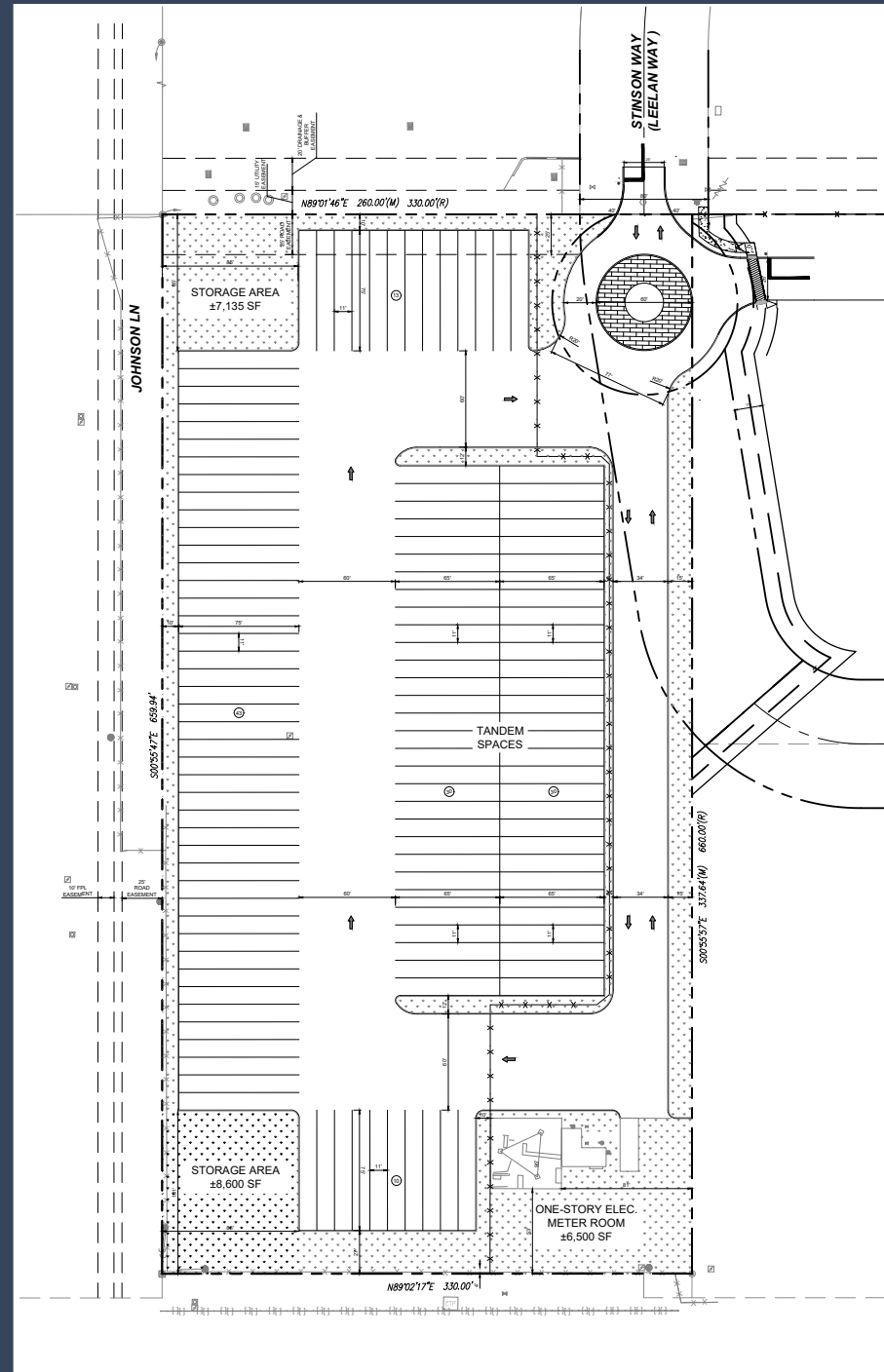



FOR INQUIRIES, CONTACT:

ANDREW ROSENBERG

President

 **(305) 897-0939**

 **andrew@upsidecre.com**

 **www.upsidecre.com**