



FOR SALE

INDUSTRIAL SUITE

1522 SANTIAGO RIDGE WAY
SAN DIEGO, CA 92154

1,992 SF AVAILABLE

PROPERTY HIGHLIGHTS

TURN-KEY READY FOR IMMEDIATE OCCUPANCY



ASKING RATE: CONTACT BROKER

- Modern Finishes and High Quality Improvements
- Private Entrance, Office and Restroom
- Rear Roll-Up Door
- High Speed Internet Available
- Light Industrial Zoning
- Ample Parking
- Convenient Access to I-805, I-5, I-905 & Otay Mesa Border Crossing
- Potential Employment, Tax & Other Business Incentives throughout the City of San Diego
- Flex Industrial Turn-Key ready for immediate occupancy

PROPERTY INFORMATION



ASKING RATE: CONTACT BROKER

1,992 SF
TOTAL BUILDING SIZE

16'
CLEAR HEIGHT

2.50/100
PARKING

640 SF
TURN-KEY OFFICE

1
CONDO UNIT

IL-2
ZONING

GAS
100 AMPS / 13PH

*Grandfathered SDG&E 45KW PV Solar Rate

SITE PLAN

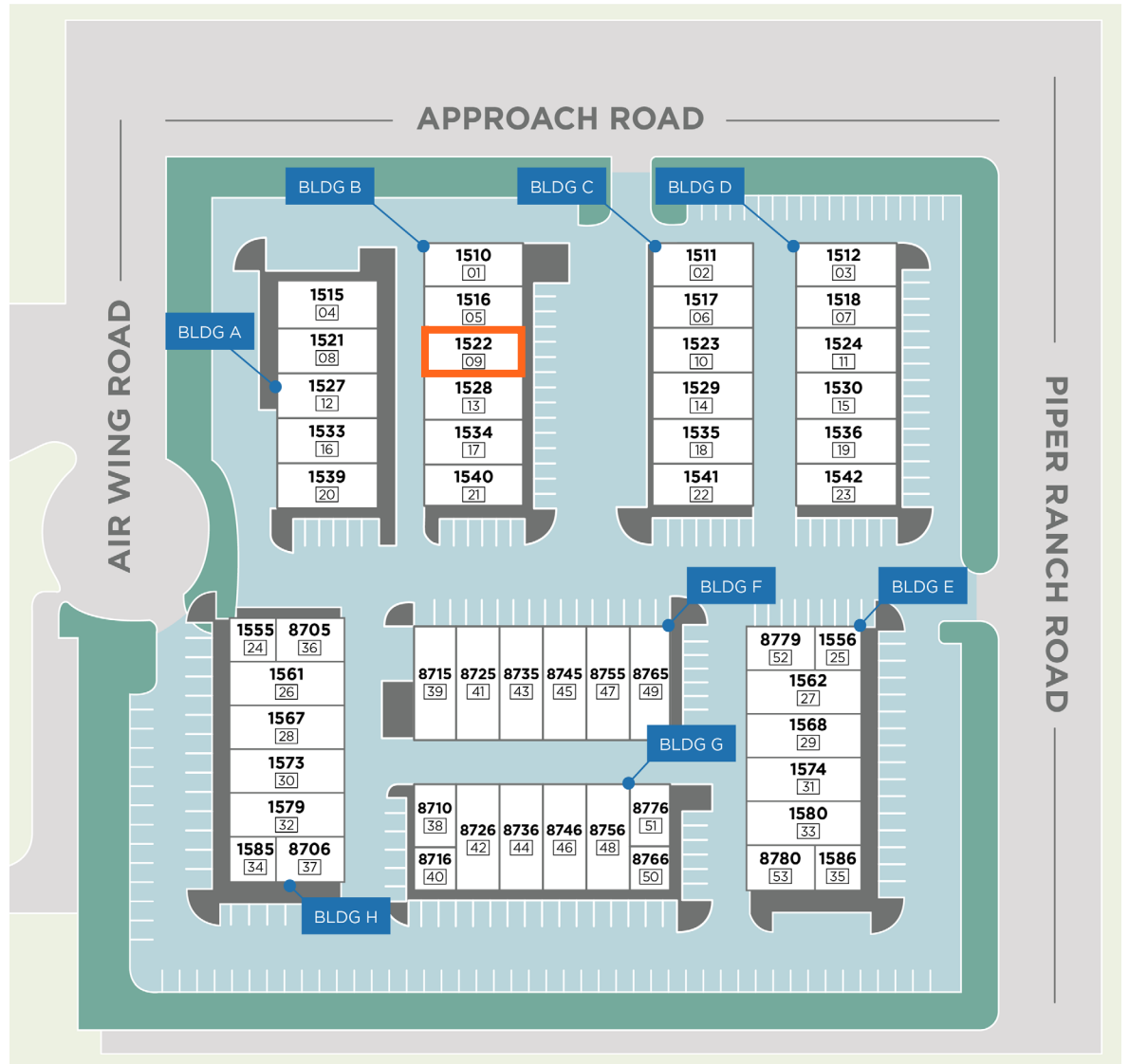



DRIVE INS



OFFICE SPACE

ENTRANCE



FLOOR PLAN

Building B - GROUND FLOOR

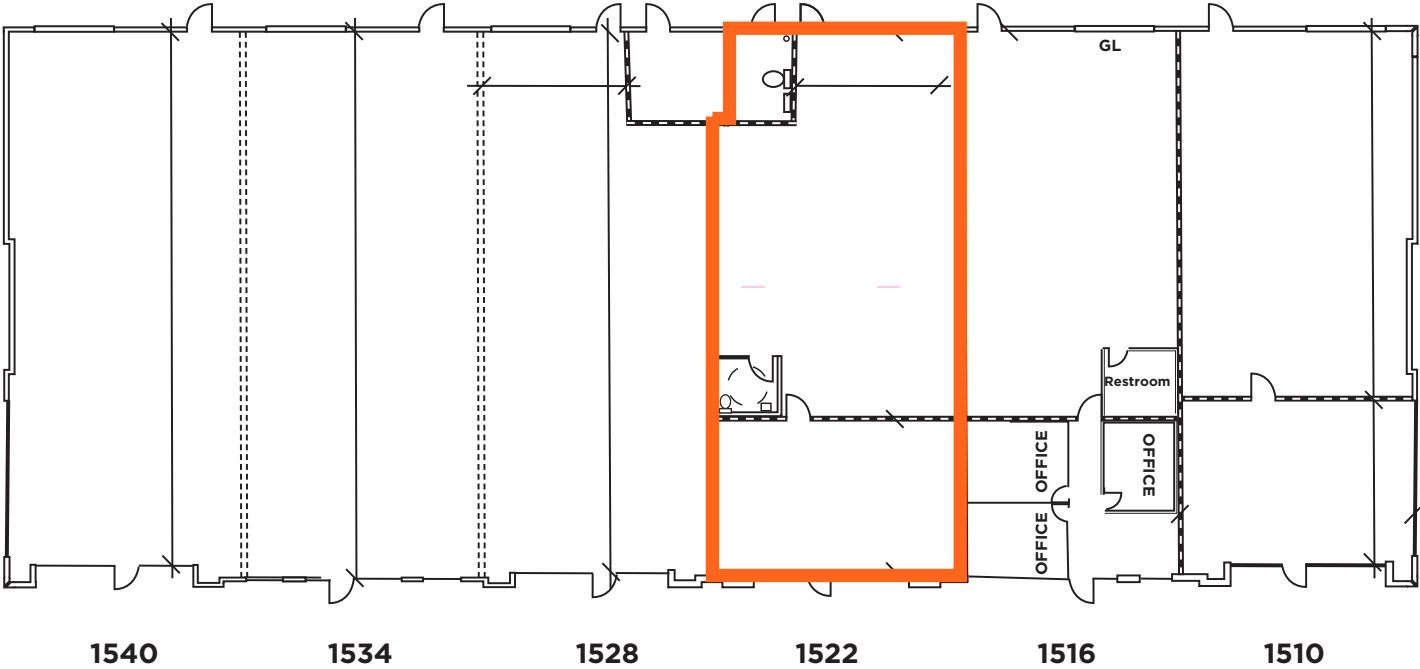



©2025 Cushman & Wakefield. All rights reserved. The information contained in this communication is strictly confidential. This information has been obtained from sources believed to be reliable but has not been verified. NO WARRANTY OR REPRESENTATION, EXPRESS OR IMPLIED, IS MADE AS TO THE CONDITION OF THE PROPERTY (OR PROPERTIES) REFERENCED HEREIN OR AS TO THE ACCURACY OR COMPLETENESS OF THE INFORMATION CONTAINED HEREIN, AND SAME IS SUBMITTED SUBJECT TO ERRORS, OMISSIONS, CHANGE OF PRICE, RENTAL OR OTHER CONDITIONS, WITHDRAWAL WITHOUT NOTICE, AND TO ANY SPECIAL LISTING CONDITIONS IMPOSED BY THE PROPERTY OWNER(S). ANY PROJECTIONS, OPINIONS OR ESTIMATES ARE SUBJECT TO UNCERTAINTY AND DO NOT SIGNIFY CURRENT OR FUTURE PROPERTY PERFORMANCE.

For more information
please contact:

Regan Tully
Managing Director
CA License #00712457
Direct: +1 619 661 0656
Mobile: +1 619 520 2424
regan.tully@cushwake.com

8780 Sherwood Terrace
San Diego, CA 92154 | USA
T: +1 619 661 0657
F: +1 619 661 1869
www.cushmanwakefield.com