

Portage Trail Ext.

Cuyahoga Falls, OH 44223

Property Features

- Excellent Visibility
- Located near Portage Trail Ext. W. and Northampton Rd. Intersection
- Approximately 1.25 miles from Portage Crossing retail area
- Zoned R-5

Parcel A #70-02663 \$300,000

4.35 acres
Approximately 930' frontage and 233' depth

Parcel B #70-00935 \$250,000

9.138 acres
Approximately: 930' wide by 631' to 267" deep

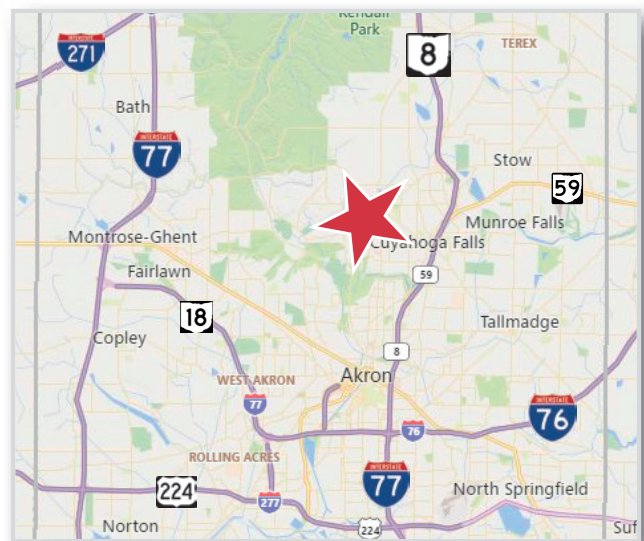

For more information:

Ronald Midcap II
+1 216 455 0900
RMidcap@naipvc.com

NO WARRANTY OR REPRESENTATION, EXPRESS OR IMPLIED, IS MADE AS TO THE ACCURACY OF THE INFORMATION CONTAINED HEREIN, AND THE SAME IS SUBMITTED SUBJECT TO ERRORS, OMISSIONS, CHANGE OF PRICE, RENTAL OR OTHER CONDITIONS, PRIOR SALE, LEASE OR FINANCING, OR WITHDRAWAL WITHOUT NOTICE, AND OF ANY SPECIAL LISTING CONDITIONS IMPOSED BY OUR PRINCIPALS NO WARRANTIES OR REPRESENTATIONS ARE MADE AS TO THE CONDITION OF THE PROPERTY OR ANY HAZARDS CONTAINED THEREIN ARE ANY TO BE IMPLIED.

6155 Rockside Rd., Suite 304
Independence, Ohio 44131
216 831 3310
naipvc.com



Demographics	1 Mile	3 Miles	5 Miles
Population:	6,361	73,712	171,874
Households:	3,202	33,100	75,534
Median Age:	33.3	41	40.6
Average HH Income:	\$65,163	\$72,832	\$69,781
Traffic:	16,980 Portage Trail @ Northampton Rd		



Portage Crossing

Portage Trail Ext. West
Cuyahoga Falls, OH 44223

Ronald Midcap II
+1 216 455 0900
RMidcap@naipvc.com

6155 Rockside Rd., Suite 304
Independence, Ohio 44131
216 831 3310
naipvc.com

1 mile

KEY FACTS

6,361

Population

33.3

Median Age



2.0

Average Household Size

\$42,124

Median Household Income

EDUCATION

5%

No High School Diploma



25%
High School Graduate



32%
Some College



37%
Bachelor's/Grad/Pr of Degree

BUSINESS



105

Total Businesses



952

Total Employees

EMPLOYMENT



White Collar

69%



Blue Collar

17%



Services

15%



3.7%
Unemployment Rate

INCOME



\$42,124

Median Household Income



\$32,500

Per Capita Income



\$20,838

Median Net Worth

Households By Income

The largest group: \$50,000 - \$74,999 (20.7%)
The smallest group: \$150,000 - \$199,999 (4.6%)

Indicator ▲	Value	Diff	
<\$15,000	11.7%	+0.8%	
\$15,000 - \$24,999	8.5%	-0.8%	
\$25,000 - \$34,999	19.3%	+8.4%	
\$35,000 - \$49,999	18.7%	+5.4%	
\$50,000 - \$74,999	20.7%	+2.1%	
\$75,000 - \$99,999	6.1%	-6%	
\$100,000 - \$149,999	5.9%	-6.7%	
\$150,000 - \$199,999	4.6%	-1.4%	
\$200,000+	4.6%	-1.7%	

Bars show deviation from Summit County

3 miles

KEY FACTS

73,712

Population

41.0

Median Age



2.2

Average Household Size

\$53,496

Median Household Income

EDUCATION

8%

No High School Diploma



25%
High School Graduate



30%
Some College



38%
Bachelor's/Grad/Pr of Degree

BUSINESS



1,979

Total Businesses



26,485

Total Employees

EMPLOYMENT



White Collar

70%



Blue Collar

19%



Services

11%



4.4%
Unemployment Rate

INCOME



\$53,496

Median Household Income



\$32,714

Per Capita Income



\$96,094

Median Net Worth

Households By Income

The largest group: \$50,000 - \$74,999 (20.5%)
The smallest group: \$200,000+ (4.2%)

Indicator ▲	Value	Diff	
<\$15,000	10.3%	-0.6%	
\$15,000 - \$24,999	8.8%	-0.5%	
\$25,000 - \$34,999	12.6%	+1.7%	
\$35,000 - \$49,999	14.2%	+0.9%	
\$50,000 - \$74,999	20.5%	+1.9%	
\$75,000 - \$99,999	12.8%	+0.7%	
\$100,000 - \$149,999	11.7%	-0.9%	
\$150,000 - \$199,999	5%	-1%	
\$200,000+	4.2%	-2.1%	

Bars show deviation from Summit County

5 miles

KEY FACTS

171,874

Population

40.6

Median Age



2.2

Average Household Size

\$49,685

Median Household Income

EDUCATION

8%

No High School Diploma



27%
High School Graduate



29%
Some College



35%
Bachelor's/Grad/Pr of Degree

BUSINESS



6,504

Total Businesses



118,813

Total Employees

EMPLOYMENT



White Collar

70%



Blue Collar

19%



Services

11%



5.1%
Unemployment Rate

INCOME



\$49,685

Median Household Income



\$30,672

Per Capita Income



\$72,047

Median Net Worth

Households By Income

The largest group: \$50,000 - \$74,999 (18.7%)
The smallest group: \$150,000 - \$199,999 (4.3%)

Indicator ▲	Value	Diff	
<\$15,000	14.3%	+3.4%	
\$15,000 - \$24,999	10%	+0.7%	
\$25,000 - \$34,999	12.3%	+1.4%	
\$35,000 - \$49,999	13.7%	+0.4%	
\$50,000 - \$74,999	18.7%	+0.1%	
\$75,000 - \$99,999	11.7%	-0.4%	
\$100,000 - \$149,999	10.6%	-2%	
\$150,000 - \$199,999	4.3%	-1.7%	
\$200,000+	4.5%	-1.8%	

Bars show deviation from Summit County