



## MIDWAY BUSINESS PARK

12 Buildings Total | 258,846 SF Total | 2,000-40,000 SF Available

### OFFERING SUMMARY

Midway Business Park is a premier industrial development spanning 258,846 square feet across twelve versatile buildings in the heart of Richland Hills, Texas. Strategically located in central Tarrant County, this dynamic business hub offers exceptional freeway visibility and immediate access to major highways, placing tenants just minutes from downtown Fort Worth and DFW International Airport. Surrounded by a robust and diverse labor pool, Midway Business Park is designed to accommodate a wide range of tenant needs, with flexible suite sizes from 2,000 to 40,000 square feet. Whether you're a growing business or an established enterprise, Midway Business Park delivers the accessibility, visibility, and workforce proximity essential for success.

Owned by:

Ackerman & Co.

Leased by:

HPI

# 6,048 SF FOR LEASE

# MBP | MIDWAY BUSINESS PARK

2842 Dogwood Park, Richland Hills, TX 76118  
Suite 100

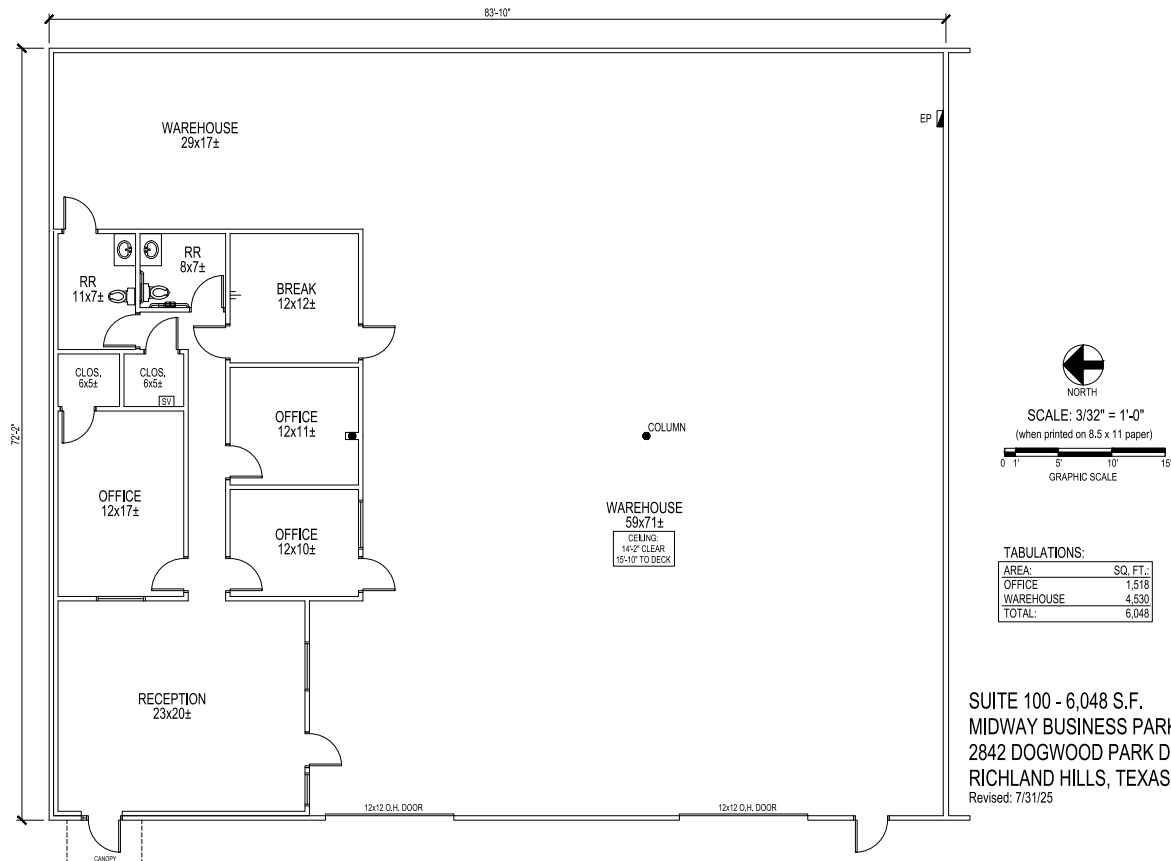

SUITE 100 - 6,048 S.F.  
MIDWAY BUSINESS PARK  
2842 DOGWOOD PARK DRIVE  
RICHLAND HILLS, TEXAS  
Revised: 7/31/25

## HIGHLIGHTS

- 6,048 Total SF
- 4,530 SF Warehouse
- 1,518 SF Office
- Two (2) 12x12 Grade Level Doors
- 14' Clear Height
- Ample Parking
- Billboard Sign Available
- Prime Location with Close Proximity to Highway 121, Loop 820 + I-35W





# 2,016 SF FOR LEASE

**MBP** | MIDWAY  
BUSINESS  
PARK

7336B Dogwood Park, Richland Hills, TX 76118

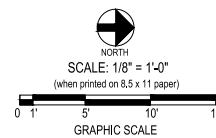
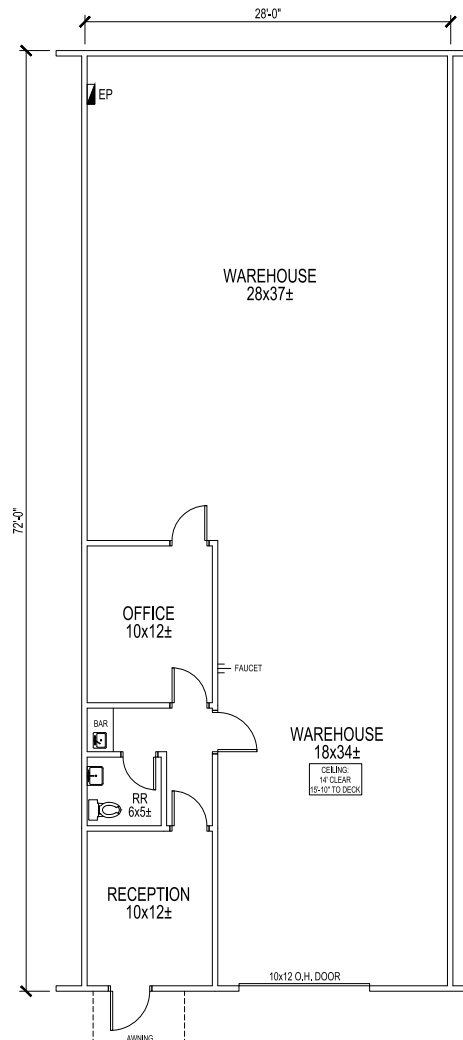

#### TABULATIONS:

AREA:	SQ. FT.:
OFFICE	352
WAREHOUSE	1,664
TOTAL:	2,016

FLOOR PLAN - 2,016 S.F.  
MIDWAY BUSINESS PARK  
7336B DOGWOOD PARK DRIVE  
RICHLAND HILLS, TEXAS  
Revised: 8/14/25

## HIGHLIGHTS

2,016 Total SF	14' Clear Height
1,664 SF Warehouse	Ample Parking
352 SF Office	Prime Location with Close Proximity to Highway 121, Loop 820, and I-35W
One (1) 10x12 Grade Level Door	



# 2,016 SF FOR LEASE

**MBP** | MIDWAY  
BUSINESS  
PARK

7350 Dogwood Park, Richland Hills, TX 76118

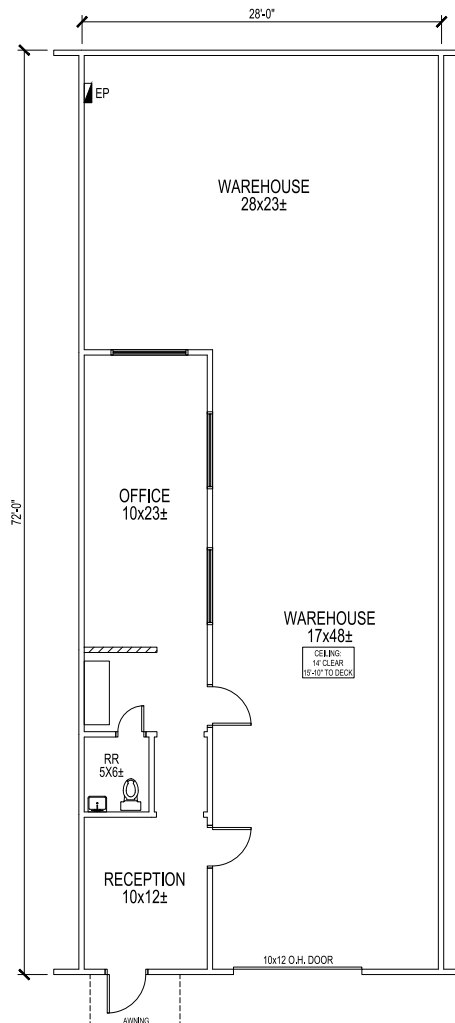

#### TABULATIONS:

AREA:	SQ. FT.:
OFFICE	497
WAREHOUSE	1,519
TOTAL:	2,016

FLOOR PLAN - 2,016 S.F.  
MIDWAY BUSINESS PARK  
7350 DOGWOOD PARK DRIVE  
RICHLAND HILLS, TEXAS  
Revised: 9/4/25

## HIGHLIGHTS

2,016 Total SF	14' Clear Height
1,664 SF Warehouse	Ample Parking
352 SF Office	Prime Location with Close Proximity to Highway 121, Loop 820, and I-35W
One (1) 10x12 Grade Level Door	





# 2,016 SF FOR LEASE

**MBP** | MIDWAY  
BUSINESS  
PARK

7354 Dogwood Park, Richland Hills, TX 76118

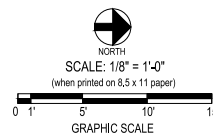
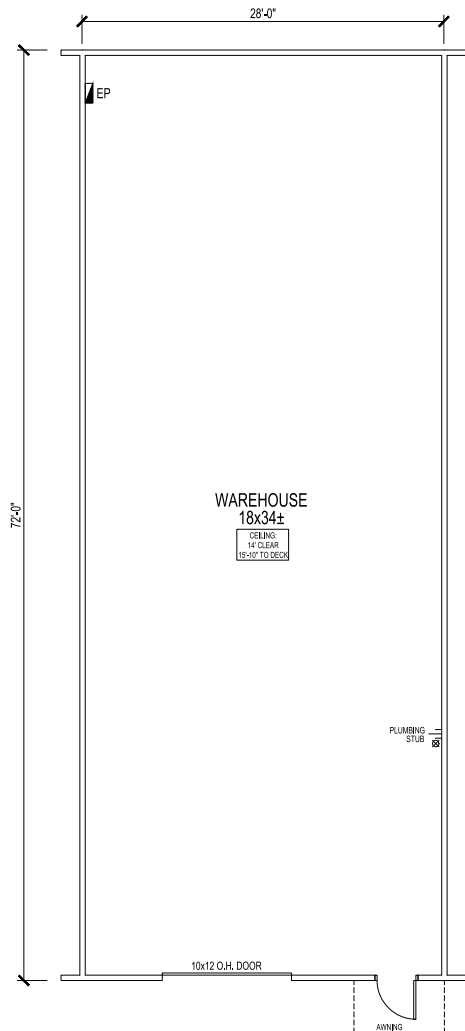

#### TABULATIONS:

AREA:	SQ. FT.:
OFFICE	0
WAREHOUSE	2,016
TOTAL:	2,016

FLOOR PLAN - 2,016 S.F.  
MIDWAY BUSINESS PARK  
7354 DOGWOOD PARK DRIVE  
RICHLAND HILLS, TEXAS  
Revised: 8/14/25

## HIGHLIGHTS

2,016 SF of Warehouse

One (1) 10x10 Grade Level Door

14' Clear Height



7339 Tower St, Richland Hills, TX 76118

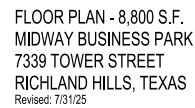



# FOR LEASE

# MBP | MIDWAY BUSINESS PARK





# FOR LEASE

# MBP | MIDWAY BUSINESS PARK

