

FOR SALE

ALIGN
COMPLETE REAL ESTATE SERVICES

Commercial Condo for Sale at The Harvey



**501 East 2700 South
Salt Lake City, Utah**

Property Details

- Price: \$499,000.00
- New Boutique Mixed-Use Project Overlooking Nibley Park Golf Course
- Office or Retail Use
- 1276 Rentable Square Feet
- Unit #104
- 2 Dedicated Parking Stalls
- Construction Complete Early 2026
- Across the Street From Nibley Park
- Commercial Neighborhood Zoning

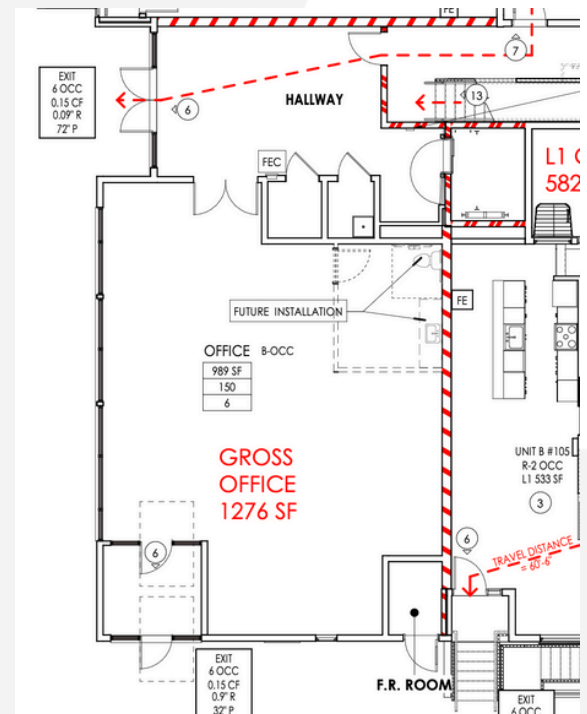

Jonah Hornsby, CCIM
Managing Partner | Commercial Agent
801-580-4945
Jonah@acresutah.com

FOR SALE

Commercial Condo for Sale at The Harvey

ALIGN
COMPLETE REAL ESTATE SERVICES



Jonah Hornsby, CCIM
Managing Partner | Commercial Agent
801-580-4945
Jonah@acresutah.com

FOR SALE

Commercial Condo for Sale at The Harvey

ALIGN
COMPLETE REAL ESTATE SERVICES



Jonah Hornsby, CCIM
Managing Partner | Commercial Agent
801-580-4945
Jonah@acresutah.com