

# **BARRISTER**

*EXECUTIVE SUITES, INC.*

**Superior Office Solutions**

**Bank of America Building**

9440 S. Santa Monica Boulevard, Suite 301  
Beverly Hills, CA 90210  
(310) 696-2000/<http://www.barrister-suites.com>  
800-576-0744

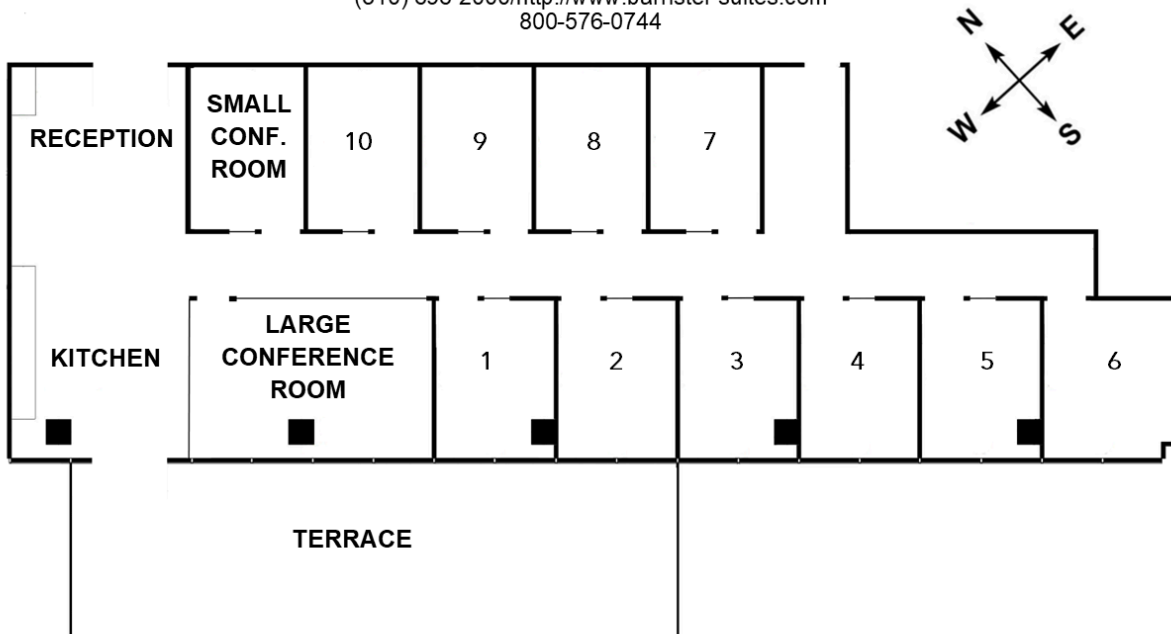

**AREA MANAGER:** Jacqueline Jansen

**HOURS OF OPERATION:** 8:30 am to 5:00 pm

**DIRECTIONS:** 405 Freeway, exit Santa Monica Boulevard east.

**AMENITIES:** Gorgeous Floor to Ceiling Windows, Large Private Terrace Overlooking Beverly Hills, Banking, Car Wash/Auto Detailing, & Valet Parking On-site.

**POINTS OF INTEREST:** 2-Hr. Free City Parking Next Door & Walking Distance to Rodeo Drive. Banks, Health Clubs, Hotels, Restaurants, Coffee Shops & World-Class Shopping Nearby.