

# FOR LEASE MARKET/DRUG ANCHORED CENTER RARE RETAIL SPACE IN CLOSEST CENTER TO CAL POLY



844 Foothill Blvd | San Luis Obispo, CA

- Rare retail space available at Highway 1 (Santa Rosa) & Foothill Road
- Closest Shopping Center to Cal Poly, San Luis Obispo
- Market/Drug Anchored Shopping Center
- Spaces rarely available in this center

Chris Garner  
805.928.2800 ext. 104  
CGarner@PacificaCRE.com  
Lic #01010310



PO Box 250 | Santa Maria, CA 93456 | [PacificaCommercialRealty.com](http://PacificaCommercialRealty.com)

Information contained herein has been obtained from the owner of the property or from other sources deemed reliable. We have no reason to doubt its accuracy, but we do not guarantee it.



# FOR LEASE 844 FOOTHILL BLVD. | SAN LUIS OBISPO, CA



## PROPERTY AND LEASE DETAILS

Lease Price	\$4.00/SF, NNN
Zoning	C-R-S (Many Allowed Uses)
Square Feet	Approximately 1,208 SF
Notes	A rare opportunity to lease a high-exposure retail space near Cal Poly. Ample onsite parking.

Chris Garner  
805.928.2800 ext. 104  
CGarner@PacificaCRE.com  
Lic #01010310



PO Box 250 | Santa Maria, CA 93456 | [PacificaCommercialRealty.com](http://PacificaCommercialRealty.com)

Information contained herein has been obtained from the owner of the property or from other sources deemed reliable. We have no reason to doubt its accuracy, but we do not guarantee it.



# FOR LEASE 844 FOOTHILL BLVD. | SAN LUIS OBISPO, CA



Chris Garner  
805.928.2800 ext. 104  
CGarner@PacificaCRE.com  
Lic #01010310



PO Box 250 | Santa Maria, CA 93456 | [PacificaCommercialRealty.com](http://PacificaCommercialRealty.com)

Information contained herein has been obtained from the owner of the property or from other sources deemed reliable. We have no reason to doubt its accuracy, but we do not guarantee it.



# FOR LEASE 844 FOOTHILL BLVD. | SAN LUIS OBISPO, CA

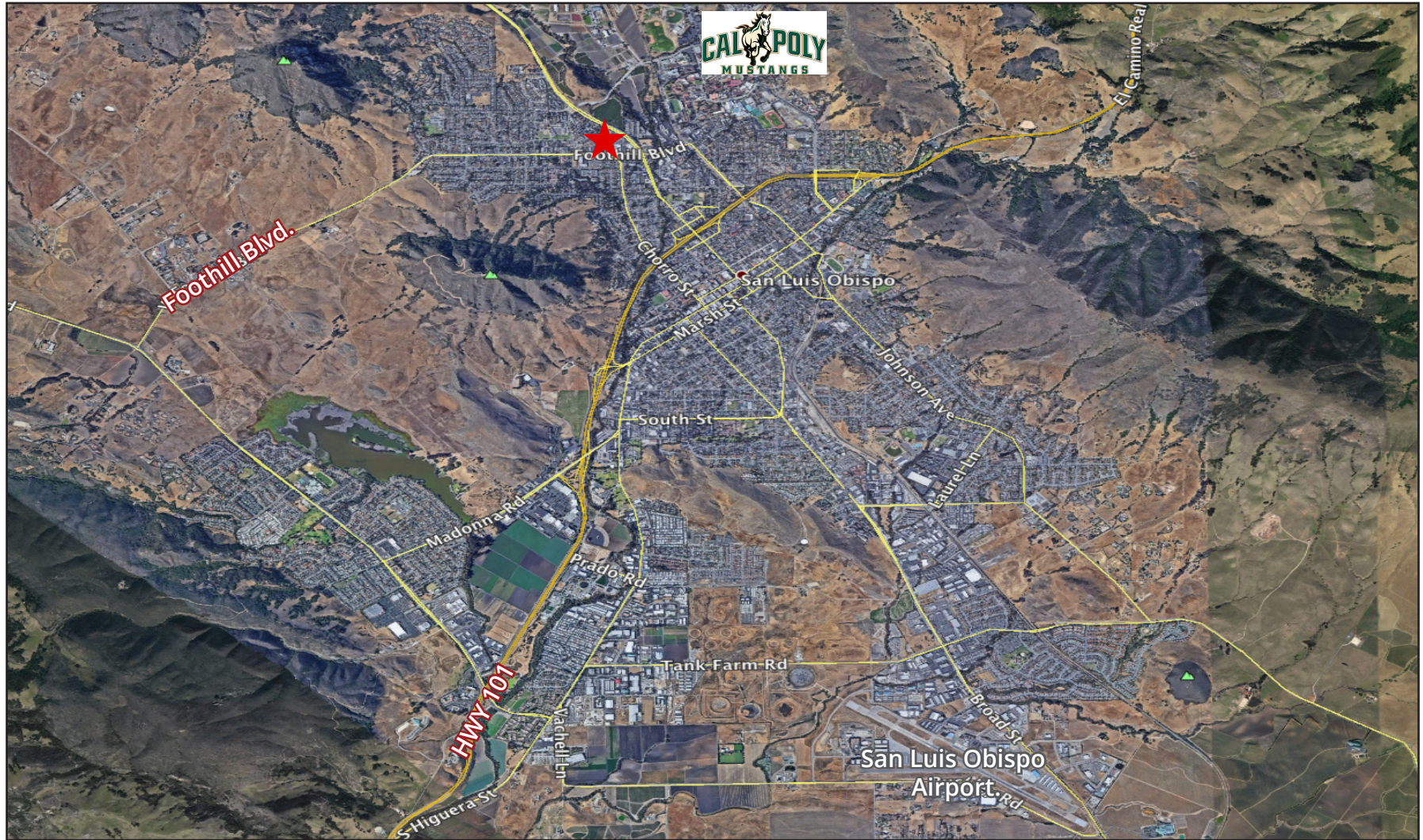

Chris Garner  
805.928.2800 ext. 104  
CGarner@PacificaCRE.com  
Lic #01010310



PO Box 250 | Santa Maria, CA 93456 | [PacificaCommercialRealty.com](http://PacificaCommercialRealty.com)

Information contained herein has been obtained from the owner of the property or from other sources deemed reliable. We have no reason to doubt its accuracy, but we do not guarantee it.



# FOR LEASE 844 FOOTHILL BLVD. | SAN LUIS OBISPO, CA

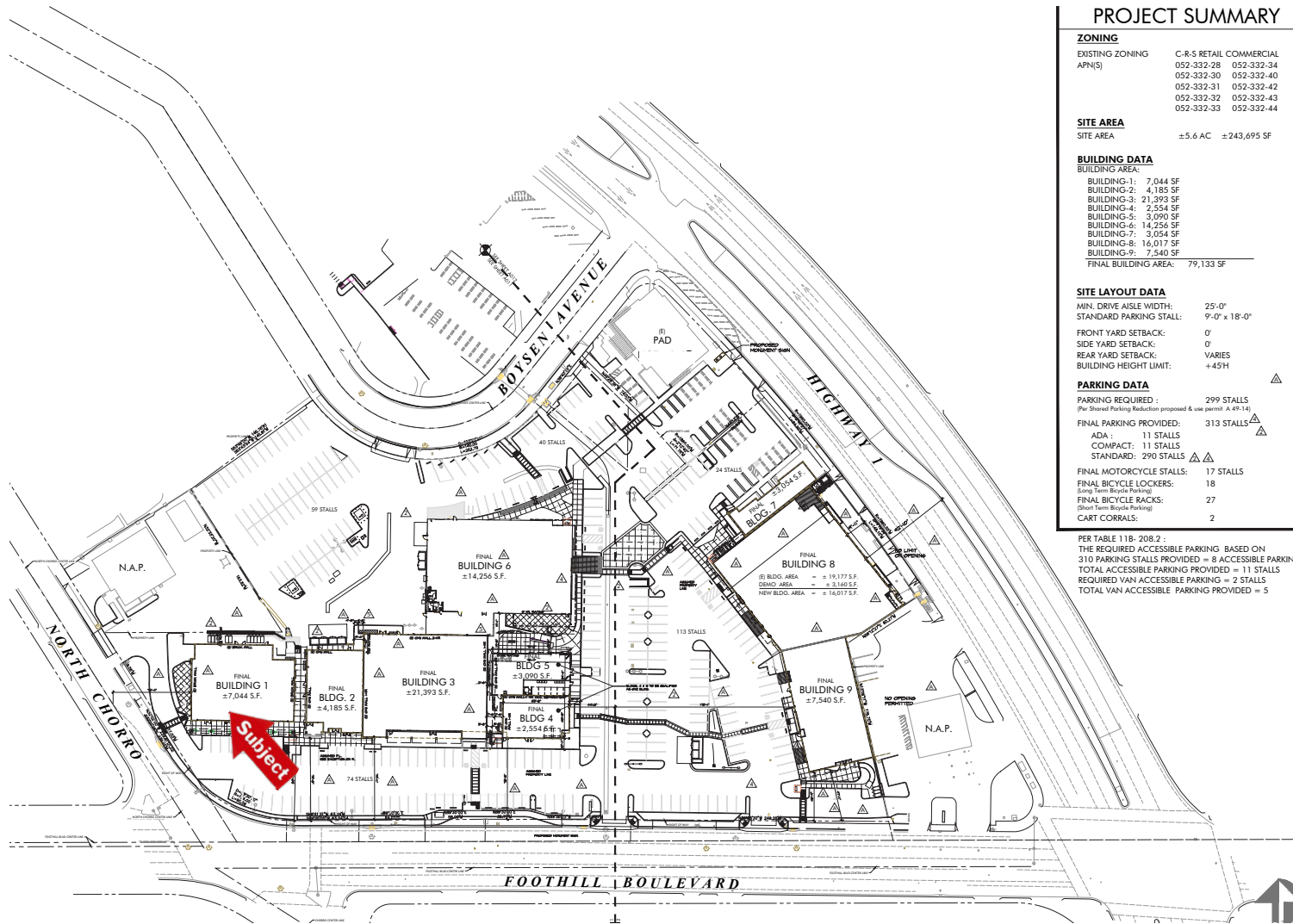

## PROJECT SUMMARY

### ZONING

EXISTING ZONING	C-R-S RETAIL COMMERCIAL
APN(S)	052-332-28 052-332-34 052-332-30 052-332-40 052-332-31 052-332-42 052-332-32 052-332-43 052-332-33 052-332-44

### SITE AREA

SITE AREA	±5.6 AC ±243,695 SF
-----------	---------------------

### BUILDING DATA

BUILDING AREA:	
BUILDING-1:	7,044 SF
BUILDING-2:	4,185 SF
BUILDING-3:	21,393 SF
BUILDING-4:	2,554 SF
BUILDING-5:	3,090 SF
BUILDING-6:	14,256 SF
BUILDING-7:	3,054 SF
BUILDING-8:	16,017 SF
BUILDING-9:	7,540 SF
FINAL BUILDING AREA:	79,133 SF

### SITE LAYOUT DATA

MIN. DRIVE AISLE WIDTH:	25'-0"
STANDARD PARKING STALL:	9'-0" x 18'-0"
FRONT YARD SETBACK:	0'
SIDE YARD SETBACK:	0'
REAR YARD SETBACK:	VARIES
BUILDING HEIGHT LIMIT:	+45H

### PARKING DATA

PARKING REQUIRED :	299 STALLS
(Per Shared Parking Reduction proposed & use permit A 49-14)	
FINAL PARKING PROVIDED:	313 STALLS
ADA :	11 STALLS
COMPACT:	11 STALLS
STANDARD:	290 STALLS
FINAL MOTORCYCLE STALLS:	17 STALLS
FINAL BICYCLE LOCKERS:	18
FINAL BICYCLE RACKS:	27
(Short Term Bicycle Parking)	
CART CORRALES:	2

PER TABLE 11B-208.2 :  
 THE REQUIRED ACCESSIBLE PARKING BASED ON  
 310 PARKING STALLS PROVIDED = 8 ACCESSIBLE PARKING  
 TOTAL ACCESSIBLE PARKING PROVIDED = 11 STALLS  
 REQUIRED VAN ACCESSIBLE PARKING = 2 STALLS  
 TOTAL VAN ACCESSIBLE PARKING PROVIDED = 5

Chris Garner

805.928.2800 ext. 104

CGarner@PacificaCRE.com

Lic #01010310



PO Box 250 | Santa Maria, CA 93456 | PacificaCommercialRealty.com

Information contained herein has been obtained from the owner of the property or from other sources deemed reliable. We have no reason to doubt the accuracy, but we do not guarantee it.