



13904 MARYTON AVE
SANTA FE SPRINGS, CA

Property Highlights

- ±21,632 sq. ft. that is Part of a Larger 46,368 sq. ft. Building
- ±1,464 sq. ft. of Offices
- 2 Dock High Loading Positions
- 18' Clear Height
- 1,000 Amps, 277/480 Volts, 3 Phase
- Large Private Fenced Yard – Approximately 8,500 sq. ft.
- .27/3,000 GPM Fire Sprinkler System
- Warehouse and Office LED Lighting
- Major Building Renovations Completed
- Quick Access to the 5,91, 105 and 605 freeways
- Excellent Santa Fe Springs Location
- Available Now
- \$1.42 per sq. ft. Gross
- Opex \$0.0377

SITE MAP

Secured Yard

± 21,806 Sq. Ft.
Building

Maryton Ave



COMMERCIAL BROKERAGE

16700 Valley View Avenue, Suite 270 | La Mirada, CA 90638

Incocommercialbrokerage.com

SITE PLAN

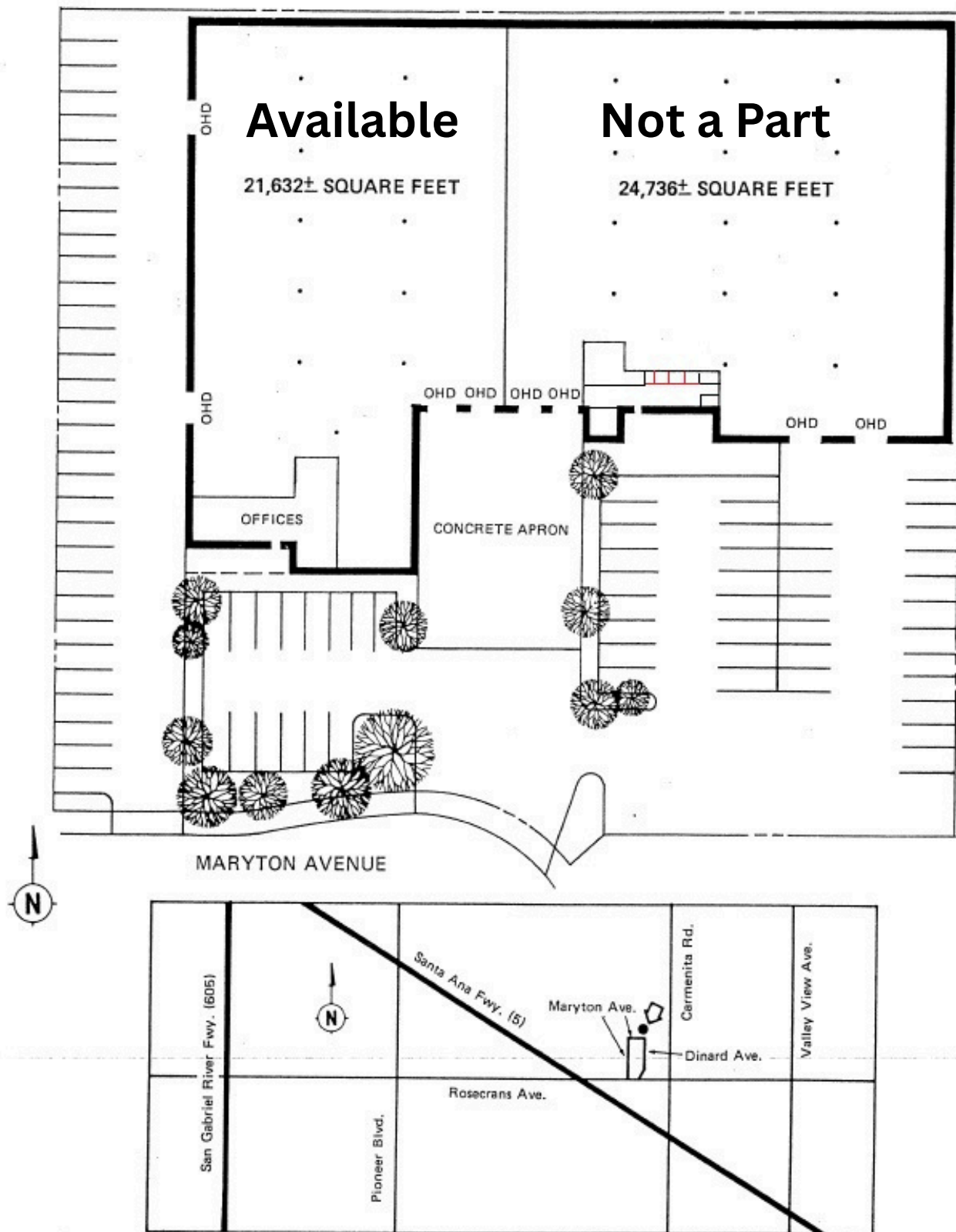

COMMERCIAL BROKERAGE

16700 Valley View Avenue, Suite 270 | La Mirada, CA 90638

Incocommercialbrokerage.com



COMMERCIAL BROKERAGE

16700 Valley View Avenue, Suite 270 | La Mirada, CA 90638

Incocommercialbrokerage.com

FOR MORE INFORMATION OR TO SCHEDULE A TOUR, PLEASE CONTACT:

BRANDON COURTNEY

VICE PRESIDENT
LIC. 02241945

✉ BRANDON@INCOCOMMERCIALBROKERAGE.COM
☎ (714) 521-0800 X. 4

KEVIN ROMANO

PRINCIPAL
LIC. 02025562

✉ KEVIN@INCOCOMMERCIALBROKERAGE.COM
☎ (714) 521-0800 X. 2

BRUCE ROMANO

PRINCIPAL
LIC. 00702877

✉ BROMANO@PACBELL.NET
☎ (714) 521-0800 X. 3



COMMERCIAL BROKERAGE

16700 Valley View Avenue, Suite 270 | La Mirada, CA 90638

Incocommercialbrokerage.com