

**FOR LEASE**  
INDUSTRIAL PROPERTY



# 25 WAREHAM STREET, MIDDLEBORO

25 WAREHAM ST, MIDDLEBORO, MA 02346

**DAVE ELLIS, SIOR**

781.919.0800 X701  
dave@ellisrealtyadvisors.com

**KERRICK PIERCE**

781.919.0800 X710  
kperce@ellisrealtyadvisors.com

*For More Information*



# 25 WAREHAM STREET, MIDDLEBORO



## PROPERTY DESCRIPTION

Various sized commercial spaces and contractor yard space available for lease. Please call for more information!

## PROPERTY HIGHLIGHTS

- Industrial Warehouse or Manufacturing Space
- 3 Ton Bridge Crane
- 800Amp @ 480V 3P Power
- 4 Grade-level overhead doors
- Close Proximity to I-495 and Route 44
- Walking Distance to Middleborough/Lakeville MBTA

## OFFERING SUMMARY

Lease Rate:	\$2,000 - 16,500 per month (MG)
Number of Units:	42
Available SF:	120 - 14,625 SF
Lot Size:	2.99 Acres
Building Size:	74,474 SF

DEMOGRAPHICS	1 MILE	3 MILES	5 MILES
Total Households	2,356	6,871	11,911
Total Population	5,640	17,000	31,564
Average HH Income	\$94,514	\$111,761	\$123,602



**DAVE ELLIS, SIOR**

781.919.0800 x701  
dave@ellisrealtyadvisors.com

**KERRICK PIERCE**

781.919.0800 x710  
kpierce@ellisrealtyadvisors.com



# 25 WAREHAM STREET, MIDDLEBORO

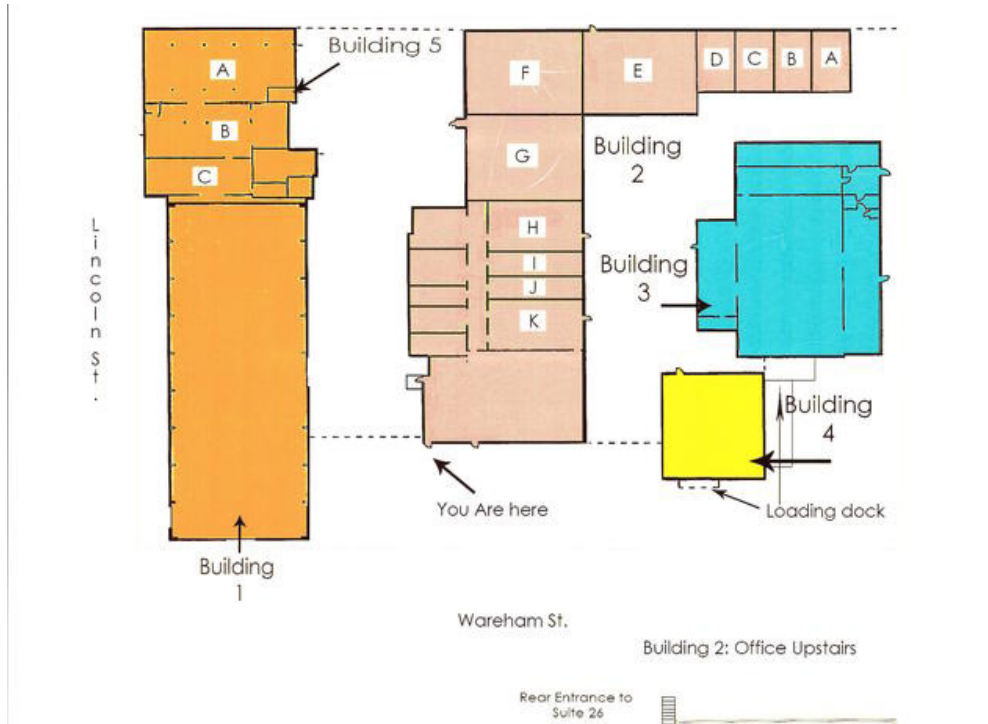

## LEASE INFORMATION

Lease Type:	MG	Lease Term:	Negotiable
Total Space:	1,250 - 14,850 SF	Lease Rate:	\$2,000 - \$16,500 per month

## AVAILABLE SPACES

SUITE	TENANT	SIZE (SF)	LEASE TYPE	LEASE RATE	DESCRIPTION
Building 1	Available	14,850 SF	Modified Gross	\$16,500 per month	-
Building 5, Unit B	Available	2,500 SF	Modified Gross	\$3,000 per month	-
3B	Available	2,500 SF	Modified Gross	\$3,000 per month	-
3F	Available	1,250 SF	Modified Gross	\$2,000 per month	-

# 25 WAREHAM STREET, MIDDLEBORO



## Logistical Details

 ----- 5 Minute Drive Via Everett Street

 ----- 3 Minute Drive Via Main Street

# 25 WAREHAM STREET, MIDDLEBORO

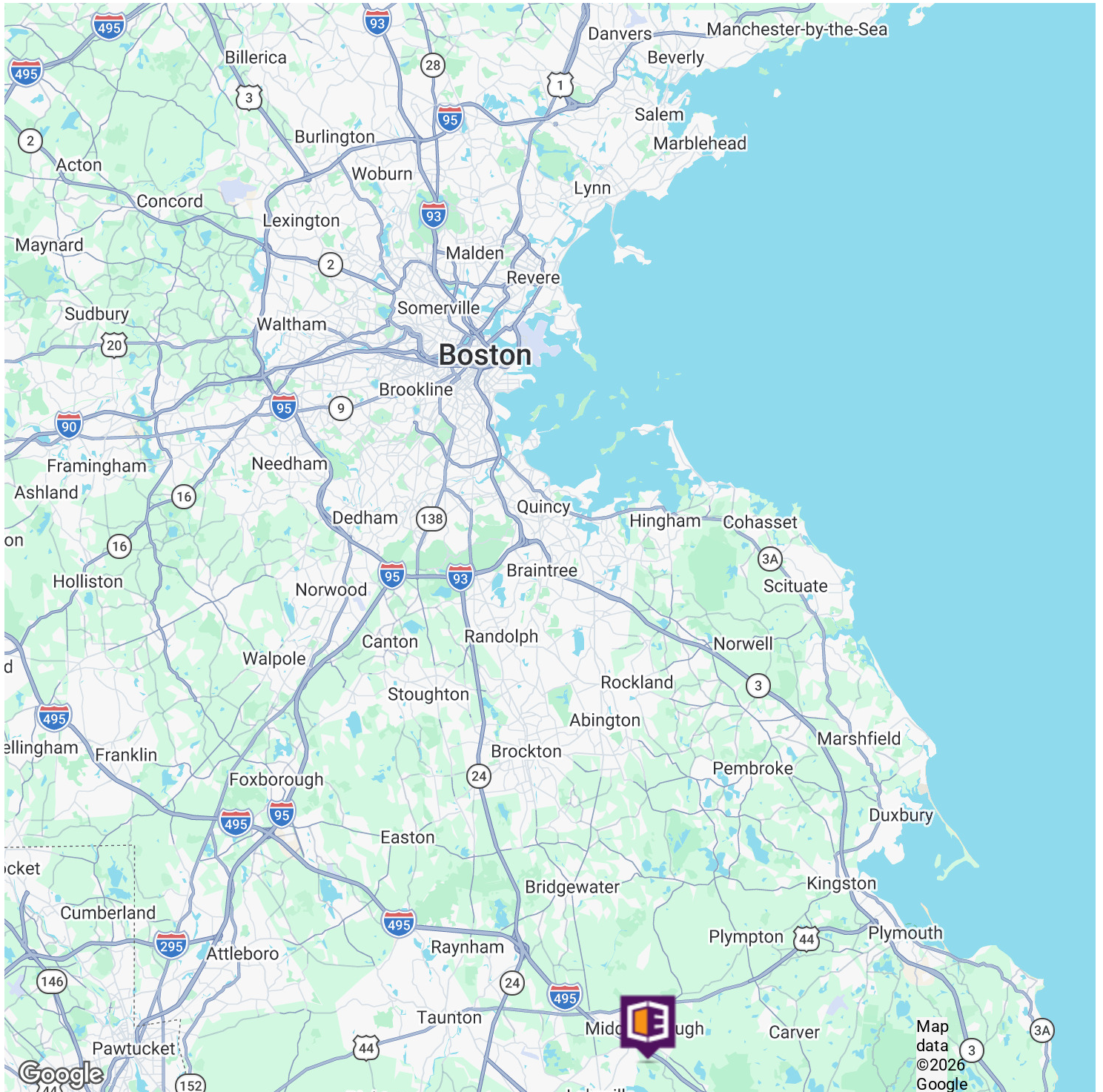

**DAVE ELLIS, SIOR**  
781.919.0800 x701  
dave@ellisrealtyadvisors.com

**KERRICK PIERCE**  
781.919.0800 x710  
kpierce@ellisrealtyadvisors.com