

REVISIONS			
DATE	BY	LIC. NO.	COMMENTS
9/15/09	JAM	29918	
6/15/10	JAM	29918	
7/12/10	JAM	29918	
1/3/11	JAM	29918	
4/5/12	JAM	29918	
6/12/13	JAM	29918	
12/16/13	JAM	29918	
07/09/14	JAM	29918	
REVISIONS			
DATE	BY	LIC. NO.	COMMENTS
08/21/14	JAM	29918	
12/18/14	JAM	29918	
1/2/15	JAM	29918	
12/3/15	JAM	29918	
1/25/16	JAM	29918	
10/13/16	JAM	29918	
7/14/17	JAM	29918	
3/2/18	JAM	29918	
REVISIONS			
DATE	BY	LIC. NO.	COMMENTS
9/20/18	JAM	29918	

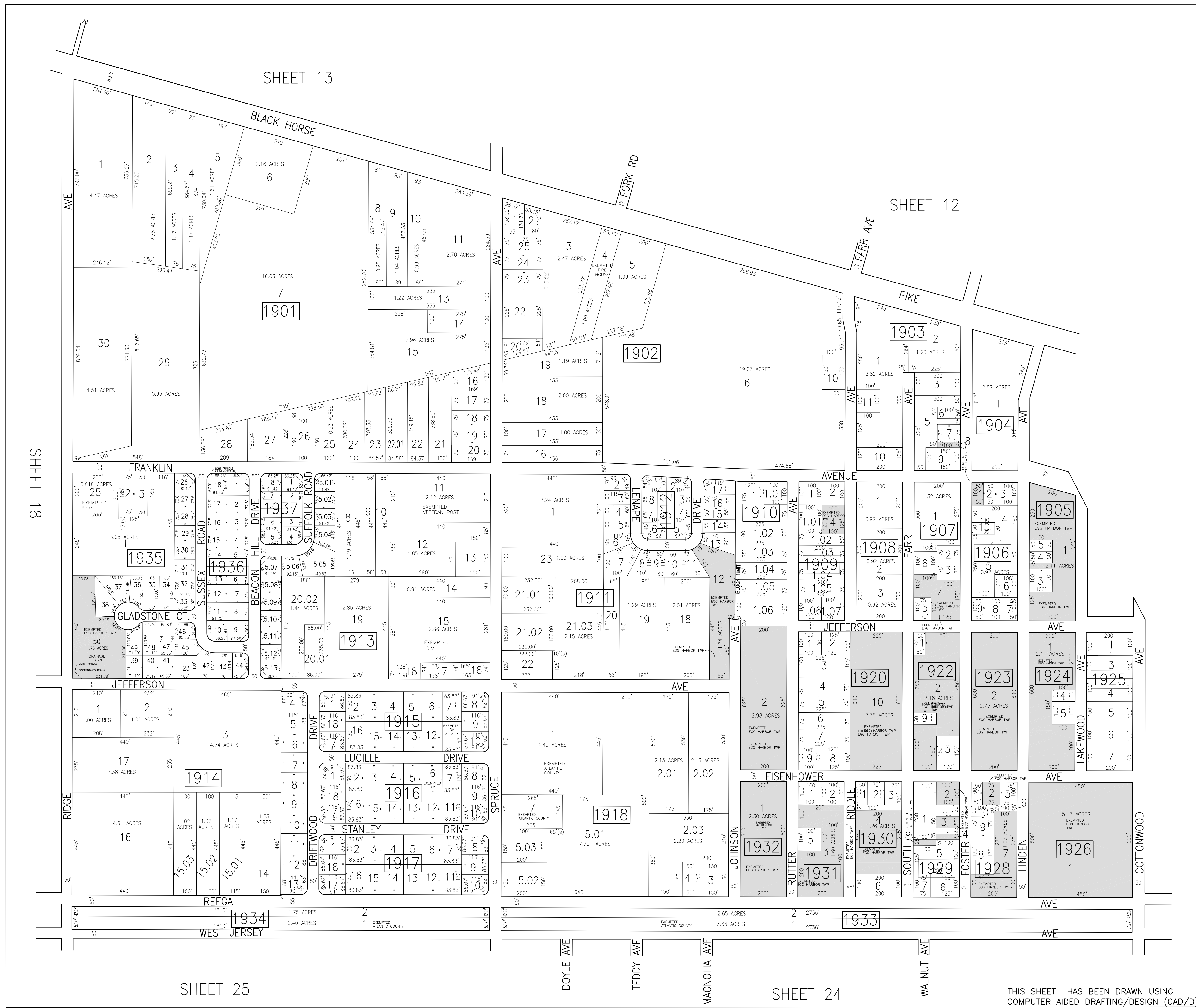
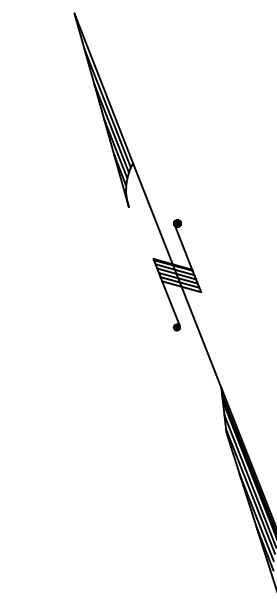

SHADED AREAS INDICATE
EGG HARBOR TOWNSHIP
EXEMPTED PROPERTY

TAX MAP
TOWNSHIP OF EGG HARBOR
ATLANTIC COUNTY, NEW JERSEY
SCALE: 1"=200'
JANUARY 2010
JAMES A. MOTT, PE, PLS
PROFESSIONAL ENGINEER & LAND SURVEYOR
NEW JERSEY LICENSE NO. 29918
3122 FIRE ROAD
EGG HARBOR TOWNSHIP, NJ 08234