

FOR SALE  
BUILT TO SUIT

# 7.1 ACRES AT PEARL & BOSTON | STRONGSVILLE LARGE HARD CORNER SITE AVAILABLE

PEARL ROAD & BOSTON ROAD, STRONGSVILLE, OH 44149



*For Sale Price:*  
**\$1,800,000**

Joseph Khouri  
First Vice President  
+1 216 658 6120  
joseph.khouri@cbre.com

CBRE, Inc.  
950 Main Avenue, Suite 200  
Cleveland, OH 44113  
+1 216 687 1800

**CBRE**

# PEARL & BOSTON LAND PARCEL

LOCATED AT HARD CORNER, SIGNALIZED INTERSECTION AT  
BORDER OF STRONGSVILLE AND BRUNSWICK

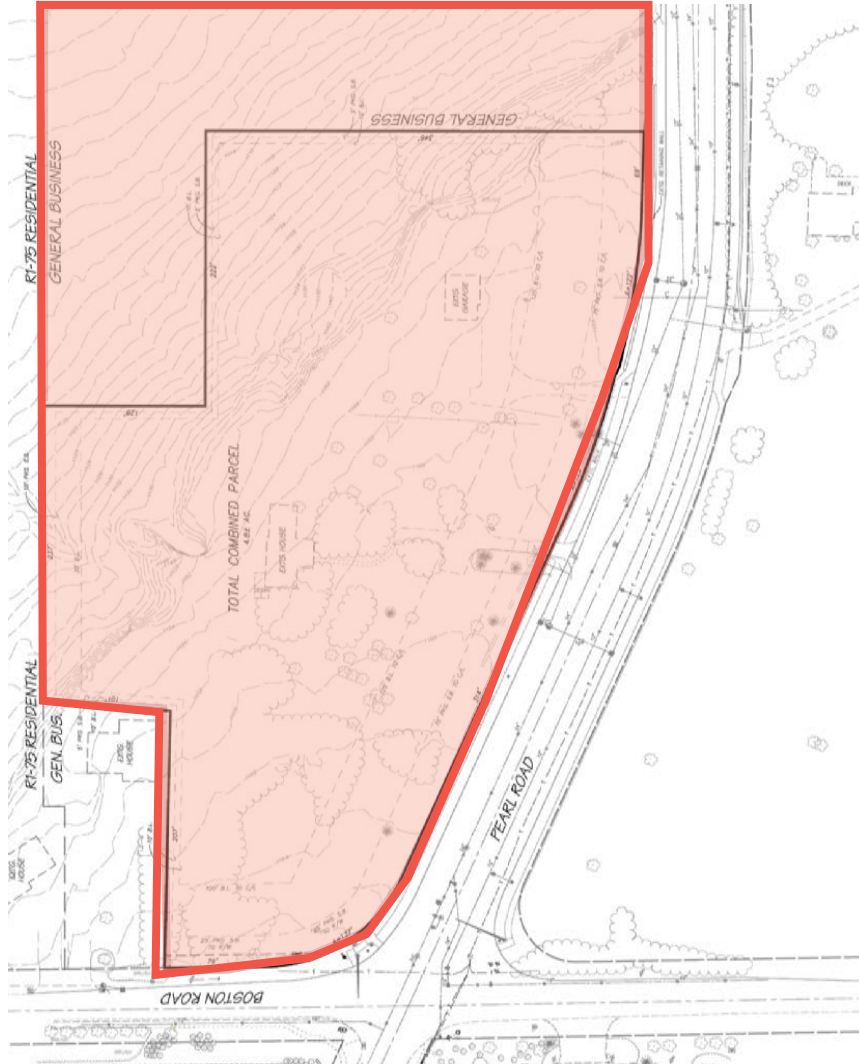

## PROPERTY HIGHLIGHTS

Located on the NW corner of Pearl Road & Boston Road

---

Total Parcel Size: ±7.1 Acres

---

Parcel Numbers:  
39432004, 39432010, 39432017, 39432011, 39431007

---

Zoned: General Business

---

776' frontage on Pearl Road

---

Sale Price: \$1,800,000  
OR OWNER WILL BUILD TO SUIT

---

Excellent Demographics:  
Household Income of \$112,125 in a 1 mile radius

---

High Visibility with optimal access

---

Hard corner, signalized intersection land site

---

# PEARL & BOSTON LAND PARCEL

LOCATED AT HARD CORNER, SIGNALIZED INTERSECTION AT  
BORDER OF STRONGSVILLE AND BRUNSWICK

**NEW!**  
AVENUE AT STRONGSVILLE CARE  
AND REHABILITATION CENTER

**11.7 AC  
UNDER  
CONTRACT**

**ENCOMPASS  
HEALTH**



Pearl Crossing  
Assisted Living

**7.1 AC  
AVAILABLE**

**\*LAND NOT AVAILABLE  
FOR DEVELOPMENT**

**BOSTON RD  
5,893 VPD**

**PEARL RD  
13,668 VPD**

**14,316 VPD**



# MARKET OVERVIEW



18,850 VPD

33,338 VPD

23,693 VPD

## SOUTHPARK MALL

- Dillard's
- macy's
- sears
- JCPenney
- WILLIAMS-SONOMA
- H&M
- KOHL'S
- EVERY SEASON STARTS AT DICK'S SPORTING GOODS
- CINEMARK CENTURY THEATRES
- BAM! BOOKS-A-MILLION
- CHIPOTLE
- Panera
- HOULIHAN'S
- Red Lobster
- Macaroni GRILL
- Biya
- Applebee's
- OfficeMax
- LONGHORN

6 AC RECENTLY SOLD UNDER CONSTRUCTION

UNDER CONTRACT

7.1 AC AVAILABLE

### NEW RETAILERS TO THE MARKET

- HomeGoods
- HAND & STONE MASSAGE AND FACIAL SPA
- Bank of America
- Swensons DRIVE-IN
- OUTBACK STEAKHOUSE
- City BARBECUE
- tropical CAFE SMOOTHIE
- BURGER KING
- PEACE LOVE & LITTLE ACORNS

# MARKET SNAPSHOT

STRONGSVILLE, OHIO | CUYAHOGA COUNTY  
15 MILES SOUTH OF CLEVELAND



## BUSINESSES

(5 Miles)

- ±3.6 MSF of Office Space\*
- ±15.3 MSF of Industrial Space\*
- ±9.3 MSF of Retail Space\*
- 4,399 Businesses

\*CoStar



## STRENGTHS

- Fifth largest suburb in Cuyahoga County
- High retail occupancy rate
- Four office parks within the area employing about 9,000 people
- Two highway interchanges



## HEALTHCARE

- Cleveland Clinic Family Health & Surgery Center
- Southwest General Strongsville Medical Center



## TRAFFIC GENERATORS

- SouthPark Mall
- Strongsville Recreation Center



## SCHOOLS

- Strongsville School District: ±5,500 Students
- Performance Index: 81.9%; 101st in Ohio
- Polaris Career Center: 905 Students

## DEMOGRAPHICS

		1 Mile Radius	3 Mile Radius	5 Mile Radius
POPULATION	2021 Population - Current Year Estimate	9,790	58,921	103,513
	2026 Population - Five Year Projection	9,960	59,696	104,601
	2021 Employees	1,500	20,256	37,983
	2021 Daytime Population	8,100	52,268	93,542
	2021 Median Age	42.0	43.1	43.9
HOUSEHOLDS	2021 Households - Current Year Estimate	3,686	22,379	41,028
	2026 Households - Five Year Projection	3,771	22,769	41,614
	2021 Average Household Size	2.65	2.62	2.51
INCOME	2021 Average Household Income	\$112,125	\$103,681	\$101,228
	2026 Average Household Income Projection	\$122,166	\$114,375	\$111,981
	2021 Median Household Income	\$86,146	\$84,289	\$79,744
	2021 Per Capita Income	\$42,046	\$39,254	\$40,062
HOUSING	2021 Housing Units	3,600	22,718	42,225
	2021 Owner Occupied Housing Units	2,961	18,737	32,424
	2021 Median Value of Owner Occ. Housing Units	\$248,337	\$226,208	\$231,767
	2021 Average Value of Owner Occ. Housing Units	\$281,182	\$242,934	\$254,804

# *STRONGSVILLE PEARL ROAD - LAND SITE*

*7.1 ACRES*

*FOR SALE PRICE: \$1,800,000*

PEARL ROAD AND BOSTON ROAD, STRONGSVILLE, OH 44149

## PLEASE CONTACT:

**Joseph Khouri**

First Vice President

+1 216 658 6120

joseph.khouri@cbre.com

**CBRE, Inc.**

950 Main Avenue, Suite 200

Cleveland, OH 44113

+1 216 687 1800

© 2021 CBRE, Inc. All rights reserved. This information has been obtained from sources believed reliable, but has not been verified for accuracy or completeness. You should conduct a careful, independent investigation of the property and verify all information. Any reliance on this information is solely at your own risk. CBRE and the CBRE logo are service marks of CBRE, Inc. All other marks displayed on this document are the property of their respective owners, and the use of such logos does not imply any affiliation with or endorsement of CBRE. Photos herein are the property of their respective owners. Use of these images without the express written consent of the owner is prohibited.

