



DANIEL MUELLER

Executive Director
916 704 9341
1555 River Park Dr. Ste. 109
Sacramento, CA 95815
dmueller@muellercommercial.com
Cal DRE# 01829919

CAMERON FREELOVE

Director
916 613 3899
1555 River Park Dr. Ste. 109
Sacramento, CA 95815
cfreelove@muellercommercial.com
Cal DRE# 02092307

CENTURY 21

Select Real Estate, Inc.



AVAILABLE
FOR LEASE

3017 - 3039 KILGORE RD.

RANCHO CORDOVA, CA 95670

-/+ 1,826 TO +/- 8,765 SF

KILGORE RD.

+/-7,000 VPD

TURN-KEY & CUSTOMIZABLE FLEX SUITES WITH MULTIPLE ROLL-UP DOORS

THE PROPERTY

3017 - 3039 KILGORE RD. RANCHO CORDOVA, CA 95670

REGION AVAILABILITY ZONING OPPORTUNITY PRICING

				
RANCHO CORDOVA	-/+ 1,826 TO -/+ 8,765 SF	OMIU	WAREHOUSE FLEX SPACE HVAC DISTRIBUTED	\$1.00 + NNN

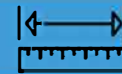

3017 Kilgore Ste. 100 +/-6,226 SF

Perimeter offices, open floor plan, break room, HVAC distributed, and roll up door

*Can be combined to +/-8,765 SF.



3017 Kilgore Ste. 120 +/-2,539 SF

Flex suite with front offices, conditioned warehouse, and roll up door



3039 Kilgore Ste. 150 +/- 1,826 SF

Flex suite with front offices, conditioned warehouse, and roll up door

*Can be combined to +/-3,652 SF.



3039 Kilgore Ste. 170 +/-1,826 SF

Warehouse with roll up door

-  BANK OF AMERICA
-  BARCO
-  BEDROSIANS TILE & STONE
-  CISCO SYSTEMS
-  CORAM
-  CORELOGIC
-  COSTCO
-  DATACATE, INC
-  EBAY
-  FAIRFIELD INN & SUITES
-  FEDEX SHIP CENTER
-  GENWORTH FINANCIAL
-  GOLDEN STATE WATER COMPANY
-  GUIDED WAVE INC
-  HAMPTON INN
-  HEALTH COLLEGE
-  HEALTH NET
-  HEWLETT PACKARD
-  HYATT
-  KELLY-MOORE PAINTS
-  MAXIMUS
-  NATIONAL CAREER EDUCATION
-  NEC
-  PEARSON SCHOOLS
-  PROGRESSIVE INSURANCE
-  QUICK QUACK CAR WASH
-  R. C. HOSPICE CENTER
-  SPRINT
-  TRAVELERS INSURANCE
-  VERIZON
-  VOLCANO
-  WELLS FARGO
-  WELLS FARGO INSURANCE



FLOOR PLAN

3017-3039
KILGORE RD RANCHO CORDOVA

AVAILABLE

LEASED

3017 KILGORE RD - FOR LEASE

3039 KILGORE RD - FOR LEASE

SUITE 100
+/-6,226 SF

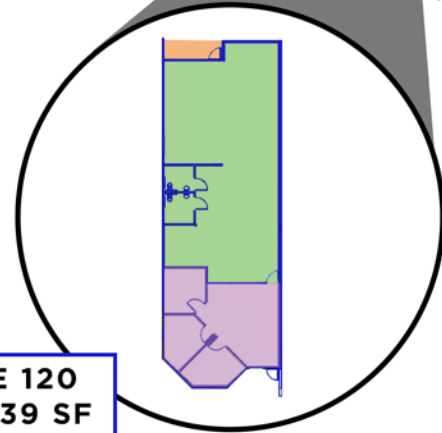
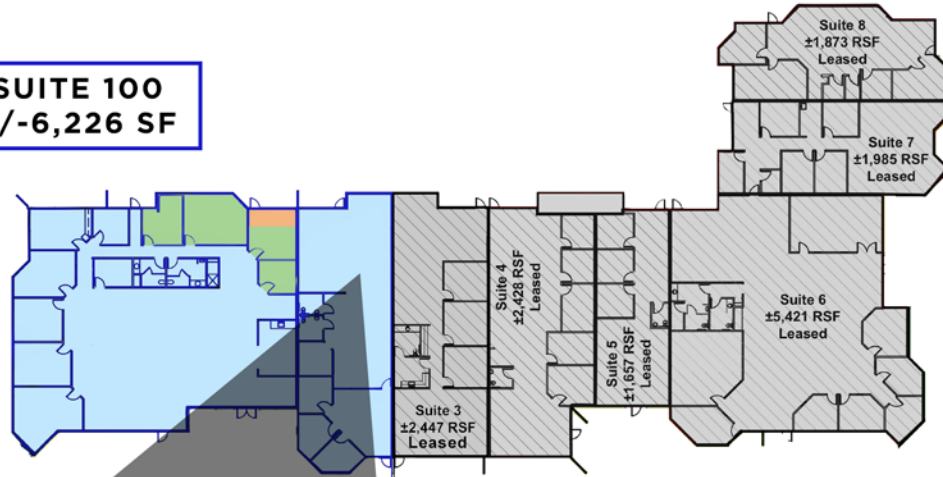

SUITE 120
+/-2,539 SF

SUITE 170
+/-1,826 SF

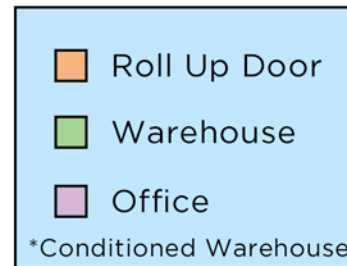
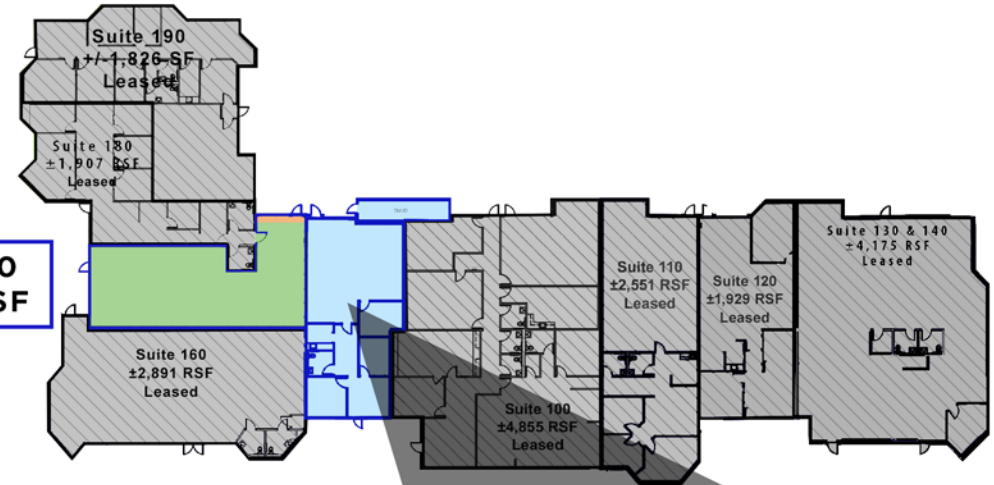

SUITE 150
+/-1,826 SF

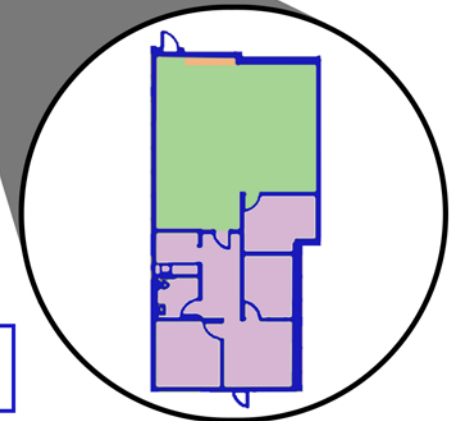

FLOOR PLAN

3017 KILGORE RD - **FOR LEASE**

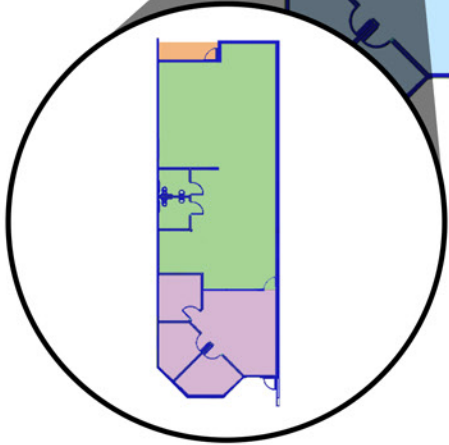
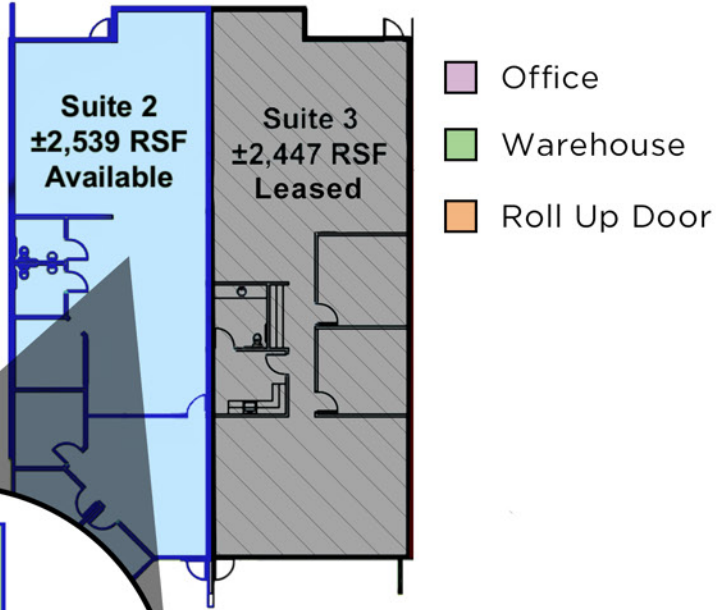

3017-3039
KILGORE RD RANCHO CORDOVA

DOWNTOWN DOVA PROJECT

3017-3039

KILGORE RD. RANCHO CORDOVA

Basic Facts & Scope

- The development is planned on approximately 28 acres of land near Kilgore Road
- It is a sports anchored, mixed use entertainment district aimed at creating a downtown feel in the city.

Key Components of the Project

- A 7,500 seat indoor arena (expandable to ~8,000 for concerts).
- Minimum of 640 housing units (up to 1,000 depending on market)
- At least two hotels with 800+ rooms combined.
- Retail and dining district covering ~145,000 squarefeet, plus a public plaza.
- Structured parking for over 3,600 vehicles.

Strategic Goals & Impacts

- Create a true downtown destination for Rancho Cordova.
- Fills a regional gap for midsize venues (6,000-10,000 seats).
- Projected 37,000 jobs created over 12 years.
- Estimated \$4.5 billion in economic output.

Timing, Phases & Status

- Arena groundbreaking targeted for early 2026.
- Arena opening projected for fall 2027.
- Residential, hotel, and retail phases to follow based on market demand.

Benefits & Considerations

- Drives job creation and tax base growth for Rancho Cordova.
- Adds new housing and amenities to the area.
- Enhances city identity and profile.



3017-3039
KILGORE RD. RANCHO CORDOVA



THE BUILDING

3017 - 3039 Kilgore Rd. in Rancho Cordova, CA are two flex buildings that are situated East of Zinfandel Dr. and West of Sunrise Blvd. with White Rock Rd. immediately South and HWY 50 due North. Each building consists of +/-27,239 SF, totaling +/-54,478 SF. 3017 Kilgore Rd. has +/-11,012 SF available of FLEX SPACE and 3039 Kilgore Rd. +/-9,358 SF available. Predominate features of these Flex buildings include multiple roll-up doors with open and a flexible layout for a multitude of users. Tenant's will have the benefit of utilizing the flexible

layout to their advantage to best suit their business needs. Additionally, tenants can benefit from the large parking field and multiple ingress and egress points for large vehicles, not far from Sunrise Blvd. & HWY 50. The buildings offer a grand centralized entrance surrounded by a well-maintained landscape with a clean parking lot that offers ample parking both in the front and rear of the buildings. A competitive lease rate, motivated ownership, a flexible layout, and well-maintained landscape and buildings make this a desirable location for tenancy.



CENTURY 21
COMMERCIAL REAL ESTATE

FOR LEASE





3017-3039
KILGORE RD. RANCHO CORDOVA

LEASED

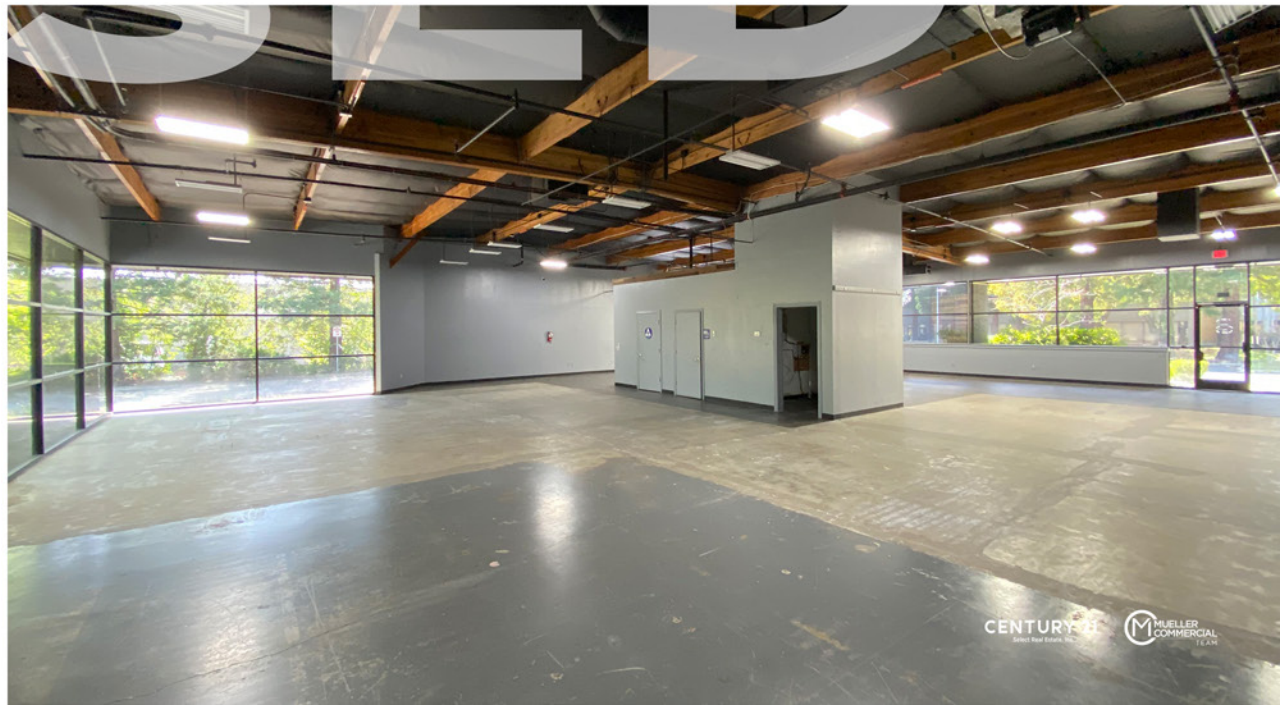

3039 KILGORE STE. 130-140 +/-4,125 SF





3017-3039

KILGORE RD. RANCHO CORDOVA



3039 KILGORE STE. 150 +/-1,826 SF



CENTURY 21
MUELLER COMMERCIAL TEAM





THE AREA

This expanding business district in Rancho Cordova, CA is surrounded by large office buildings, several local and national food amenities, and existing businesses of similar nature continue to draw expanding businesses and a working population to support the area's continuous growth. In 2019, Rancho Cordova saw a population of approximately 73,000 individuals with a median age of 34.5 and a medium household income of \$65,307. Population growth between 2018 - 2019 saw an increase of 1.51% and a household income growth of 3.3%. The largest universities in Rancho Cordova consists of InterCoast Colleges-Rancho Cordova, Chamberlain University-California, and Independent Training & Apprenticeship Program have awarded 219 degrees. The average property value in Rancho Cordova saw an increase from \$278,800 to \$299,800. The nearby intersection of Sunrise Blvd. and White Rock Rd. has an average daily traffic count of approximately 37,000 vehicles per day. An expanding educated working population that lives within the city limits create a desirable working environment for expanding or beginning business. It's proximity to HWY 50, Sunrise Blvd, Costco, Starbucks, and several other local and national food amenities makes 3017-3039 Kilgore a highly desirable location.

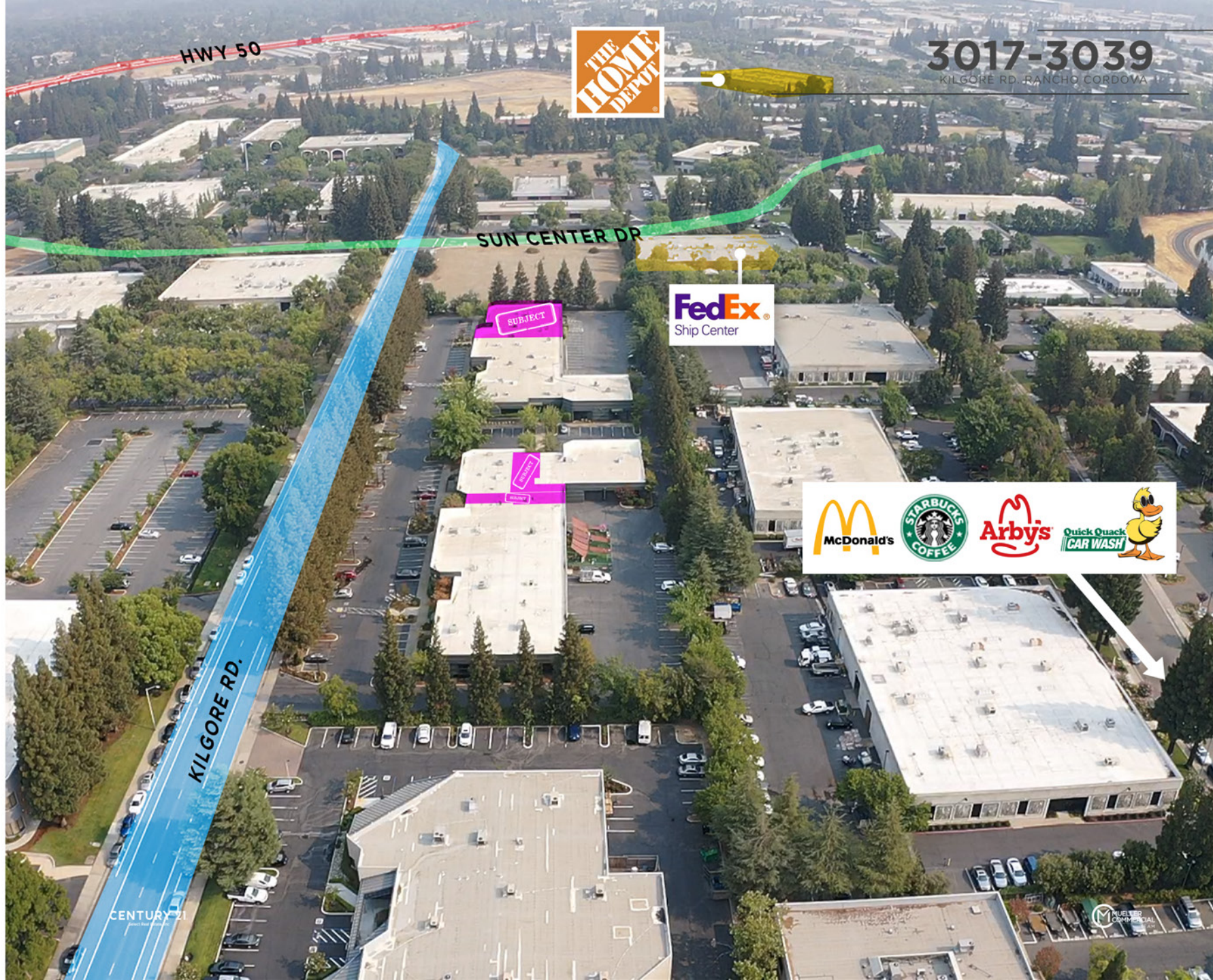

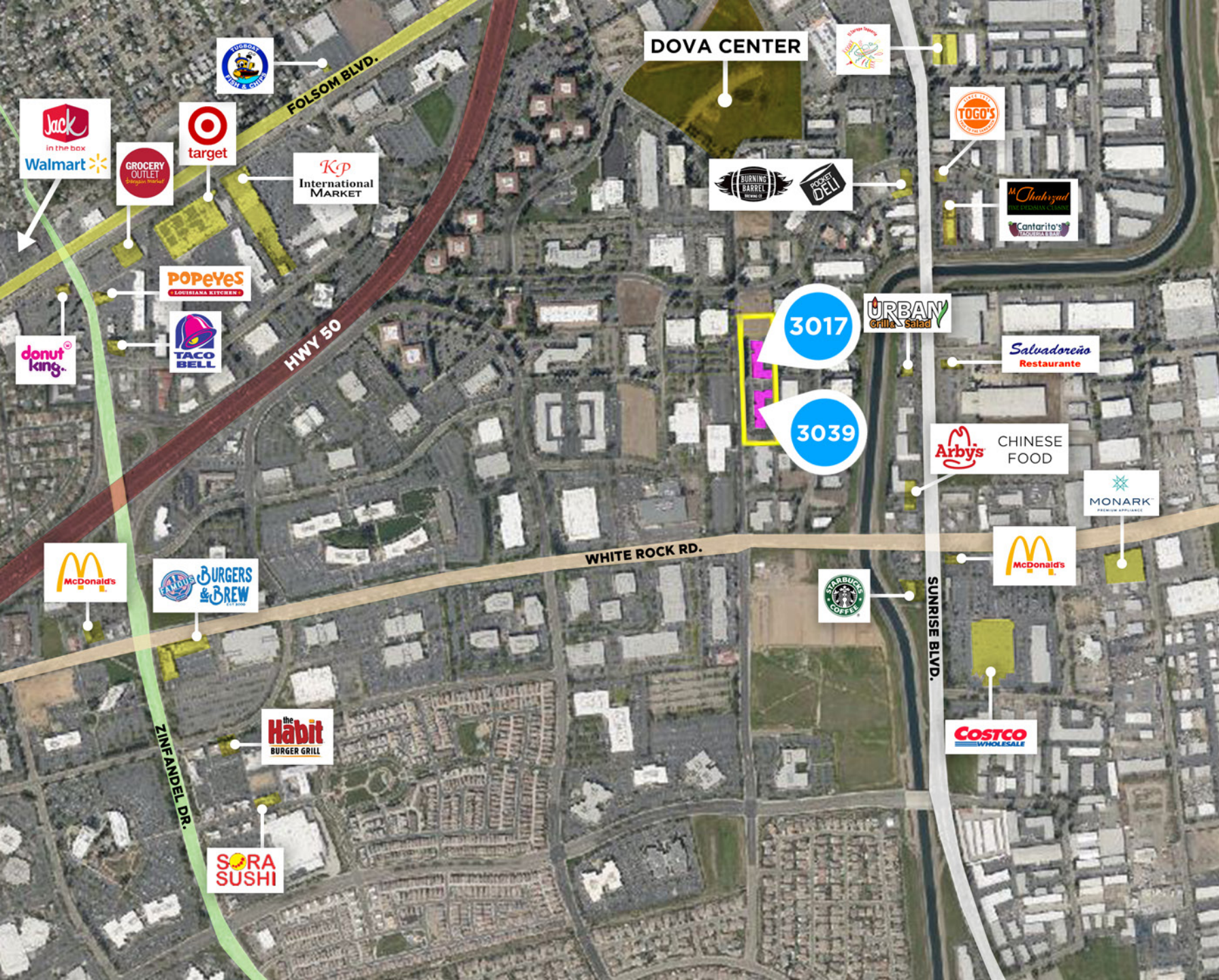

3017-3039

KILGORE RD. RANCHO CORDOVA



DEMOGRAPHICS I

Educational Attainment

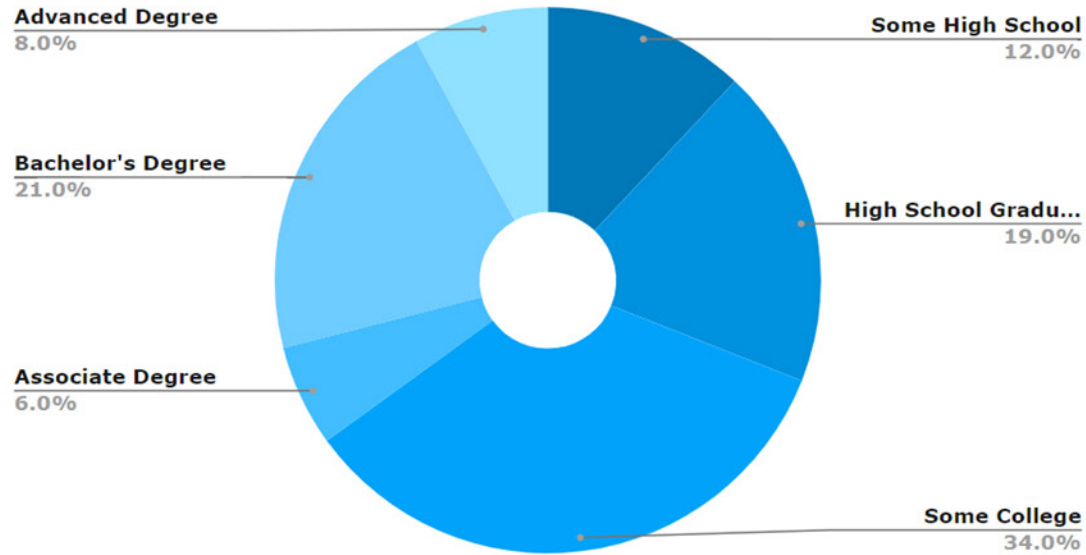

Monthly House Hold Income

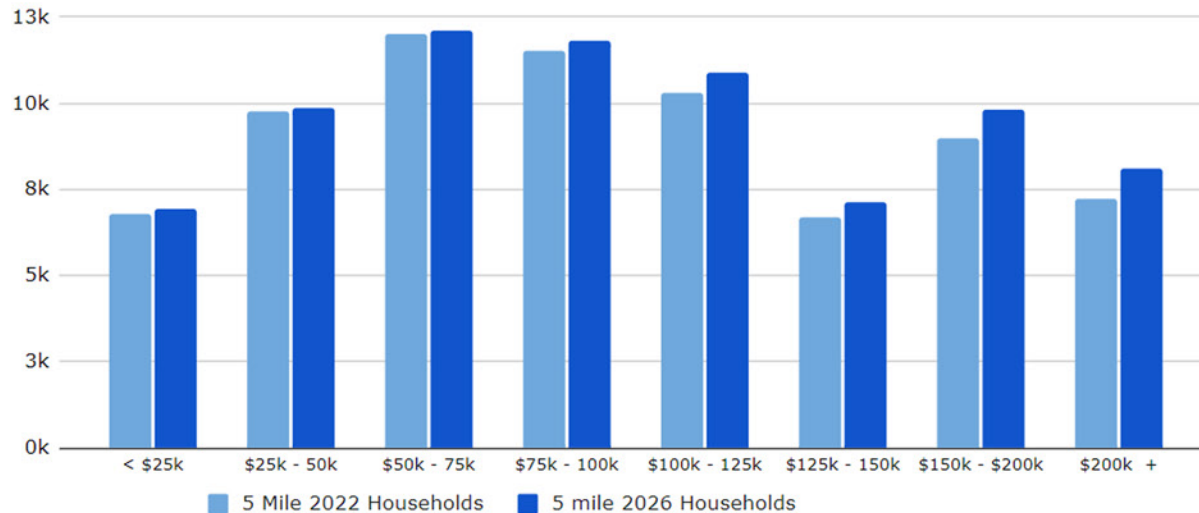

Homes Built by Year

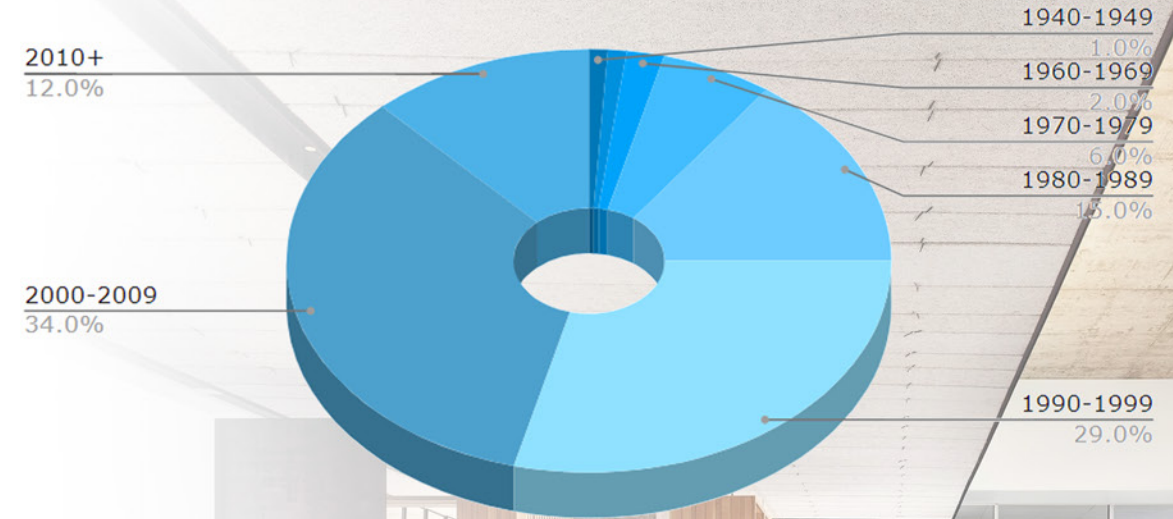

Housing Occupancy

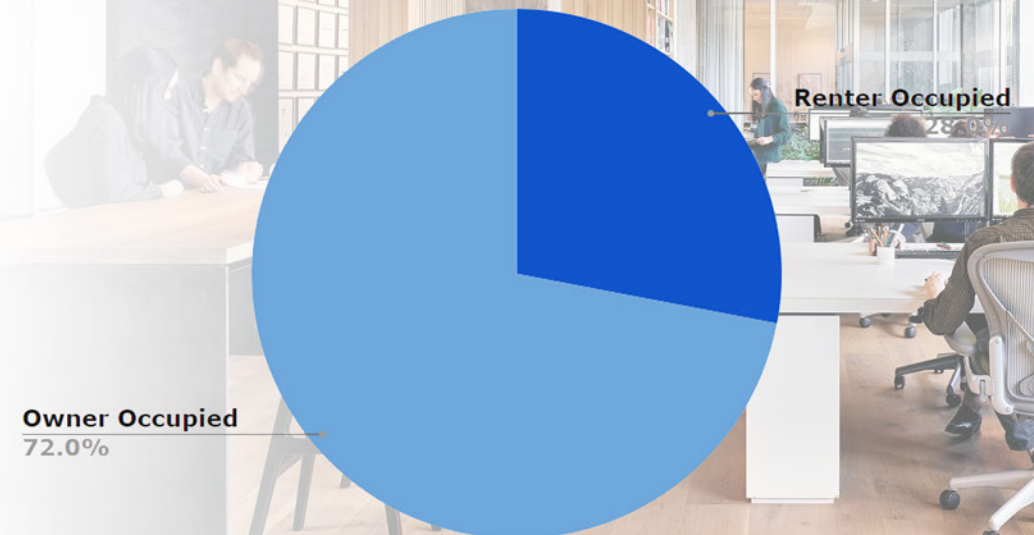

DEMOGRAPHICS II

Housing Type

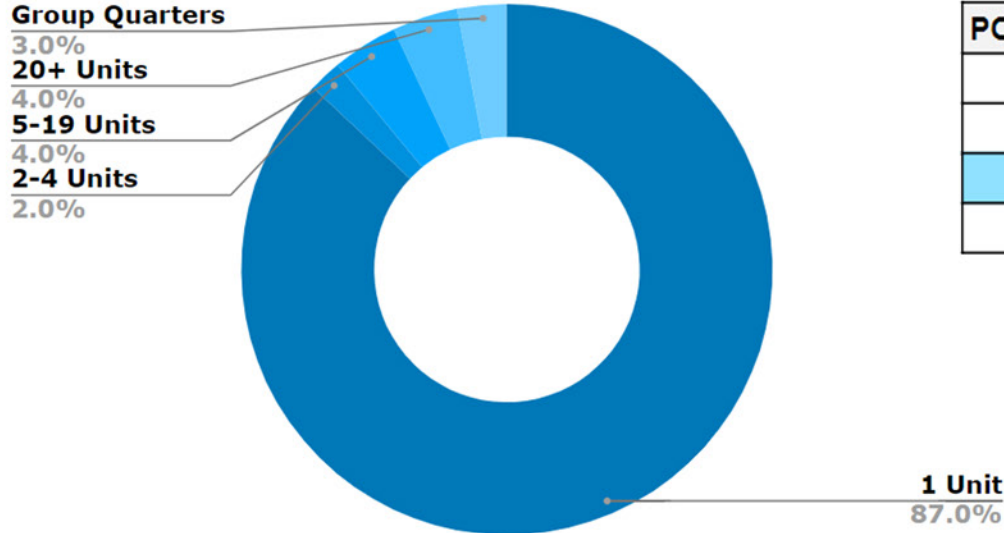

Per Capita & Avg. Household Spending

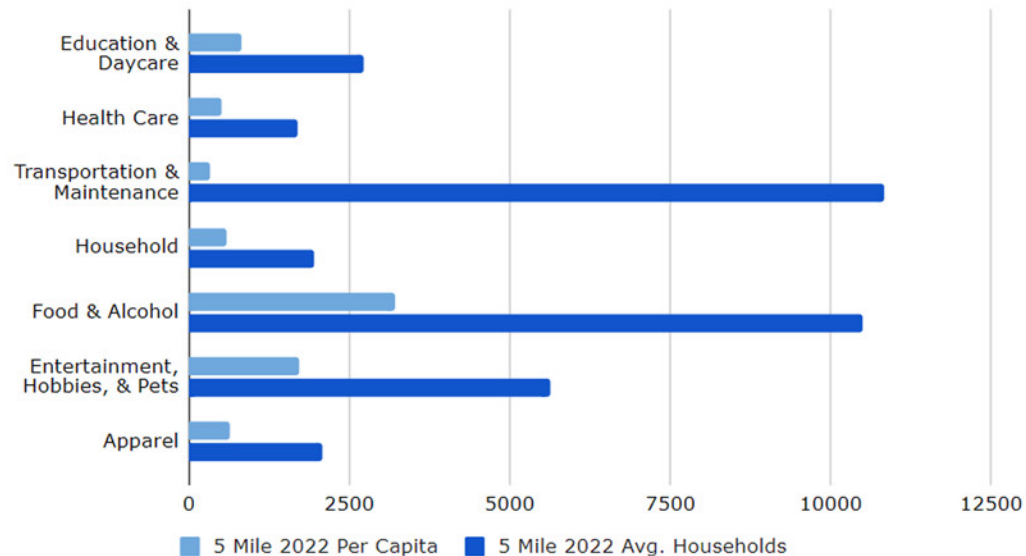

POPULATION	2 Mile Pop.	5 Mile Pop.	10 Mile Pop.
2000	28,765	127,890	362,027
2010	43,432	208,895	460,440
2022	51,387	239,338	513,519
2027	53,812	249,465	533,077

POPULATION





DANIEL MUELLER

Executive Director

916 704 9341

1555 River Park Dr. Ste. 109

Sacramento, CA 95815

dmueller@muellercommercial.com

Cal DRE# 01829919

CAMERON FREELOVE

Director

916 613 3899

1555 River Park Dr. Ste. 109

Sacramento, CA 95815

cfreelove@muellercommercial.com

Cal DRE# 02092307

KILGORE RD.

+/-7,000 VPD

CENTURY 21

Select Real Estate, Inc



LEASE

CENTURY 21
Select Real Estate, Inc.



2023 This information has been secured from sources believed to be reliable. Any projections, opinions, assumptions or estimates used are for example only and do not constitute any warranty or representation as to the accuracy of the information. All information should be verified through an independent investigation by the recipient, prior to execution of legal documents or purchase, to determine the suitability of the property for their needs. Logos and/or pictures are displayed for visual purpose only and are the property of their respective owners. CalDRE# 0101224