

1761 MCCOBA DRIVE

SMYRNA, GA
30080

For Sublease
8,699± SF & 12,136± SF
Warehouse Space

CARSON HAWKS

Associate
770.312.0267
chawks@kingindustrial.com

CLYDE PURMORT

Senior Advisor
941.323.0763
cpurmort@kingindustrial.com



Industrial • Commercial • Investment
404.942.2000 | kingindustrial.com



FOR SUBLEASE

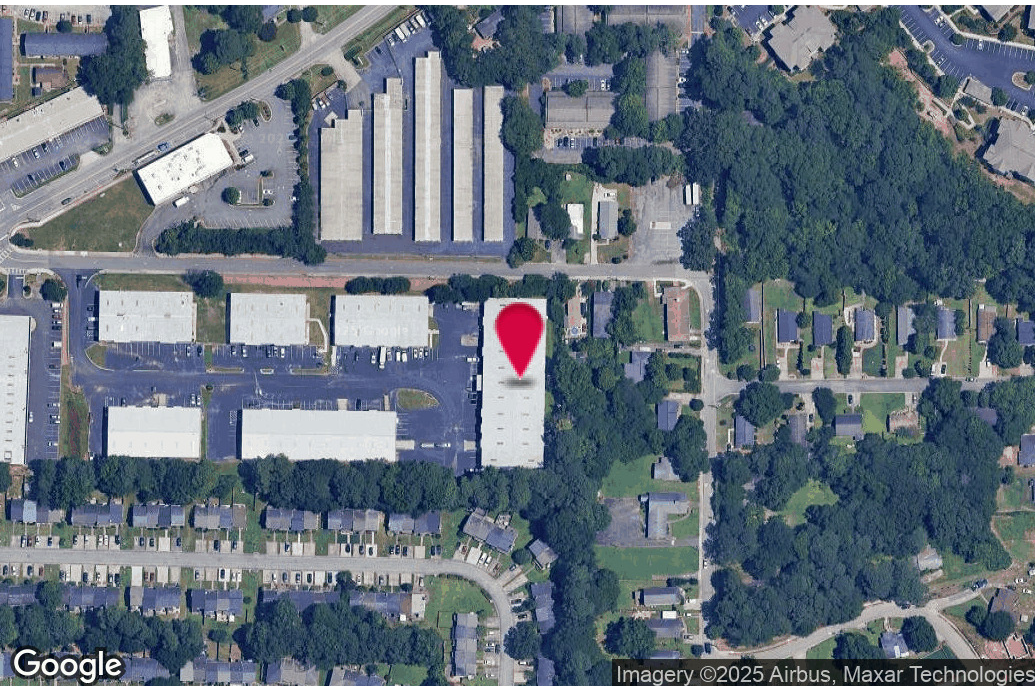

PROPERTY HIGHLIGHTS

- Suite A: 8,699± SF, 1 Dock Door & 1 Drive-In Door
- Suite C: 12,136± SF with 762± Office Space, 2 Dock Doors & 1 Drive-In Door
- 18' Clear Height
- Sublease Term 9/30/27

OFFERING SUMMARY

Building Size:	27,550 SF
Zoning:	OD

CARSON HAWKS

Associate

770.312.0267

chawks@kingindustrial.com

CLYDE PURMORT

Senior Advisor

941.323.0763

cpurmort@kingindustrial.com

Every effort has been made to provide accurate information, but no liability is assumed for errors or omissions.

king Industrial Realty, Inc. **CORFAC** INTERNATIONAL

Industrial • Commercial • Investment
404.942.2000 | kingindustrial.com

ADDITIONAL PHOTOS



CARSON HAWKS

Associate

770.312.0267

chawks@kingindustrial.com

CLYDE PURMORT

Senior Advisor

941.323.0763

cpurmort@kingindustrial.com

Every effort has been made to provide accurate information, but no liability is assumed for errors or omissions.

king Industrial
Realty, Inc. **CORFAC**
INTERNATIONAL

Industrial • Commercial • Investment
404.942.2000 | kingindustrial.com

FLOOR PLAN

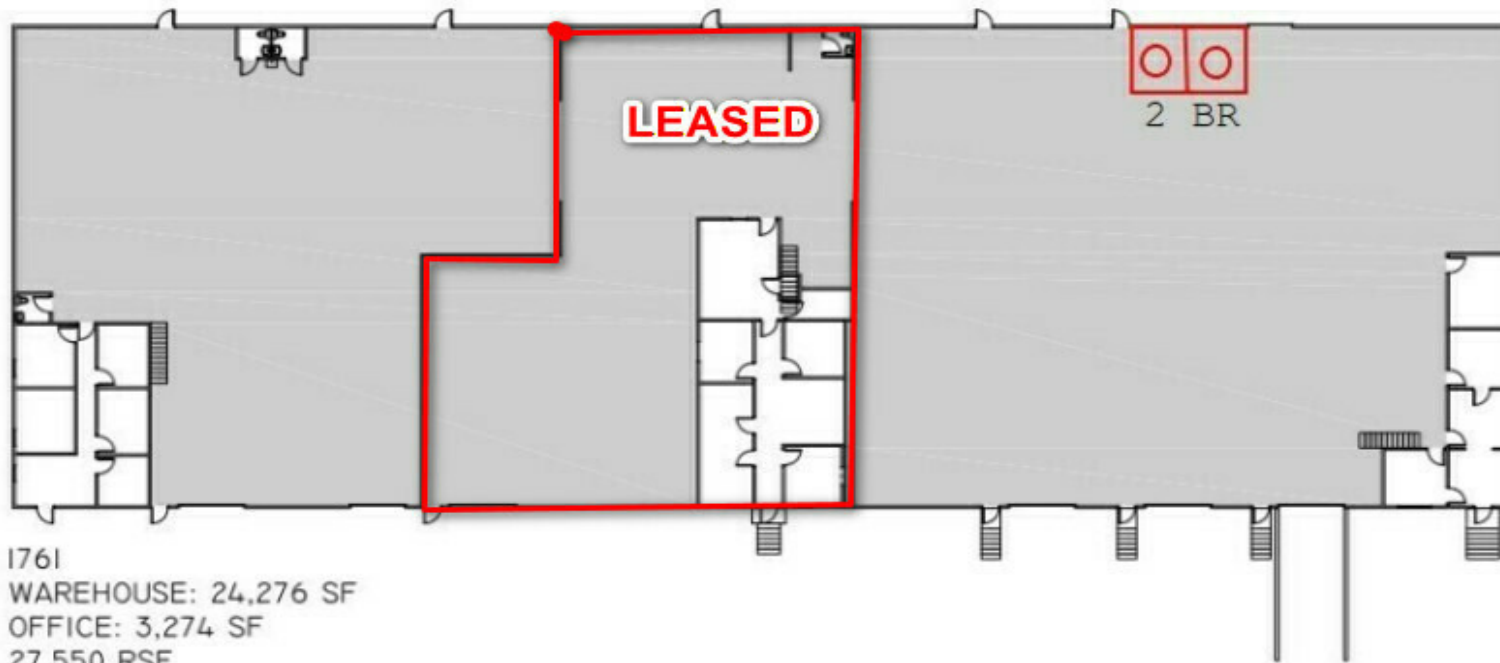

PLANNING U
INTERIORS E SMYRNA CIRCLE • 1761 MCCOBA DR • FULL BUILDING • 27,550 RSF

06.21.2010

CARSON HAWKS

Associate

770.312.0267

chawks@kingindustrial.com

CLYDE PURMORT

Senior Advisor

941.323.0763

cpurmort@kingindustrial.com



Industrial • Commercial • Investment
404.942.2000 | kingindustrial.com

LOCATION MAP

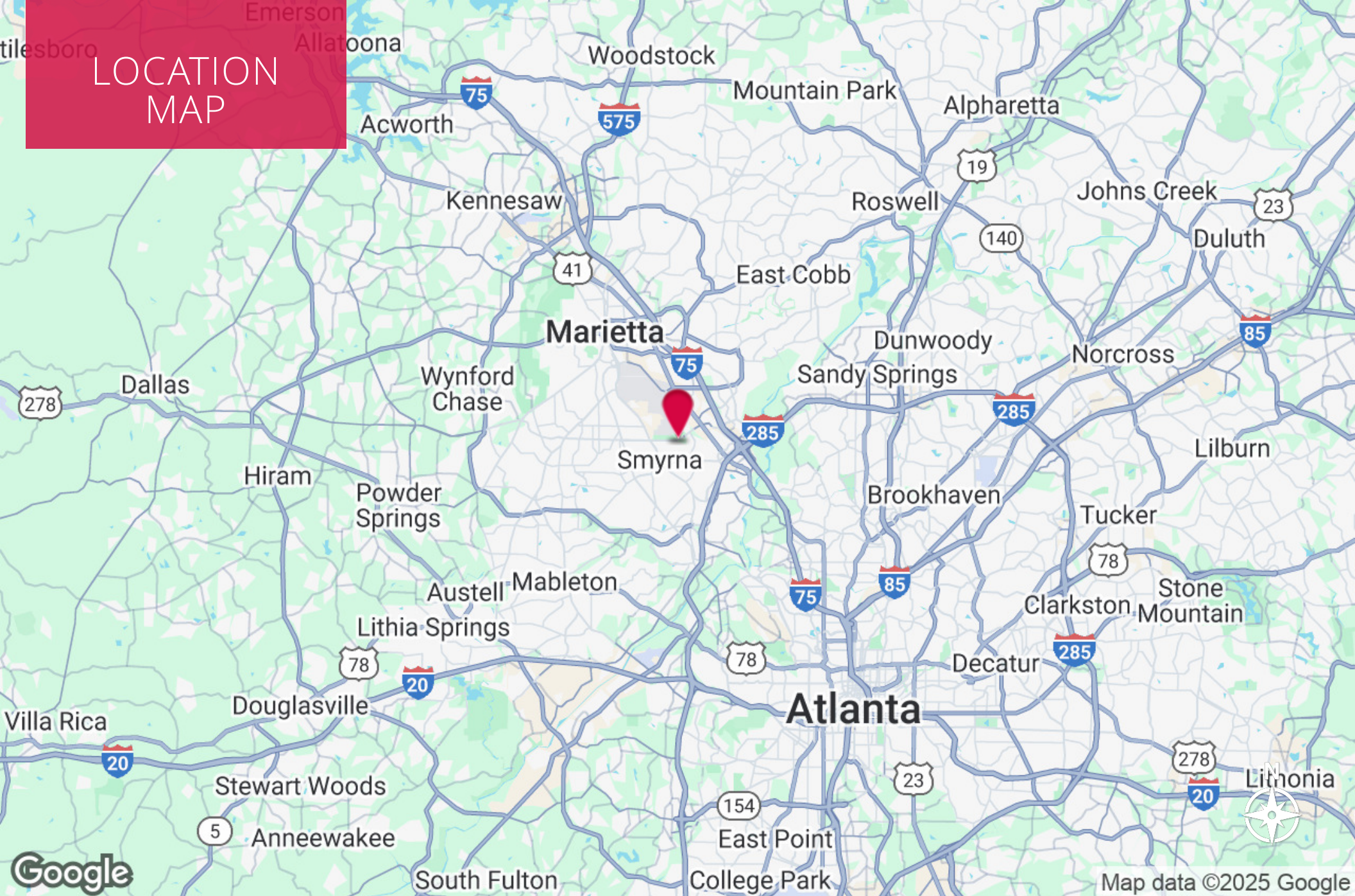

CARSON HAWKS

Associate

770.312.0267

chawks@kingindustrial.com

CLYDE PURMORT

Senior Advisor

941.323.0763

cpurmort@kingindustrial.com



Industrial • Commercial • Investment
404.942.2000 | kingindustrial.com

EXCLUSIVELY LISTED BY:

CARSON HAWKS

Associate

chawks@kingindustrial.com

770.312.0267

CLYDE PURMORT

Senior Advisor

cpurmort@kingindustrial.com

941.323.0763

King Industrial
Realty, Inc.

Industrial • Commercial • Investment
404.942.2000 | kingindustrial.com