

For Lease

2907 SHELTER ISLAND DR

POINT LOMA | SAN DIEGO

±807 SF Retail/Cafe



Serena Patterson
serena@upgsocal.com

UPG **URBAN**
PROPERTY
GROUP EST. 1989

For Lease Retail/Cafe

Property Highlights

- Signature retail/cafe spaces on Shelter Island Drive
- Steps to Humphrey's concert venue, San Diego Yacht Club, hotels, and popular dining destinations
- Easy access to San Diego International Airport and Liberty Station, with convenient access from Interstate 5 and Interstate 8
- Adjacent restaurants include Old Venice, Miguel's Mexican Cocina, Point Loma Fish Shop, Point Loma Seafoods, and the Point Loma Farmer's Market that occurs every Sunday

→ ± 807
Size

→ Available Now
Timing Available



2907 Shelter Island Drive | Point Loma

Site Plan

GROUND FLOOR

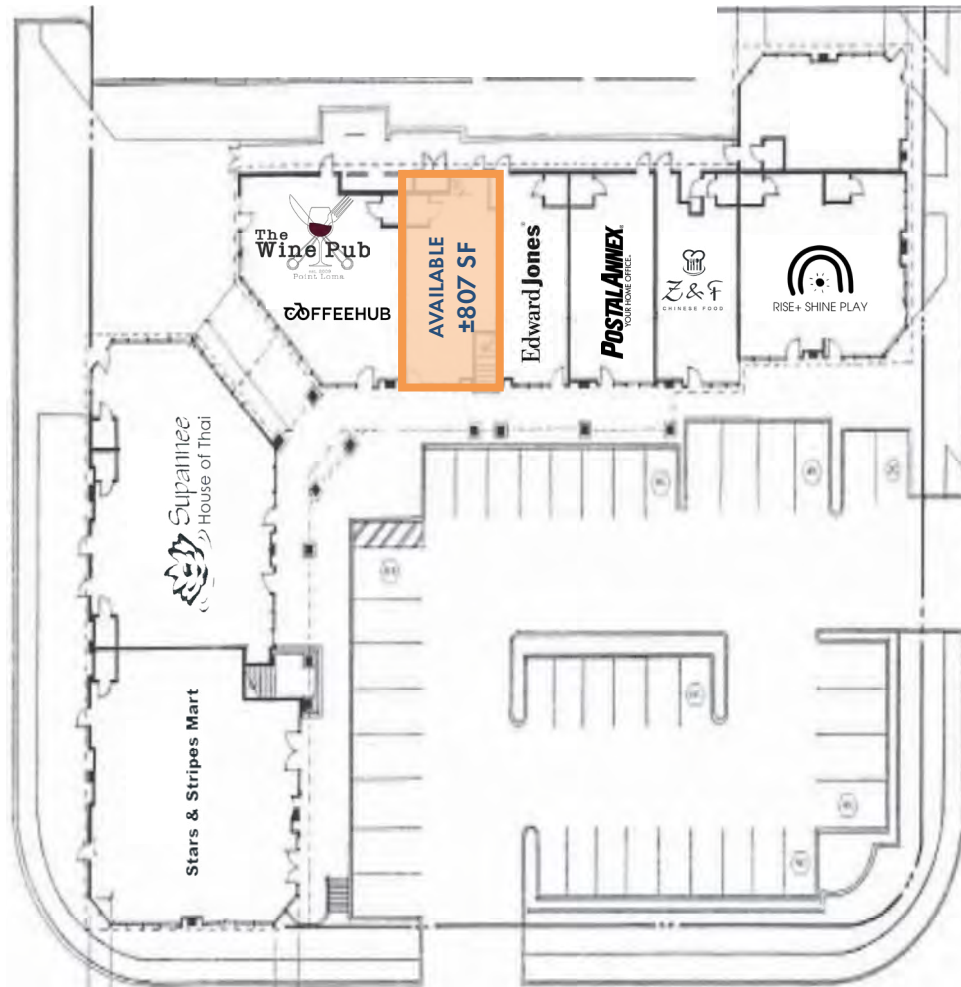

SCOTT STREET

SHELTER ISLAND DRIVE

Excluded Uses: Coffee, Bakery, Chinese, Thai, Wine Pub

SECOND FLOOR



2907 Shelter Island Drive | Point Loma

For Lease Retail/Cafe

Point Loma

Near downtown and San Diego International Airport, and anchored by the Navy Base and San Diego Yacht Club, Point Loma is one of the oldest communities of San Diego. A peninsula jutting into the sea, the area features picturesque marinas from which sportfishing excursions, whale watching tours and harbor cruises depart.

With spectacular views of the Pacific Ocean, Downtown and America's Cup Harbor, Point Loma is one of the area's most desirable and affluent communities. The nautical industry continues to have a strong presence in the community as does the military. Shelter Island is home great dining destinations and Humphrey's on the Bay, one of San Diego's best concert venues. The Cabrillo National Monument is the nation's second-most visited National Park. Tourists and locals alike enjoy the historic Point Loma Lighthouse.

More recently the nearby 361-acre waterfront urban village of Liberty Station has emerged as a new central arts and entertainment destination for San Diego.



42,409

POPULATION

\$131,411

AVG HOUSEHOLD INCOME

18,124

TOTAL EMPLOYEES

All demographics taken from 2 mile radius

For Lease Retail/Cafe

Your Neighbors

1 MILE TO



San Diego Yacht Club



The Pearl



Humphreys

2907 Shelter Island Drive | Point Loma



2907 Shelter Island Drive | Point Loma

UPGSOCAL.COM
858 874 1989

CONTACT US

Serena Patterson
serena@upsocal.com
Lic. No. 01721040

UPG **URBAN**
PROPERTY
GROUP EST. 1989



©2024 Urban Property Group, Inc. Information herein has been obtained from sources deemed reliable, however its accuracy cannot be guaranteed. The user is required to conduct their own due diligence and verification.