

# 10158

## S. PARKER ROAD, UNIT 105

PARKER, CO 80138

LEASE RATE

**\$24.00 PSF/YR (NNN)**



**NEW SIGNALIZED INTERSECTION**

GREAT VISIBILITY | 54,000 VPD



**MARC S. LIPPITT**

CHAIRMAN | PRESIDENT

303.321.5888

[mlippitt@uniqueprop.com](mailto:mlippitt@uniqueprop.com)

**JUSTIN N. HERMAN**

VICE PRESIDENT

720.881.6343

[jherman@uniqueprop.com](mailto:jherman@uniqueprop.com)

 **UNIQUE**  
PROPERTIES

TCN  
REAL ESTATE SERVICES

400 S. Broadway | Denver, CO 80209  
[www.uniqueprop.com](http://www.uniqueprop.com) | 303.321.5888



*10158 S. Parker Road, Parker, CO 80138*

## Team Contacts

### Marc S. Lippitt

Chairman | President

303.321.5888

mlippitt@uniqueprop.com

### Justin Herman

Vice President

720.881.6343

jherman@uniqueprop.com



### Unique Properties, Inc

400 South Broadway | Denver, CO 80209

www.uniqueprop.com | 303.321.5888

## Confidentiality & Conditions

All materials and information received or derived from Unique Properties, Inc its directors, officers, agent's, advisors, affiliates and / or any third party sources are provided without representation or warranty as to completeness, veracity, or accuracy, condition of the property, compliance or lack of compliance with applicable governmental requirements, developability or suitability, financial performance of the property, projected financial performance of the property for any party's intended use or any and all other matters.

Neither Unique Properties, Inc its directors, officers, agents, advisors, or affiliates makes any representation or warranty, express or implied, as to accuracy or completeness of any materials or information provided, derived, or received. Materials and information from any source, whether written or verbal, that may be furnished for review are not a substitute for a party's active conduct of its own due diligence to determine these and other matters of significance to such party. Unique Properties, Inc will not investigate or verify any such matters or conduct due diligence for a party unless otherwise agreed in writing.

EACH PARTY SHALL CONDUCT ITS OWN INDEPENDENT INVESTIGATION AND DUE DILIGENCE.

Any party contemplating or under contract or in escrow for a transaction is urged to verify all information and to conduct their own inspections and investigations including through appropriate third party independent professionals selected by such party.

All financial data should be verified by the party including by obtaining and reading applicable documents and reports and consulting appropriate independent professionals. Unique Properties, Inc makes no warranties and / or representations regarding the veracity, completeness, or relevance of any financial data or assumptions. Unique Properties, Inc does not service as a financial advisor to any party regarding any proposed transaction. All data and assumptions regarding financial performance, including that used for financial modeling purposes, may differ

from actual data or performance. Any estimates of market rents and / or projected rents that may be provided to a party do not necessarily mean that rents can be established at or increased to that level. Parties must evaluate any applicable contractual and governmental limitations as well as market conditions, vacancy factors and other issues in order to determine rents from or for the property.

Legal questions should be discussed by the party with an attorney. Tax questions should be discussed by the party with a certified public accountant or tax attorney. Title questions should be discussed by the party with a title officer or attorney. Questions regarding the condition of the property and whether the property complies with applicable governmental requirements should be discussed by the party with appropriate engineers, architects, contractors, other consultants and governmental agencies. All properties and services are marketed by Unique Properties, Inc in compliance with all applicable fair housing and equal opportunity laws

# PROPERTY HIGHLIGHTS

|                        |                          |
|------------------------|--------------------------|
| Lease Rate:            | \$24 PSF + NNN           |
| Est NNN:               | \$9.33 PSF               |
| Available SF:          | 1,658 SF                 |
| Building Size:         | 11,254 SF                |
| Lot Size:              | 1.516 Acres              |
| Year Built:            | 1998                     |
| Parking Spaces:        | 84 Spaces                |
| County:                | Douglas                  |
| Property Taxes (2025): | \$41,141.99 (\$3.66 PSF) |

## PROPERTY DESCRIPTION

10158 S. Parker Road is a 11,254 square foot mixed use building located directly off of South Parker Road. The property is just north of Parker Main Street and has amazing visibility with over 54,000 vehicles per day. This property has excellent ownership and management and they are very responsive. This space could lend itself to a multitude of different uses. Suite 106 is currently being used as a music school.

- Great management and ownership
- Amazing visibility | Over 54,000 VPD
- Easy access to downtown Parker and the surrounding areas.
- Private bathroom.
- New signalized intersection on Parker Road.
- Abundant Parking | 7.46 spaces per 1,000 SF
- Monument signage on Parker Road.
- Great demographics | \$140 AHHI (3 Mile Radius)
- Permissive Zoning | Abundant Potential Uses

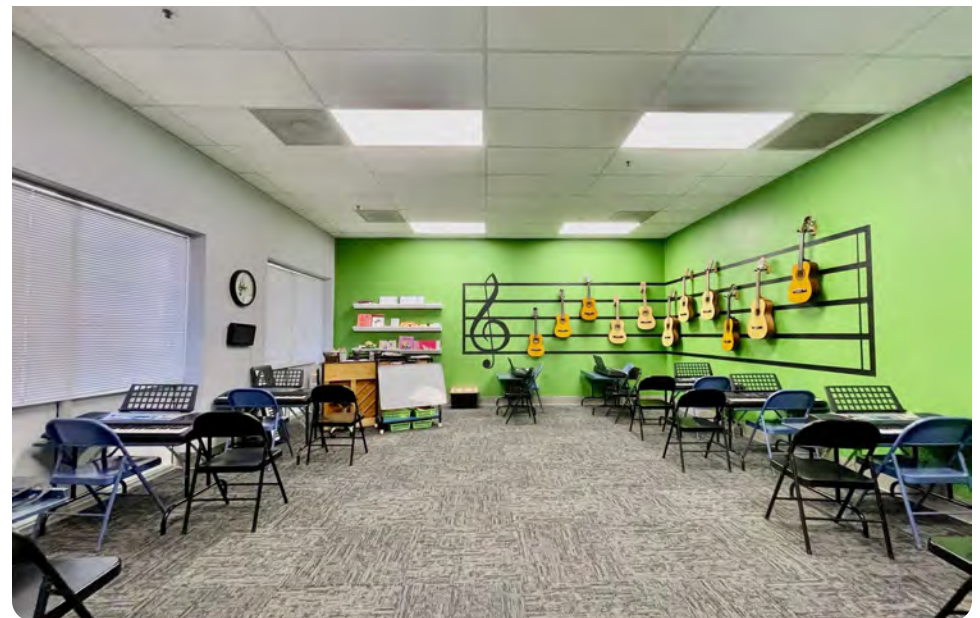



# SITE PLAN

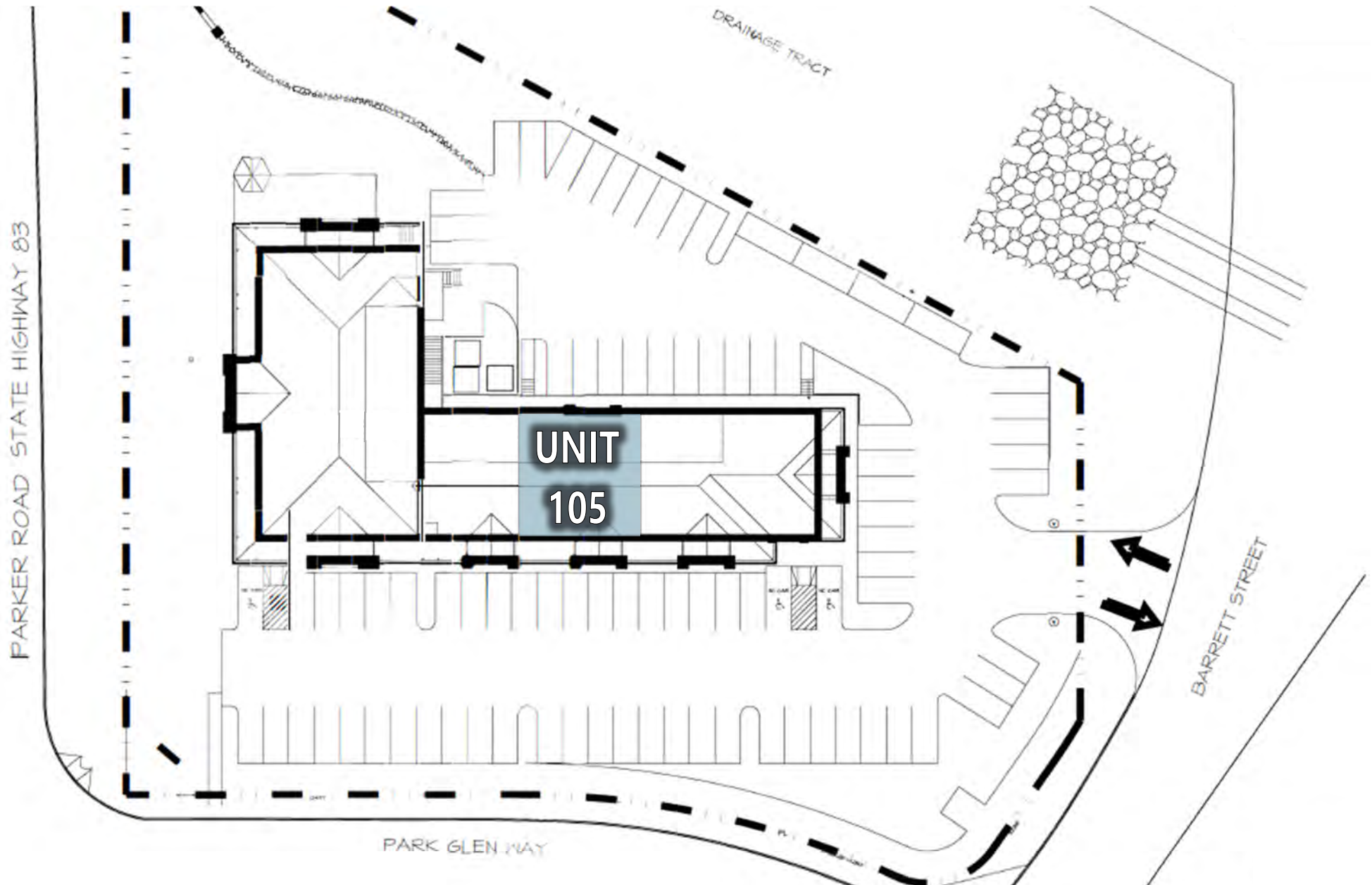



# AERIAL LOOKING S





# AERIAL LOOKING N





# AREA DEMOGRAPHICS

| Radius                           | 1 Mile           | 2 Mile           | 3 Mile           |
|----------------------------------|------------------|------------------|------------------|
| <b>Population:</b>               |                  |                  |                  |
| 2029 Projection                  | 4,535            | 38,559           | 83,887           |
| 2024 Estimate                    | 3,905            | 33,910           | 73,938           |
| 2010 Census                      | 3,102            | 31,441           | 68,395           |
| Growth 2024-2029                 | 16.13%           | 13.71%           | 13.46%           |
| Growth 2020-2024                 | 25.89%           | 7.85%            | 8.10%            |
| Median Age                       | 39.00            | 37.00            | 38.30            |
| Average Age                      | 40.00            | 37.50            | 37.80            |
| <b>2024 Population by Race:</b>  |                  |                  |                  |
| White                            | 3,041            | 26,572           | 57,449           |
| Black                            | 81               | 754              | 1,404            |
| Am. Indian & Alaskan             | 15               | 144              | 298              |
| Asian                            | 244              | 1,984            | 5,395            |
| Hawaiian & Pacific Island        | 5                | 27               | 48               |
| Other                            | 519              | 4,429            | 9,344            |
| Hispanic Origin                  | 488              | 4,124            | 8,146            |
| <b>U.S. Armed Forces:</b>        |                  |                  |                  |
| <b>Households:</b>               | <b>18</b>        | <b>145</b>       | <b>255</b>       |
| 2029 Projection                  | 1,942            | 15,176           | 30,559           |
| 2024 Estimate                    | 1,672            | 13,318           | 26,885           |
| 2010 Census                      | 1,346            | 12,323           | 24,827           |
| Growth 2024-2029                 | 16.15%           | 13.95%           | 13.67%           |
| Growth 2020-2024                 | 24.22%           | 8.07%            | 8.29%            |
| Owner Occupied                   | 999              | 7,723            | 19,635           |
| Renter Occupied                  | 673              | 5,595            | 7,250            |
| <b>2024 Avg Household Income</b> | <b>\$111,174</b> | <b>\$119,893</b> | <b>\$140,161</b> |
| <b>2024 Med Household Income</b> | <b>\$86,847</b>  | <b>\$96,151</b>  | <b>\$118,410</b> |

| Radius                                   | 1 Mile | 2 Mile | 3 Mile |
|--|--------|--------|--------|
| <b>2024 Households by Household Inc:</b> |        |        |        |
| <\$25,000                                | 81     | 875    | 1,308  |
| \$25,000 - \$50,000                      | 349    | 1,682  | 2,728  |
| \$50,000 - \$75,000                      | 225    | 2,156  | 3,226  |
| \$75,000 - \$100,000                     | 383    | 2,300  | 3,913  |
| \$100,000 - \$125,000                    | 149    | 1,450  | 3,079  |
| \$125,000 - \$150,000                    | 92     | 1,404  | 2,949  |
| \$150,000 - \$200,000                    | 202    | 1,760  | 4,798  |
| \$200,000+                               | 192    | 1,691  | 4,884  |
| <b>2024 Population by Education:</b>     |        |        |        |
| Some High School, No Diploma             | 78     | 1,046  | 2,014  |
| High School Grad (Incl Equivalency)      | 599    | 3,492  | 6,663  |
| Some College, No Degree                  | 1,047  | 7,728  | 14,760 |
| Associate Degree                         | 246    | 1,629  | 3,315  |
| Bachelor Degree                          | 850    | 7,585  | 17,622 |
| Advanced Degree                          | 305    | 3,764  | 9,582  |
| <b>2024 Population by Occupation</b>     |        |        |        |
| Real Estate & Finance                    | 162    | 1,860  | 4,875  |
| Professional & Management                | 1,515  | 12,647 | 29,810 |
| Public Administration                    | 295    | 1,154  | 2,537  |
| Education & Health                       | 352    | 4,180  | 8,634  |
| Services                                 | 252    | 2,894  | 5,877  |
| Information                              | 94     | 1,009  | 2,068  |
| Sales                                    | 563    | 4,995  | 10,287 |
| Transportation                           | 51     | 170    | 443    |
| Retail                                   | 264    | 2,286  | 4,885  |
| Wholesale                                | 70     | 635    | 1,248  |
| Manufacturing                            | 125    | 890    | 1,996  |
| Production                               | 136    | 1,429  | 3,002  |
| Construction                             | 278    | 1,370  | 2,191  |
| Utilities                                | 65     | 1,154  | 2,177  |
| Agriculture & Mining                     | 13     | 73     | 406    |
| Farming, Fishing, Forestry               | 0      | 13     | 42     |
| Other Services                           | 53     | 729    | 1,623  |





**MARC S. LIPPITT**

CHAIRMAN | PRESIDENT

**303.321.5888**

[mlippitt@uniqueprop.com](mailto:mlippitt@uniqueprop.com)

**JUSTIN N. HERMAN**

VICE PRESIDENT

**720.881.6343**

[jherman@uniqueprop.com](mailto:jherman@uniqueprop.com)