



4608 South 3500 West
West Haven, UT 84401

Lease Price
\$1.05/SF
/NNN



FOR LEASE

Property Features

- ✓ ± 1,500 - ± 3,000 SF Available
- ✓ Zoned West Haven City C-2
- ✓ New Construction Ready for Tenant Build-Out
- ✓ ± 1,500 SF Warehouse with 14' H Door
- ✓ 3-Phase Power | 22' Ceiling Clearance
- ✓ ± 1,500 SF Office/Showroom Space
- ✓ High Ceilings w/ Lots of Natural Light
- ✓ ± 1,500 SF Optional Mezzanine Available
- ✓ Quick Access to Freeway & Major Roads
- ✓ Tenant Improvements Negotiable

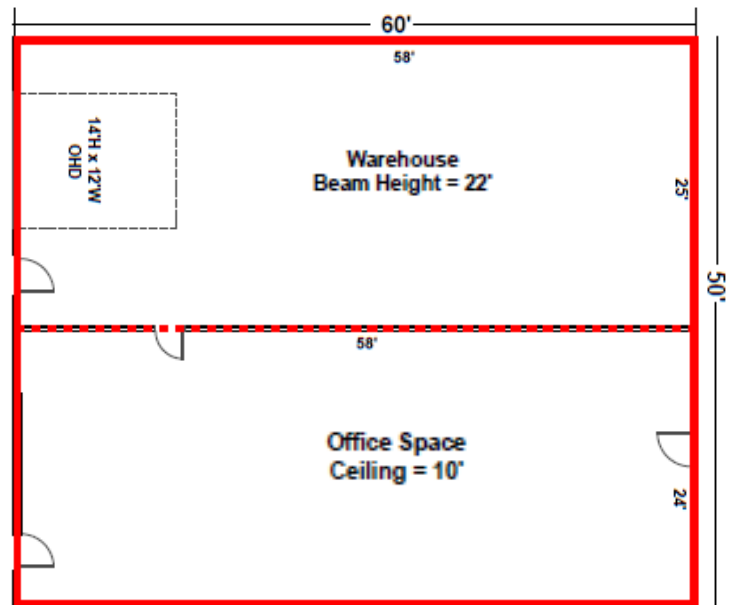

Contact Agents



Garrett Pierson
801-644-1361
g@crestutah.com



Aaron McCrady
801-953-7012
aaroncrest@gmail.com



www.CrestUtah.com

978 Chamber St., Suite 3, South Ogden, Utah 84403
Phone : 801-476-9500 | Fax: 801-476-9581

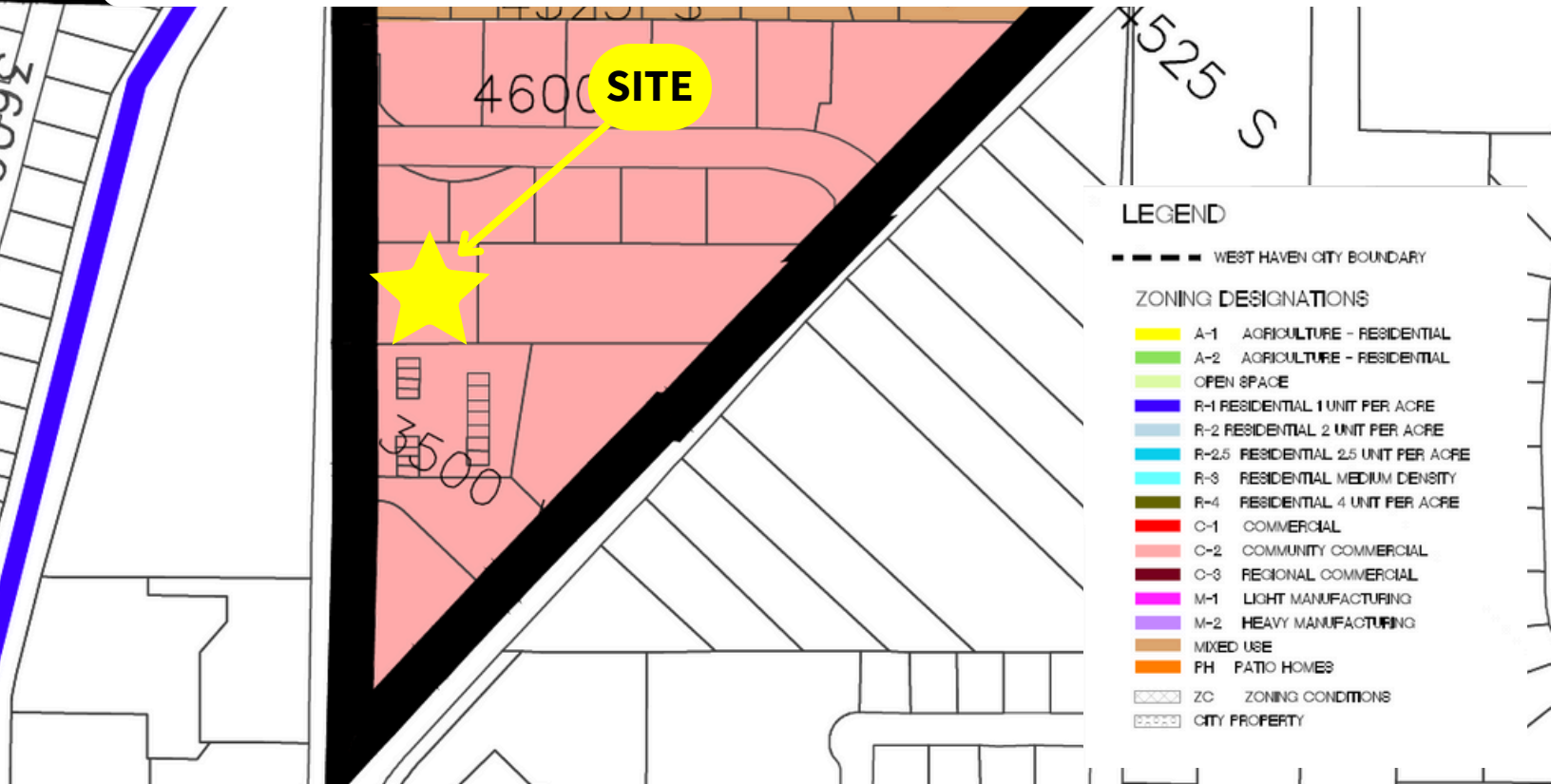

Contact Agents



Garrett Pierson
801-644-1361
g@crestutah.com



Aaron McCrady
801-953-7012
aaroncrest@gmail.com

Floor Plan

Total Square Feet

1,500-3,000

Warehouse = 1,500 Sq Ft
Office = 1,500 Sq Ft
Total Available = 3,000 Sq Ft

Optional Mezzanine = 1,500 Sq Ft

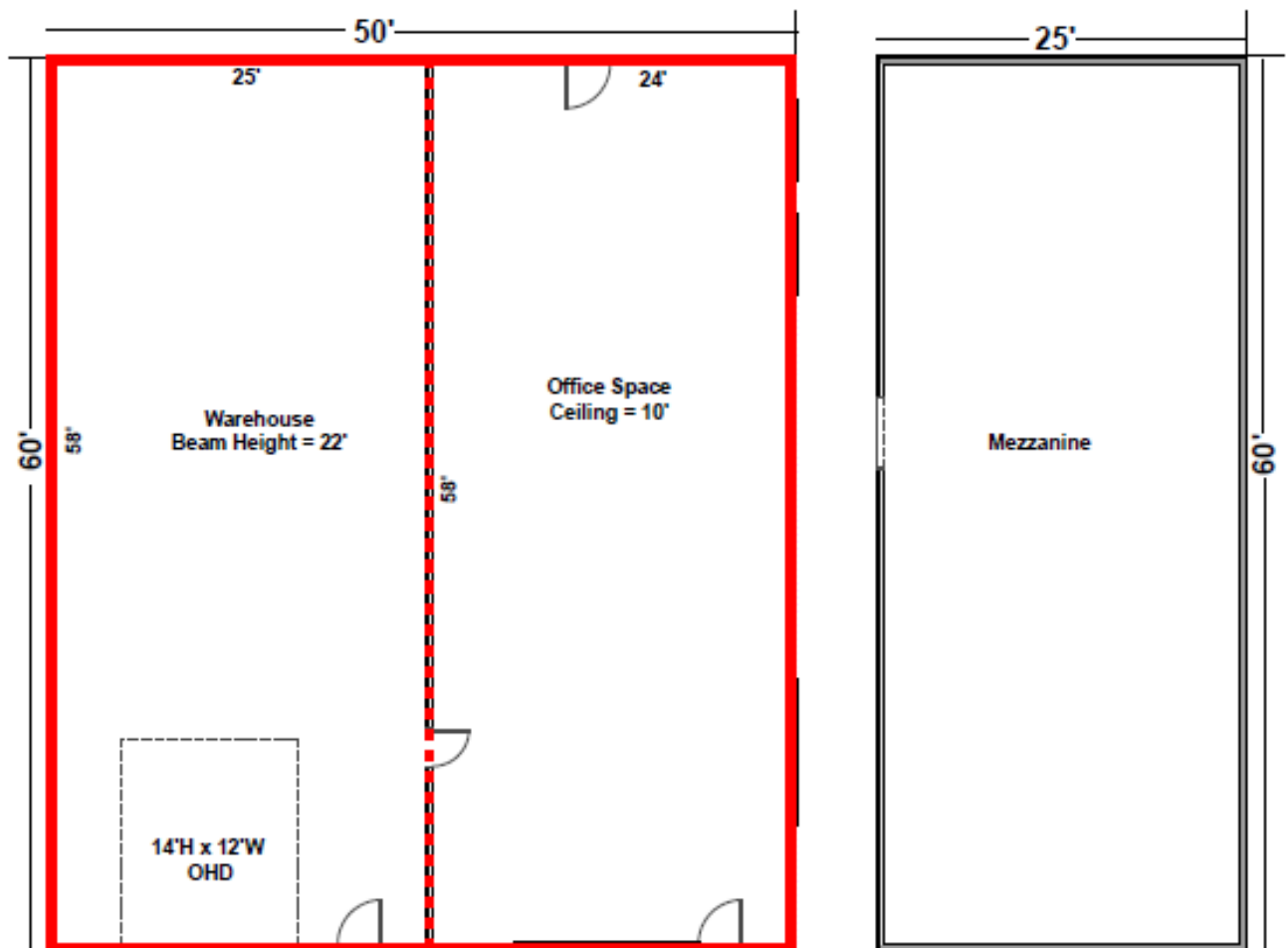

Contact Agents



Garrett Pierson
801-644-1361
g@crestutah.com



Aaron McCrady
801-953-7012
aaroncrest@gmail.com



Contact Agents



Garrett Pierson
801-644-1361
g@crestutah.com



Aaron McCrady
801-953-7012
aaroncrest@gmail.com



FOR LEASE

**4608 S 3500 W
West Haven, UT**

**For More Information
Please Contact:**



Garrett Pierson
801-644-1361
g@crestutah.com



Aaron McCrady
801-953-7012
aaroncrest@gmail.com

