



## 1660 E Race St

Allentown, Pennsylvania 18109

### Property Overview

Space features 24,000 SF of fully conditioned warehouse space complemented by 2,800 SF of dedicated office area. The warehouse is equipped with four (4) 8' x 10' dock doors and one (1) 12' x 14' drive-in door, with each dock position including levelers, seals, and bumpers to support efficient loading operations.

The facility offers strong industrial specifications suited for a variety of warehouse, manufacturing, and distribution users, including 20' clear ceiling heights, 75' x 25' column spacing, 3-phase 480V / 400-amp electrical service, and upgraded LED lighting throughout. Additional features include outdoor storage and yard area available for tenant use. The space was remodeled in 2024, providing a modernized and functional industrial environment.

### Offering Summary

<b>Lease Rate:</b>	Call for details
<b>Building Size:</b>	48,000 SF
<b>Available SF:</b>	26,800 SF
<b>Lot Size:</b>	4.4 Acres

### For More Information

#### Michael Adams, SIOR

O: 610 871 1701 | C: 610 704 3681  
madams@naisummit.com

#### Sarah Finney Miller

O: 610 871 1719 | C: 610 554 5695  
sfinney@naisummit.com

#### Collin Holben

O: 610 871 1691 | C: 484 951 4517  
cholben@naisummit.com

### Property Information

Property Type	Industrial
Property Subtype	Refrigerated/Cold Storage, Warehouse/Distribution, Manufacturing, Flex, and R&D
Zoning	PIO - Planned Industrial/Office
Lot Size	4.4 Acres
Year Built / Renovated	1966 / 2024
Parking Spaces	51
Truck Court	125 ft
Outdoor Storage	Yes
Gas/Propane	Gas Heat
Water/Sewer	Public

### Suite Information

Total Space	26,800 SF
Warehouse Space	24,000 SF
Office Space	2,800 SF
Number of Dock High Doors	4 (8'x 10') All docks equipped with levelers, seals, & bumpers
Number of Drive in Bays	1 (12' x 14')
Ceiling Height	20 ft
Column Space	70 ft x 25 ft
Condition	Good
Sprinkler System	Wet
HVAC	Fully Air-Conditioned
Lighting	LED

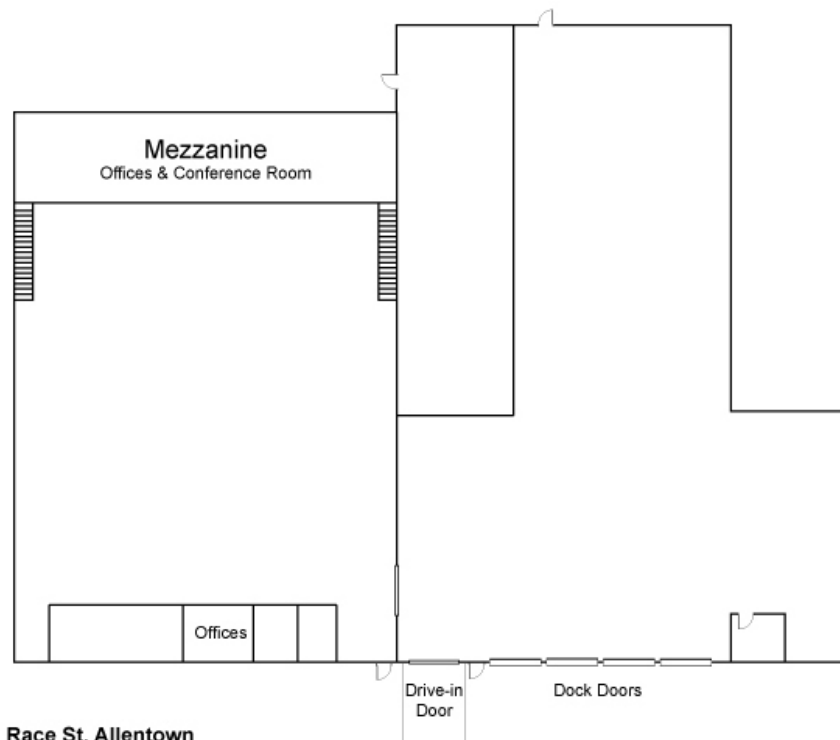

1660 E Race St, Allentown  
Floor Plan  
Not to Scale

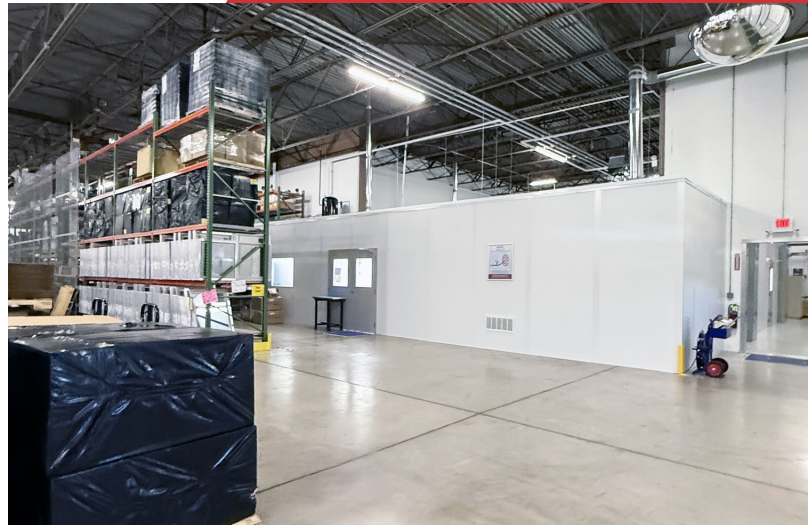

The information contained herein has been obtained from sources believed to be reliable; however, NAI Summit makes no representations, warranties, or guarantees, express or implied, as to the accuracy or completeness of this information. All information is subject to errors, omissions, changes in price, rental, or other conditions, prior sale, lease, or financing, or withdrawal without notice. Any reliance on this information is at your own risk, and you are advised to conduct your own independent review and due diligence. NAI Summit and its logo are service marks of Summit Management and Realty Company d/b/a NAI Summit. All other service marks, trademarks, logos, and images are the property of their respective owners and are used herein for informational purposes only. Unauthorized use of images or materials without written permission is strictly prohibited. All rights reserved.

1620 Pond Road, Suite 150  
Allentown, PA 18104  
610 264 0200 tel  
[naisummit.com](http://naisummit.com)

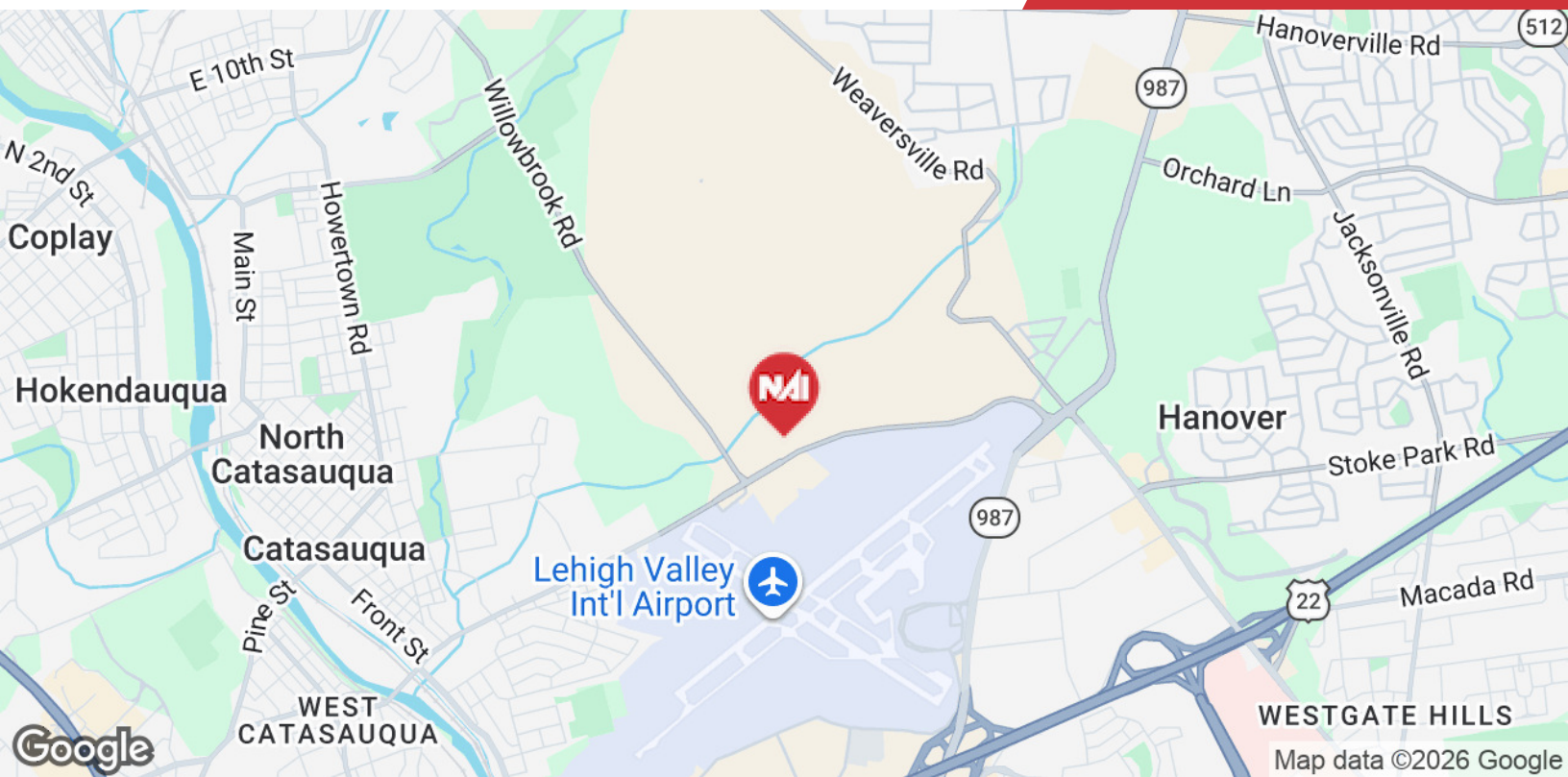

	Time	Miles
Lehigh Valley International Airport	3 min	1.5 miles
Route 22	5 min	2.5 miles
Route 33	14 min	10 miles
I-476 NE Extension	16 min	11 miles
I-78 W	16 min	12 miles

## Location Advantages

- Strategically located with near-immediate access to Lehigh Valley International Airport and Route 22
- Lehigh Valley is a two-county region in eastern Pennsylvania, located at the center of the East Coast's massive consumer market.
- Approximately 60 minutes from Philadelphia, 90 minutes from New York City, and within a one-day drive of one-third of the U.S. population.

## About NAI Summit

NAI Summit is the greater Lehigh Valley's leading full-service commercial and industrial real estate firm. Our services offered include property sales & leasing, investment sales, distressed properties, consulting, and comprehensive property management and building services.

Michael Adams

Senior Vice President / Broker of Record

O: 610 871 1701

madams@naisummit.com

Sarah Finney Miller

Senior Vice President

O: 610 871 1719

sfinney@naisummit.com

Collin Holben

Associate

O: 610 871 1691

cholben@naisummit.com