

3300 WOODCREEK DRIVE

6,000 SF Spec Suite

DOWNERS GROVE, ILLINOIS



PROPERTY DETAILS

- 6,000 SF Fully Furnished, Ready to Occupy Spec Suite
- Ready to Occupy Space includes:
 - 10 private offices
 - 22 cubicles
 - kitchen/break area
- Asking Rate: \$26.00/SF Gross (Tax, CAM & Janitorial included)
- Close to area amenities including restaurants, hotels and shopping
- Close to the full interchange to I-88 and I-355 at

BUILDING DETAILS

- Training/Conference Rooms on site includes: 105 person auditorium 64 person Conference Room A, 32 person Conference Room B, and 32 person Conference Room C for a total of 128 people
- Employee lounge area on site
- Heavy parking capability - 141 total building parking spaces. Existing Owner uses 50 spaces or less.



Aubrey Van Reken-Englund

630 693 0679

avanreken@hiffman.com

Caroline Firrantello

630 389 8906

cfirrantello@hiffman.com

[PROPERTY WEBSITE](#)



ONE OAKBROOK TERRACE SUITE 400
OAKBROOK TERRACE IL 60181
630 932 1234

HIFFMAN.COM
@NAIHIFFMAN

©2021 NAI Hiffman. All rights reserved. All information contained herein is from sources deemed reliable; however, no representation or warranty is made to the accuracy thereof.

3300 WOODCREEK DRIVE

6,000 SF Spec Suite

DOWNERS GROVE, ILLINOIS

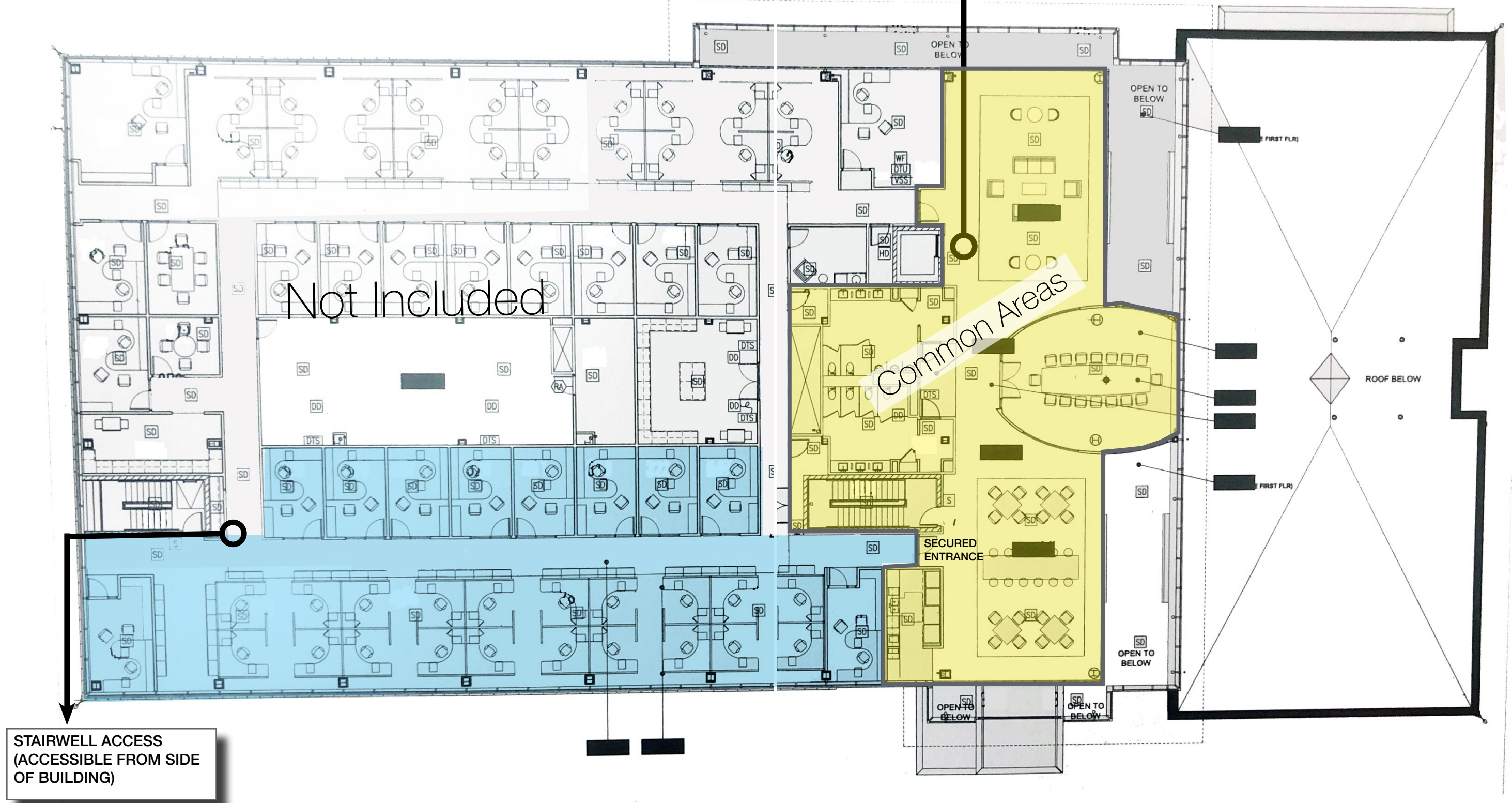

Floor Plan

3300 WOODCREEK DRIVE
6,000 SF Spec Suite
DOWNERS GROVE, ILLINOIS

