



FOR LEASE

RETAIL SPACE

Property Highlights

- 3,725 ± SF Retail Space in Blume Bentonville
- Lease Rate: Negotiable
- Restaurant/coffee opportunity
- Signage opportunity available
- Outdoor patio available
- Opportunity for reserved parking in front of the space and the patio
- Building undergoing extensive refresh/rebranding
- Exterior access allows for after-hours operation
- Located in Downtown Bentonville, just minutes from the new Walmart Headquarters, Sam's Club Headquarters, Interstate 49, and many restaurant and retail options
- Easy access to I-49 via SW 8th St
- Close proximity to Razorback Greenway, Osage Park, and 8th Street Gateway Park

For more information, please contact:

Stephanie Farmer

479 845 3022

sfarmer@sagepartners.com

Ethan Fowler

501 590 6544

efowler@sagepartners.com

479 845 3000

[sagepartners.com](https://www.sagepartners.com)

*information deemed reliable but not guaranteed



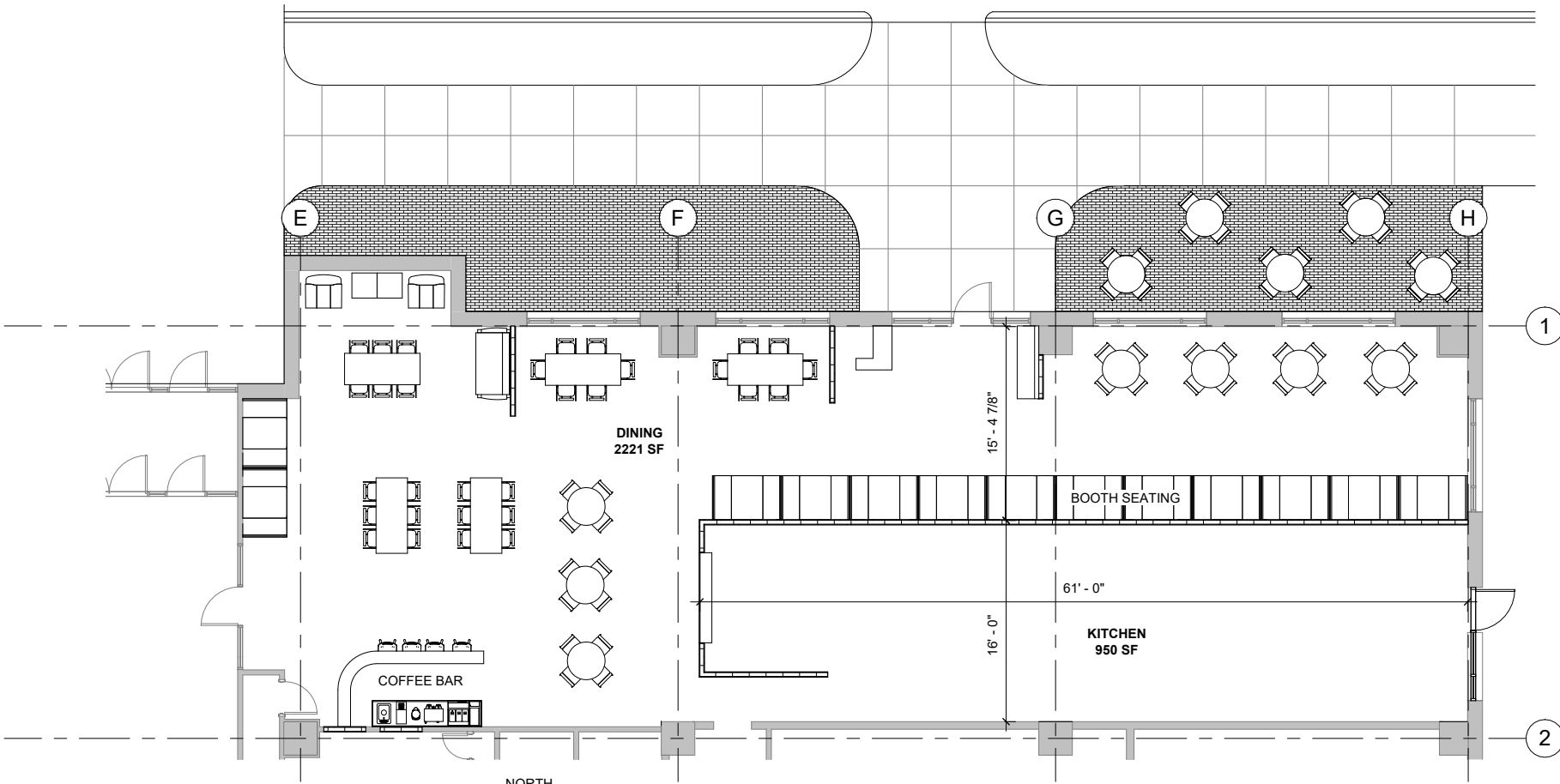

CAFE FLOOR PLAN
1/8" = 1'-0"

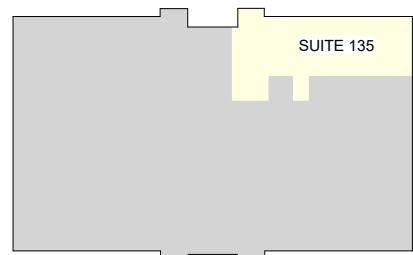

KEY PLAN

