

# Palo Alto County, IA

## Summary

Parcel ID 603015024050  
Alternate ID  
Property Address 2001 10th St  
Emmetsburg  
Sec/Twp/Rng 0-0-0  
Brief Legal Description CORBIN & LAWLER LOTS 5 THRU 11 INC. BLOCK 24  
(Note: Not to be used on legal documents)  
Document(s) REC: 35-1  
Gross Acres 0.00  
Exempt Acres N/A  
Net Acres 0.00  
Class C - Commercial  
(Note: This is for tax purposes only. Not to be used for zoning.)  
Tax District EMMETSBURG CITY TIF SOUTH  
School District EMMETSBURG



## Owners

Primary Owner  
(Deed Holder)  
[Brown, Ruth & Michael](#)  
[PO Box 446](#)  
Emmetsburg, IA 50536

Secondary Owner

Mailing Address  
A Heavenly Celebration  
2001 10th St  
Emmetsburg, IA 50536

## Address Change Form

[Link to the Address Change Form](#)

## Land

Lot Dimensions Regular Lot: 112.00 x 168.00  
Lot Area 0.43 Acres;18,816 SF

## Commercial Buildings

Building 1: Store - Retail Small, 1 Story, Built - 1900, 4014 SF, Bsmt - 4014 SF,  
, Condition - Below Normal

## Data Correction Form

[Link to the Data Correction Form](#)

## Sales

Date	Seller	Buyer	Recording	Sale Condition - NUTC	Type	Multi Parcel	Amount
5/10/2002	S & P SIMONSON	R & M BROWN	35 - 1	No consideration	Warranty Deed		\$0.00
9/5/2000	S & P SIMONSON	R & M BROWN	97 - 399	No consideration	Contract		\$35,000.00

**Recent Sales in Area**

Sale date range:

From:

To:

**Valuation**

	2023	2022	2021	2020	2019
+ Land	\$21,170	\$21,170	\$21,170	\$21,170	\$21,170
+ Building	\$43,680	\$39,680	\$39,680	\$37,590	\$37,590
= Total Assessed Value	\$64,850	\$60,850	\$60,850	\$58,760	\$58,760

**Photos**



**Sketches**

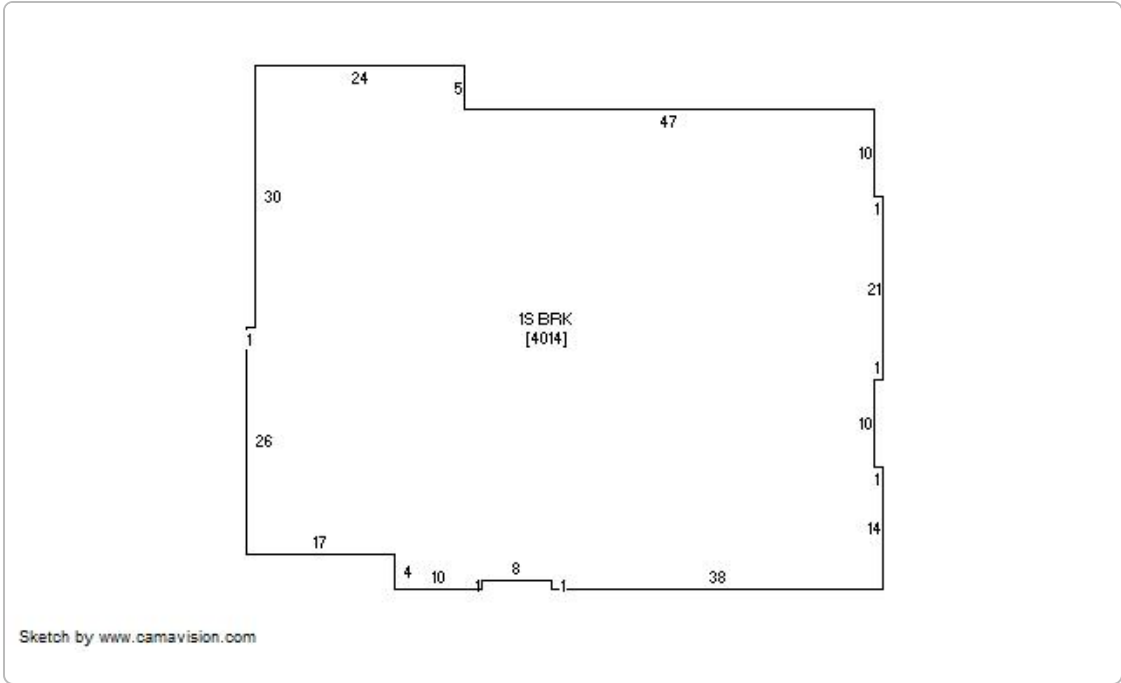

**No data available for the following modules:** Assessment Appeals, Residential Dwellings, Agricultural Buildings, Yard Extras, Family Farm Tax Credit, Homestead Tax Credit Application, Military Service Tax Exemption Application.

Disclaimer: The information in this web site represents current data from a working file which is updated continuously. Information is believed reliable, but its accuracy cannot be guaranteed.  
[User Privacy Policy](#) | [GDPR Privacy Notice](#)  
[Last Data Upload: 7/12/2023, 9:22:04 PM](#)

[Contact Us](#)

Developed by  
 Schneider  
GEOSPATIAL