



The Mustard Seed Place

340 High St, Portsmouth, VA 23704

Laurie Cox Spangle

OMD on High LLC

520 W 21st St, Suite G2, Norfolk, VA 23517

laurie.coxspangle@ardx.net

(757) 805-6523



The Mustard Seed Place

\$23.00 - \$23.46 /SF/YR

Property Overview:

Welcome to The Mustard Seed Place – a truly unique gem nestled in the heart of historic Old Towne Portsmouth. This charming, multi-use building offers character and opportunity on every floor, combining historic elegance with modern potential. Whether you office front, bustling café, art studio, or boutique storefront, this property provides the perfect setting.

- Parking Included



Rental Rate: \$23.00 - \$23.46 /SF/YR

Property Type: [object Object]

Year Built: 1958

Rental Rate Mo: \$1.96 /SF/MO

1st Floor

Space Available	342 SF
Rental Rate	\$23.46 /SF/YR
Date Available	November 04, 2024
Service Type	Modified Gross
Space Type	New
Space Use	Office/Retail
Lease Term	3 - 5 Years

Parking, Coffee Bar Station, Mentoring from Entrepreneur

1

1st Floor Ste 104

Space Available	1,340 SF
Rental Rate	\$23.46 /SF/YR
Date Available	30 Days
Service Type	Modified Gross
Built Out As	Standard Office
Space Type	New
Space Use	Office
Lease Term	3 Years

Rent includes CAM, parking, and utilities

2

2nd Floor Ste 205

Space Available	115 SF
Rental Rate	\$23.00 /SF/YR
Date Available	30 Days
Service Type	Modified Gross
Built Out As	Standard Office
Space Type	New
Space Use	Office
Lease Term	1 Years

Rent plus CAM charge

3

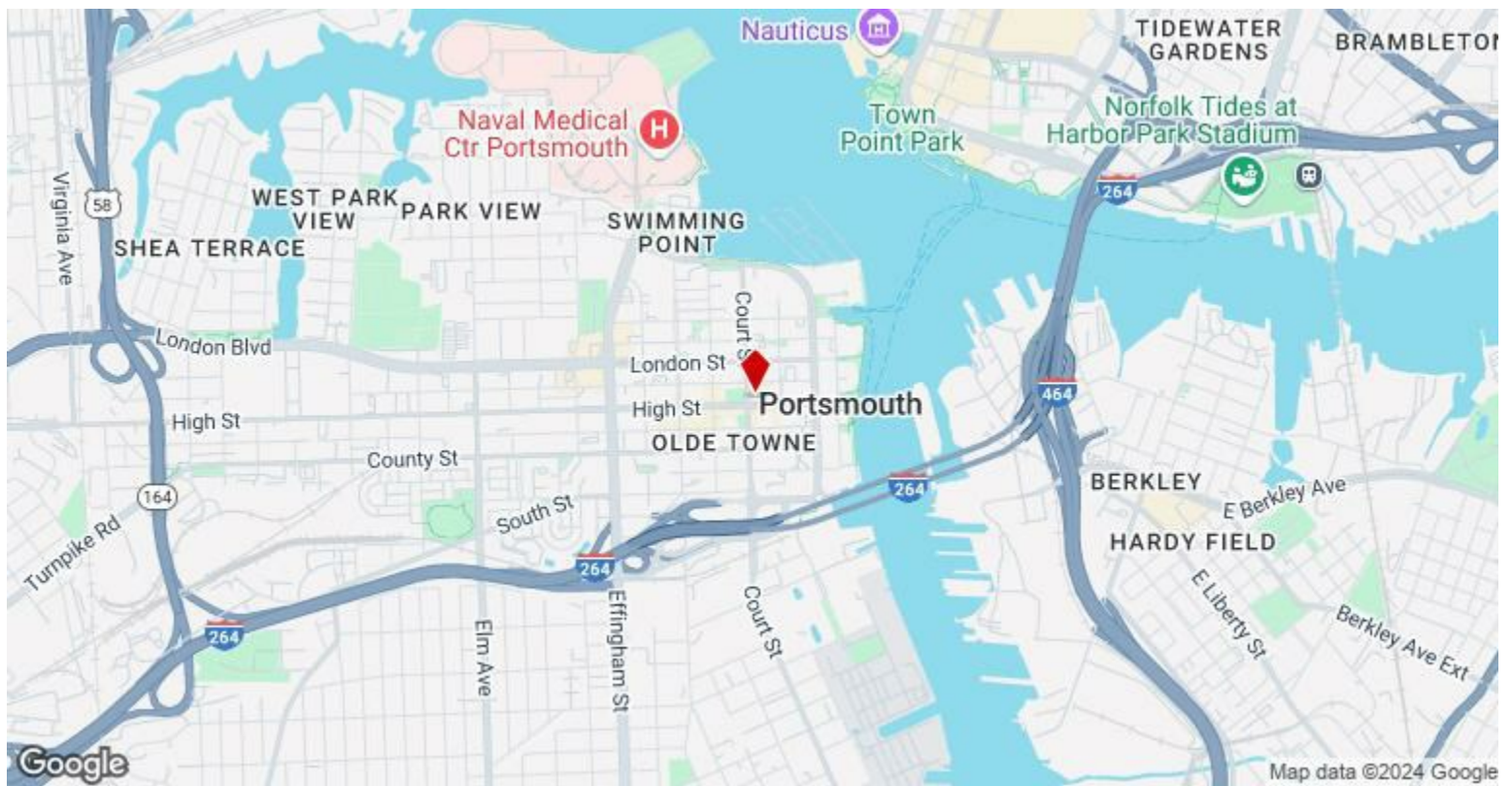

340 High St, Portsmouth, VA 23704

Property Overview:

Welcome to The Mustard Seed Place – a truly unique gem nestled in the heart of historic Old Towne Portsmouth.

Key Features:

Prime Location: Situated along the picturesque High Street, just steps away from Portsmouth's best shopping, dining, and waterfront views.

Historic Charm: Period details preserved throughout, including beautiful hardwood floors, high ceilings, and classic architectural accents.

Flexible Floor Plan: Ideal for residential, commercial, or multi-use applications – the possibilities are endless for both entrepreneurs and homebuyers alike.

Ample Natural Light: Expansive windows allow for plenty of natural light, creating an inviting and open atmosphere.

Community Appeal: Located in a vibrant neighborhood known for its community events, historic ambiance, and walkable streets.

Nearby Attractions:

- Portsmouth Naval Shipyard Museum
- High Street Landing
- Local cafes, restaurants, and boutique shops
- Art galleries and cultural venues

Schedule a Tour Today!

Property Photos

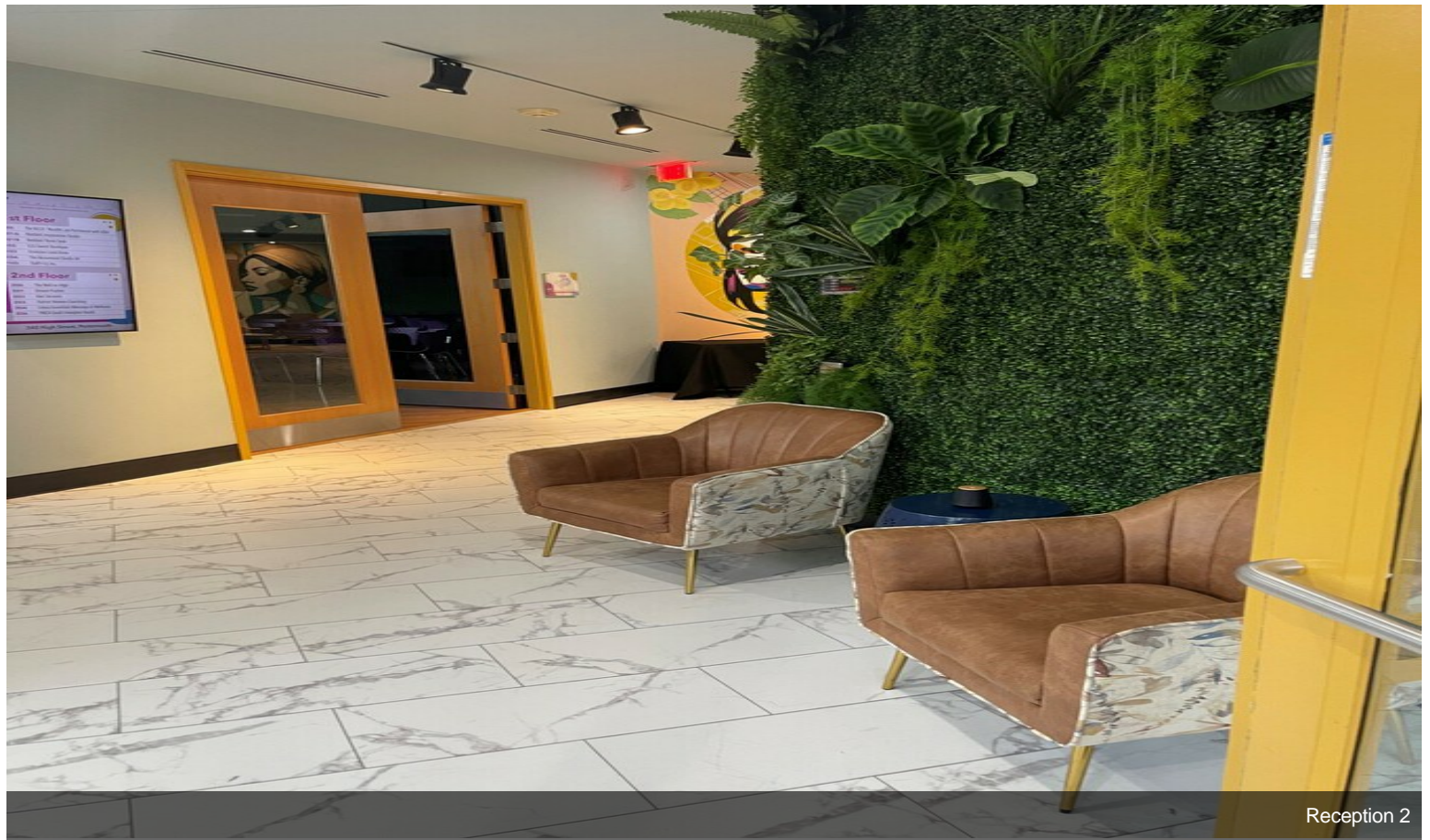

Reception 2

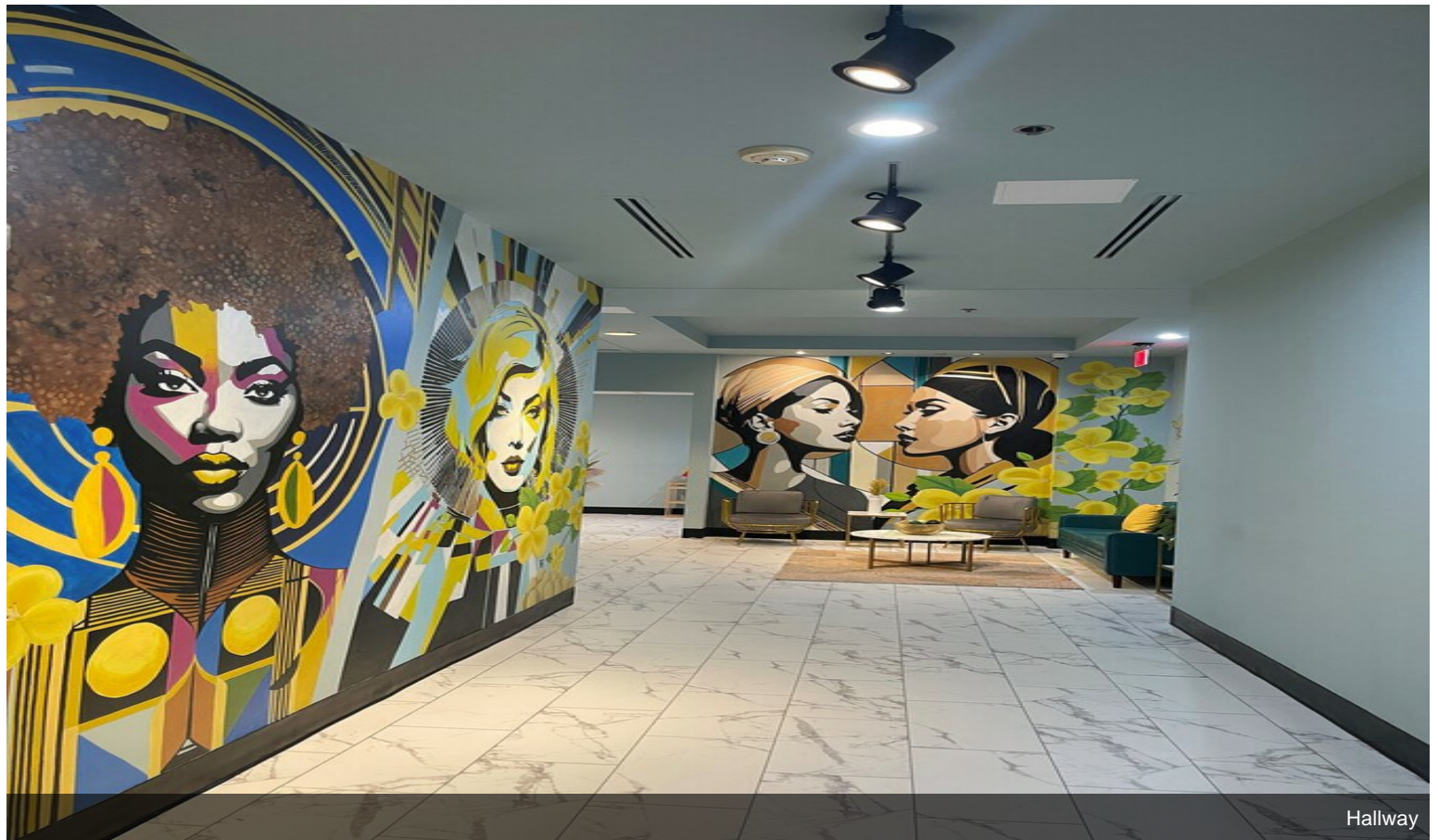

Hallway

Property Photos



Common Area



Kitchen