

BUILDING & COMMERCIAL BAKERY BUSINESS FOR SALE



SCAN & SUBSCRIBE!

LARKIN
INDUSTRIAL GROUP

5045 W Mardon Ave | Las Vegas, NV 89139



NAIExcel
COMMERCIAL REAL ESTATE SERVICES, WORLDWIDE

6064 South Durango Drive,
Las Vegas, NV 89113
702.383.3383 | naiexcel.com

LISTING LEADS

Eric J. Larkin, MBA, CCIM, SIOR

LIC#BS.0073906
702.279.2479
elarkin@naiexcel.com

Leslie Houston
Member Associate, Society of
Industrial and Office Realtors

LIC#S.01879121
660.287.2253
lhouston@naiexcel.com

Michael Kenny, SIOR

LIC#S.0178188
702.408.0963
mkenny@naiexcel.com

Todd Manning

LIC#B.1001879.CORP
702.575.4866
tmanning@naiexcel.com

Sale Details

LIST PRICE	\$14,000,000
PRICE PSF	\$336
BUILDING SQFT	±41,600 SF
ACRES	±3.13 AC

- Concrete Tilt-Up Construction (2006)
- Zoned I-P
- Two Story HVAC Office ± 6,938 SF*
 - Floor 1: ±3,314
 - Floor 2: ±3,624
- 3 Phase, 277/480 V, 2,000 Amps*
- Clear Height - TBD*
- Swamp Coolers
- Two (2) Dock High Doors
- One (1) Grade Level Door
- Freezers
- Coolers
- Ovens
- Cold Kitchens

*To Be Verified By Buyer



OR TEXT 22073 TO 39200

Message frequency will vary. Message and data rates may apply. Reply HELP for help or STOP to cancel.

[ARTI Terms of Service](#) | [ARTI Privacy Statement](#)



Floor Plan

SECOND FLOOR

 [CLICK HERE FOR A 3D TOUR](#)

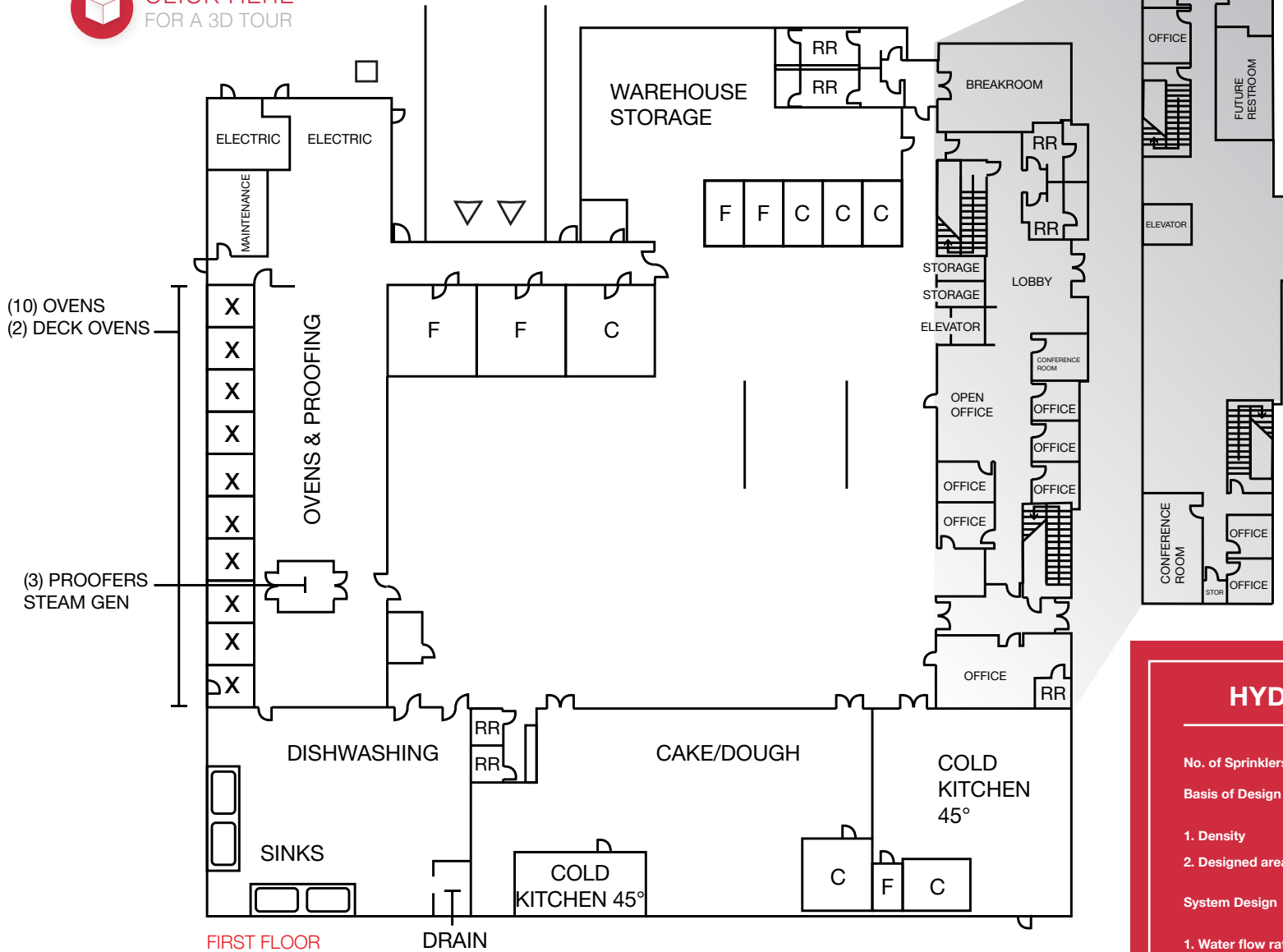

△ - Dock High Loading
 □ - Grade Level Loading

F - Freezer
C - Cooler
X - Ovens

HYDRAULIC SYSTEM	
No. of Sprinklers	9
Basis of Design	
1. Density	.15 GPM/SQFT
2. Designed area of discharge	1,500 SQFT
System Design	
1. Water flow rate	619.403 GPM
2. Residual pressure at the base of the riser	51.054 PSI

Site Plan

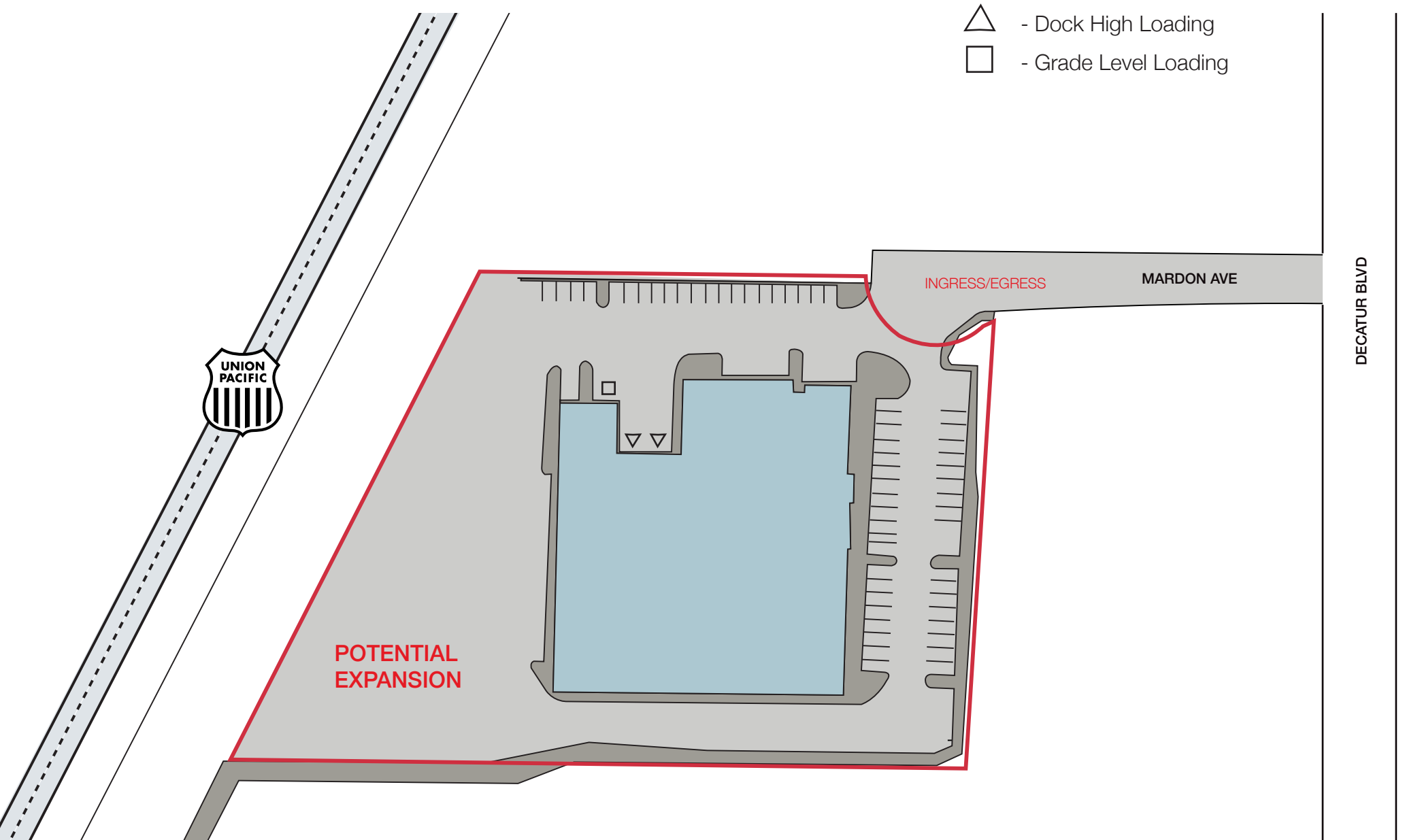









Area Map

- Shops/Tenants
- Schools
- Public Parks
- Govt. Buildings
- Airport



Area Map

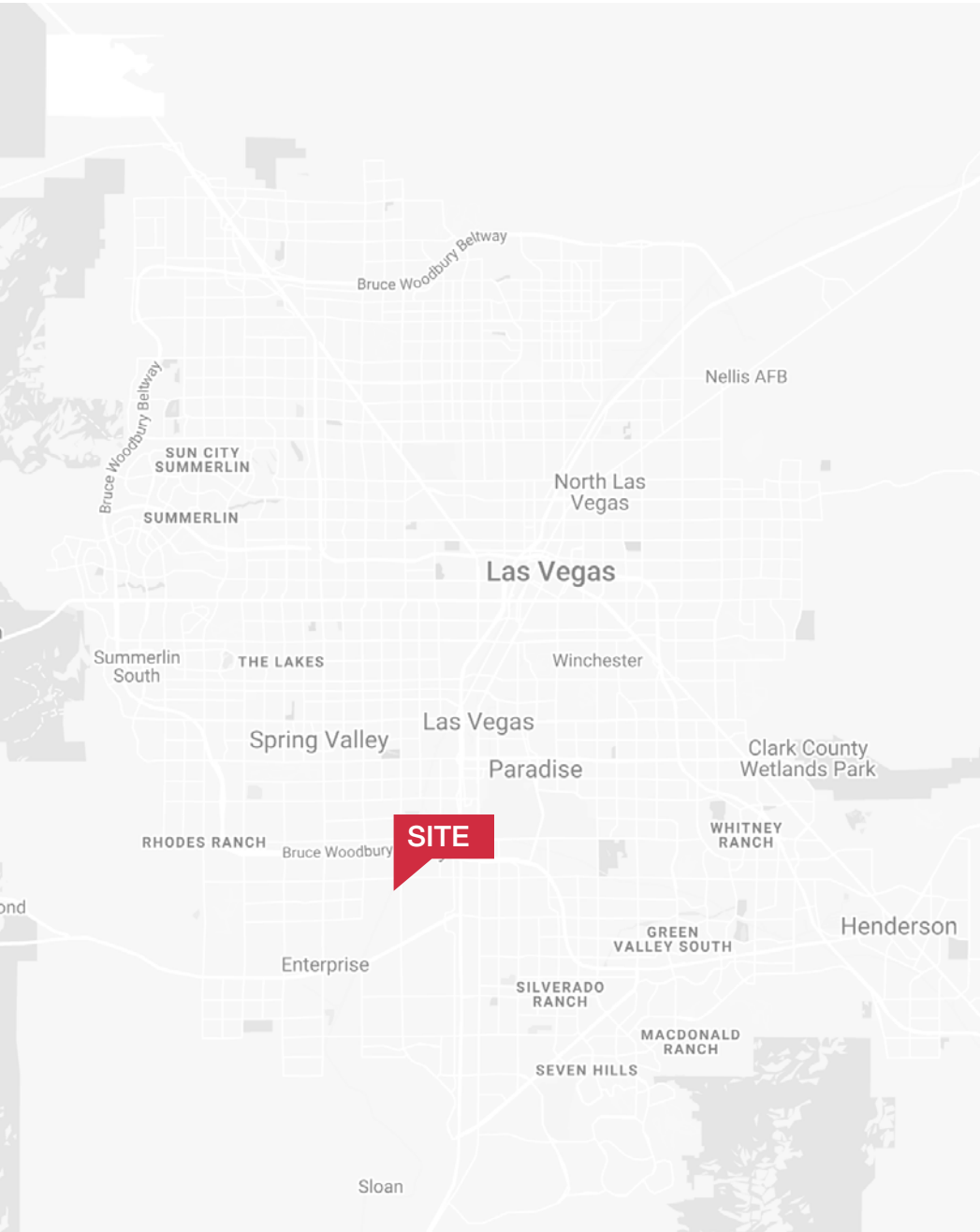



Distance to Major Cities

Salt Lake City, Utah	420 miles
Reno, Nevada	438 miles
Los Angeles, California	270 miles
San Diego, California	332 miles
Denver, Colorado	748 miles
Phoenix, Arizona	305 miles

Market Research

Our offices publish commercial and residential market research across Utah and Nevada. NAI Excel is known for their deep and rich data. Lending institutions, appraisers, and business consultants look to our market reports as the authority on commercial real estate market trends. We have built and maintained a comprehensive database comprised of data collected from some of the largest appraisal firms in the region, NAI transaction, and other data. NAI publishes statistics for the office, retail, industrial, and multifamily markets. Additionally, single family housing reports are published for every major market from Las Vegas to Salt Lake City, through our affiliate.

[ARTI Terms of Service](#) | [ARTI Privacy Statement](#)
<https://brokerstechnology.com/terms-of-use/>
<https://brokerstechnology.com/privacy-policy/>

CLICK HERE



**VIEW MARKET STATISTICS
FOR OFFICE, RETAIL,
INDUSTRIAL & MULTIFAMILY**

<https://excelcres.com/market-research>



6064 South Durango Drive,
Las Vegas, NV 89113
702.383.3383 | naixel.com

LISTING LEADS

Eric J. Larkin, MBA, CCIM, SIOR

LIC#BS.0073906
702.279.2479
elarkin@naixel.com

Leslie Houston

Member Associate, Society of
Industrial and Office Realtors

LIC#S.01879121
660.287.2253
lhouston@naixel.com

Michael Kenny, SIOR

LIC#S.0178188
702.408.0963
mkenny@naixel.com

Todd Manning

LIC#B.1001879.CORP
702.575.4866
tmanning@naixel.com

This offering, including any related digital marketing, contains selected information pertaining to the Property and does not purport to be a representation of the state of the Property, to be all-inclusive, or to contain all or part of the information which interested parties may require to evaluate a purchase or lease of real property.

Neither the seller or NAI Excel, nor any of their respective directors, officers, Affiliates or representatives make any representation or warranty, expressed or implied, as to the accuracy or completeness of this Offering Memorandum or any of its contents, as to the financial performance of the property, or as to the condition of the Property, malfunctions or mechanical defects on the Property or to any improvements thereon, including but not limited to the material, workmanship or mechanical components of the structures, foundations, roof, heating, plumbing, electrical or sewage system, drainage or moisture conditions, air conditioning, or damage by the presence of pests, mold or other organisms, environmental condition, soils conditions, the zoning of the Property, the suitability of the Property for interested parties intended use or purpose, or for any other use or purpose.