

Highland Park Boutique Grocer

Asset Sale



248 N Avenue 50,
Los Angeles, CA 90042





Prime Location

HIGHLAND PARK

248 N Avenue 50, Los Angeles, CA 90042, presents a rare opportunity in the heart of Highland Park. This 3,311 SF second-generation boutique grocery store offers a beautiful, well-positioned space just minutes from both Figueroa and York Boulevard. Surrounded by a diverse community and vibrant culture, the property is ideally suited for a variety of uses, making it a perfect fit for operators looking to establish themselves in one of Los Angeles' most dynamic neighborhoods.



Property Details:

Size: 3,311 sf

Base Rent: \$10,401.51 + CAM: \$2,330.51

License: Type 20

Term: 8 years + options

Parking: Dedicated parking on-site

Recently improved patio

Fully equipped boutique grocery store with Type 20 license.



Floorplan

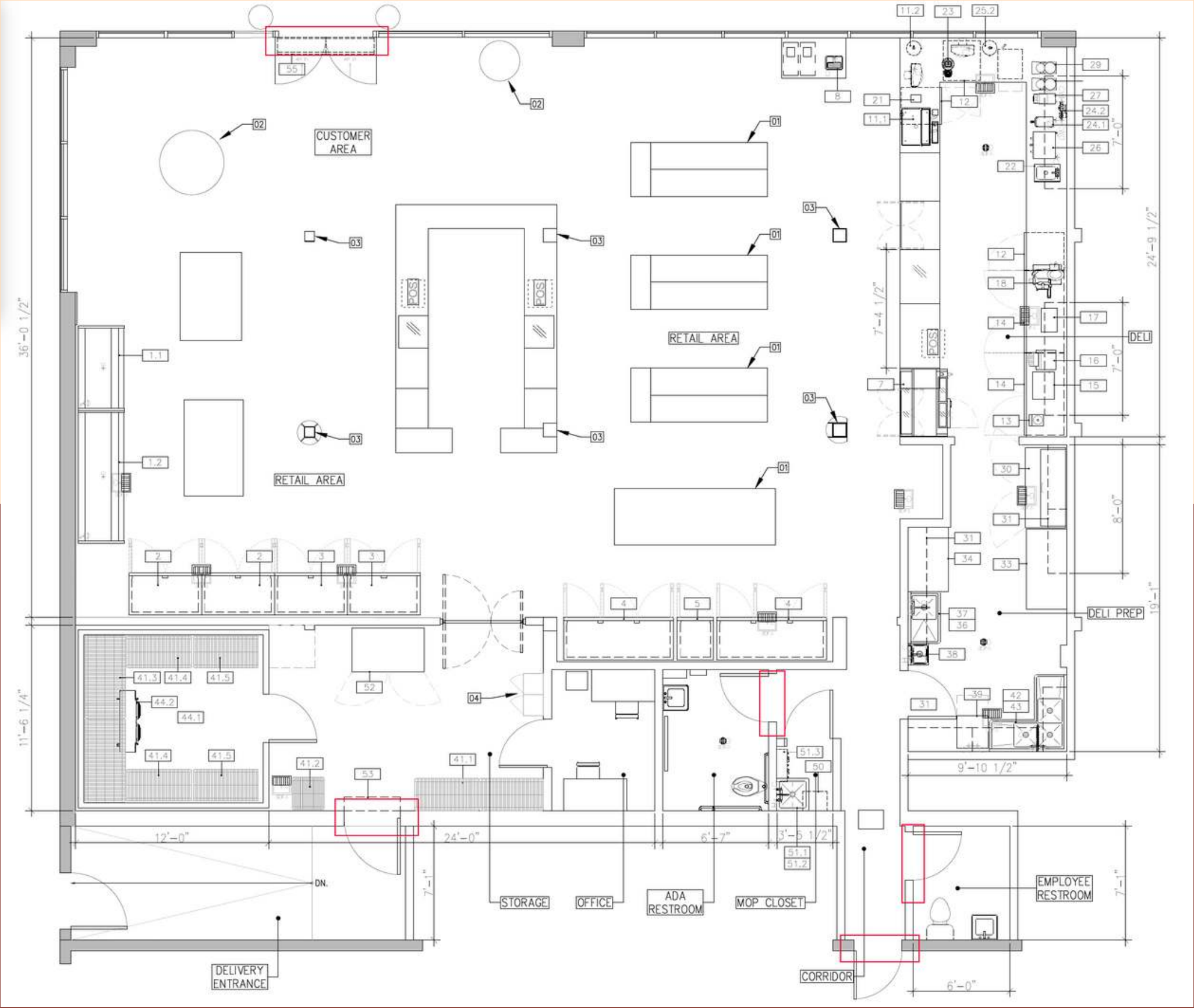

3,311 sf

Neighborhood



LODGE.
ROOM.

lumencoffee



GLORIA'S
CUISINE·LA·

highly likely

Sage
Organic Nail Spa

Rosty

TheBeastBurgerLA

Mendocino Farms

HomeState



JULIE CHAVEZ

213.277.7247 x6

Julie@urbanlimere.com

BRE#02053293