

RETAIL DEVELOPMENT

333 SW CUTOFF

Northborough, MA



TODD ALEXANDER
508.981.7014
alexander@kelleher-sadowsky.com

JAMES UMPHREY
508.635.6790
umphrey@kelleher-sadowsky.com



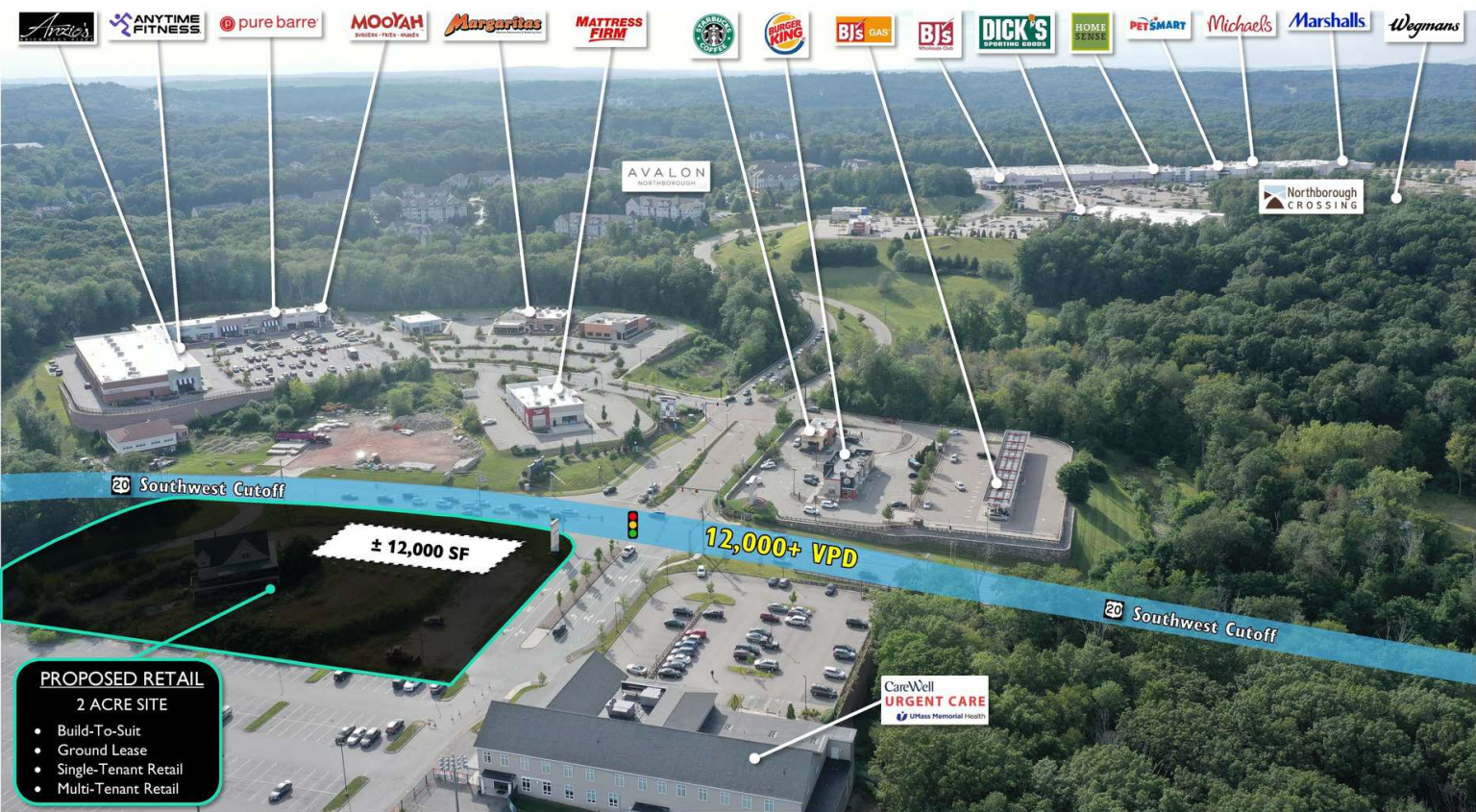

PROPERTY DESCRIPTION

Kelleher & Sadowsky is pleased to present a premier retail opportunity at 333 SW Cutoff, Northborough, MA. This exceptional site is located at the traffic light on Route 20 directly across from the Wegman's anchored Northborough Crossing. The lot totals ± 2 acres proposed for new retail development with frontage on Route 20. Ownership is considering a variety of proposed retail options including ground leases, BTS, multi-tenant retail, single-tenant retail and more. Reach out today to find out more about this rare opportunity to be at a premier location in one of New England's top retail markets!

OFFERING SUMMARY

Lot Size:	± 2 Acres
Proposed Retail Space:	± 12,000 SF

DEMOGRAPHICS	1 MILE	3 MILES	5 MILES
Total Population	4,866	41,514	97,384
Average HH Income	\$183,430	\$185,499	\$174,386

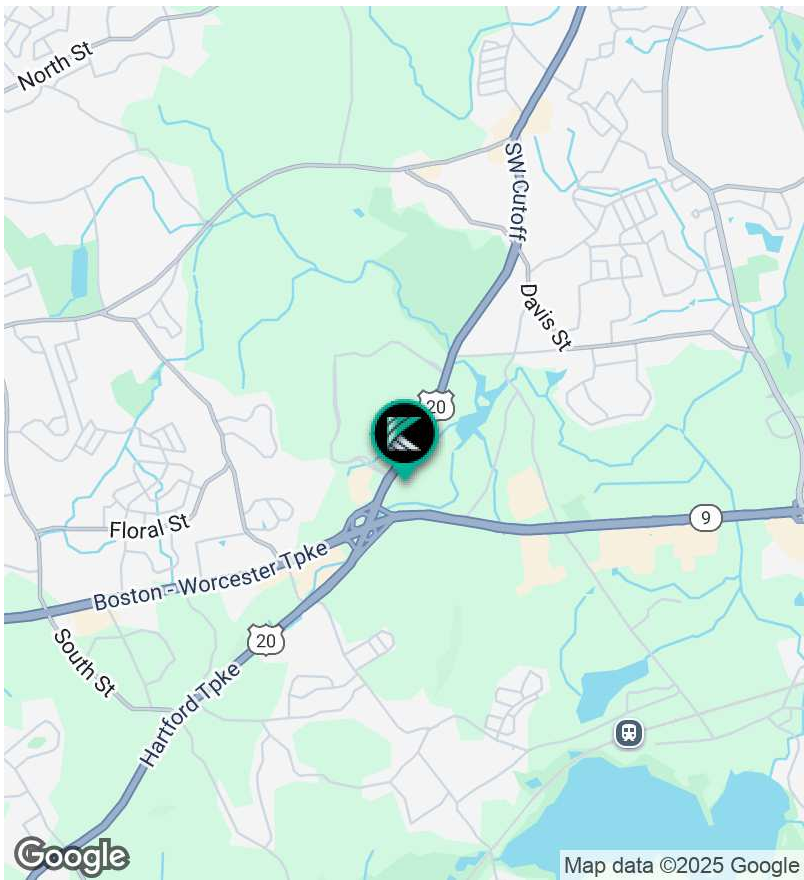



OPTION #1

(Preliminary Sketch)

ROUTE 20 -- SOUTHWEST CUTOFF

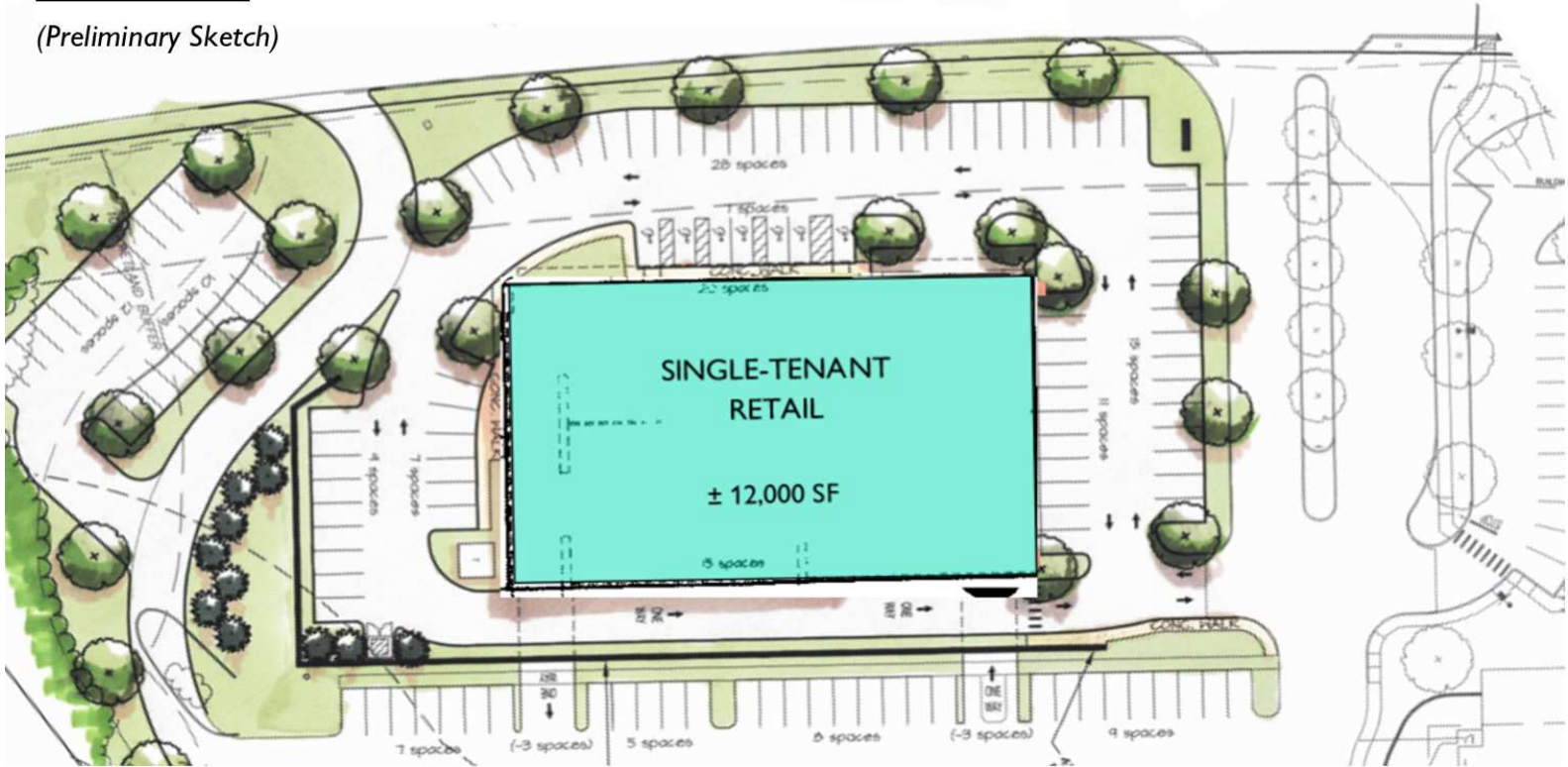

OPTION #2

(Preliminary Sketch)

ROUTE 20 -- SOUTHWEST CUTOFF

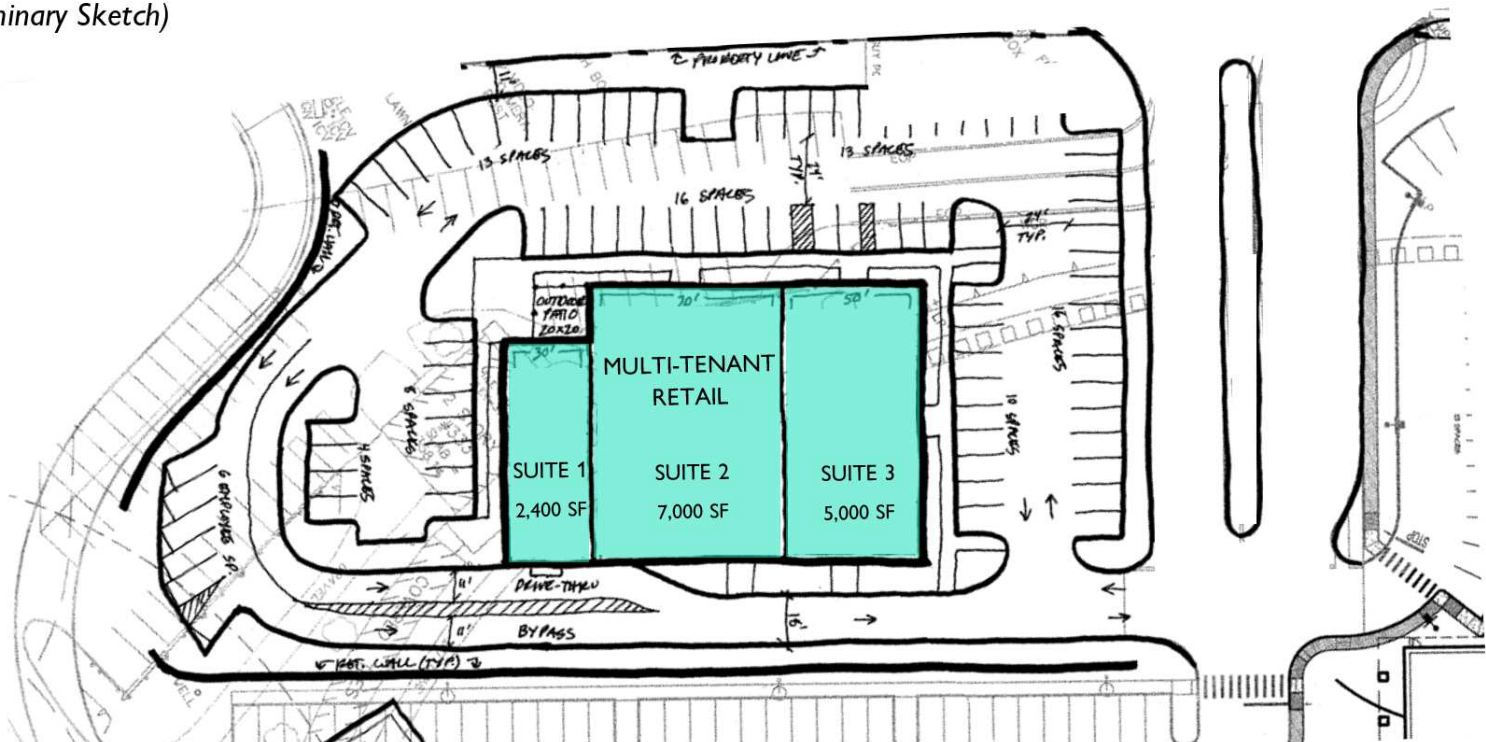

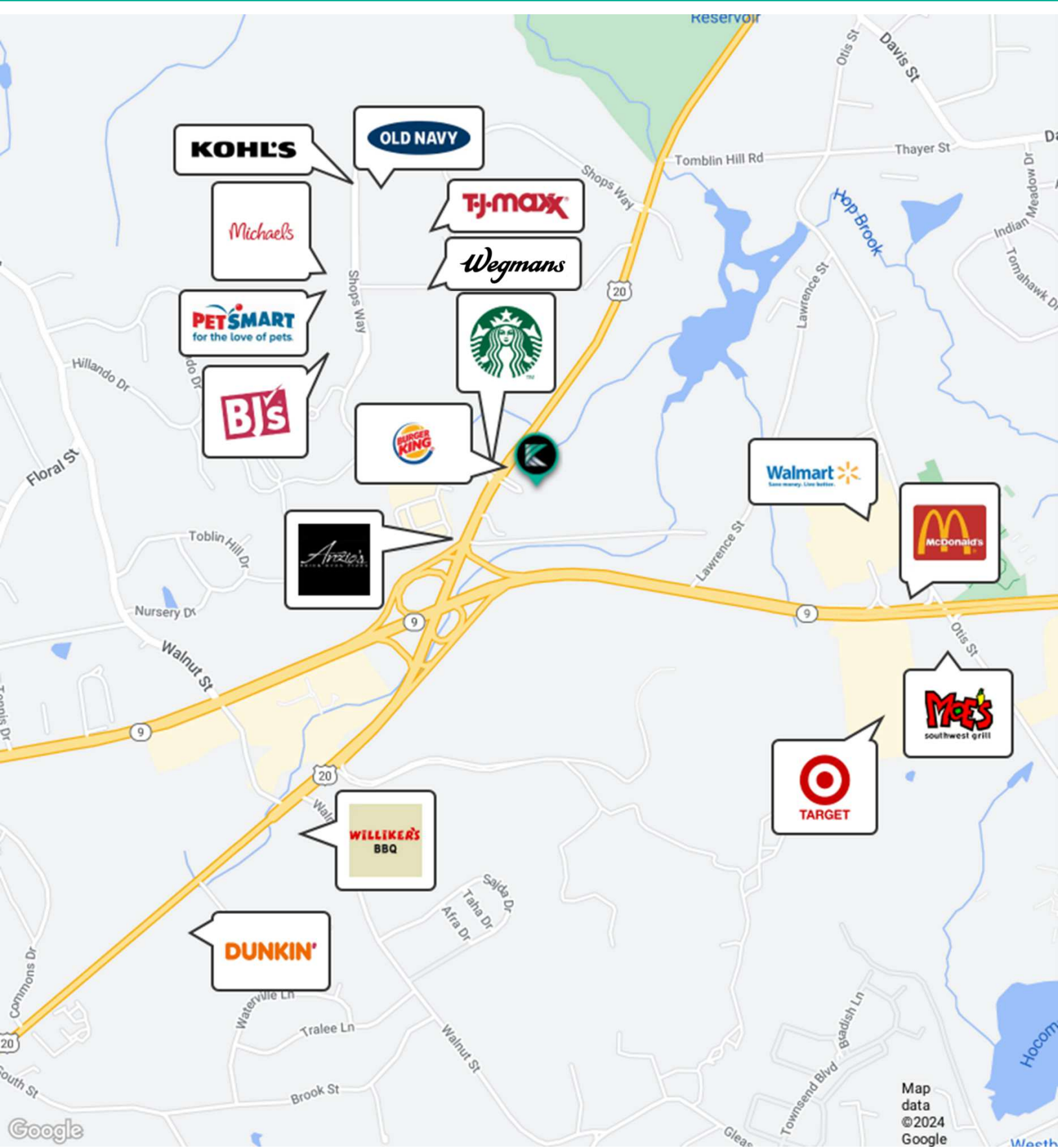

RETAILER MAP

333 SW Cutoff

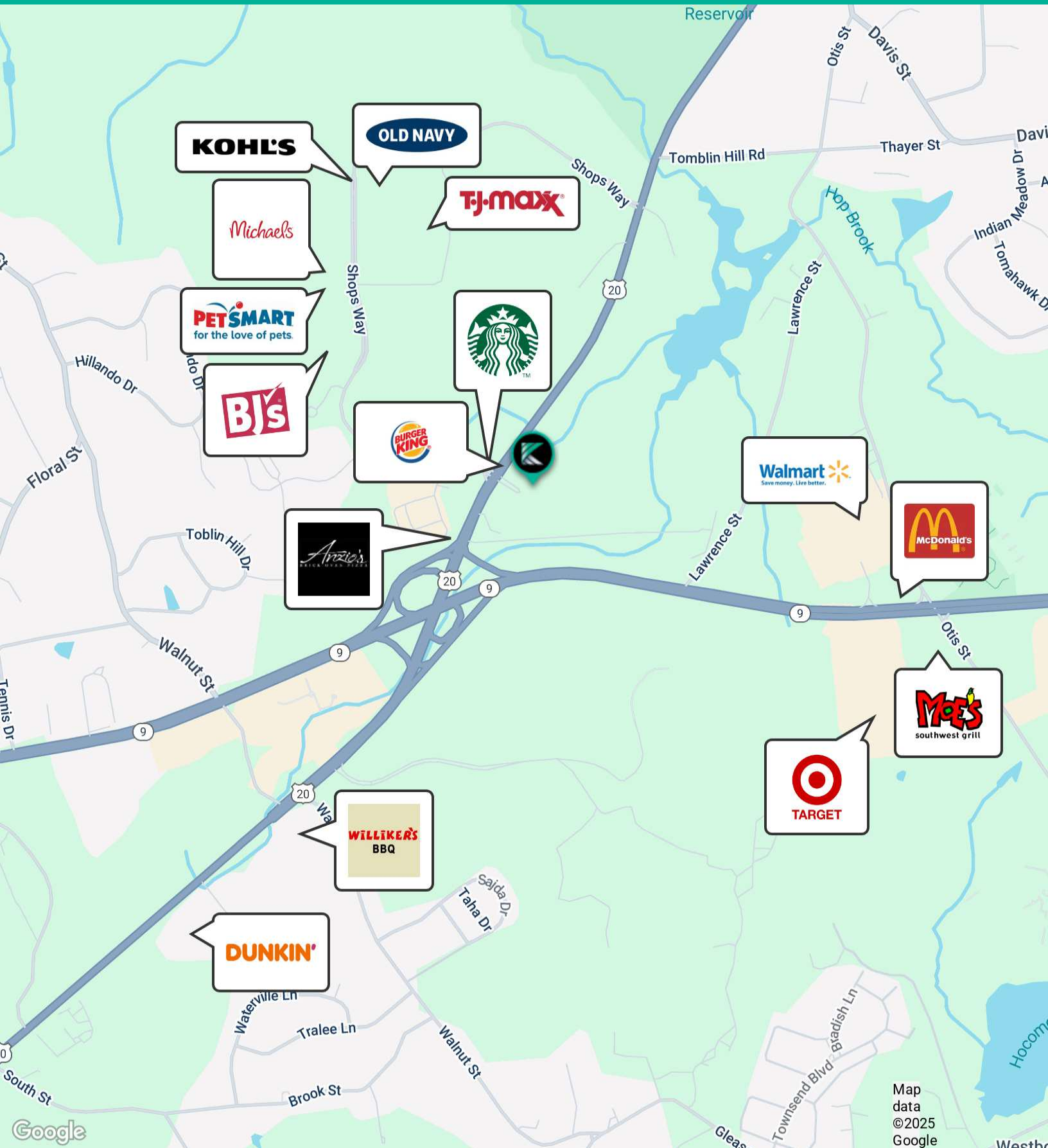

Map data
©2025
Google