

COMMERCIAL OUTPARCEL FOR SALE SUNSET LAKE COMMONS

201 Matthews Drive, Holly Springs, NC 27540



COMMERCIAL REAL ESTATE SERVICES
RALEIGH DURHAM



PROPERTY DESCRIPTION

Commercial parcel for sale in the Sunset Lake Commons shopping center at the intersection of Holly Springs Road and Sunset Lake Road.

PROPERTY HIGHLIGHTS

- ±1.38 acres in Harris Teeter-anchored shopping center
- NMX zoning (Neighborhood Mixed Use) allows for a number of uses including office, medical office, personal services, veterinary clinic, food/restaurant and retail
- Site is rough graded with stubbed utilities
- Majority of storm water management is accounted for in the master development plan
- Rapidly developing area with new I-540 interchange less than one mile from site
- Sale Price: \$1,200,000

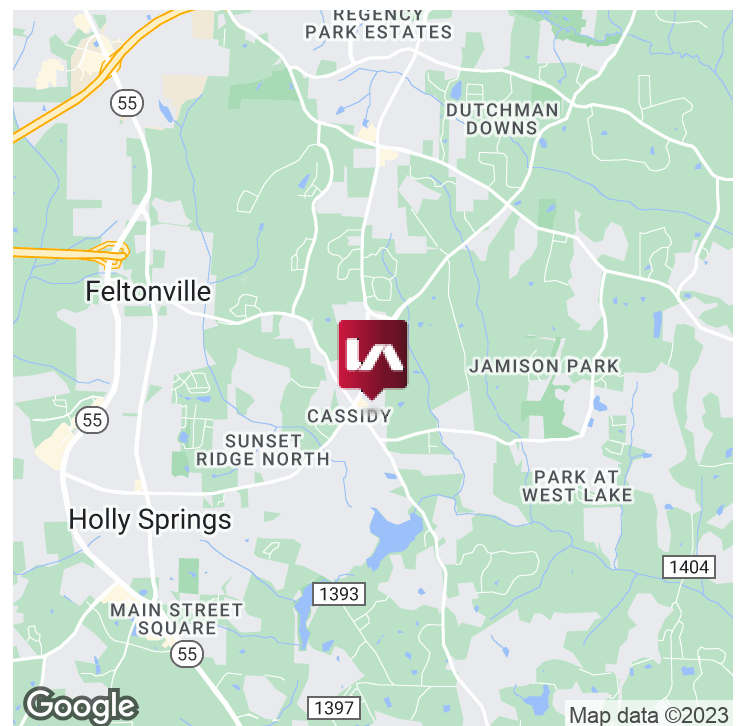

Moss Withers, SIOR, MBA
mwithers@lee-associates.com
O: 919.576.2501
C: 919.576.2501

Karah Jennings McConnell
kjennings@lee-associates.com
O: 919.576.2502
C: 919.817.0705

All information furnished regarding property for sale, rental or financing is from sources deemed reliable, but no warranty or representation is made to the accuracy thereof and same is submitted to errors, omissions, change of price, rental or other conditions prior to sale, lease or financing or withdrawal without notice. No liability of any kind is to be imposed on the broker herein.

COMMERCIAL OUTPARCEL FOR SALE SUNSET LAKE COMMONS

201 Matthews Drive, Holly Springs, NC 27540



COMMERCIAL REAL ESTATE SERVICES
RALEIGH DURHAM

Conceptual Site Plan

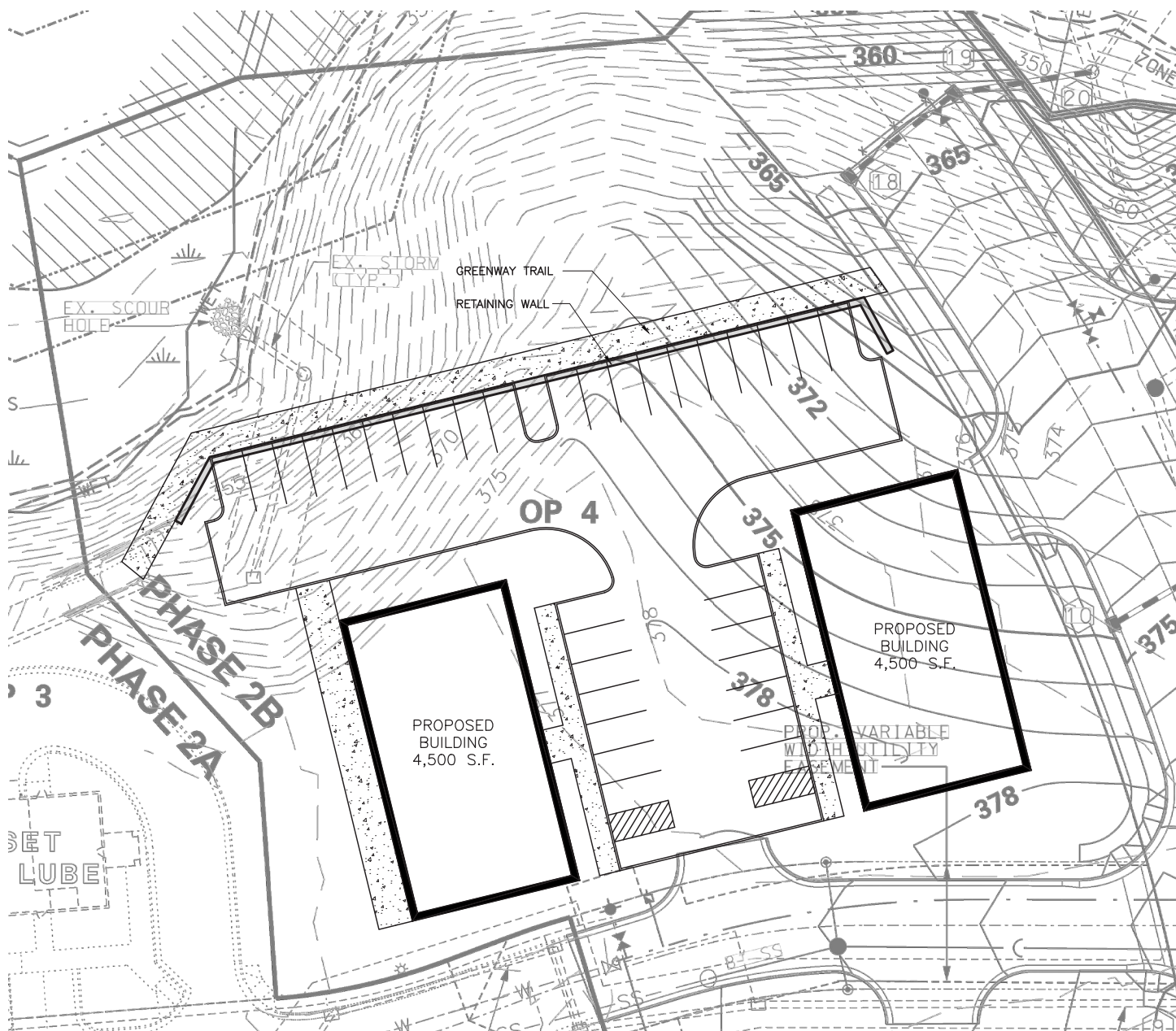

Moss Withers, SIOR, MBA
mwithers@lee-associates.com
O: 919.576.2501
C: 919.576.2501

Karah Jennings McConnell
kjennings@lee-associates.com
O: 919.576.2502
C: 919.817.0705

All information furnished regarding property for sale, rental or financing is from sources deemed reliable, but no warranty or representation is made to the accuracy thereof and same is submitted to errors, omissions, change of price, rental or other conditions prior to sale, lease or financing or withdrawal without notice.
No liability of any kind is to be imposed on the broker herein.

COMMERCIAL OUTPARCEL FOR SALE SUNSET LAKE COMMONS

201 Matthews Drive, Holly Springs, NC 27540



Moss Withers, SIOR, MBA
mwithers@lee-associates.com
O: 919.576.2501
C: 919.576.2501

Karah Jennings McConnell
kjennings@lee-associates.com
O: 919.576.2502
C: 919.817.0705

All information furnished regarding property for sale, rental or financing is from sources deemed reliable, but no warranty or representation is made to the accuracy thereof and same is submitted to errors, omissions, change of price, rental or other conditions prior to sale, lease or financing or withdrawal without notice. No liability of any kind is to be imposed on the broker herein.

COMMERCIAL OUTPARCEL FOR SALE SUNSET LAKE COMMONS

201 Matthews Drive, Holly Springs, NC 27540

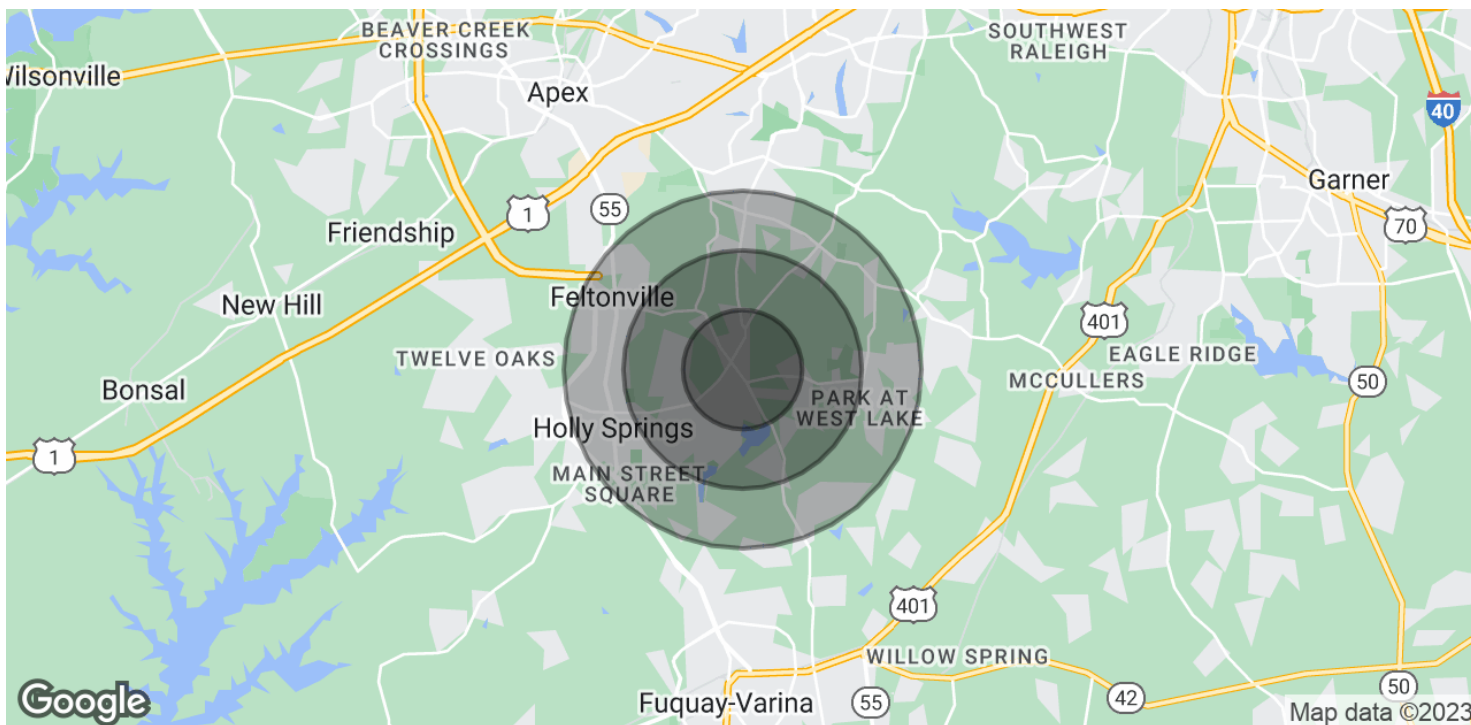

POPULATION

| | 1 MILE | 2 MILES | 3 MILES |
|----------------------|--------|---------|---------|
| Total Population | 5,615 | 22,699 | 44,443 |
| Average Age | 38.1 | 37.7 | 37.7 |
| Average Age (Male) | 38.4 | 38.2 | 37.6 |
| Average Age (Female) | 35.8 | 35.0 | 36.4 |

HOUSEHOLDS & INCOME

| | 1 MILE | 2 MILES | 3 MILES |
|---------------------|-----------|-----------|-----------|
| Total Households | 1,856 | 7,543 | 15,514 |
| # of Persons per HH | 3.0 | 3.0 | 2.9 |
| Average HH Income | \$141,707 | \$138,031 | \$130,052 |
| Average House Value | \$369,585 | \$365,624 | \$358,729 |

* Demographic data derived from 2020 ACS - US Census

Moss Withers, SIOR, MBA
mwithers@lee-associates.com
O: 919.576.2501
C: 919.576.2501

Karah Jennings McConnell
kjennings@lee-associates.com
O: 919.576.2502
C: 919.817.0705

All information furnished regarding property for sale, rental or financing is from sources deemed reliable, but no warranty or representation is made to the accuracy thereof and same is submitted to errors, omissions, change of price, rental or other conditions prior to sale, lease or financing or withdrawal without notice. No liability of any kind is to be imposed on the broker herein.