

1852 E 46TH ST.
LOS ANGELES 90058



DOWNTOWN ALAMEDA

INDUSTRIAL CENTER
LOS ANGELES 90058



FOR LEASE

5,088 SF

DOCK HIGH LOADING

22' CLEAR W/ CALCULATED FIRE SPRINKLERS

Click for Video Tour



ERIC REAVIS, SIOR

01216423

213.709.6760

eric@reavisrealty.com

www.reavisrealty.com

01

Property Highlights

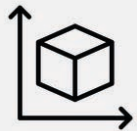

5,088 SF
AVAILABLE SF



ONE DOCK HIGH SPOT
EASY CONTAINER & 53'
TRAILER ACCESS



22' CLEARANCE



5-CAR PARKING
GATED YARD

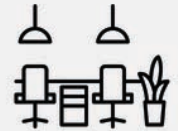

800 SF
WELL APPOINTED OFFICES



**CALCULATED FIRE
SPRINKLERS**



SKYLIGHTS
& FOIL INSULATION



ON-SITE SECURITY
ON NIGHTS & WEEKENDS



CLOSE-IN LOCATION
MINUTES TO DTLA, ARTS &
FASHION DISTRICT



LED LIGHTING
IN WAREHOUSE & OFFICES

This information supplied herein is from sources we deem reliable. It is provided without any representation, warranty or guarantee, expressed or implied as to its accuracy. A prospective buyer or tenant should conduct an independent investigation and verification of all matters deemed to be material.

02

Specs

BUILDING SIZE	5,088 SF
LAND SIZE	POL
OFFICE SIZE	800 SF
DOCK HIGH POSITIONS	1
FENCED PARKING	5
FIRE SPRINKLERS	YES, CALCULATED
LIGHTING	LED
SKYLIGHTS	YES
ELECTRICAL SERVICE	100A, 120/240V, 1-Ph, 3W
CONSTRUCTION	CONCRETE TILT-UP
ZONING	M2
OCCUPANCY	05/01/26
LEASE RATE	\$1.29 PSF, 1G
CURRENT CAM	\$0.07 PSF



This information supplied herein is from sources we deem reliable. It is provided without any representation, warranty or guarantee, expressed or implied as to its accuracy. A prospective buyer or tenant should conduct an independent investigation and verification of all matters deemed to be material.

03

Location Highlights

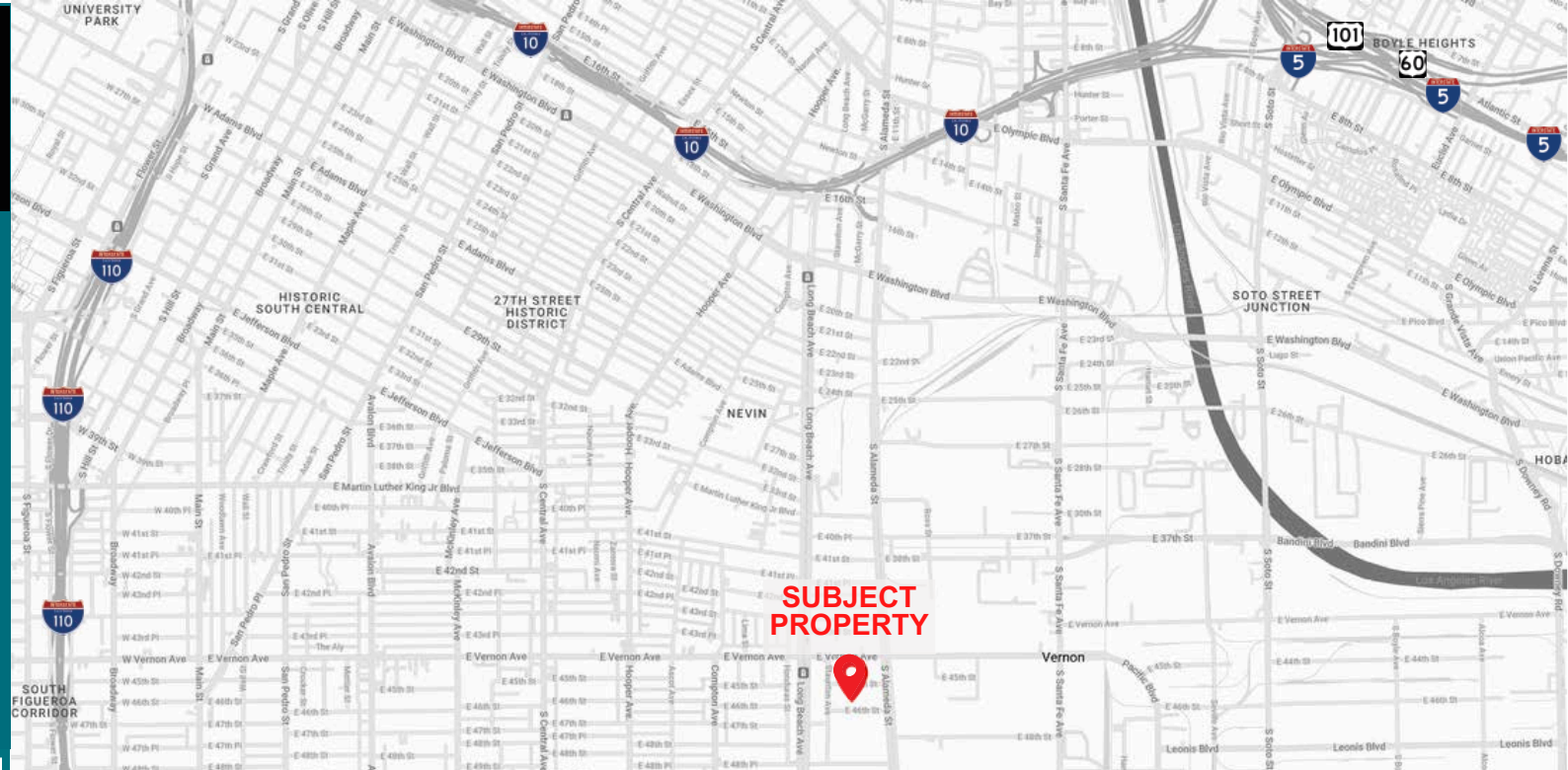

5 MINUTES TO DTLA, ARTS DISTRICT & FASHION DISTRICT

APPROXIMATELY 1 MILE SOUTH OF SANTA MONICA (10) FWY

BEST SMALL, DOCK-HIGH SPACE CLOSE TO DTLA

LOS ANGELES LOCATION, NO VERNON WAREHOUSE/PARCEL TAX

**DOWNTOWN
ALAMEDA
INDUSTRIAL
CENTER**

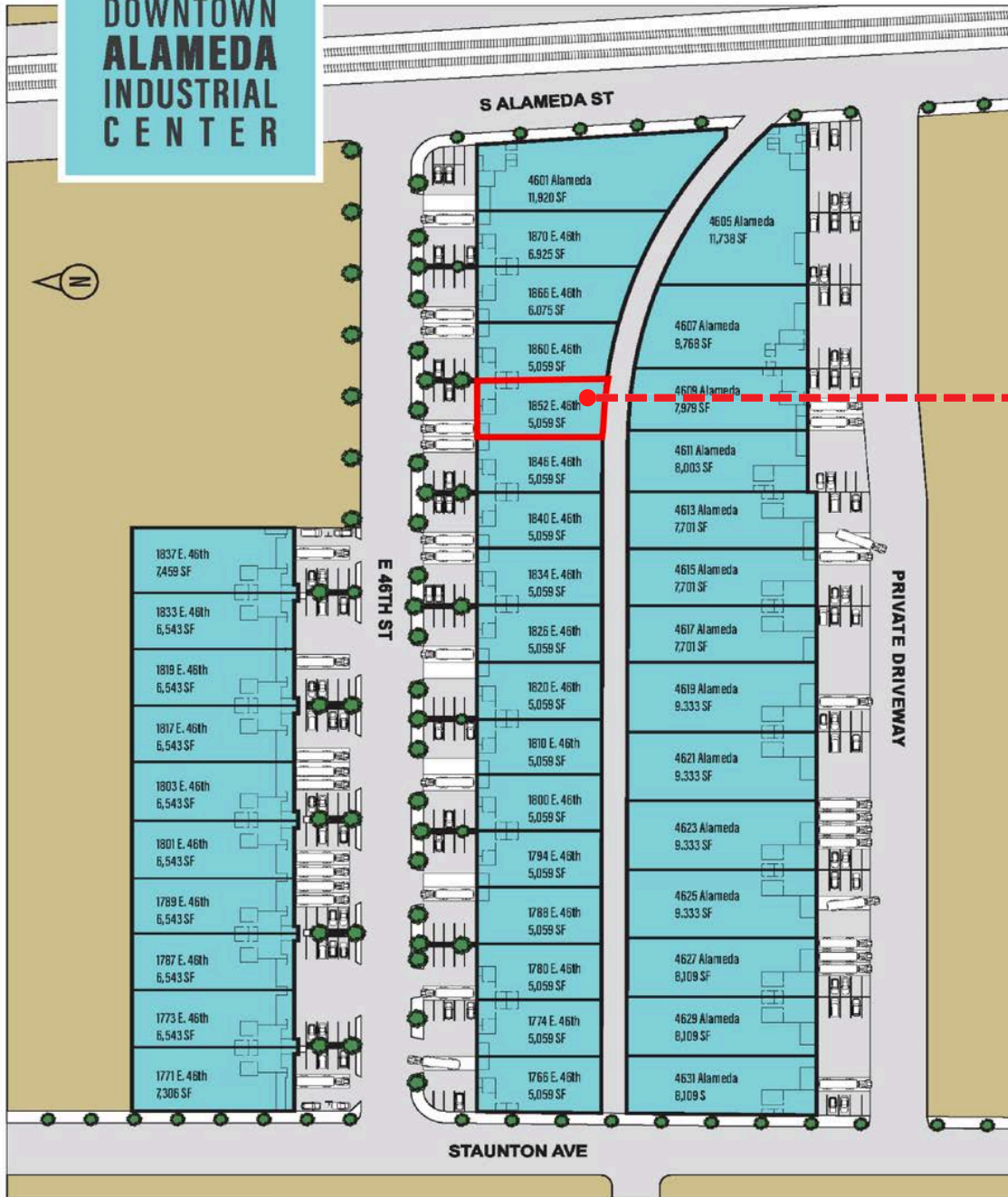

AVAILABLE

04
**Property
Site Plan**



NOT TO SCALE. SITE PLAN MAY NOT REFLECT CURRENT OFFICE LAYOUT.

This information supplied herein is from sources we deem reliable. It is provided without any representation, warranty or guarantee, expressed or implied as to its accuracy. A prospective buyer or tenant should conduct an independent investigation and verification of all matters deemed to be material.



REAVIS REALTY
INDUSTRIAL REAL ESTATE

05

Photos

Typical Post-Refurbishment
Condition



This information supplied herein is from sources we deem reliable. It is provided without any representation, warranty or guarantee, expressed or implied as to its accuracy. A prospective buyer or tenant should conduct an independent investigation and verification of all matters deemed to be material.

6 1852 E 46TH ST

ERIC REAVIS, SIOR



01216423



213.709.6760



eric@reavisrealty.com



ERIC REAVIS, SIOR

 01216423

 213.709.6760

 eric@reavisrealty.com

www.reavisrealty.com