

Sylmar, CA 91342

YOSHIE BROCIIOUS

818-778-1112
properties_4_u@yahoo.com

Office: General Realty
Group,Inc.

State Lic#: 00847596

\$5,600,000

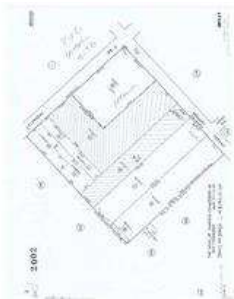

2 parcel and sold together, 1) 11555 Eldridge Av., is 129,822 Sqft.,(2.98 A/C)., 2) 11545 Kagele Canyon St., is 68,249 Sqft.(1.56678 A/C) Total: 198,071 Sqft.,(4.54 A/C)Land!! Zone is same #LARS., and land must sold together. This lot for last resource for Developer dream flat land, less 5 minute way from fwy#210. Nice and quiet neighbor hood in Sylmar. Sold is "As Is". Both has a good paved street and all utility is in public.

-
- View: None