

FOR LEASE

FOUNDERS BUSINESS PARK

OFFICE | R&D | INDUSTRIAL



1240-1250 NORTH LAKE VIEW AVENUE

ANAHEIM, CALIFORNIA

GENERAL INFORMATION

- Corporate Image Project
- Office / R&D / Industrial
- Excellent Access to the 91, 57 and 55 Freeways
- Major Street Frontage
- Ample Parking
- Flexible Unit Layouts
- Professionally Managed by Kraemer Land Company

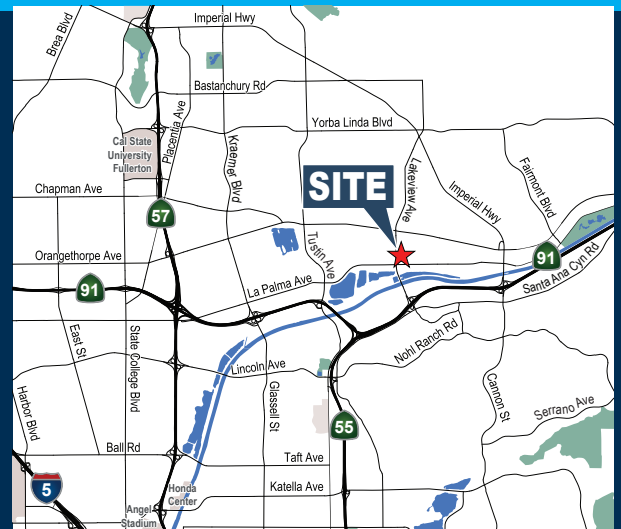

Voit

REAL ESTATE SERVICES

Barry Walshe
Vice President | Partner
(714) 935-2309
bwalshe@voitco.com
Lic. #01991785

Mike Boomer
Vice President
714.935.2344
mboomer@voitco.com
Lic. #01209091

PROFESSIONALLY MANAGED BY



2400 E. Katella Avenue, Suite 750 | Anaheim, California 92806 | (714) 978-7880 | (714) 978-9431 FAX | Lic #01991785 | www.VoitCo.com

Licensed as Real Estate Salespersons by the DRE. The information contained herein has been obtained from sources we deem reliable. While we have no reason to doubt its accuracy, we do not guarantee it. ©2021 Voit Real Estate Services, Inc. All Rights Reserved. Lic #01991785.

FOR LEASE

OFFICE | R&D | INDUSTRIAL

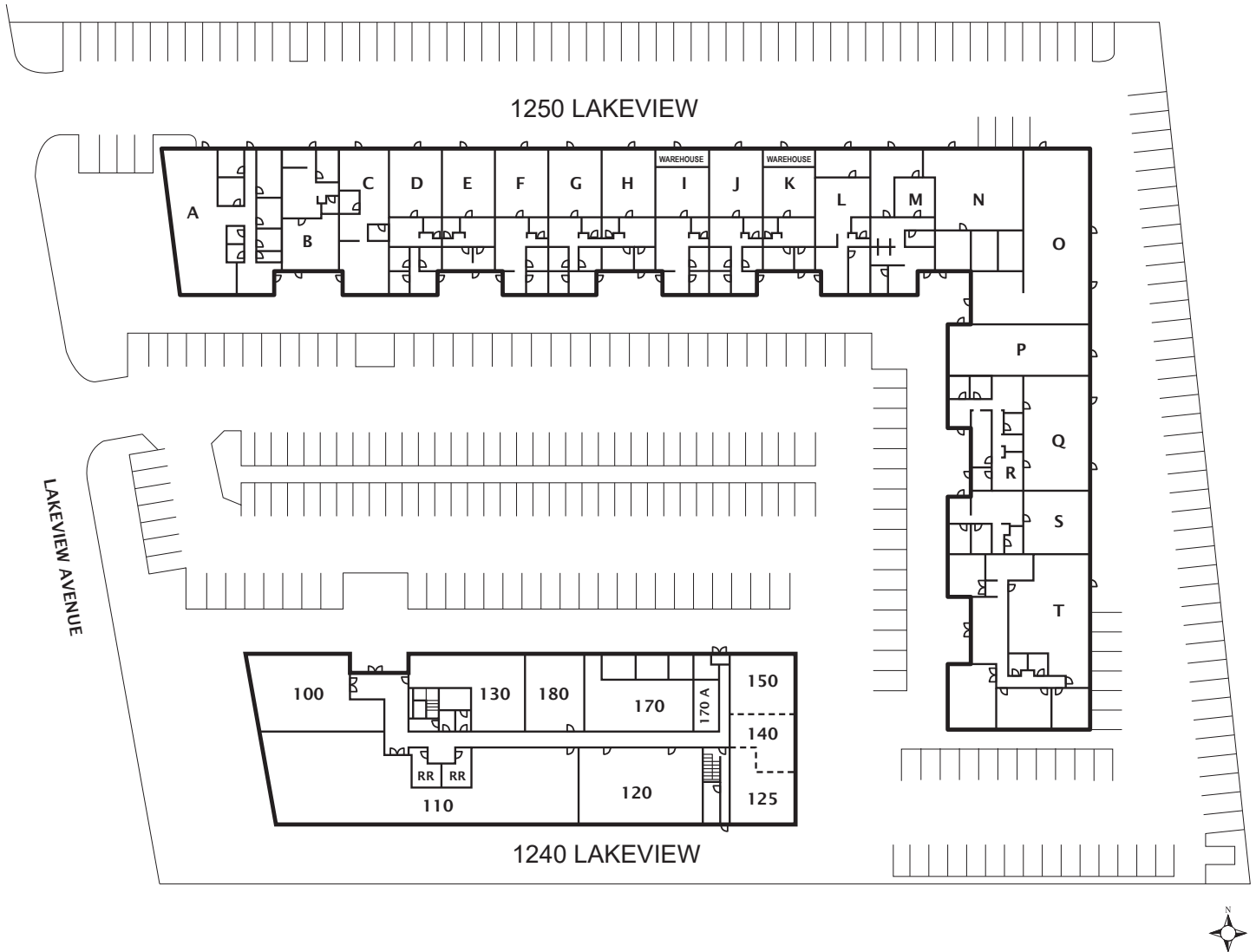

1240-1250 NORTH LAKE VIEW AVE.

ANAHEIM, CALIFORNIA

Voit

REAL ESTATE SERVICES

Barry Walshe
Vice President | Partner
(714) 935-2309
bwalshe@voitco.com
Lic. #01991785

Mike Boomer
Vice President
714.935.2344
mboomer@voitco.com
Lic. #01209091

PROFESSIONALLY MANAGED BY



2400 E. Katella Avenue, Suite 750 | Anaheim, California 92806 | (714) 978-7880 | (714) 978-9431 FAX | Lic #01991785 | www.VoitCo.com

Licensed as Real Estate Salespersons by the DRE. The information contained herein has been obtained from sources we deem reliable. While we have no reason to doubt its accuracy, we do not guarantee it. ©2021 Voit Real Estate Services, Inc. All Rights Reserved. Lic #01991785.