

2777 28TH STREET SW
WYOMING, MICHIGAN

VACANT LAND FOR SALE
2.12 Acres Available



**SIGNATURE
ASSOCIATES**
KNOW SIGNATURE | KNOW RESULTS

INDUSTRIAL LAND



PROPERTY FEATURES

- Prime 2.12 acres available
- Zoned I-1 (Master Planned Commercial Corridor)
- Over 230' of frontage with curb-cut
- Utilities available at the street
- Uses included off-street parking, tool and die shops and manufacturing, to name a few
- Sale Price: \$1,500,000 (\$706,547/acre)

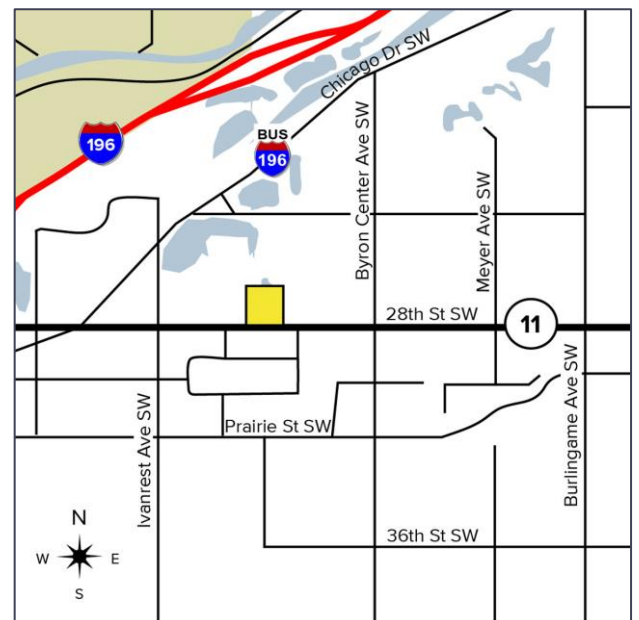

For more information, please contact:

JOE RIZQALLAH
(616) 822 6310

jrizzqallah@signatureassociates.com

PETER CACHEY
(616) 259 6386

pcachey@signatureassociates.com

SIGNATURE ASSOCIATES

1188 East Paris Ave SE, Suite 220
Grand Rapids, MI 49546
www.signatureassociateswm.com

Zoning | Master Planned Commercial Corridor

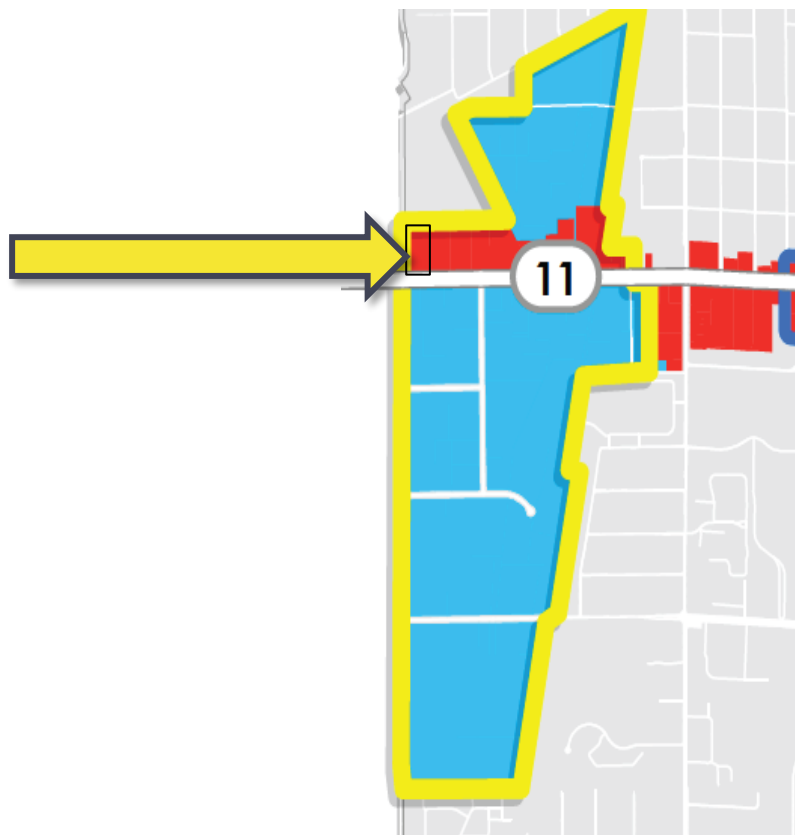

PER: WYOMING [RE]IMAGINED MASTER PLAN Commercial Corridor.

Revitalize and enhance the image of concentrated commercial corridors through streetscaping and reinvestment strategies that attract quality retail, dining, office, and entertainment businesses.

DEMOGRAPHICS		
	POPULATION	MED. HH INCOME
1 MILE	8,670	\$69,048
3 MILE	84,560	\$83,235
5 MILE	229,319	\$77,643

TRAFFIC COUNTS (TWO-WAY)	
26,754	28 th Street west of Ivanrest Avenue
25,177	28 th Street east of Byron Center Avenue
11,052	Ivanrest Avenue south of 28 th Street
12,147	Byron Center Avenue south of 28 th Street

For more information, please contact:

JOE RIZQALLAH
(616) 822 6310
jrizzqallah@signatureassociates.com

PETER CACHEY
(616) 259 6386
pcachey@signatureassociates.com

SIGNATURE ASSOCIATES
1188 East Paris Ave SE, Suite 220
Grand Rapids, MI 49546
www.signatureassociateswm.com