

Montgomery Gateway

9380 Montgomery Road
Montgomery, OH

Property Highlights

- + Former Fitness Studio Available
 - 2,476 SF
- + Mixed-use building located in the heart of downtown Montgomery
 - On-site parking garage with 90 spaces
- + Adjacent to Montgomery Quarter, \$140M mixed-use development
- + Within a mile of I-71 with easy access to Ronald Reagan Cross County Hwy
- + Excellent visibility and frontage on Montgomery Rd
- + Under half a mile from Moeller High School (879 students)



Contact Us

John Abraham

First Vice President
+1 513 369 1315
john.abraham@cbre.com

Mike Seliga

Associate
+1 513 369 1394
mike.seliga@cbre.com

Lacey Kelly

Associate
+1 513 369 1640
lacey.kelly@cbre.com

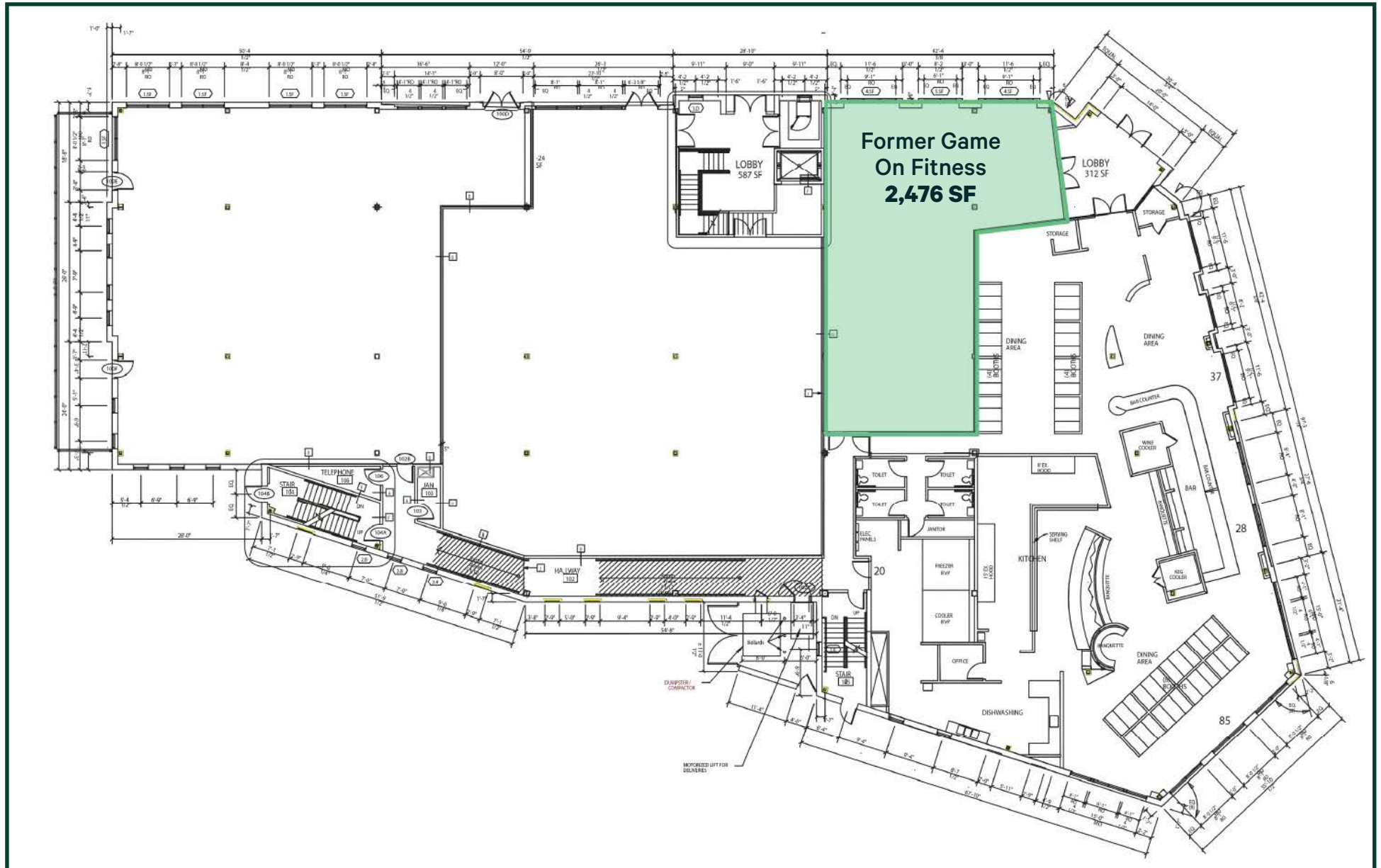

Market Overview



Parking Overview



#	Lot	Spaces
1	Shelly Lot	180
2	Montgomery Gateway Garage	90
3	Roosa Garage	161
4	Ayers Lot/Montgomery Garage	170

Montgomery Gateway

9380 Montgomery Rd | Montgomery, OH 45242

For Lease

Former Game On Fitness - 2,476 SF



Market Insights

Demographics	1 Mile	3 Mile	5 Mile
Population	5,226	53,338	137,205
Daytime Population	7,527	81,075	170,149
Median Age	47.1	41.8	41.8
Households	1,821	21,042	56,022
Average Household Income	\$185,534	\$159,648	\$145,619

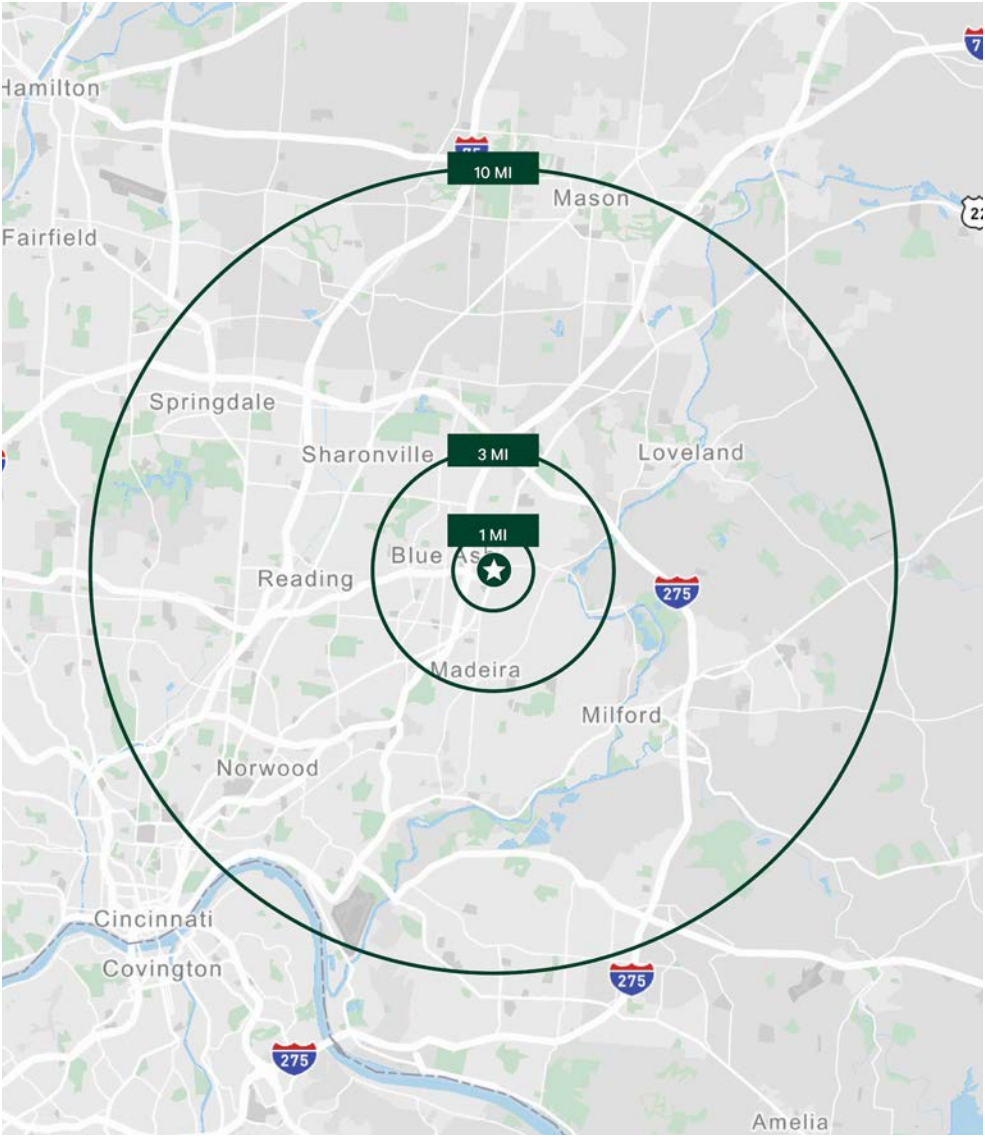

Contact Us

John Abraham
First Vice President
+1 513 369 1315
john.abraham@cbre.com

Mike Seliga
Associate
+1 513 369 1394
mike.seliga@cbre.com

Lacey Kelly
Associate
+1 513 369 1640
lacey.kelly@cbre.com

© 2024 CBRE, Inc. All rights reserved. This information has been obtained from sources believed reliable, but has not been verified for accuracy or completeness. You should conduct a careful, independent investigation of the property and verify all information. Any reliance on this information is solely at your own risk. CBRE and the CBRE logo are service marks of CBRE, Inc. All other marks displayed on this document are the property of their respective owners, and the use of such logos does not imply any affiliation with or endorsement of CBRE. Photos herein are the property of their respective owners. Use of these images without the express written consent of the owner is prohibited.

