

AVAILABLE FOR SALE

±96,290 SF FREESTANDING INDUSTRIAL BUILDING

1822 FRANCIS STREET
ONTARIO, CALIFORNIA



JOHN SEOANE | SIOR
SENIOR VICE PRESIDENT/PRINCIPAL
909.373.2946
jseoane@lee-assoc.com
DRE #01453455

RYAN DE GUZMAN
SENIOR VICE PRESIDENT/PRINCIPAL
909.373.2926
rdeguzman@lee-assoc.com
DRE #02101391

LEE & ASSOCIATES - ONTARIO
3535 Inland Empire Boulevard
Ontario, California 91764
(909) 989-7771 | lee-associates.com

LEE & ASSOCIATES
COMMERCIAL REAL ESTATE SERVICES
ONTARIO
CORPORATE ID #00976995

AVAILABLE FOR SALE

VINEYARD & FRANCIS COMMERCE CENTER

1822 FRANCIS STREET
ONTARIO, CALIFORNIA

PROPERTY FEATURES

- VINEYARD & FRANCIS COMMERCE CENTER - BUILDING A
- ±96,290 SQUARE FOOT FREESTANDING INDUSTRIAL BUILDING
- ±4.03 ACRE PARCEL OF LAND
- ±6,087 SQUARE FEET OF OFFICE SPACE
- DIVISIBLE INTO TWO INDUSTRIAL SUITES:
 - SUITE A: ±43,342 SQUARE FEET WITH ±3,036 SQUARE FEET OF OFFICE SPACE
 - SUITE B: ±52,948 SQUARE FEET WITH ±3,051 SQUARE FEET OF OFFICE SPACE
- SEVENTEEN (17) DOCK HIGH DOORS WITH SEVEN (7) EDGE OF DOCK LEVELERS
- THREE (3) GROUND LEVEL LOADING DOORS
- 0.45 GPM / 3,000 SF SPRINKLER SYSTEM
- 24' MINIMUM CLEARANCE HEIGHT
- 1,200 AMPS, 277/480 VOLTS OF POWER
- LARGE TRUCK COURT WITH ACCESS OFF VINEYARD AVENUE & FRANCIS STREET
- ±1-MILE DRIVING DISTANCE TO THE CA-60 FREEWAY VIA VINEYARD AVENUE
- ±4.4-MILE DRIVING DISTANCE TO THE I-15 FREEWAY VIA JURUPA STREET
- ±4.5-MILE DRIVING DISTANCE TO THE I-10 FREEWAY VIA HAVEN AVENUE
- ±3.9-MILE DRIVING DISTANCE TO THE FEDEX AND AMAZON HUBS LOCATED AT THE ONTARIO INTL' AIRPORT
- EXTERIOR AND INTERIOR RENOVATIONS COMPLETED IN 2021



JOHN SEOANE | SIOR
SENIOR VICE PRESIDENT/PRINCIPAL
909.373.2946
jseoane@lee-assoc.com
DRE #01453455

RYAN DE GUZMAN
SENIOR VICE PRESIDENT/PRINCIPAL
909.373.2926
rdeguzman@lee-assoc.com
DRE #02101391

LEE & ASSOCIATES - ONTARIO
3535 Inland Empire Boulevard
Ontario, California 91764
(909) 989-7771 | lee-associates.com

LEE & ASSOCIATES
COMMERCIAL REAL ESTATE SERVICES
ONTARIO
CORPORATE ID #00976995

AVAILABLE FOR SALE
VINEYARD & FRANCIS COMMERCE CENTER

1822 FRANCIS STREET
ONTARIO, CALIFORNIA

1822 FRANCIS STREET SITE PLAN

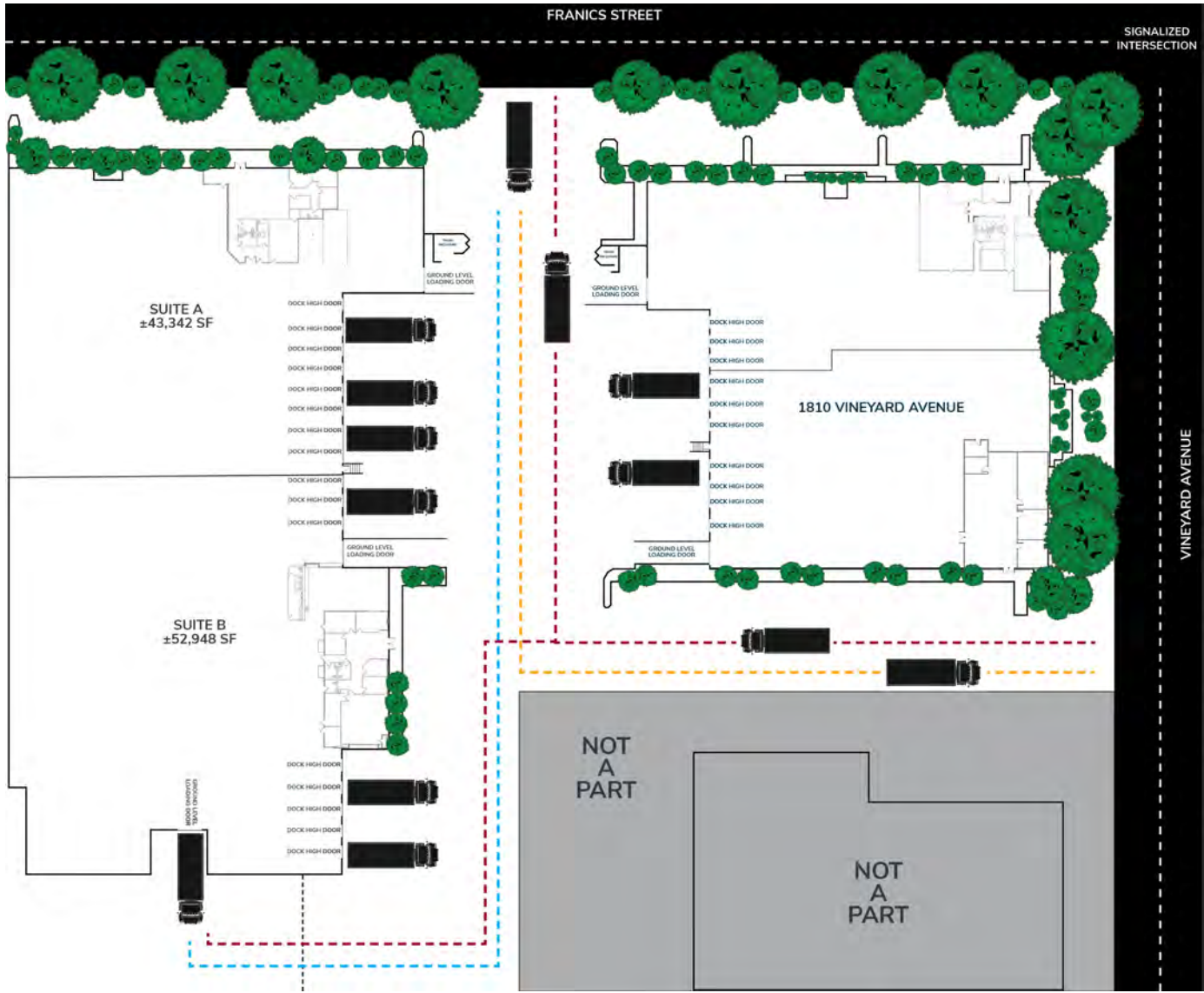

JOHN SEOANE | SIOR
 SENIOR VICE PRESIDENT/PRINCIPAL
 909.373.2946
 jseoane@lee-assoc.com
 DRE #01453455

RYAN DE GUZMAN
 SENIOR VICE PRESIDENT/PRINCIPAL
 909.373.2926
 rdeguzman@lee-assoc.com
 DRE #02101391

LEE & ASSOCIATES - ONTARIO
 3535 Inland Empire Boulevard
 Ontario, California 91764
 (909) 989-7771 | lee-associates.com



All information furnished regarding property for sale, rental or financing is from sources deemed reliable, but no warranty or representation is made to the accuracy thereof and same is submitted to errors, omissions, change of price, rental or other conditions prior to sale, lease or financing or withdrawal without notice. No liability of any kind is to be imposed on the broker herein.

AVAILABLE FOR SALE

VINEYARD & FRANCIS COMMERCE CENTER

1822 FRANCIS STREET

ONTARIO, CALIFORNIA

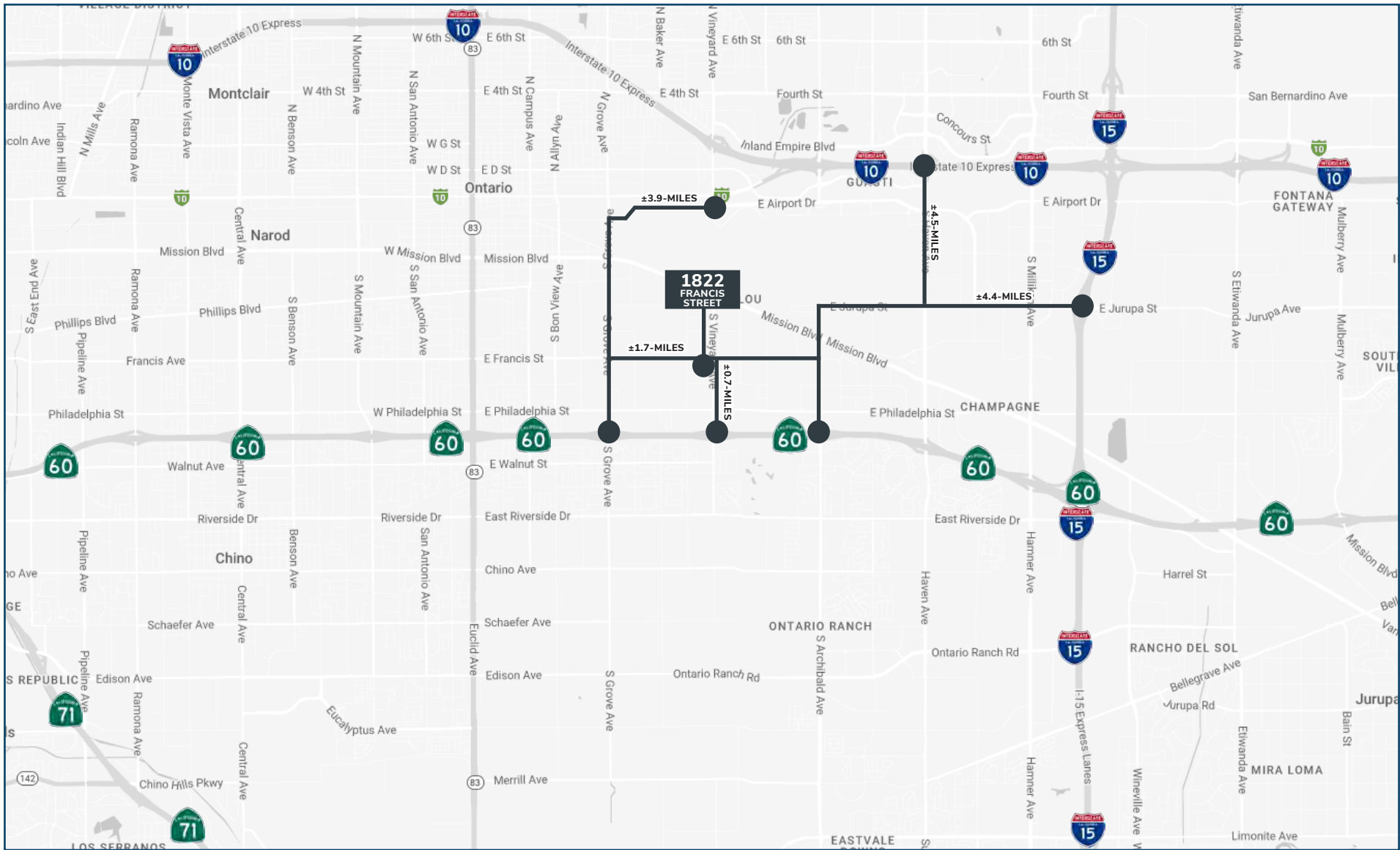

ONT INTL' AIRPORT I
±3.9-MILE DRIVING DISTANCE

LA INTL' AIRPORT I
±4.5-MILE DRIVING DISTANCE



PORTS OF LONG BEACH AND LOS ANGELES I
±55-MILE DRIVING DISTANCE



CA-60 FREEWAY INTERCHANGE I
±1-MILE DRIVING DISTANCE VIA VINEYARD AVENUE

CA-15 FREEWAY INTERCHANGE I
±4.4-MILE DRIVING DISTANCE VIA JURUPA STREET

JOHN SEOANE | SIOR
SENIOR VICE PRESIDENT/PRINCIPAL
909.373.2946
jseoane@lee-assoc.com
DRE #01453455

RYAN DE GUZMAN
SENIOR VICE PRESIDENT/PRINCIPAL
909.373.2926
rdeguzman@lee-assoc.com
DRE #02101391

LEE & ASSOCIATES - ONTARIO
3535 Inland Empire Boulevard
Ontario, California 91764
(909) 989-7771 | lee-associates.com

LEE & ASSOCIATES
COMMERCIAL REAL ESTATE SERVICES
ONTARIO
CORPORATE ID #00976995

All information furnished regarding property for sale, rental or financing is from sources deemed reliable, but no warranty or representation is made to the accuracy thereof and same is submitted to errors, omissions, change of price, rental or other conditions prior to sale, lease or financing or withdrawal without notice. No liability of any kind is to be imposed on the broker herein.

AVAILABLE FOR SALE
VINEYARD & FRANCIS COMMERCE CENTER

1822 FRANCIS STREET
ONTARIO, CALIFORNIA

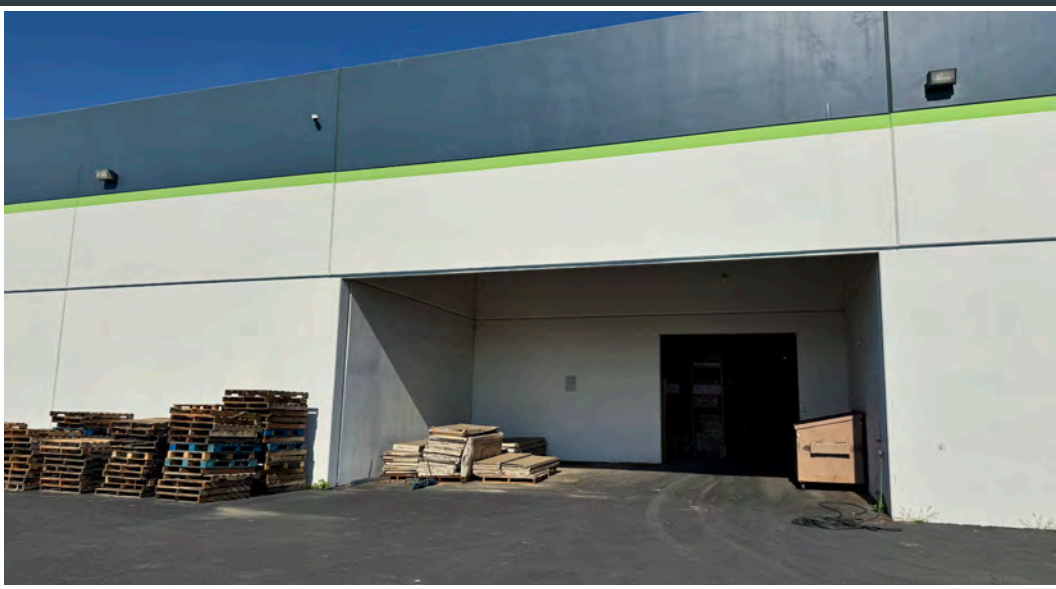

JOHN SEOANE | SIOR
SENIOR VICE PRESIDENT/PRINCIPAL
909.373.2946
jseoane@lee-assoc.com
DRE #01453455

RYAN DE GUZMAN
SENIOR VICE PRESIDENT/PRINCIPAL
909.373.2926
rdeguzman@lee-assoc.com
DRE #02101391

LEE & ASSOCIATES - ONTARIO
3535 Inland Empire Boulevard
Ontario, California 91764
(909) 989-7771 | lee-associates.com



All information furnished regarding property for sale, rental or financing is from sources deemed reliable, but no warranty or representation is made to the accuracy thereof and same is submitted to errors, omissions, change of price, rental or other conditions prior to sale, lease or financing or withdrawal without notice. No liability of any kind is to be imposed on the broker herein.

1822 FRANCIS STREET

ONTARIO, CALIFORNIA

FOR MORE INFORMATION, PLEASE CONTACT:

JOHN SEOANE | SIOR

SENIOR VICE PRESIDENT/PRINCIPAL

909.373.2946

jseoane@lee-assoc.com

DRE #01453455

RYAN DE GUZMAN

SENIOR VICE PRESIDENT/PRINCIPAL

909.373.2926

rdeguzman@lee-assoc.com

DRE #02101391

LEE & ASSOCIATES - ONTARIO

3535 Inland Empire Boulevard | Ontario, California 91764

(909) 989-7771 | lee-assoc.com

Corporate ID: 00976995



COMMERCIAL REAL ESTATE SERVICES
ONTARIO